

Reed, Jackie
Reed, John
46 Reed Lane
Wade ME 04786

B4004P219

Inspection Witnessed By:

No./Date	Description	Date Insp.
X		

Notes:

Wade

Property Data			Assessment Record																																																																																																																																																																																																						
Neighborhood 1 Rural			Year	Land	Buildings	Exempt	Total																																																																																																																																																																																																		
Tree Growth Year 0			2017	11,900	46,700	26,000	32,600																																																																																																																																																																																																		
X Coordinate			2018	11,900	46,700	26,000	32,600																																																																																																																																																																																																		
Y Coordinate			2020	11,900	46,700	31,000	27,600																																																																																																																																																																																																		
Zone/Land Use 1 Residential			2021	12,900	46,700	31,000	28,600																																																																																																																																																																																																		
Secondary Zone			2022	19,500	69,700	31,000	58,200																																																																																																																																																																																																		
Topography 2 Rolling																																																																																																																																																																																																									
1.Level 4.Below Stre 7.Steep 2.Rolling 5.Low 8.Rough 3.Above Stre 6.Swampy 9.																																																																																																																																																																																																									
Utilities 1 Drilled Well / Septic																																																																																																																																																																																																									
1.Well+Septi 4.Public Wat 7.Cess Pool 2.Drilled We 5.Public Sew 8.Holding Ta 3.Septic Sys 6.Dug Well 9.NoW/NoSew																																																																																																																																																																																																									
Street 3 Gravel																																																																																																																																																																																																									
1.Paved 4.Proposed 7. 2.Semi-Impro 5.Private 8. 3.Gravel 6. 9.No Street																																																																																																																																																																																																									
LAND USE 0			<table border="1"> <thead> <tr> <th rowspan="2">Front Foot</th> <th rowspan="2">Type</th> <th colspan="2">Effective</th> <th colspan="2">Influence</th> <th rowspan="2">Influence Codes</th> </tr> <tr> <th>Frontage</th> <th>Depth</th> <th>Factor</th> <th>Code</th> </tr> </thead> <tbody> <tr> <td>11.Regular Lot</td> <td></td> <td></td> <td></td> <td>%</td> <td></td> <td>1.Vacancy</td> </tr> <tr> <td>12.Delta Triangle</td> <td></td> <td></td> <td></td> <td>%</td> <td></td> <td>2.Unimproved</td> </tr> <tr> <td>13.Nabla Triangle</td> <td></td> <td></td> <td></td> <td>%</td> <td></td> <td>3.Topography</td> </tr> <tr> <td>14.Rear Land</td> <td></td> <td></td> <td></td> <td>%</td> <td></td> <td>4.Size/Shape</td> </tr> <tr> <td>15.Class I Road</td> <td></td> <td></td> <td></td> <td>%</td> <td></td> <td>5.Access</td> </tr> <tr> <td></td> <td></td> <td></td> <td></td> <td>%</td> <td></td> <td>6.Restriction</td> </tr> <tr> <td></td> <td></td> <td></td> <td></td> <td>%</td> <td></td> <td>7.Corner/Locatio</td> </tr> <tr> <td></td> <td></td> <td></td> <td></td> <td>%</td> <td></td> <td>8.View/Environme</td> </tr> <tr> <td></td> <td></td> <td></td> <td></td> <td>%</td> <td></td> <td>9.Fractional Sha</td> </tr> <tr> <td></td> <td></td> <td></td> <td></td> <td>%</td> <td></td> <td>Acres</td> </tr> <tr> <td></td> <td></td> <td></td> <td></td> <td>%</td> <td></td> <td>32.Pasture</td> </tr> <tr> <td></td> <td></td> <td></td> <td></td> <td>%</td> <td></td> <td>33.Orchard</td> </tr> <tr> <td></td> <td></td> <td></td> <td></td> <td>%</td> <td></td> <td>34.Softwood (FL)</td> </tr> <tr> <td></td> <td></td> <td></td> <td></td> <td>%</td> <td></td> <td>35.Mixed Wood (FL)</td> </tr> <tr> <td></td> <td></td> <td></td> <td></td> <td>%</td> <td></td> <td>36.Hardwood (FL)</td> </tr> <tr> <td></td> <td></td> <td></td> <td></td> <td>%</td> <td></td> <td>37.Softwood (TG)</td> </tr> <tr> <td></td> <td></td> <td></td> <td></td> <td>%</td> <td></td> <td>38.Mixed Wood (TG)</td> </tr> <tr> <td></td> <td></td> <td></td> <td></td> <td>%</td> <td></td> <td>39.Hardwood (TG)</td> </tr> <tr> <td></td> <td></td> <td></td> <td></td> <td>%</td> <td></td> <td>40.Wasteland</td> </tr> <tr> <td></td> <td></td> <td></td> <td></td> <td>%</td> <td></td> <td>41.Open Space</td> </tr> <tr> <td></td> <td></td> <td></td> <td></td> <td>%</td> <td></td> <td>42.Mobile Home Si</td> </tr> <tr> <td></td> <td></td> <td></td> <td></td> <td>%</td> <td></td> <td>43.Condo Site</td> </tr> <tr> <td></td> <td></td> <td></td> <td></td> <td>%</td> <td></td> <td>44.Lot Improvemen</td> </tr> <tr> <td></td> <td></td> <td></td> <td></td> <td>%</td> <td></td> <td>45.Subdivision Lo</td> </tr> <tr> <td></td> <td></td> <td></td> <td></td> <td>%</td> <td></td> <td>46.Heavy Ind Sit</td> </tr> <tr> <td colspan="2"></td> <td colspan="2">Total Acreage</td> <td colspan="3">1.00</td> <td></td> </tr> </tbody> </table>					Front Foot	Type	Effective		Influence		Influence Codes	Frontage	Depth	Factor	Code	11.Regular Lot				%		1.Vacancy	12.Delta Triangle				%		2.Unimproved	13.Nabla Triangle				%		3.Topography	14.Rear Land				%		4.Size/Shape	15.Class I Road				%		5.Access					%		6.Restriction					%		7.Corner/Locatio					%		8.View/Environme					%		9.Fractional Sha					%		Acres					%		32.Pasture					%		33.Orchard					%		34.Softwood (FL)					%		35.Mixed Wood (FL)					%		36.Hardwood (FL)					%		37.Softwood (TG)					%		38.Mixed Wood (TG)					%		39.Hardwood (TG)					%		40.Wasteland					%		41.Open Space					%		42.Mobile Home Si					%		43.Condo Site					%		44.Lot Improvemen					%		45.Subdivision Lo					%		46.Heavy Ind Sit			Total Acreage		1.00			
Front Foot	Type	Effective								Influence		Influence Codes																																																																																																																																																																																													
		Frontage	Depth	Factor	Code																																																																																																																																																																																																				
11.Regular Lot				%		1.Vacancy																																																																																																																																																																																																			
12.Delta Triangle				%		2.Unimproved																																																																																																																																																																																																			
13.Nabla Triangle				%		3.Topography																																																																																																																																																																																																			
14.Rear Land				%		4.Size/Shape																																																																																																																																																																																																			
15.Class I Road				%		5.Access																																																																																																																																																																																																			
				%		6.Restriction																																																																																																																																																																																																			
				%		7.Corner/Locatio																																																																																																																																																																																																			
				%		8.View/Environme																																																																																																																																																																																																			
				%		9.Fractional Sha																																																																																																																																																																																																			
				%		Acres																																																																																																																																																																																																			
				%		32.Pasture																																																																																																																																																																																																			
				%		33.Orchard																																																																																																																																																																																																			
				%		34.Softwood (FL)																																																																																																																																																																																																			
				%		35.Mixed Wood (FL)																																																																																																																																																																																																			
				%		36.Hardwood (FL)																																																																																																																																																																																																			
				%		37.Softwood (TG)																																																																																																																																																																																																			
				%		38.Mixed Wood (TG)																																																																																																																																																																																																			
				%		39.Hardwood (TG)																																																																																																																																																																																																			
				%		40.Wasteland																																																																																																																																																																																																			
				%		41.Open Space																																																																																																																																																																																																			
				%		42.Mobile Home Si																																																																																																																																																																																																			
				%		43.Condo Site																																																																																																																																																																																																			
				%		44.Lot Improvemen																																																																																																																																																																																																			
				%		45.Subdivision Lo																																																																																																																																																																																																			
				%		46.Heavy Ind Sit																																																																																																																																																																																																			
		Total Acreage		1.00																																																																																																																																																																																																					
Sale Date			<table border="1"> <thead> <tr> <th>Fract. Acre</th> <th colspan="2">Acreage/Sites</th> <th colspan="2"></th> <th></th> </tr> </thead> <tbody> <tr> <td>21.Developed Pave</td> <td>23</td> <td>1.00</td> <td>100</td> <td>%</td> <td>0</td> </tr> <tr> <td>22.Undev Paved (F</td> <td></td> <td></td> <td></td> <td>%</td> <td></td> </tr> <tr> <td>23.Developed Grav</td> <td></td> <td></td> <td></td> <td>%</td> <td></td> </tr> <tr> <td>Acres</td> <td></td> <td></td> <td></td> <td>%</td> <td></td> </tr> <tr> <td>24.Undev Gravel (</td> <td></td> <td></td> <td></td> <td>%</td> <td></td> </tr> <tr> <td>26.Rear Land</td> <td></td> <td></td> <td></td> <td>%</td> <td></td> </tr> <tr> <td>27.Backlot</td> <td></td> <td></td> <td></td> <td>%</td> <td></td> </tr> <tr> <td>29.Pavement</td> <td></td> <td></td> <td></td> <td>%</td> <td></td> </tr> <tr> <td>30.Utility R O W</td> <td></td> <td></td> <td></td> <td>%</td> <td></td> </tr> <tr> <td>31.Tillable</td> <td></td> <td></td> <td></td> <td>%</td> <td></td> </tr> </tbody> </table>					Fract. Acre	Acreage/Sites					21.Developed Pave	23	1.00	100	%	0	22.Undev Paved (F				%		23.Developed Grav				%		Acres				%		24.Undev Gravel (%		26.Rear Land				%		27.Backlot				%		29.Pavement				%		30.Utility R O W				%		31.Tillable				%																																																																																																																																	
Fract. Acre	Acreage/Sites																																																																																																																																																																																																								
21.Developed Pave	23	1.00	100	%	0																																																																																																																																																																																																				
22.Undev Paved (F				%																																																																																																																																																																																																					
23.Developed Grav				%																																																																																																																																																																																																					
Acres				%																																																																																																																																																																																																					
24.Undev Gravel (%																																																																																																																																																																																																					
26.Rear Land				%																																																																																																																																																																																																					
27.Backlot				%																																																																																																																																																																																																					
29.Pavement				%																																																																																																																																																																																																					
30.Utility R O W				%																																																																																																																																																																																																					
31.Tillable				%																																																																																																																																																																																																					
Building Use 0																																																																																																																																																																																																									
Sale Type																																																																																																																																																																																																									
1.Land 4.Mobile 7.C/I L&B 2.L & B 5.Other 8. 3.Building 6.C/I Land 9.																																																																																																																																																																																																									
Financing																																																																																																																																																																																																									
1.Convent 4.Seller 7. 2.FHA/VA 5.Private 8. 3.Assumed 6.Cash 9.Unknown																																																																																																																																																																																																									
Validity																																																																																																																																																																																																									
1.Valid 4.Split 7.Renovate 2.Related 5.Partial 8.Other 3.Distress 6.Exempt 9.																																																																																																																																																																																																									
Verified																																																																																																																																																																																																									
1.Buyer 4.Agent 7.Family 2.Seller 5.Pub Rec 8.Other 3.Lender 6.MLS 9.																																																																																																																																																																																																									

Wade

Map Lot 003-001

Account 163

Location 46 Reed Lane

Card 1 Of 1 1/09/2023

Building Style 1 CONVENTIONAL	SF Bsmt Living 0	Layout 1 TYPICAL
1.CONVENTI 5.GARRISON 9.GAMBREL	Fin Bsmt Grade 0 0	1.TYPICAL 4. 7.
2.RANCH 6.SALT BOX 10.OTHER	DIRT FLOOR 0	2.INADEQUA 5. 8.
3.RAISED R 7.CONTEMP 11.SPLIT	Heat Type 100% 5 FORCED WARM AIR	3.POOR 6. 9.
4.CAPE 8.LOG 12.NE	1.HWBB 5.FWA 9.NOT HEAT	Attic 9 NONE
Dwelling Units 1	2.HWCI 6.GRAVWA 10.	1.1/4 FINI 4.FULL FIN 7.
Other Units 0	3.HP 7.ELECTRIC 11.	2.1/2 FINI 5.FL / STA 8.
Stories 4 ONE & 1/2 STORY	4.STEAM 8.FL/WALL 12.	3.3/4 FINI 6. 9.NONE
1.ONE STOR 4.1.5 STOR 7.1.25 STO	Cool Type 0% 9 NONE	Insulation 1 FULLY INSULATED
2.TWO STOR 5.1.75 STO 8.	1.REFRIG A 4.W&C AIR 7.	1.FULLY IN 4.MINIMAL 7.
3.THREE ST 6.2.5 STOR 9.	2.EVAPORAT 5. 8.	2.HEAVY 5.UNKNOWN 8.
Exterior Walls 2 VINYL/ALUMINUM	3.HEAT PUM 6. 9.NONE	3.CAPPED O 6. 9.NONE
1.WOOD 5.STUCKO 9.T-111	Kitchen Style 2 TYPICAL	Unfinished % 0%
2.VIN/AL 6.BRICK 10.OTHER	1.GOOD 4.OBSOLETE 7.	Grade & Factor 3 AVERAGE QUALITY
3.COMPOS. 7.STONE 11.LOG	2.TYPICAL 5. 8.	1.E GRADE 4.B GRADE 7.
4.ASBESTOS 8.CONCRETE 12.	3.OLD STYL 6. 9.NONE	2.D GRADE 5.A GRADE 8.
Roof Surface 1 ASPHALT SHINGLES	Bath(s) Style 2 TYPICAL	3.C GRADE 6.AA GRADE 9.SAME
1.ASPHALT 4.COMPOSIT 7.	1.GOOD 4.OBSOLETE 7.	SQFT (Footprint) 440
2.SLATE 5.WOOD 8.	2.TYPICAL 5. 8.	Condition 4 AVERAGE
3.METAL 6.OTHER 9.	3.OLD STYL 6. 9.NONE	1.POOR 4.AVERAGE 7.VERY GOO
SF Masonry Trim 0	# Rooms 6	2.FAIR 5.ABOVE AV 8.EXCELLEN
0	# Bedrooms 2	3.BELOW AV 6.GOOD 9.SAME
0	# Full Baths 2	Phys. % Good 0%
Year Built 1950	# Half Baths 0	Funct. % Good 100%
Year Remodeled 0	# Addn Fixtures 0	Functional Code 9 None
Foundation 1 CONCRETE	# Fireplaces 0	1.Incomp 4.LongTerm 7.Layout
1.CONCRETE 4.WOOD 7.		2.Overbuil 5.Utility 8.Other
2.CONCRETE 5.SLAB 8.		3.Delap 6.Style 9.None
3.BRICK/ST 6.PIERS 9.		Econ. % Good 100%
Basement 4 FULL BASEMENT		Economic Code NONE
1.1/4 BASE 4.FULL BAS 7.		0.None 3.NO ELECT 6.
2.1/2 BASE 5.CRAWL 8.		1.LOCATION 4.GENERATC 7.
3.3/4 BASE 6. 9.NO BASEM		2.ENCROACH 5. 8.OTHER
Bsmt Gar # Cars 0		Entrance Code 5 ESTIMATED
Wet Basement 2 DAMP BASEMENT		1.INTERIOR 4.UNOCCUPI 7.
1.DRY BASE 4. 7.		2.REFUSED 5.ESTIMATE 8.
2.DAMP BAS 5. 8.		3.INFO ONL 6. 9.
3.WET BASE 6. 9.NO BASEM		Information Code 5 ESTIMATE
		1.OWNER 4.AGENT 7.
		2.RELATIVE 5.ESTIMATE 8.
		3.TENANT 6.OTHER 9.

Date Inspected 7/11/2022

Additions, Outbuildings & Improvements

Type	Year	Units	Grade	Cond	Phys.	Funct.	Sound Value
68 Deck	1990	120	3 100	4	0 %	100 %	
14 1 & 1/2 Story w/	1950	280	3 100	4	0 %	100 %	
21 Open Porch	1950	368	3 100	4	0 %	100 %	
23 Frame Garage	1980	324	3 100	4	0 %	100 %	
					%	%	
					%	%	
					%	%	
					%	%	
					%	%	
					%	%	
					%	%	
					%	%	

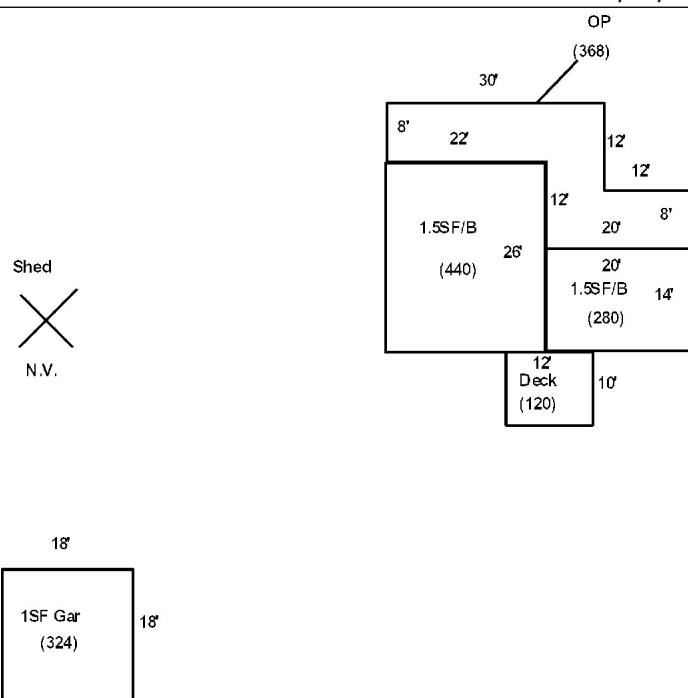

Reed, James
Reed, Patricia
53 Reed Lane
Wade ME 04786

B2864P83

Inspection Witnessed By:

No./Date	Description	Date Insp.
X		

Notes:

Wade

Property Data			Assessment Record																																																																																																																																																																																																					
Neighborhood 1 Rural			Year	Land	Buildings	Exempt	Total																																																																																																																																																																																																	
Tree Growth Year 0			2017	15,600	57,100	20,000	52,700																																																																																																																																																																																																	
X Coordinate			2018	15,600	57,100	20,000	52,700																																																																																																																																																																																																	
Y Coordinate			2020	15,600	57,100	25,000	47,700																																																																																																																																																																																																	
Zone/Land Use 1 Residential			2021	16,600	57,100	25,000	48,700																																																																																																																																																																																																	
Secondary Zone			2022	23,800	65,000	25,000	63,800																																																																																																																																																																																																	
Topography 2 Rolling																																																																																																																																																																																																								
1.Level 4.Below Stre 7.Steep 2.Rolling 5.Low 8.Rough 3.Above Stre 6.Swampy 9.																																																																																																																																																																																																								
Utilities 1 Drilled Well / Septic																																																																																																																																																																																																								
1.Well+Septi 4.Public Wat 7.Cess Pool 2.Drilled We 5.Public Sew 8.Holding Ta 3.Septic Sys 6.Dug Well 9.NoW/NoSew																																																																																																																																																																																																								
Street 3 Gravel																																																																																																																																																																																																								
1.Paved 4.Proposed 7. 2.Semi-Impro 5.Private 8. 3.Gravel 6. 9.No Street																																																																																																																																																																																																								
LAND USE 0			<table border="1"> <thead> <tr> <th rowspan="2">Front Foot</th> <th rowspan="2">Type</th> <th colspan="2">Effective</th> <th colspan="2">Influence</th> <th rowspan="2">Influence Codes</th> </tr> <tr> <th>Frontage</th> <th>Depth</th> <th>Factor</th> <th>Code</th> </tr> </thead> <tbody> <tr> <td>11.Regular Lot</td> <td></td> <td></td> <td></td> <td>%</td> <td></td> <td>1.Vacancy</td> </tr> <tr> <td>12.Delta Triangle</td> <td></td> <td></td> <td></td> <td>%</td> <td></td> <td>2.Unimproved</td> </tr> <tr> <td>13.Nabla Triangle</td> <td></td> <td></td> <td></td> <td>%</td> <td></td> <td>3.Topography</td> </tr> <tr> <td>14.Rear Land</td> <td></td> <td></td> <td></td> <td>%</td> <td></td> <td>4.Size/Shape</td> </tr> <tr> <td>15.Class I Road</td> <td></td> <td></td> <td></td> <td>%</td> <td></td> <td>5.Access</td> </tr> <tr> <td></td> <td></td> <td></td> <td></td> <td>%</td> <td></td> <td>6.Restriction</td> </tr> <tr> <td></td> <td></td> <td></td> <td></td> <td>%</td> <td></td> <td>7.Corner/Locatio</td> </tr> <tr> <td></td> <td></td> <td></td> <td></td> <td>%</td> <td></td> <td>8.View/Environme</td> </tr> <tr> <td></td> <td></td> <td></td> <td></td> <td>%</td> <td></td> <td>9.Fractional Sha</td> </tr> <tr> <td></td> <td></td> <td></td> <td></td> <td>%</td> <td></td> <td>Acres</td> </tr> <tr> <td></td> <td></td> <td></td> <td></td> <td>%</td> <td></td> <td>32.Pasture</td> </tr> <tr> <td></td> <td></td> <td></td> <td></td> <td>%</td> <td></td> <td>33.Orchard</td> </tr> <tr> <td></td> <td></td> <td></td> <td></td> <td>%</td> <td></td> <td>34.Softwood (FL)</td> </tr> <tr> <td></td> <td></td> <td></td> <td></td> <td>%</td> <td></td> <td>35.Mixed Wood (FL)</td> </tr> <tr> <td></td> <td></td> <td></td> <td></td> <td>%</td> <td></td> <td>36.Hardwood (FL)</td> </tr> <tr> <td></td> <td></td> <td></td> <td></td> <td>%</td> <td></td> <td>37.Softwood (TG)</td> </tr> <tr> <td></td> <td></td> <td></td> <td></td> <td>%</td> <td></td> <td>38.Mixed Wood (TG)</td> </tr> <tr> <td></td> <td></td> <td></td> <td></td> <td>%</td> <td></td> <td>39.Hardwood (TG)</td> </tr> <tr> <td></td> <td></td> <td></td> <td></td> <td>%</td> <td></td> <td>40.Wasteland</td> </tr> <tr> <td></td> <td></td> <td></td> <td></td> <td>%</td> <td></td> <td>41.Open Space</td> </tr> <tr> <td></td> <td></td> <td></td> <td></td> <td>%</td> <td></td> <td>42.Mobile Home Si</td> </tr> <tr> <td></td> <td></td> <td></td> <td></td> <td>%</td> <td></td> <td>43.Condo Site</td> </tr> <tr> <td></td> <td></td> <td></td> <td></td> <td>%</td> <td></td> <td>44.Lot Improvemen</td> </tr> <tr> <td></td> <td></td> <td></td> <td></td> <td>%</td> <td></td> <td>45.Subdivision Lo</td> </tr> <tr> <td></td> <td></td> <td></td> <td></td> <td>%</td> <td></td> <td>46.Heavy Ind Sit</td> </tr> <tr> <td colspan="2"></td> <td colspan="2">Total Acreage</td> <td colspan="2">8.80</td> <td></td> </tr> </tbody> </table>					Front Foot	Type	Effective		Influence		Influence Codes	Frontage	Depth	Factor	Code	11.Regular Lot				%		1.Vacancy	12.Delta Triangle				%		2.Unimproved	13.Nabla Triangle				%		3.Topography	14.Rear Land				%		4.Size/Shape	15.Class I Road				%		5.Access					%		6.Restriction					%		7.Corner/Locatio					%		8.View/Environme					%		9.Fractional Sha					%		Acres					%		32.Pasture					%		33.Orchard					%		34.Softwood (FL)					%		35.Mixed Wood (FL)					%		36.Hardwood (FL)					%		37.Softwood (TG)					%		38.Mixed Wood (TG)					%		39.Hardwood (TG)					%		40.Wasteland					%		41.Open Space					%		42.Mobile Home Si					%		43.Condo Site					%		44.Lot Improvemen					%		45.Subdivision Lo					%		46.Heavy Ind Sit			Total Acreage		8.80		
Front Foot	Type	Effective								Influence		Influence Codes																																																																																																																																																																																												
		Frontage	Depth	Factor	Code																																																																																																																																																																																																			
11.Regular Lot				%		1.Vacancy																																																																																																																																																																																																		
12.Delta Triangle				%		2.Unimproved																																																																																																																																																																																																		
13.Nabla Triangle				%		3.Topography																																																																																																																																																																																																		
14.Rear Land				%		4.Size/Shape																																																																																																																																																																																																		
15.Class I Road				%		5.Access																																																																																																																																																																																																		
				%		6.Restriction																																																																																																																																																																																																		
				%		7.Corner/Locatio																																																																																																																																																																																																		
				%		8.View/Environme																																																																																																																																																																																																		
				%		9.Fractional Sha																																																																																																																																																																																																		
				%		Acres																																																																																																																																																																																																		
				%		32.Pasture																																																																																																																																																																																																		
				%		33.Orchard																																																																																																																																																																																																		
				%		34.Softwood (FL)																																																																																																																																																																																																		
				%		35.Mixed Wood (FL)																																																																																																																																																																																																		
				%		36.Hardwood (FL)																																																																																																																																																																																																		
				%		37.Softwood (TG)																																																																																																																																																																																																		
				%		38.Mixed Wood (TG)																																																																																																																																																																																																		
				%		39.Hardwood (TG)																																																																																																																																																																																																		
				%		40.Wasteland																																																																																																																																																																																																		
				%		41.Open Space																																																																																																																																																																																																		
				%		42.Mobile Home Si																																																																																																																																																																																																		
				%		43.Condo Site																																																																																																																																																																																																		
				%		44.Lot Improvemen																																																																																																																																																																																																		
				%		45.Subdivision Lo																																																																																																																																																																																																		
				%		46.Heavy Ind Sit																																																																																																																																																																																																		
		Total Acreage		8.80																																																																																																																																																																																																				
Sale Date			<table border="1"> <thead> <tr> <th>Fract. Acre</th> <th colspan="2">Acreage/Sites</th> <th colspan="2"></th> <th colspan="2"></th> </tr> </thead> <tbody> <tr> <td>21.Developed Pave</td> <td>23</td> <td>1.00</td> <td>100</td> <td>%</td> <td>0</td> <td></td> </tr> <tr> <td>22.Undev Paved (F</td> <td>26</td> <td>7.80</td> <td>100</td> <td>%</td> <td>0</td> <td></td> </tr> <tr> <td>23.Developed Grav</td> <td></td> <td></td> <td></td> <td>%</td> <td></td> <td></td> </tr> <tr> <td>Acres</td> <td></td> <td></td> <td></td> <td>%</td> <td></td> <td></td> </tr> <tr> <td>24.Undev Gravel (</td> <td></td> <td></td> <td></td> <td>%</td> <td></td> <td></td> </tr> <tr> <td>26.Rear Land</td> <td></td> <td></td> <td></td> <td>%</td> <td></td> <td></td> </tr> <tr> <td>27.Backlot</td> <td></td> <td></td> <td></td> <td>%</td> <td></td> <td></td> </tr> <tr> <td>29.Pavement</td> <td></td> <td></td> <td></td> <td>%</td> <td></td> <td></td> </tr> <tr> <td>30.Utility R O W</td> <td></td> <td></td> <td></td> <td>%</td> <td></td> <td></td> </tr> <tr> <td>31.Tillable</td> <td></td> <td></td> <td></td> <td>%</td> <td></td> <td></td> </tr> </tbody> </table>					Fract. Acre	Acreage/Sites						21.Developed Pave	23	1.00	100	%	0		22.Undev Paved (F	26	7.80	100	%	0		23.Developed Grav				%			Acres				%			24.Undev Gravel (%			26.Rear Land				%			27.Backlot				%			29.Pavement				%			30.Utility R O W				%			31.Tillable				%																																																																																																																						
Fract. Acre	Acreage/Sites																																																																																																																																																																																																							
21.Developed Pave	23	1.00	100	%	0																																																																																																																																																																																																			
22.Undev Paved (F	26	7.80	100	%	0																																																																																																																																																																																																			
23.Developed Grav				%																																																																																																																																																																																																				
Acres				%																																																																																																																																																																																																				
24.Undev Gravel (%																																																																																																																																																																																																				
26.Rear Land				%																																																																																																																																																																																																				
27.Backlot				%																																																																																																																																																																																																				
29.Pavement				%																																																																																																																																																																																																				
30.Utility R O W				%																																																																																																																																																																																																				
31.Tillable				%																																																																																																																																																																																																				
Building Use 0																																																																																																																																																																																																								
Sale Data																																																																																																																																																																																																								
Price																																																																																																																																																																																																								
Sale Type																																																																																																																																																																																																								
1.Land 4.Mobile 7.C/I L&B 2.L & B 5.Other 8. 3.Building 6.C/I Land 9.																																																																																																																																																																																																								
Financing																																																																																																																																																																																																								
1.Convent 4.Seller 7. 2.FHA/VA 5.Private 8. 3.Assumed 6.Cash 9.Unknown																																																																																																																																																																																																								
Validity																																																																																																																																																																																																								
1.Valid 4.Split 7.Renovate 2.Related 5.Partial 8.Other 3.Distress 6.Exempt 9.																																																																																																																																																																																																								
Verified																																																																																																																																																																																																								
1.Buyer 4.Agent 7.Family 2.Seller 5.Pub Rec 8.Other 3.Lender 6.MLS 9.																																																																																																																																																																																																								

Wade

Map Lot 003-001A

Account 164

Location 53 Reed Lane

Card 1 Of 1 1/09/2023

Building Style 2 RANCH	SF Bsmt Living 0	Layout 1 TYPICAL
1.CONVENTI 5.GARRISON 9.GAMBREL	Fin Bsmt Grade 0 0	1.TYPICAL 4. 7.
2.RANCH 6.SALT BOX 10.OTHER	DIRT FLOOR 0	2.INADEQUA 5. 8.
3.RAISED R 7.CONTEMP 11.SPLIT	Heat Type 100% 1 HOT WATER BB	3.POOR 6. 9.
4.CAPE 8.LOG 12.NE	1.HWBB 5.FWA 9.NOT HEAT	Attic 9 NONE
Dwelling Units 1	2.HWCI 6.GRAWWA 10.	1.1/4 FINI 4.FULL FIN 7.
Other Units 0	3.HP 7.ELECTRIC 11.	2.1/2 FINI 5.FL / STA 8.
Stories 1 ONE STORY	4.STEAM 8.FL/WALL 12.	3.3/4 FINI 6. 9.NONE
1.ONE STOR 4.1.5 STOR 7.1.25 STO	Cool Type 100% 3 HEAT PUMP	Insulation 1 FULLY INSULATED
2.TWO STOR 5.1.75 STO 8.	1.REFRIG A 4.W&C AIR 7.	1.FULLY IN 4.MINIMAL 7.
3.THREE ST 6.2.5 STOR 9.	2.EVAPORAT 5. 8.	2.HEAVY 5.UNKNOWN 8.
Exterior Walls 2 VINYL/ALUMINUM	3.HEAT PUM 6. 9.NONE	3.CAPPED O 6. 9.NONE
1.WOOD 5.STUCKO 9.T-111	Kitchen Style 2 TYPICAL	Unfinished % 0%
2.VIN/AL 6.BRICK 10.OTHER	1.GOOD 4.OBSOLETE 7.	Grade & Factor 3 AVERAGE QUALITY
3.COMPOS. 7.STONE 11.LOG	2.TYPICAL 5. 8.	1.E GRADE 4.B GRADE 7.
4.ASBESTOS 8.CONCRETE 12.	3.OLD STYL 6. 9.NONE	2.D GRADE 5.A GRADE 8.
Roof Surface 1 ASPHALT SHINGLES	Bath(s) Style 2 TYPICAL	3.C GRADE 6.AA GRADE 9.SAME
1.ASPHALT 4.COMPOSIT 7.	1.GOOD 4.OBSOLETE 7.	SQFT (Footprint) 1040
2.SLATE 5.WOOD 8.	2.TYPICAL 5. 8.	Condition 4 AVERAGE
3.METAL 6.OTHER 9.	3.OLD STYL 6. 9.NONE	1.POOR 4.AVERAGE 7.VERY GOO
SF Masonry Trim 0	# Rooms 5	2.FAIR 5.ABOVE AV 8.EXCELLEN
0	# Bedrooms 2	3.BELOW AV 6.GOOD 9.SAME
0	# Full Baths 1	Phys. % Good 0%
Year Built 1995	# Half Baths 0	Funct. % Good 100%
Year Remodeled 0	# Addn Fixtures 0	Functional Code 9 None
Foundation 1 CONCRETE	# Fireplaces 0	1.Incomp 4.LongTerm 7.Layout
1.CONCRETE 4.WOOD 7.		2.Overbuil 5.Utility 8.Other
2.CONCRETE 5.SLAB 8.		3.Delap 6.Style 9.None
3.BRICK/ST 6.PIERS 9.		Econ. % Good 100%
Basement 4 FULL BASEMENT		Economic Code NONE
1.1/4 BASE 4.FULL BAS 7.		0.None 3.NO ELECT 6.
2.1/2 BASE 5.CRAWL 8.		1.LOCATION 4.GENERATC 7.
3.3/4 BASE 6. 9.NO BASEM		2.ENCROACH 5. 8.OTHER
Bsmt Gar # Cars 0		Entrance Code 1 INTERIOR INSPECT
Wet Basement 1 DRY BASEMENT		1.INTERIOR 4.UNOCCUPI 7.
1.DRY BASE 4. 7.		2.REFUSED 5.ESTIMATE 8.
2.DAMP BAS 5. 8.	3.INFO ONL 6. 9.	
3.WET BASE 6. 9.NO BASEM	Information Code 1 OWNER	
	1.OWNER 4.AGENT 7.	
	2.RELATIVE 5.ESTIMATE 8.	
	3.TENANT 6.OTHER 9.	

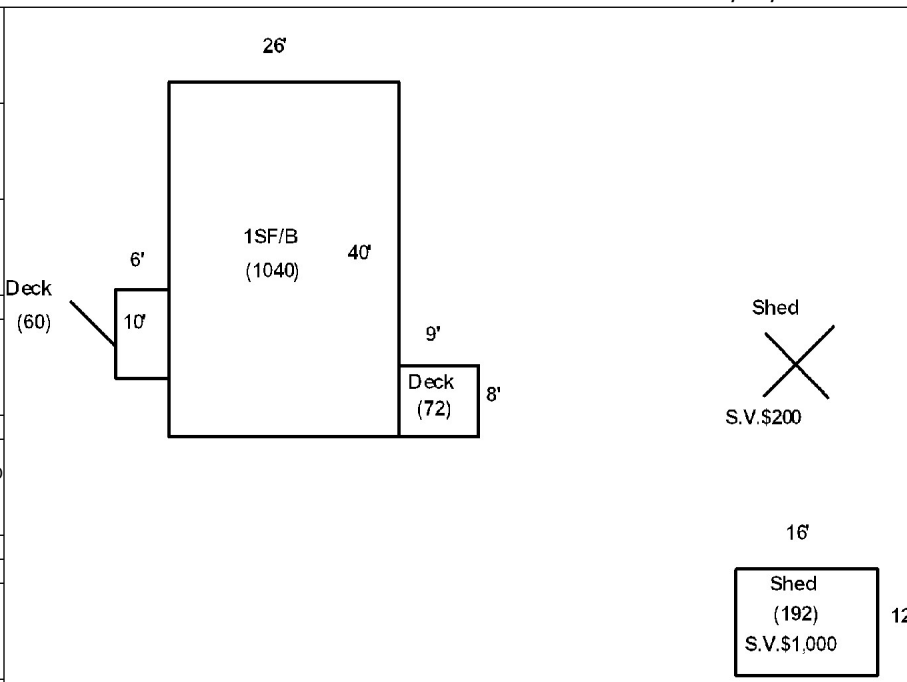

Date Inspected 8/29/2022

Additions, Outbuildings & Improvements

Type	Year	Units	Grade	Cond	Phys.	Funct.	Sound Value
68 Deck	2000	72	3 100	4	0 %	100 %	
68 Deck	2000	60	3 100	4	0 %	100 %	
24 Frame Shed	2000				%	%	1,000
24 Frame Shed	0				%	%	200
					%	%	
					%	%	
					%	%	
					%	%	
					%	%	
					%	%	
					%	%	

- 1.One Story Fram
- 2.Two Story Fram
- 3.Three Story Fr
- 4.1 & 1/2 Story
- 5.1 & 3/4 Story
- 6.2 & 1/2 Story
- 21.Open Porch
- 22.Enclosed Porch
- 23.Frame Garage
- 24.Frame Shed
- 25.1SF Bay Window
- 26.1SF Over Hang
- 27.Unfinished Bas
- 28.Unfinished Att
- 29.Finished Basem

Porter Farms LLC
601 Griffin Ridge Road
Mapleton ME 04757

B3776P290

Previous Owner
Irving & Marr Farms
221 Davis Rd

Woodland ME 04736
Sale Date: 4/01/2016

Inspection Witnessed By:

X	Date	Description	Date Insp.

Notes:

Wade

Property Data			Assessment Record																																																																																																																																																																																														
Neighborhood 1 Rural			Year	Land	Buildings	Exempt	Total																																																																																																																																																																																										
Tree Growth Year 0			2017	84,400	0	0	84,400																																																																																																																																																																																										
X Coordinate			2018	84,400	0	0	84,400																																																																																																																																																																																										
Y Coordinate			2020	84,400	0	0	84,400																																																																																																																																																																																										
Zone/Land Use 1 Residential			2021	92,000	0	0	92,000																																																																																																																																																																																										
Secondary Zone			2022	109,100	0	0	109,100																																																																																																																																																																																										
Topography 2 Rolling																																																																																																																																																																																																	
1.Level 4.Below Stre 7.Steep 2.Rolling 5.Low 8.Rough 3.Above Stre 6.Swampy 9.																																																																																																																																																																																																	
Utilities 9 NoWater/NoSewer																																																																																																																																																																																																	
1.Well+Septi 4.Public Wat 7.Cess Pool 2.Drilled We 5.Public Sew 8.Holding Ta 3.Septic Sys 6.Dug Well 9.NoW/NoSew																																																																																																																																																																																																	
Street 1 Paved																																																																																																																																																																																																	
1.Paved 4.Proposed 7. 2.Semi-Impro 5.Private 8. 3.Gravel 6. 9.No Street																																																																																																																																																																																																	
LAND USE 0			<table border="1"> <thead> <tr> <th rowspan="2">Front Foot</th> <th rowspan="2">Type</th> <th colspan="2">Effective</th> <th colspan="2">Influence</th> <th rowspan="2">Influence Codes</th> </tr> <tr> <th>Frontage</th> <th>Depth</th> <th>Factor</th> <th>Code</th> </tr> </thead> <tbody> <tr><td>11.Regular Lot</td><td></td><td></td><td></td><td>%</td><td></td><td>1.Vacancy</td></tr> <tr><td>12.Delta Triangle</td><td></td><td></td><td></td><td>%</td><td></td><td>2.Unimproved</td></tr> <tr><td>13.Nabla Triangle</td><td></td><td></td><td></td><td>%</td><td></td><td>3.Topography</td></tr> <tr><td>14.Rear Land</td><td></td><td></td><td></td><td>%</td><td></td><td>4.Size/Shape</td></tr> <tr><td>15.Class I Road</td><td></td><td></td><td></td><td>%</td><td></td><td>5.Access</td></tr> <tr><td></td><td></td><td></td><td></td><td>%</td><td></td><td>6.Restriction</td></tr> <tr><td></td><td></td><td></td><td></td><td>%</td><td></td><td>7.Corner/Locatio</td></tr> <tr><td></td><td></td><td></td><td></td><td>%</td><td></td><td>8.View/Environme</td></tr> <tr><td></td><td></td><td></td><td></td><td>%</td><td></td><td>9.Fractional Sha</td></tr> <tr><td></td><td></td><td></td><td></td><td>%</td><td></td><td>Acres</td></tr> <tr><td></td><td></td><td></td><td></td><td>%</td><td></td><td>32.Pasture</td></tr> <tr><td></td><td></td><td></td><td></td><td>%</td><td></td><td>33.Orchard</td></tr> <tr><td></td><td></td><td></td><td></td><td>%</td><td></td><td>34.Softwood (FL)</td></tr> <tr><td></td><td></td><td></td><td></td><td>%</td><td></td><td>35.Mixed Wood (FL)</td></tr> <tr><td></td><td></td><td></td><td></td><td>%</td><td></td><td>36.Hardwood (FL)</td></tr> <tr><td></td><td></td><td></td><td></td><td>%</td><td></td><td>37.Softwood (TG)</td></tr> <tr><td></td><td></td><td></td><td></td><td>%</td><td></td><td>38.Mixed Wood (TG)</td></tr> <tr><td></td><td></td><td></td><td></td><td>%</td><td></td><td>39.Hardwood (TG)</td></tr> <tr><td></td><td></td><td></td><td></td><td>%</td><td></td><td>40.Wasteland</td></tr> <tr><td></td><td></td><td></td><td></td><td>%</td><td></td><td>41.Open Space</td></tr> <tr><td></td><td></td><td></td><td></td><td>%</td><td></td><td>42.Mobile Home Si</td></tr> <tr><td></td><td></td><td></td><td></td><td>%</td><td></td><td>43.Condo Site</td></tr> <tr><td></td><td></td><td></td><td></td><td>%</td><td></td><td>44.Lot Improvemen</td></tr> <tr><td></td><td></td><td></td><td></td><td>%</td><td></td><td>45.Subdivision Lo</td></tr> <tr><td></td><td></td><td></td><td></td><td>%</td><td></td><td>46.Heavy Ind Sit</td></tr> </tbody> </table>					Front Foot	Type	Effective		Influence		Influence Codes	Frontage	Depth	Factor	Code	11.Regular Lot				%		1.Vacancy	12.Delta Triangle				%		2.Unimproved	13.Nabla Triangle				%		3.Topography	14.Rear Land				%		4.Size/Shape	15.Class I Road				%		5.Access					%		6.Restriction					%		7.Corner/Locatio					%		8.View/Environme					%		9.Fractional Sha					%		Acres					%		32.Pasture					%		33.Orchard					%		34.Softwood (FL)					%		35.Mixed Wood (FL)					%		36.Hardwood (FL)					%		37.Softwood (TG)					%		38.Mixed Wood (TG)					%		39.Hardwood (TG)					%		40.Wasteland					%		41.Open Space					%		42.Mobile Home Si					%		43.Condo Site					%		44.Lot Improvemen					%		45.Subdivision Lo					%		46.Heavy Ind Sit
Front Foot	Type	Effective								Influence		Influence Codes																																																																																																																																																																																					
		Frontage	Depth	Factor	Code																																																																																																																																																																																												
11.Regular Lot				%		1.Vacancy																																																																																																																																																																																											
12.Delta Triangle				%		2.Unimproved																																																																																																																																																																																											
13.Nabla Triangle				%		3.Topography																																																																																																																																																																																											
14.Rear Land				%		4.Size/Shape																																																																																																																																																																																											
15.Class I Road				%		5.Access																																																																																																																																																																																											
				%		6.Restriction																																																																																																																																																																																											
				%		7.Corner/Locatio																																																																																																																																																																																											
				%		8.View/Environme																																																																																																																																																																																											
				%		9.Fractional Sha																																																																																																																																																																																											
				%		Acres																																																																																																																																																																																											
				%		32.Pasture																																																																																																																																																																																											
				%		33.Orchard																																																																																																																																																																																											
				%		34.Softwood (FL)																																																																																																																																																																																											
				%		35.Mixed Wood (FL)																																																																																																																																																																																											
				%		36.Hardwood (FL)																																																																																																																																																																																											
				%		37.Softwood (TG)																																																																																																																																																																																											
				%		38.Mixed Wood (TG)																																																																																																																																																																																											
				%		39.Hardwood (TG)																																																																																																																																																																																											
				%		40.Wasteland																																																																																																																																																																																											
				%		41.Open Space																																																																																																																																																																																											
				%		42.Mobile Home Si																																																																																																																																																																																											
				%		43.Condo Site																																																																																																																																																																																											
				%		44.Lot Improvemen																																																																																																																																																																																											
				%		45.Subdivision Lo																																																																																																																																																																																											
				%		46.Heavy Ind Sit																																																																																																																																																																																											
Sale Date 4/01/2016			Land Data																																																																																																																																																																																														
Price			Front Foot		Square Feet																																																																																																																																																																																												
Sale Type 1 Land Only			11.Regular Lot		16.Class II Road																																																																																																																																																																																												
1.Land 4.Mobile 7.C/I L&B			12.Delta Triangle		17.Municipal Rese																																																																																																																																																																																												
2.L & B 5.Other 8.			13.Nabla Triangle		18.Munic Sep Lago																																																																																																																																																																																												
3.Building 6.C/I Land 9.			14.Rear Land		19.Gravel Pit																																																																																																																																																																																												
Financing 1 Conventional			15.Class I Road		20.Industrial Bas																																																																																																																																																																																												
1.Convent 4.Seller 7.			Square Foot		Acres/Sites																																																																																																																																																																																												
2.FHA/VA 5.Private 8.			21.Developed Pave		22.Undev Paved (F																																																																																																																																																																																												
3.Assumed 6.Cash 9.Unknown			22.Undev Paved (F		23.Developed Grav																																																																																																																																																																																												
Validity 1 Arms Length Sale			23.Developed Grav		Acres																																																																																																																																																																																												
1.Valid 4.Split 7.Renovate			24.Undev Gravel (26.Rear Land																																																																																																																																																																																												
2.Related 5.Partial 8.Other			26.Rear Land		27.Backlot																																																																																																																																																																																												
3.Distress 6.Exempt 9.			27.Backlot		29.Pavement																																																																																																																																																																																												
Verified 1 Buyer			29.Pavement		30.Utility R O W																																																																																																																																																																																												
1.Buyer 4.Agent 7.Family			30.Utility R O W		31.Tillable																																																																																																																																																																																												
2.Seller 5.Pub Rec 8.Other			31.Tillable		Total Acreage 143.00																																																																																																																																																																																												
3.Lender 6.MLS 9.																																																																																																																																																																																																	

Wade

Map Lot 003-002

Account 91

Location

Card 1 Of 1 1/09/2023

Building Style 0	SF Bsmt Living 0	Layout 0
1.CONVENTI 5.GARRISON 9.GAMBREL	Fin Bsmt Grade 0 0	1.TYPICAL 4. 7.
2.RANCH 6.SALT BOX 10.OTHER	DIRT FLOOR 0	2.INADEQUA 5. 8.
3.RAISED R 7.CONTEMP 11.SPLIT	Heat Type 100% 0	3.POOR 6. 9.
4.CAPE 8.LOG 12.NE	1.HWBB 5.FWA 9.NOT HEAT	Attic 0
Dwelling Units 0	2.HWCI 6.GRAWWA 10.	1.1/4 FINI 4.FULL FIN 7.
Other Units 0	3.HP 7.ELECTRIC 11.	2.1/2 FINI 5.FL / STA 8.
Stories 0	4.STEAM 8.FL/WALL 12.	3.3/4 FINI 6. 9.NONE
1.ONE STOR 4.1.5 STOR 7.1.25 STO	Cool Type 0% 9 NONE	Insulation 0
2.TWO STOR 5.1.75 STO 8.	1.REFRIG A 4.W&C AIR 7.	1.FULLY IN 4.MINIMAL 7.
3.THREE ST 6.2.5 STOR 9.	2.EVAPORAT 5. 8.	2.HEAVY 5.UNKNOWN 8.
Exterior Walls 0	3.HEAT PUM 6. 9.NONE	3.CAPPED O 6. 9.NONE
1.WOOD 5.STUCKO 9.T-111	Kitchen Style 0	Unfinished % 0%
2.VIN/AL 6.BRICK 10.OTHER	1.GOOD 4.OBSOLETE 7.	Grade & Factor 0 0%
3.COMPOS. 7.STONE 11.LOG	2.TYPICAL 5. 8.	1.E GRADE 4.B GRADE 7.
4.ASBESTOS 8.CONCRETE 12.	3.OLD STYL 6. 9.NONE	2.D GRADE 5.A GRADE 8.
Roof Surface 0	Bath(s) Style 0	3.C GRADE 6.AA GRADE 9.SAME
1.ASPHALT 4.COMPOSIT 7.	1.GOOD 4.OBSOLETE 7.	SQFT (Footprint) 0
2.SLATE 5.WOOD 8.	2.TYPICAL 5. 8.	Condition 0
3.METAL 6.OTHER 9.	3.OLD STYL 6. 9.NONE	1.POOR 4.AVERAGE 7.VERY GOO
SF Masonry Trim 0	# Rooms 0	2.FAIR 5.ABOVE AV 8.EXCELLEN
0	# Bedrooms 0	3.BELOW AV 6.GOOD 9.SAME
0	# Full Baths 0	Phys. % Good 0%
Year Built 0	# Half Baths 0	Funct. % Good 100%
Year Remodeled 0	# Addn Fixtures 0	Functional Code 9 None
Foundation 0	# Fireplaces 0	1.Incomp 4.LongTerm 7.Layout
1.CONCRETE 4.WOOD 7.		2.Overbuil 5.Utility 8.Other
2.CONCRETE 5.SLAB 8.		3.Delap 6.Style 9.None
3.BRICK/ST 6.PIERS 9.		Econ. % Good 100%
Basement 0		Economic Code NONE
1.1/4 BASE 4.FULL BAS 7.		0.None 3.NO ELECT 6.
2.1/2 BASE 5.CRAWL 8.		1.LOCATION 4.GENERATC 7.
3.3/4 BASE 6. 9.NO BASEM		2.ENCROACH 5. 8.OTHER
Bsmt Gar # Cars 0		Entrance Code 5 ESTIMATED
Wet Basement 0		1.INTERIOR 4.UNOCCUPI 7.
1.DRY BASE 4. 7.		2.REFUSED 5.ESTIMATE 8.
2.DAMP BAS 5. 8.		3.INFO ONL 6. 9.
3.WET BASE 6. 9.NO BASEM		Information Code 5 ESTIMATE
		1.OWNER 4.AGENT 7.
		2.RELATIVE 5.ESTIMATE 8.
		3.TENANT 6.OTHER 9.



Date Inspected 7/14/2022

Additions, Outbuildings & Improvements							
Type	Year	Units	Grade	Cond	Phys.	Funct.	Sound Value
					%	%	1.One Story Fram
					%	%	2.Two Story Fram
					%	%	3.Three Story Fr
					%	%	4.1 & 1/2 Story
					%	%	5.1 & 3/4 Story
					%	%	6.2 & 1/2 Story
					%	%	21.Open Porch
					%	%	22.Enclosed Porch
					%	%	23.Frame Garage
					%	%	24.Frame Shed
					%	%	25.1SF Bay Window
					%	%	26.1SF Over Hang
					%	%	27.Unfinished Bas
					%	%	28.Unfinished Att
					%	%	29.Finished Basem

Wade

Map Lot 003-002-1 & 005-2

Account 109

Location 287 South Wade Rd

Card 1 Of 1 1/09/2023

Building Style 0	SF Bsmt Living 0	Layout 0
1.CONVENTI 5.GARRISON 9.GAMBREL	Fin Bsmt Grade 0 0	1.TYPICAL 4. 7.
2.RANCH 6.SALT BOX 10.OTHER	DIRT FLOOR 0	2.INADEQUA 5. 8.
3.RAISED R 7.CONTEMP 11.SPLIT	Heat Type 100% 0	3.POOR 6. 9.
4.CAPE 8.LOG 12.NE	1.HWBB 5.FWA 9.NOT HEAT	Attic 0
Dwelling Units 0	2.HWCI 6.GRAVWA 10.	1.1/4 FINI 4.FULL FIN 7.
Other Units 0	3.HP 7.ELECTRIC 11.	2.1/2 FINI 5.FL / STA 8.
Stories 0	4.STEAM 8.FL/WALL 12.	3.3/4 FINI 6. 9.NONE
1.ONE STOR 4.1.5 STOR 7.1.25 STO	Cool Type 0% 9 NONE	Insulation 0
2.TWO STOR 5.1.75 STO 8.	1.REFRIG A 4.W&C AIR 7.	1.FULLY IN 4.MINIMAL 7.
3.THREE ST 6.2.5 STOR 9.	2.EVAPORAT 5. 8.	2.HEAVY 5.UNKNOWN 8.
Exterior Walls 0	3.HEAT PUM 6. 9.NONE	3.CAPPED O 6. 9.NONE
1.WOOD 5.STUCKO 9.T-111	Kitchen Style 0	Unfinished % 0%
2.VIN/AL 6.BRICK 10.OTHER	1.GOOD 4.OBSOLETE 7.	Grade & Factor 0 0%
3.COMPOS. 7.STONE 11.LOG	2.TYPICAL 5. 8.	1.E GRADE 4.B GRADE 7.
4.ASBESTOS 8.CONCRETE 12.	3.OLD STYL 6. 9.NONE	2.D GRADE 5.A GRADE 8.
Roof Surface 0	Bath(s) Style 0	3.C GRADE 6.AA GRADE 9.SAME
1.ASPHALT 4.COMPOSIT 7.	1.GOOD 4.OBSOLETE 7.	SQFT (Footprint) 0
2.SLATE 5.WOOD 8.	2.TYPICAL 5. 8.	Condition 0
3.METAL 6.OTHER 9.	3.OLD STYL 6. 9.NONE	1.POOR 4.AVERAGE 7.VERY GOO
SF Masonry Trim 0	# Rooms 0	2.FAIR 5.ABOVE AV 8.EXCELLEN
0	# Bedrooms 0	3.BELOW AV 6.GOOD 9.SAME
0	# Full Baths 0	Phys. % Good 0%
Year Built 0	# Half Baths 0	Funct. % Good 100%
Year Remodeled 0	# Addn Fixtures 0	Functional Code 9 None
Foundation 0	# Fireplaces 0	1.Incomp 4.LongTerm 7.Layout
1.CONCRETE 4.WOOD 7.		2.Overbuil 5.Utility 8.Other
2.CONCRETE 5.SLAB 8.		3.Delap 6.Style 9.None
3.BRICK/ST 6.PIERS 9.		Econ. % Good 100%
Basement 0		Economic Code NONE
1.1/4 BASE 4.FULL BAS 7.		0.None 3.NO ELECT 6.
2.1/2 BASE 5.CRAWL 8.		1.LOCATION 4.GENERATC 7.
3.3/4 BASE 6. 9.NO BASEM		2.ENCROACH 5. 8.OTHER
Bsmt Gar # Cars 0		Entrance Code 0
Wet Basement 0		1.INTERIOR 4.UNOCCUPI 7.
1.DRY BASE 4. 7.		2.REFUSED 5.ESTIMATE 8.
2.DAMP BAS 5. 8.		3.INFO ONL 6. 9.
3.WET BASE 6. 9.NO BASEM		Information Code 0
		1.OWNER 4.AGENT 7.
		2.RELATIVE 5.ESTIMATE 8.
		3.TENANT 6.OTHER 9.



Date Inspected

Additions, Outbuildings & Improvements								
Type	Year	Units	Grade	Cond	Phys.	Funct.	Sound Value	
					%	%		1.One Story Fram
					%	%		2.Two Story Fram
					%	%		3.Three Story Fr
					%	%		4.1 & 1/2 Story
					%	%		5.1 & 3/4 Story
					%	%		6.2 & 1/2 Story
					%	%		21.Open Porch
					%	%		22.Enclosed Porch
					%	%		23.Frame Garage
					%	%		24.Frame Shed
					%	%		25.1SF Bay Window
					%	%		26.1SF Over Hang
					%	%		27.Unfinished Bas
					%	%		28.Unfinished Att
					%	%		29.Finished Basem

Wade

Map Lot 003-003 & 004-2

Account 110

Location 228 South Wade Rd

Card 1 Of 1 1/09/2023

Building Style 0	SF Bsmt Living 0	Layout 0
1.CONVENTI 5.GARRISON 9.GAMBREL	Fin Bsmt Grade 0 0	1.TYPICAL 4. 7.
2.RANCH 6.SALT BOX 10.OTHER	DIRT FLOOR 0	2.INADEQUA 5. 8.
3.RAISED R 7.CONTEMP 11.SPLIT	Heat Type 100% 0	3.POOR 6. 9.
4.CAPE 8.LOG 12.NE	1.HWBB 5.FWA 9.NOT HEAT	Attic 0
Dwelling Units 0	2.HWCI 6.GRAVWA 10.	1.1/4 FINI 4.FULL FIN 7.
Other Units 0	3.HP 7.ELECTRIC 11.	2.1/2 FINI 5.FL / STA 8.
Stories 0	4.STEAM 8.FL/WALL 12.	3.3/4 FINI 6. 9.NONE
1.ONE STOR 4.1.5 STOR 7.1.25 STO	Cool Type 0% 9 NONE	Insulation 0
2.TWO STOR 5.1.75 STO 8.	1.REFRIG A 4.W&C AIR 7.	1.FULLY IN 4.MINIMAL 7.
3.THREE ST 6.2.5 STOR 9.	2.EVAPORAT 5. 8.	2.HEAVY 5.UNKNOWN 8.
Exterior Walls 0	3.HEAT PUM 6. 9.NONE	3.CAPPED O 6. 9.NONE
1.WOOD 5.STUCKO 9.T-111	Kitchen Style 0	Unfinished % 0%
2.VIN/AL 6.BRICK 10.OTHER	1.GOOD 4.OBSOLETE 7.	Grade & Factor 0 0%
3.COMPOS. 7.STONE 11.LOG	2.TYPICAL 5. 8.	1.E GRADE 4.B GRADE 7.
4.ASBESTOS 8.CONCRETE 12.	3.OLD STYL 6. 9.NONE	2.D GRADE 5.A GRADE 8.
Roof Surface 0	Bath(s) Style 0	3.C GRADE 6.AA GRADE 9.SAME
1.ASPHALT 4.COMPOSIT 7.	1.GOOD 4.OBSOLETE 7.	SQFT (Footprint) 0
2.SLATE 5.WOOD 8.	2.TYPICAL 5. 8.	Condition 0
3.METAL 6.OTHER 9.	3.OLD STYL 6. 9.NONE	1.POOR 4.AVERAGE 7.VERY GOO
SF Masonry Trim 0	# Rooms 0	2.FAIR 5.ABOVE AV 8.EXCELLEN
0	# Bedrooms 0	3.BELOW AV 6.GOOD 9.SAME
0	# Full Baths 0	Phys. % Good 0%
Year Built 0	# Half Baths 0	Funct. % Good 100%
Year Remodeled 0	# Addn Fixtures 0	Functional Code 9 None
Foundation 0	# Fireplaces 0	1.Incomp 4.LongTerm 7.Layout
1.CONCRETE 4.WOOD 7.		2.Overbuil 5.Utility 8.Other
2.CONCRETE 5.SLAB 8.		3.Delap 6.Style 9.None
3.BRICK/ST 6.PIERS 9.		Econ. % Good 100%
Basement 0		Economic Code NONE
1.1/4 BASE 4.FULL BAS 7.		0.None 3.NO ELECT 6.
2.1/2 BASE 5.CRAWL 8.		1.LOCATION 4.GENERATC 7.
3.3/4 BASE 6. 9.NO BASEM		2.ENCROACH 5. 8.OTHER
Bsmt Gar # Cars 0		Entrance Code 3 INFORMATION ONLY
Wet Basement 0		1.INTERIOR 4.UNOCCUPI 7.
1.DRY BASE 4. 7.		2.REFUSED 5.ESTIMATE 8.
2.DAMP BAS 5. 8.		3.INFO ONL 6. 9.
3.WET BASE 6. 9.NO BASEM		Information Code 4 AGENT
		1.OWNER 4.AGENT 7.
		2.RELATIVE 5.ESTIMATE 8.
		3.TENANT 6.OTHER 9.

Date Inspected 7/11/2022

Additions, Outbuildings & Improvements

Type	Year	Units	Grade	Cond	Phys.	Funct.	Sound Value
231	970				%	%	3,000
					%	%	
					%	%	
					%	%	
					%	%	
					%	%	
					%	%	
					%	%	
					%	%	
					%	%	

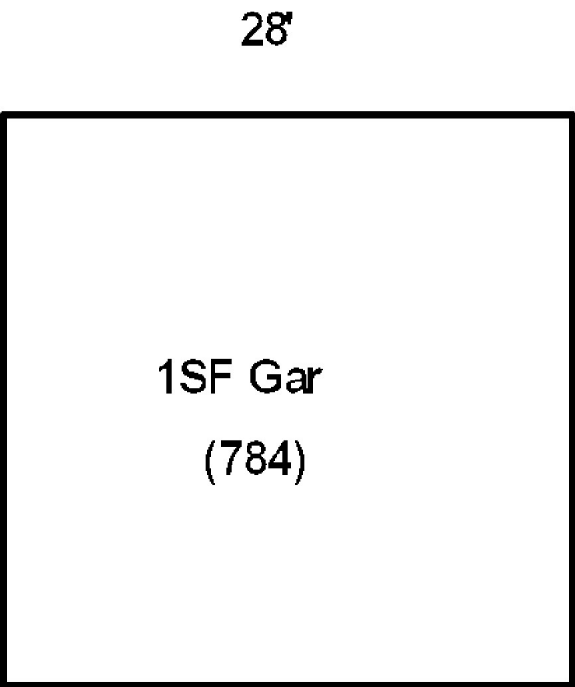

Hallowell, Larry
Hallowell, Wanita
131 Timoga Trail
St. Augustine FL 32084

B4049P48

Inspection Witnessed By:

No./Date	Description	Date Insp.
X		

Notes:

Wade

Property Data			Assessment Record																																																																																																																																																																																																					
Neighborhood 1 Rural			Year	Land	Buildings	Exempt	Total																																																																																																																																																																																																	
Tree Growth Year 0			2017	10,900	0	0	10,900																																																																																																																																																																																																	
X Coordinate			2018	10,900	0	0	10,900																																																																																																																																																																																																	
Y Coordinate			2020	10,900	0	0	10,900																																																																																																																																																																																																	
Zone/Land Use 1 Residential			2021	11,400	0	0	11,400																																																																																																																																																																																																	
Secondary Zone			2022	16,500	0	0	16,500																																																																																																																																																																																																	
Topography 2 Rolling																																																																																																																																																																																																								
1.Level 4.Below Stre 7.Steep 2.Rolling 5.Low 8.Rough 3.Above Stre 6.Swampy 9.																																																																																																																																																																																																								
Utilities 9 NoWater/NoSewer																																																																																																																																																																																																								
1.Well+Septi 4.Public Wat 7.Cess Pool 2.Drilled We 5.Public Sew 8.Holding Ta 3.Septic Sys 6.Dug Well 9.NoW/NoSew																																																																																																																																																																																																								
Street 1 Paved																																																																																																																																																																																																								
1.Paved 4.Proposed 7. 2.Semi-Impro 5.Private 8. 3.Gravel 6. 9.No Street																																																																																																																																																																																																								
LAND USE 0			<table border="1"> <thead> <tr> <th rowspan="2">Front Foot</th> <th rowspan="2">Type</th> <th colspan="2">Effective</th> <th colspan="2">Influence</th> <th rowspan="2">Influence Codes</th> </tr> <tr> <th>Frontage</th> <th>Depth</th> <th>Factor</th> <th>Code</th> </tr> </thead> <tbody> <tr><td>11.Regular Lot</td><td></td><td></td><td></td><td>%</td><td></td><td>1.Vacancy</td></tr> <tr><td>12.Delta Triangle</td><td></td><td></td><td></td><td>%</td><td></td><td>2.Unimproved</td></tr> <tr><td>13.Nabla Triangle</td><td></td><td></td><td></td><td>%</td><td></td><td>3.Topography</td></tr> <tr><td>14.Rear Land</td><td></td><td></td><td></td><td>%</td><td></td><td>4.Size/Shape</td></tr> <tr><td>15.Class I Road</td><td></td><td></td><td></td><td>%</td><td></td><td>5.Access</td></tr> <tr><td></td><td></td><td></td><td></td><td>%</td><td></td><td>6.Restriction</td></tr> <tr><td></td><td></td><td></td><td></td><td>%</td><td></td><td>7.Corner/Locatio</td></tr> <tr><td></td><td></td><td></td><td></td><td>%</td><td></td><td>8.View/Environme</td></tr> <tr><td></td><td></td><td></td><td></td><td>%</td><td></td><td>9.Fractional Sha</td></tr> <tr><td></td><td></td><td></td><td></td><td>%</td><td></td><td>Acres</td></tr> <tr><td></td><td></td><td></td><td></td><td>%</td><td></td><td>32.Pasture</td></tr> <tr><td></td><td></td><td></td><td></td><td>%</td><td></td><td>33.Orchard</td></tr> <tr><td></td><td></td><td></td><td></td><td>%</td><td></td><td>34.Softwood (FL)</td></tr> <tr><td></td><td></td><td></td><td></td><td>%</td><td></td><td>35.Mixed Wood (FL)</td></tr> <tr><td></td><td></td><td></td><td></td><td>%</td><td></td><td>36.Hardwood (FL)</td></tr> <tr><td></td><td></td><td></td><td></td><td>%</td><td></td><td>37.Softwood (TG)</td></tr> <tr><td></td><td></td><td></td><td></td><td>%</td><td></td><td>38.Mixed Wood (TG)</td></tr> <tr><td></td><td></td><td></td><td></td><td>%</td><td></td><td>39.Hardwood (TG)</td></tr> <tr><td></td><td></td><td></td><td></td><td>%</td><td></td><td>40.Wasteland</td></tr> <tr><td></td><td></td><td></td><td></td><td>%</td><td></td><td>41.Open Space</td></tr> <tr><td></td><td></td><td></td><td></td><td>%</td><td></td><td>42.Mobile Home Si</td></tr> <tr><td></td><td></td><td></td><td></td><td>%</td><td></td><td>43.Condo Site</td></tr> <tr><td></td><td></td><td></td><td></td><td>%</td><td></td><td>44.Lot Improvemen</td></tr> <tr><td></td><td></td><td></td><td></td><td>%</td><td></td><td>45.Subdivision Lo</td></tr> <tr><td></td><td></td><td></td><td></td><td>%</td><td></td><td>46.Heavy Ind Sit</td></tr> <tr> <td colspan="2">Total Acreage</td> <td>12.00</td> <td colspan="4"></td> </tr> </tbody> </table>					Front Foot	Type	Effective		Influence		Influence Codes	Frontage	Depth	Factor	Code	11.Regular Lot				%		1.Vacancy	12.Delta Triangle				%		2.Unimproved	13.Nabla Triangle				%		3.Topography	14.Rear Land				%		4.Size/Shape	15.Class I Road				%		5.Access					%		6.Restriction					%		7.Corner/Locatio					%		8.View/Environme					%		9.Fractional Sha					%		Acres					%		32.Pasture					%		33.Orchard					%		34.Softwood (FL)					%		35.Mixed Wood (FL)					%		36.Hardwood (FL)					%		37.Softwood (TG)					%		38.Mixed Wood (TG)					%		39.Hardwood (TG)					%		40.Wasteland					%		41.Open Space					%		42.Mobile Home Si					%		43.Condo Site					%		44.Lot Improvemen					%		45.Subdivision Lo					%		46.Heavy Ind Sit	Total Acreage		12.00				
Front Foot	Type	Effective								Influence		Influence Codes																																																																																																																																																																																												
		Frontage	Depth	Factor	Code																																																																																																																																																																																																			
11.Regular Lot				%		1.Vacancy																																																																																																																																																																																																		
12.Delta Triangle				%		2.Unimproved																																																																																																																																																																																																		
13.Nabla Triangle				%		3.Topography																																																																																																																																																																																																		
14.Rear Land				%		4.Size/Shape																																																																																																																																																																																																		
15.Class I Road				%		5.Access																																																																																																																																																																																																		
				%		6.Restriction																																																																																																																																																																																																		
				%		7.Corner/Locatio																																																																																																																																																																																																		
				%		8.View/Environme																																																																																																																																																																																																		
				%		9.Fractional Sha																																																																																																																																																																																																		
				%		Acres																																																																																																																																																																																																		
				%		32.Pasture																																																																																																																																																																																																		
				%		33.Orchard																																																																																																																																																																																																		
				%		34.Softwood (FL)																																																																																																																																																																																																		
				%		35.Mixed Wood (FL)																																																																																																																																																																																																		
				%		36.Hardwood (FL)																																																																																																																																																																																																		
				%		37.Softwood (TG)																																																																																																																																																																																																		
				%		38.Mixed Wood (TG)																																																																																																																																																																																																		
				%		39.Hardwood (TG)																																																																																																																																																																																																		
				%		40.Wasteland																																																																																																																																																																																																		
				%		41.Open Space																																																																																																																																																																																																		
				%		42.Mobile Home Si																																																																																																																																																																																																		
				%		43.Condo Site																																																																																																																																																																																																		
				%		44.Lot Improvemen																																																																																																																																																																																																		
				%		45.Subdivision Lo																																																																																																																																																																																																		
				%		46.Heavy Ind Sit																																																																																																																																																																																																		
Total Acreage		12.00																																																																																																																																																																																																						
Sale Date			<table border="1"> <thead> <tr> <th rowspan="2">Square Foot</th> <th colspan="2">Square Feet</th> <th colspan="2"></th> <th rowspan="2"></th> </tr> <tr> <th></th> <th></th> <th></th> <th></th> </tr> </thead> <tbody> <tr><td>16.Class II Road</td><td></td><td></td><td></td><td></td><td></td></tr> <tr><td>17.Municipal Rese</td><td></td><td></td><td></td><td></td><td></td></tr> <tr><td>18.Munic Sep Lago</td><td></td><td></td><td></td><td></td><td></td></tr> <tr><td>19.Gravel Pit</td><td></td><td></td><td></td><td></td><td></td></tr> <tr><td>20.Industrial Bas</td><td></td><td></td><td></td><td></td><td></td></tr> <tr> <td>Fract. Acre</td> <td colspan="2">Acreage/Sites</td> <td colspan="2"></td> <td></td> </tr> <tr><td>21.Developed Pave</td><td>22</td><td>1.00</td><td>100</td><td>%</td><td>0</td></tr> <tr><td>22.Undev Paved (F</td><td>26</td><td>8.00</td><td>100</td><td>%</td><td>0</td></tr> <tr><td>23.Developed Grav</td><td>32</td><td>3.00</td><td>100</td><td>%</td><td>0</td></tr> <tr><td>Acres</td><td></td><td></td><td></td><td></td><td></td></tr> <tr><td>24.Undev Gravel (</td><td></td><td></td><td></td><td></td><td></td></tr> <tr><td>26.Rear Land</td><td></td><td></td><td></td><td></td><td></td></tr> <tr><td>27.Backlot</td><td></td><td></td><td></td><td></td><td></td></tr> <tr><td>29.Pavement</td><td></td><td></td><td></td><td></td><td></td></tr> <tr><td>30.Utility R O W</td><td></td><td></td><td></td><td></td><td></td></tr> <tr><td>31.Tillable</td><td></td><td></td><td></td><td></td><td></td></tr> </tbody> </table>					Square Foot	Square Feet									16.Class II Road						17.Municipal Rese						18.Munic Sep Lago						19.Gravel Pit						20.Industrial Bas						Fract. Acre	Acreage/Sites					21.Developed Pave	22	1.00	100	%	0	22.Undev Paved (F	26	8.00	100	%	0	23.Developed Grav	32	3.00	100	%	0	Acres						24.Undev Gravel (26.Rear Land						27.Backlot						29.Pavement						30.Utility R O W						31.Tillable																																																																																												
Square Foot	Square Feet																																																																																																																																																																																																							
16.Class II Road																																																																																																																																																																																																								
17.Municipal Rese																																																																																																																																																																																																								
18.Munic Sep Lago																																																																																																																																																																																																								
19.Gravel Pit																																																																																																																																																																																																								
20.Industrial Bas																																																																																																																																																																																																								
Fract. Acre	Acreage/Sites																																																																																																																																																																																																							
21.Developed Pave	22	1.00	100	%	0																																																																																																																																																																																																			
22.Undev Paved (F	26	8.00	100	%	0																																																																																																																																																																																																			
23.Developed Grav	32	3.00	100	%	0																																																																																																																																																																																																			
Acres																																																																																																																																																																																																								
24.Undev Gravel (
26.Rear Land																																																																																																																																																																																																								
27.Backlot																																																																																																																																																																																																								
29.Pavement																																																																																																																																																																																																								
30.Utility R O W																																																																																																																																																																																																								
31.Tillable																																																																																																																																																																																																								
Building Use 0																																																																																																																																																																																																								
Sale Date																																																																																																																																																																																																								
Price																																																																																																																																																																																																								
Sale Type																																																																																																																																																																																																								
1.Land 4.Mobile 7.C/I L&B 2.L & B 5.Other 8. 3.Building 6.C/I Land 9.																																																																																																																																																																																																								
Financing																																																																																																																																																																																																								
1.Convent 4.Seller 7. 2.FHA/VA 5.Private 8. 3.Assumed 6.Cash 9.Unknown																																																																																																																																																																																																								
Validity																																																																																																																																																																																																								
1.Valid 4.Split 7.Renovate 2.Related 5.Partial 8.Other 3.Distress 6.Exempt 9.																																																																																																																																																																																																								
Verified																																																																																																																																																																																																								
1.Buyer 4.Agent 7.Family 2.Seller 5.Pub Rec 8.Other 3.Lender 6.MLS 9.																																																																																																																																																																																																								

Wade

Map Lot 003-004-1

Account 118

Location South Wade Rd

Card 1 Of 1 1/09/2023

Building Style 0	SF Bsmt Living 0	Layout 0
1.CONVENTI 5.GARRISON 9.GAMBREL	Fin Bsmt Grade 0 0	1.TYPICAL 4. 7.
2.RANCH 6.SALT BOX 10.OTHER	DIRT FLOOR 0	2.INADEQUA 5. 8.
3.RAISED R 7.CONTEMP 11.SPLIT	Heat Type 100% 0	3.POOR 6. 9.
4.CAPE 8.LOG 12.NE	1.HWBB 5.FWA 9.NOT HEAT	Attic 0
Dwelling Units 0	2.HWCI 6.GRAVWA 10.	1.1/4 FINI 4.FULL FIN 7.
Other Units 0	3.HP 7.ELECTRIC 11.	2.1/2 FINI 5.FL / STA 8.
Stories 0	4.STEAM 8.FL/WALL 12.	3.3/4 FINI 6. 9.NONE
1.ONE STOR 4.1.5 STOR 7.1.25 STO	Cool Type 0% 9 NONE	Insulation 0
2.TWO STOR 5.1.75 STO 8.	1.REFRIG A 4.W&C AIR 7.	1.FULLY IN 4.MINIMAL 7.
3.THREE ST 6.2.5 STOR 9.	2.EVAPORAT 5. 8.	2.HEAVY 5.UNKNOWN 8.
Exterior Walls 0	3.HEAT PUM 6. 9.NONE	3.CAPPED O 6. 9.NONE
1.WOOD 5.STUCKO 9.T-111	Kitchen Style 0	Unfinished % 0%
2.VIN/AL 6.BRICK 10.OTHER	1.GOOD 4.OBSOLETE 7.	Grade & Factor 0 0%
3.COMPOS. 7.STONE 11.LOG	2.TYPICAL 5. 8.	1.E GRADE 4.B GRADE 7.
4.ASBESTOS 8.CONCRETE 12.	3.OLD STYL 6. 9.NONE	2.D GRADE 5.A GRADE 8.
Roof Surface 0	Bath(s) Style 0	3.C GRADE 6.AA GRADE 9.SAME
1.ASPHALT 4.COMPOSIT 7.	1.GOOD 4.OBSOLETE 7.	SQFT (Footprint) 0
2.SLATE 5.WOOD 8.	2.TYPICAL 5. 8.	Condition 0
3.METAL 6.OTHER 9.	3.OLD STYL 6. 9.NONE	1.POOR 4.AVERAGE 7.VERY GOO
SF Masonry Trim 0	# Rooms 0	2.FAIR 5.ABOVE AV 8.EXCELLEN
0	# Bedrooms 0	3.BELOW AV 6.GOOD 9.SAME
0	# Full Baths 0	Phys. % Good 0%
Year Built 0	# Half Baths 0	Funct. % Good 100%
Year Remodeled 0	# Addn Fixtures 0	Functional Code 9 None
Foundation 0	# Fireplaces 0	1.Incomp 4.LongTerm 7.Layout
1.CONCRETE 4.WOOD 7.		2.Overbuil 5.Utility 8.Other
2.CONCRETE 5.SLAB 8.		3.Delap 6.Style 9.None
3.BRICK/ST 6.PIERS 9.		Econ. % Good 100%
Basement 0		Economic Code NONE
1.1/4 BASE 4.FULL BAS 7.		0.None 3.NO ELECT 6.
2.1/2 BASE 5.CRAWL 8.		1.LOCATION 4.GENERATC 7.
3.3/4 BASE 6. 9.NO BASEM		2.ENCROACH 5. 8.OTHER
Bsmt Gar # Cars 0		Entrance Code 5 ESTIMATED
Wet Basement 0		1.INTERIOR 4.UNOCCUPI 7.
1.DRY BASE 4. 7.		2.REFUSED 5.ESTIMATE 8.
2.DAMP BAS 5. 8.		3.INFO ONL 6. 9.
3.WET BASE 6. 9.NO BASEM		Information Code 5 ESTIMATE
		1.OWNER 4.AGENT 7.
		2.RELATIVE 5.ESTIMATE 8.
		3.TENANT 6.OTHER 9.



Date Inspected 7/14/2022

Additions, Outbuildings & Improvements								
Type	Year	Units	Grade	Cond	Phys.	Funct.	Sound Value	
					%	%		1.One Story Fram
					%	%		2.Two Story Fram
					%	%		3.Three Story Fr
					%	%		4.1 & 1/2 Story
					%	%		5.1 & 3/4 Story
					%	%		6.2 & 1/2 Story
					%	%		21.Open Porch
					%	%		22.Enclosed Porch
					%	%		23.Frame Garage
					%	%		24.Frame Shed
					%	%		25.1SF Bay Window
					%	%		26.1SF Over Hang
					%	%		27.Unfinished Bas
					%	%		28.Unfinished Att
					%	%		29.Finished Basem

Wade

Map Lot 003-005

Account 221

Location 287 South Wade Rd

Card 1

Of 1

1/09/2023

Building Style 1 CONVENTIONAL 1.CONVENTI 5.GARRISON 9.GAMBREL 2.RANCH 6.SALT BOX 10.OTHER 3.RAISED R 7.CONTEMP 11.SPLIT 4.CAPE 8.LOG 12.NE Dwelling Units 1 Other Units 0 Stories 4 ONE & 1/2 STORY 1.ONE STOR 4.1.5 STOR 7.1.25 STO 2.TWO STOR 5.1.75 STO 8. 3.THREE ST 6.2.5 STOR 9. Exterior Walls 2 VINYL/ALUMINUM 1.WOOD 5.STUCKO 9.T-111 2.VIN/AL 6.BRICK 10.OTHER 3.COMPOS. 7.STONE 11.LOG 4.ASBESTOS 8.CONCRETE 12. Roof Surface 3 METAL 1.ASPHALT 4.COMPOSIT 7. 2.SLATE 5.WOOD 8. 3.METAL 6.OTHER 9. SF Masonry Trim 0 Year Built 1940 Year Remodeled 0 Foundation 3 BRICK/STONE 1.CONCRETE 4.WOOD 7. 2.CONCRETE 5.SLAB 8. 3.BRICK/ST 6.PIERS 9. Basement 4 FULL BASEMENT 1.1/4 BASE 4.FULL BAS 7. 2.1/2 BASE 5.CRAWL 8. 3.3/4 BASE 6. 9.NO BASEM Bsmt Gar # Cars 0 Wet Basement 3 WET BASEMENT 1.DRY BASE 4. 7. 2.DAMP BAS 5. 8. 3.WET BASE 6. 9.NO BASEM	SF Bsmt Living 0 Fin Bsmt Grade 0 0 DIRT FLOOR 0 Heat Type 100% 5 FORCED WARM AIR 1.HWBB 5.FWA 9.NOT HEAT 2.HWCI 6.GRAWWA 10. 3.HP 7.ELECTRIC 11. 4.STEAM 8.FL/WALL 12. Cool Type 0% 9 NONE 1.REFRIG A 4.W&C AIR 7. 2.EVAPORAT 5. 8. 3.HEAT PUM 6. 9.NONE Kitchen Style 2 TYPICAL 1.GOOD 4.OBSOLETE 7. 2.TYPICAL 5. 8. 3.OLD STYL 6. 9.NONE Bath(s) Style 2 TYPICAL 1.GOOD 4.OBSOLETE 7. 2.TYPICAL 5. 8. 3.OLD STYL 6. 9.NONE # Rooms 8 # Bedrooms 4 # Full Baths 2 # Half Baths 0 # Addn Fixtures 0 # Fireplaces 0	Layout 1 TYPICAL 1.TYPICAL 4. 7. 2.INADEQUA 5. 8. 3.POOR 6. 9. Attic 9 NONE 1.1/4 FINI 4.FULL FIN 7. 2.1/2 FINI 5.FL / STA 8. 3.3/4 FINI 6. 9.NONE Insulation 1 FULLY INSULATED 1.FULLY IN 4.MINIMAL 7. 2.HEAVY 5.UNKNOWN 8. 3.CAPPED O 6. 9.NONE Unfinished % 0% Grade & Factor 3 AVERAGE QUALITY 1.E GRADE 4.B GRADE 7. 2.D GRADE 5.A GRADE 8. 3.C GRADE 6.AA GRADE 9.SAME SQFT (Footprint) 420 Condition 4 AVERAGE 1.POOR 4.AVERAGE 7.VERY GOO 2.FAIR 5.ABOVE AV 8.EXCELLEN 3.BELOW AV 6.GOOD 9.SAME Phys. % Good 0% Funct. % Good 100% Functional Code 9 None 1.Incomp 4.LongTerm 7.Layout 2.Overbuil 5.Utility 8.Other 3.Delap 6.Style 9.None Econ. % Good 100% Economic Code NONE 0.None 3.NO ELECT 6. 1.LOCATION 4.GENERATC 7. 2.ENCROACH 5. 8.OTHER Entrance Code 1 INTERIOR INSPECT 1.INTERIOR 4.UNOCCUPI 7. 2.REFUSED 5.ESTIMATE 8. 3.INFO ONL 6. 9. Information Code 1 OWNER 1.OWNER 4.AGENT 7. 2.RELATIVE 5.ESTIMATE 8. 3.TENANT 6.OTHER 9.
---	---	---



Date Inspected 7/11/2022

Additions, Outbuildings & Improvements

Type	Year	Units	Grade	Cond	Phys.	Funct.	Sound Value
1 One Story Frame	1960	300	9 100	9	0 %	100 %	
1 One Story Frame	1960	880	9 100	9	0 %	100 %	
21 Open Porch	1960	200	3 100	4	0 %	100 %	
23 Frame Garage	2003	960	3 100	4	0 %	100 %	
23 Frame Garage	1981	2100	3 100	4	0 %	85 %	
					%	%	
					%	%	
					%	%	
					%	%	
					%	%	
					%	%	
					%	%	
					%	%	

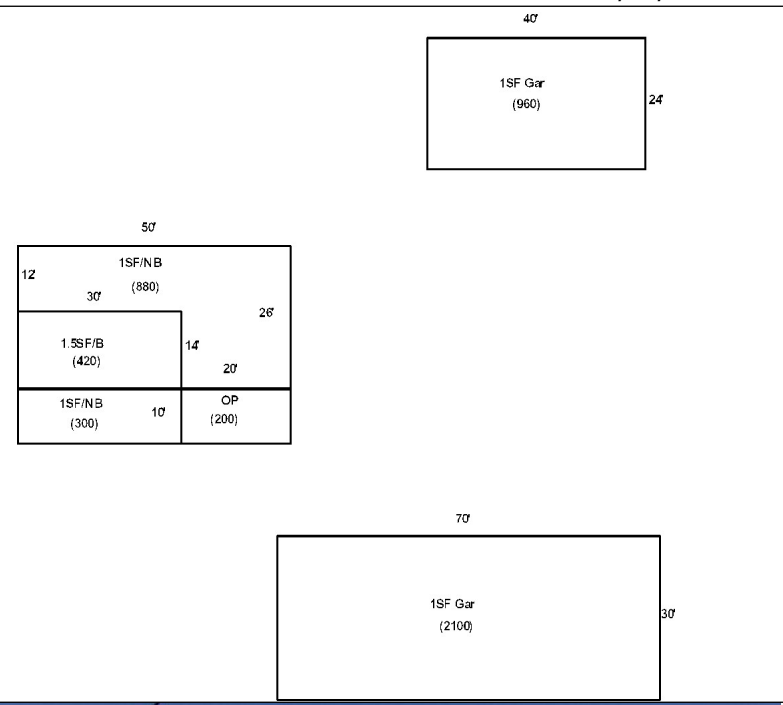

Klei, Hugh T
76 Turnpike Road
Willington CT 06279

B4894P218 B5748P239

Previous Owner
Klei Trust, Irene
Herbert E. Klei, Trustee
76 Turnpike Road
Willington CT 06279
Sale Date: 12/28/2017

Inspection Witnessed By:

X	Date	Description	Date Insp.

Notes:

Wade

Property Data			Assessment Record																																																																																																																																																																																														
Neighborhood 1 Rural			Year	Land	Buildings	Exempt	Total																																																																																																																																																																																										
Tree Growth Year 0			2017	24,300	71,900	0	96,200																																																																																																																																																																																										
X Coordinate			2018	24,100	71,900	0	96,000																																																																																																																																																																																										
Y Coordinate			2020	23,200	71,900	0	95,100																																																																																																																																																																																										
Zone/Land Use 1 Residential			2021	23,300	71,900	0	95,200																																																																																																																																																																																										
Secondary Zone			2022	36,100	74,200	0	110,300																																																																																																																																																																																										
Topography 2 Rolling																																																																																																																																																																																																	
1.Level 4.Below Stre 7.Steep 2.Rolling 5.Low 8.Rough 3.Above Stre 6.Swampy 9.																																																																																																																																																																																																	
Utilities 1 Drilled Well / Septic																																																																																																																																																																																																	
1.Well+Septi 4.Public Wat 7.Cess Pool 2.Drilled We 5.Public Sew 8.Holding Ta 3.Septic Sys 6.Dug Well 9.NoW/NoSew																																																																																																																																																																																																	
Street 1 Paved																																																																																																																																																																																																	
1.Paved 4.Proposed 7. 2.Semi-Impro 5.Private 8. 3.Gravel 6. 9.No Street																																																																																																																																																																																																	
LAND USE 0			<table border="1"> <thead> <tr> <th rowspan="2">Front Foot</th> <th rowspan="2">Type</th> <th colspan="2">Effective</th> <th colspan="2">Influence</th> <th rowspan="2">Influence Codes</th> </tr> <tr> <th>Frontage</th> <th>Depth</th> <th>Factor</th> <th>Code</th> </tr> </thead> <tbody> <tr> <td>11.Regular Lot</td> <td></td> <td></td> <td></td> <td>%</td> <td></td> <td>1.Vacancy</td> </tr> <tr> <td>12.Delta Triangle</td> <td></td> <td></td> <td></td> <td>%</td> <td></td> <td>2.Unimproved</td> </tr> <tr> <td>13.Nabla Triangle</td> <td></td> <td></td> <td></td> <td>%</td> <td></td> <td>3.Topography</td> </tr> <tr> <td>14.Rear Land</td> <td></td> <td></td> <td></td> <td>%</td> <td></td> <td>4.Size/Shape</td> </tr> <tr> <td>15.Class I Road</td> <td></td> <td></td> <td></td> <td>%</td> <td></td> <td>5.Access</td> </tr> <tr> <td></td> <td></td> <td></td> <td></td> <td>%</td> <td></td> <td>6.Restriction</td> </tr> <tr> <td></td> <td></td> <td></td> <td></td> <td>%</td> <td></td> <td>7.Corner/Locatio</td> </tr> <tr> <td></td> <td></td> <td></td> <td></td> <td>%</td> <td></td> <td>8.View/Environme</td> </tr> <tr> <td></td> <td></td> <td></td> <td></td> <td>%</td> <td></td> <td>9.Fractional Sha</td> </tr> <tr> <td></td> <td></td> <td></td> <td></td> <td>%</td> <td></td> <td>Acres</td> </tr> <tr> <td></td> <td></td> <td></td> <td></td> <td>%</td> <td></td> <td>32.Pasture</td> </tr> <tr> <td></td> <td></td> <td></td> <td></td> <td>%</td> <td></td> <td>33.Orchard</td> </tr> <tr> <td></td> <td></td> <td></td> <td></td> <td>%</td> <td></td> <td>34.Softwood (FL)</td> </tr> <tr> <td></td> <td></td> <td></td> <td></td> <td>%</td> <td></td> <td>35.Mixed Wood (FL)</td> </tr> <tr> <td></td> <td></td> <td></td> <td></td> <td>%</td> <td></td> <td>36.Hardwood (FL)</td> </tr> <tr> <td></td> <td></td> <td></td> <td></td> <td>%</td> <td></td> <td>37.Softwood (TG)</td> </tr> <tr> <td></td> <td></td> <td></td> <td></td> <td>%</td> <td></td> <td>38.Mixed Wood (TG)</td> </tr> <tr> <td></td> <td></td> <td></td> <td></td> <td>%</td> <td></td> <td>39.Hardwood (TG)</td> </tr> <tr> <td></td> <td></td> <td></td> <td></td> <td>%</td> <td></td> <td>40.Wasteland</td> </tr> <tr> <td></td> <td></td> <td></td> <td></td> <td>%</td> <td></td> <td>41.Open Space</td> </tr> <tr> <td></td> <td></td> <td></td> <td></td> <td>%</td> <td></td> <td>42.Mobile Home Si</td> </tr> <tr> <td></td> <td></td> <td></td> <td></td> <td>%</td> <td></td> <td>43.Condo Site</td> </tr> <tr> <td></td> <td></td> <td></td> <td></td> <td>%</td> <td></td> <td>44.Lot Improvemen</td> </tr> <tr> <td></td> <td></td> <td></td> <td></td> <td>%</td> <td></td> <td>45.Subdivision Lo</td> </tr> <tr> <td></td> <td></td> <td></td> <td></td> <td>%</td> <td></td> <td>46.Heavy Ind Sit</td> </tr> </tbody> </table>					Front Foot	Type	Effective		Influence		Influence Codes	Frontage	Depth	Factor	Code	11.Regular Lot				%		1.Vacancy	12.Delta Triangle				%		2.Unimproved	13.Nabla Triangle				%		3.Topography	14.Rear Land				%		4.Size/Shape	15.Class I Road				%		5.Access					%		6.Restriction					%		7.Corner/Locatio					%		8.View/Environme					%		9.Fractional Sha					%		Acres					%		32.Pasture					%		33.Orchard					%		34.Softwood (FL)					%		35.Mixed Wood (FL)					%		36.Hardwood (FL)					%		37.Softwood (TG)					%		38.Mixed Wood (TG)					%		39.Hardwood (TG)					%		40.Wasteland					%		41.Open Space					%		42.Mobile Home Si					%		43.Condo Site					%		44.Lot Improvemen					%		45.Subdivision Lo					%		46.Heavy Ind Sit
Front Foot	Type	Effective								Influence		Influence Codes																																																																																																																																																																																					
		Frontage	Depth	Factor	Code																																																																																																																																																																																												
11.Regular Lot				%		1.Vacancy																																																																																																																																																																																											
12.Delta Triangle				%		2.Unimproved																																																																																																																																																																																											
13.Nabla Triangle				%		3.Topography																																																																																																																																																																																											
14.Rear Land				%		4.Size/Shape																																																																																																																																																																																											
15.Class I Road				%		5.Access																																																																																																																																																																																											
				%		6.Restriction																																																																																																																																																																																											
				%		7.Corner/Locatio																																																																																																																																																																																											
				%		8.View/Environme																																																																																																																																																																																											
				%		9.Fractional Sha																																																																																																																																																																																											
				%		Acres																																																																																																																																																																																											
				%		32.Pasture																																																																																																																																																																																											
				%		33.Orchard																																																																																																																																																																																											
				%		34.Softwood (FL)																																																																																																																																																																																											
				%		35.Mixed Wood (FL)																																																																																																																																																																																											
				%		36.Hardwood (FL)																																																																																																																																																																																											
				%		37.Softwood (TG)																																																																																																																																																																																											
				%		38.Mixed Wood (TG)																																																																																																																																																																																											
				%		39.Hardwood (TG)																																																																																																																																																																																											
				%		40.Wasteland																																																																																																																																																																																											
				%		41.Open Space																																																																																																																																																																																											
				%		42.Mobile Home Si																																																																																																																																																																																											
				%		43.Condo Site																																																																																																																																																																																											
				%		44.Lot Improvemen																																																																																																																																																																																											
				%		45.Subdivision Lo																																																																																																																																																																																											
				%		46.Heavy Ind Sit																																																																																																																																																																																											
Sale Date 12/28/2017			Land Data																																																																																																																																																																																														
Price			Square Foot		Square Feet																																																																																																																																																																																												
Sale Type 1 Land Only			29	3,159	75	%	2																																																																																																																																																																																										
1.Land 4.Mobile 7.C/I L&B 2.L & B 5.Other 8. 3.Building 6.C/I Land 9.																																																																																																																																																																																																	
Financing 9 Unknown																																																																																																																																																																																																	
1.Convent 4.Seller 7. 2.FHA/VA 5.Private 8. 3.Assumed 6.Cash 9.Unknown																																																																																																																																																																																																	
Validity 2 Related Parties			Fract. Acre		Acres/Sites																																																																																																																																																																																												
1.Valid 4.Split 7.Renovate 2.Related 5.Partial 8.Other 3.Distress 6.Exempt 9.			21	1.00	100	%	0																																																																																																																																																																																										
Verified 7 Family Member			26	1.30	100	%	0																																																																																																																																																																																										
1.Buyer 4.Agent 7.Family 2.Seller 5.Pub Rec 8.Other 3.Lender 6.MLS 9.			40	2.30	100	%	0																																																																																																																																																																																										
			38	44.50	100	%	0																																																																																																																																																																																										
			39	4.10	100	%	0																																																																																																																																																																																										
			37	7.50	100	%	0																																																																																																																																																																																										
			Total Acreage		60.70																																																																																																																																																																																												

Wade

Map Lot 003-006,007,08,12

Account 101

Location 369 South Wade Rd

Card 1 Of 1 1/09/2023

Building Style 1 CONVENTIONAL	SF Bsmt Living 0	Layout 1 TYPICAL
1.CONVENTI 5.GARRISON 9.GAMBREL	Fin Bsmt Grade 0 0	1.TYPICAL 4. 7.
2.RANCH 6.SALT BOX 10.OTHER	DIRT FLOOR 0	2.INADEQUA 5. 8.
3.RAISED R 7.CONTEMP 11.SPLIT	Heat Type 100% 5 FORCED WARM AIR	3.POOR 6. 9.
4.CAPE 8.LOG 12.NE	1.HWBB 5.FWA 9.NOT HEAT	Attic 9 NONE
Dwelling Units 1	2.HWCI 6.GRAVWA 10.	1.1/4 FINI 4.FULL FIN 7.
Other Units 0	3.HP 7.ELECTRIC 11.	2.1/2 FINI 5.FL / STA 8.
Stories 4 ONE & 1/2 STORY	4.STEAM 8.FL/WALL 12.	3.3/4 FINI 6. 9.NONE
1.ONE STOR 4.1.5 STOR 7.1.25 STO	Cool Type 0% 9 NONE	Insulation 1 FULLY INSULATED
2.TWO STOR 5.1.75 STO 8.	1.REFRIG A 4.W&C AIR 7.	1.FULLY IN 4.MINIMAL 7.
3.THREE ST 6.2.5 STOR 9.	2.EVAPORAT 5. 8.	2.HEAVY 5.UNKNOWN 8.
Exterior Walls 6 BRICK	3.HEAT PUM 6. 9.NONE	3.CAPPED O 6. 9.NONE
1.WOOD 5.STUCKO 9.T-111	Kitchen Style 2 TYPICAL	Unfinished % 0%
2.VIN/AL 6.BRICK 10.OTHER	1.GOOD 4.OBSOLETE 7.	Grade & Factor 3 AVERAGE QUALITY
3.COMPOS. 7.STONE 11.LOG	2.TYPICAL 5. 8.	1.E GRADE 4.B GRADE 7.
4.ASBESTOS 8.CONCRETE 12.	3.OLD STYL 6. 9.NONE	2.D GRADE 5.A GRADE 8.
Roof Surface 3 METAL	Bath(s) Style 2 TYPICAL	3.C GRADE 6.AA GRADE 9.SAME
1.ASPHALT 4.COMPOSIT 7.	1.GOOD 4.OBSOLETE 7.	SQFT (Footprint) 656
2.SLATE 5.WOOD 8.	2.TYPICAL 5. 8.	Condition 7 VERY GOOD
3.METAL 6.OTHER 9.	3.OLD STYL 6. 9.NONE	1.POOR 4.AVERAGE 7.VERY GOO
SF Masonry Trim 0	# Rooms 5	2.FAIR 5.ABOVE AV 8.EXCELLEN
0	# Bedrooms 2	3.BELOW AV 6.GOOD 9.SAME
0	# Full Baths 1	Phys. % Good 0%
Year Built 1970	# Half Baths 0	Funct. % Good 100%
Year Remodeled 0	# Addn Fixtures 0	Functional Code 9 None
Foundation 1 CONCRETE	# Fireplaces 0	1.Incomp 4.LongTerm 7.Layout
1.CONCRETE 4.WOOD 7.		2.Overbuil 5.Utility 8.Other
2.CONCRETE 5.SLAB 8.		3.Delap 6.Style 9.None
3.BRICK/ST 6.PIERS 9.		Econ. % Good 100%
Basement 5 CRAWL		Economic Code NONE
1.1/4 BASE 4.FULL BAS 7.		0.None 3.NO ELECT 6.
2.1/2 BASE 5.CRAWL 8.		1.LOCATION 4.GENERATC 7.
3.3/4 BASE 6. 9.NO BASEM		2.ENCROACH 5. 8.OTHER
Bsmt Gar # Cars 0		Entrance Code 5 ESTIMATED
Wet Basement 1 DRY BASEMENT		1.INTERIOR 4.UNOCCUPI 7.
1.DRY BASE 4. 7.		2.REFUSED 5.ESTIMATE 8.
2.DAMP BAS 5. 8.	3.INFO ONL 6. 9.	
3.WET BASE 6. 9.NO BASEM	Information Code 5 ESTIMATE	
		1.OWNER 4.AGENT 7.
		2.RELATIVE 5.ESTIMATE 8.
		3.TENANT 6.OTHER 9.

Date Inspected 7/11/2022

Additions, Outbuildings & Improvements

Type	Year	Units	Grade	Cond	Phys.	Funct.	Sound Value
68 Deck	1990	96	2 100	3	0 %	100 %	
61 Canopy / Carport	1990	288	2 100	3	0 %	100 %	
23 Frame Garage	1990	280	2 100	3	0 %	100 %	
61 Canopy / Carport	1990	80	2 100	3	0 %	100 %	
					%	%	
					%	%	
					%	%	
					%	%	
					%	%	
					%	%	
					%	%	

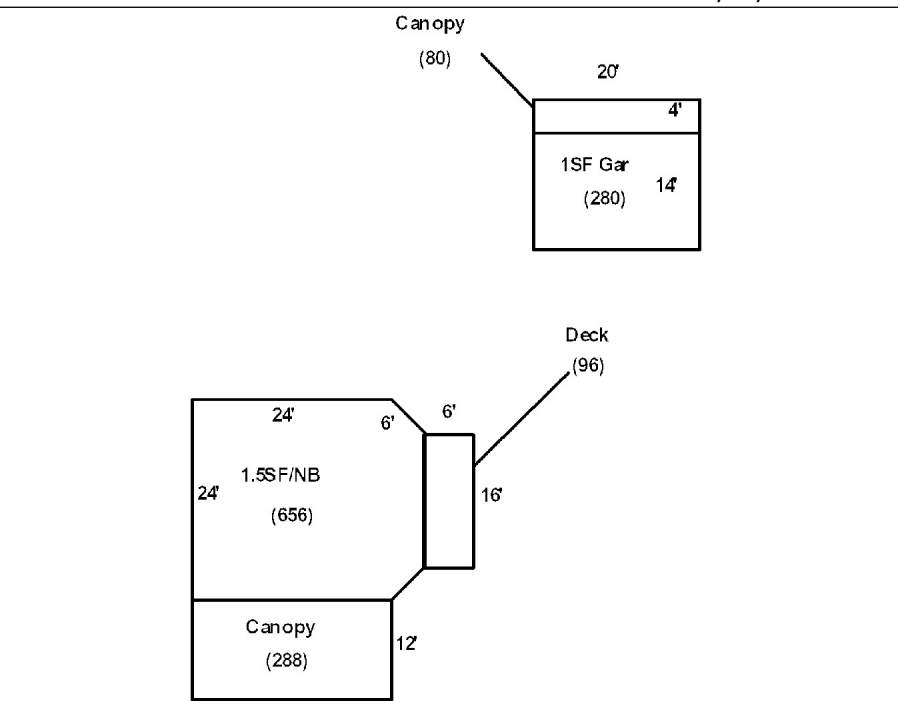

Klei, Herbert E
76 Turnpike Rd
Willington CT 06279

B2166P37

Previous Owner
Klei, Jr., Herbert E.
& Irene Klei Trust
76 Turnpike Road
Willington CT 06279
Sale Date: 2/12/2018

Inspection Witnessed By:

No./Date	Description	Date Insp.
X		

Notes:

Wade

Property Data			Assessment Record						
Neighborhood 1 Rural			Year	Land	Buildings	Exempt	Total		
Tree Growth Year 0			2017	22,900	28,500	0	51,400		
X Coordinate			2018	22,700	28,500	0	51,200		
Y Coordinate			2020	20,800	28,500	0	49,300		
Zone/Land Use 1 Residential			2021	20,800	28,500	0	49,300		
Secondary Zone			2022	29,300	36,800	0	66,100		
Topography 2 Rolling									
1.Level 4.Below Stre 7.Steep									
2.Rolling 5.Low 8.Rough									
3.Above Stre 6.Swampy 9.									
Utilities 1 Drilled Well / Septic									
1.Well+Septi 4.Public Wat 7.Cess Pool									
2.Drilled We 5.Public Sew 8.Holding Ta									
3.Septic Sys 6.Dug Well 9.NoW/NoSew									
Street 1 Paved									
1.Paved 4.Proposed 7.									
2.Semi-Impro 5.Private 8.									
3.Gravel 6. 9.No Street									
LAND USE 0									
Building Use 0									
Sale Data			Land Data						
Sale Date 2/12/2018			Front Foot	Type	Effective		Influence		Influence Codes
Price					Frontage	Depth	Factor	Code	
Sale Type 1 Land Only			11.Regular Lot					1.Vacancy	
1.Land 4.Mobile 7.C/I L&B			12.Delta Triangle					2.Unimproved	
2.L & B 5.Other 8.			13.Nabla Triangle					3.Topography	
3.Building 6.C/I Land 9.			14.Rear Land					4.Size/Shape	
Financing 9 Unknown			15.Class I Road					5.Access	
1.Convent 4.Seller 7.								6.Restriction	
2.FHA/VA 5.Private 8.								7.Corner/Locatio	
3.Assumed 6.Cash 9.Unknown								8.View/Environme	
Validity 2 Related Parties			Square Foot	Square Feet				9.Fractional Sha	
1.Valid 4.Split 7.Renovate			16.Class II Road					Acres	
2.Related 5.Partial 8.Other			17.Municipal Rese					32.Pasture	
3.Distress 6.Exempt 9.			18.Munic Sep Lago					33.Orchard	
Verified 7 Family Member			19.Gravel Pit					34.Softwood (FL)	
1.Buyer 4.Agent 7.Family			20.Industrial Bas					35.Mixed Wood (FL)	
2.Seller 5.Pub Rec 8.Other								36.Hardwood (FL)	
3.Lender 6.MLS 9.			Fract. Acre	Acres/Sites				37.Softwood (TG)	
			21.Developed Pave	21	1.00	100	% 0	38.Mixed Wood (TG)	
			22.Undev Paved (F	37	10.20	100	% 0	39.Hardwood (TG)	
			23.Developed Grav	38	41.10	100	% 0	40.Wasteland	
			Acres	39	5.70	100	% 0	41.Open Space	
			24.Undev Gravel (42.Mobile Home Si	
			26.Rear Land					43.Condo Site	
			27.Backlot					44.Lot Improvemen	
			29.Pavement					45.Subdivision Lo	
			30.Utility R O W					46.Heavy Ind Sit	
			31.Tillable						
			Total Acreage		58.00				

Wade

Map Lot 003-009 & 010

Account 112

Location South Wade Rd

Card 1 Of 1 1/09/2023

Building Style 8 LOG	SF Bsmt Living 0	Layout 1 TYPICAL
1.CONVENTI 5.GARRISON 9.GAMBREL	Fin Bsmt Grade 0 0	1.TYPICAL 4. 7.
2.RANCH 6.SALT BOX 10.OTHER	DIRT FLOOR 0	2.INADEQUA 5. 8.
3.RAISED R 7.CONTEMP 11.SPLIT	Heat Type 100% 9 NOT HEATED	3.POOR 6. 9.
4.CAPE 8.LOG 12.NE	1.HWBB 5.FWA 9.NOT HEAT	Attic 9 NONE
Dwelling Units 1	2.HWCI 6.GRAWWA 10.	1.1/4 FINI 4.FULL FIN 7.
Other Units 0	3.HP 7.ELECTRIC 11.	2.1/2 FINI 5.FL / STA 8.
Stories 4 ONE & 1/2 STORY	4.STEAM 8.FL/WALL 12.	3.3/4 FINI 6. 9.NONE
1.ONE STOR 4.1.5 STOR 7.1.25 STO	Cool Type 0% 9 NONE	Insulation 4 MINIMAL
2.TWO STOR 5.1.75 STO 8.	1.REFRIG A 4.W&C AIR 7.	1.FULLY IN 4.MINIMAL 7.
3.THREE ST 6.2.5 STOR 9.	2.EVAPORAT 5. 8.	2.HEAVY 5.UNKNOWN 8.
Exterior Walls 11 LOG	3.HEAT PUM 6. 9.NONE	3.CAPPED O 6. 9.NONE
1.WOOD 5.STUCKO 9.T-111	Kitchen Style 2 TYPICAL	Unfinished % 0%
2.VIN/AL 6.BRICK 10.OTHER	1.GOOD 4.OBSOLETE 7.	Grade & Factor 3 AVERAGE QUALITY
3.COMPOS. 7.STONE 11.LOG	2.TYPICAL 5. 8.	1.E GRADE 4.B GRADE 7.
4.ASBESTOS 8.CONCRETE 12.	3.OLD STYL 6. 9.NONE	2.D GRADE 5.A GRADE 8.
Roof Surface 3 METAL	Bath(s) Style 2 TYPICAL	3.C GRADE 6.AA GRADE 9.SAME
1.ASPHALT 4.COMPOSIT 7.	1.GOOD 4.OBSOLETE 7.	SQFT (Footprint) 624
2.SLATE 5.WOOD 8.	2.TYPICAL 5. 8.	Condition 4 AVERAGE
3.METAL 6.OTHER 9.	3.OLD STYL 6. 9.NONE	1.POOR 4.AVERAGE 7.VERY GOO
SF Masonry Trim 0	# Rooms 5	2.FAIR 5.ABOVE AV 8.EXCELLEN
0	# Bedrooms 2	3.BELOW AV 6.GOOD 9.SAME
0	# Full Baths 1	Phys. % Good 0%
Year Built 1970	# Half Baths 0	Funct. % Good 100%
Year Remodeled 0	# Addn Fixtures 0	Functional Code 9 None
Foundation 6 PIERS	# Fireplaces 0	1.Incomp 4.LongTerm 7.Layout
1.CONCRETE 4.WOOD 7.	 <p>TRIO Software A Division of Harris Computer Systems</p>	2.Overbuil 5.Utility 8.Other
2.CONCRETE 5.SLAB 8.		3.Delap 6.Style 9.None
3.BRICK/ST 6.PIERS 9.		Econ. % Good 100%
Basement 9 NO BASEMENT		Economic Code NONE
1.1/4 BASE 4.FULL BAS 7.		0.None 3.NO ELECT 6.
2.1/2 BASE 5.CRAWL 8.		1.LOCATION 4.GENERATC 7.
3.3/4 BASE 6. 9.NO BASEM		2.ENCROACH 5. 8.OTHER
Bsmt Gar # Cars 0		Entrance Code 5 ESTIMATED
Wet Basement 9 NO BASEMENT		1.INTERIOR 4.UNOCCUPI 7.
1.DRY BASE 4. 7.		2.REFUSED 5.ESTIMATE 8.
2.DAMP BAS 5. 8.	3.INFO ONL 6. 9.	
3.WET BASE 6. 9.NO BASEM	Information Code 5 ESTIMATE	
	1.OWNER 4.AGENT 7.	
	2.RELATIVE 5.ESTIMATE 8.	
	3.TENANT 6.OTHER 9.	

Date Inspected 7/11/2022

Additions, Outbuildings & Improvements

Type	Year	Units	Grade	Cond	Phys.	Funct.	Sound Value
21 Open Porch	1970	144	2 100	3	0 %	100 %	
					%	%	
					%	%	
					%	%	
					%	%	
					%	%	
					%	%	
					%	%	
					%	%	
					%	%	
					%	%	

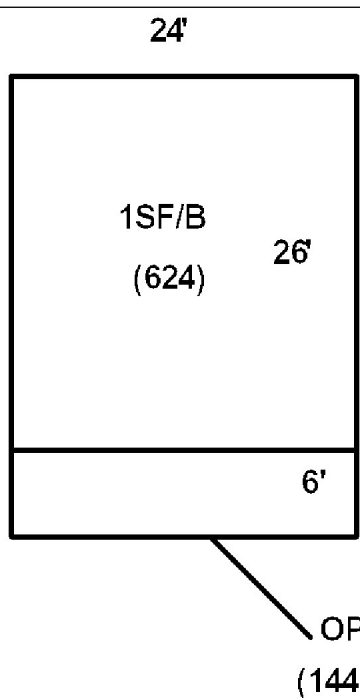

Klei, Jr., Herbert E.
76 Turnpike Road
Wilmington CT 06279

B5368P43

Inspection Witnessed By:

No./Date	Description	Date Insp.
X		

Notes:

Wade

Property Data			Assessment Record																																																																																																																																																																																																					
Neighborhood 1 Rural			Year	Land	Buildings	Exempt	Total																																																																																																																																																																																																	
Tree Growth Year 0			2017	18,800	21,000	0	39,800																																																																																																																																																																																																	
X Coordinate			2018	18,700	21,000	0	39,700																																																																																																																																																																																																	
Y Coordinate			2020	18,300	21,000	0	39,300																																																																																																																																																																																																	
Zone/Land Use 1 Residential			2021	18,800	21,000	0	39,800																																																																																																																																																																																																	
Secondary Zone			2022	27,400	30,900	0	58,300																																																																																																																																																																																																	
Topography 2 Rolling																																																																																																																																																																																																								
1.Level 4.Below Stre 7.Steep 2.Rolling 5.Low 8.Rough 3.Above Stre 6.Swampy 9.																																																																																																																																																																																																								
Utilities 1 Drilled Well / Septic																																																																																																																																																																																																								
1.Well+Septi 4.Public Wat 7.Cess Pool 2.Drilled We 5.Public Sew 8.Holding Ta 3.Septic Sys 6.Dug Well 9.NoW/NoSew																																																																																																																																																																																																								
Street 1 Paved																																																																																																																																																																																																								
1.Paved 4.Proposed 7. 2.Semi-Impro 5.Private 8. 3.Gravel 6. 9.No Street																																																																																																																																																																																																								
LAND USE 0			<table border="1"> <thead> <tr> <th rowspan="2">Front Foot</th> <th rowspan="2">Type</th> <th colspan="2">Effective</th> <th colspan="2">Influence</th> <th rowspan="2">Influence Codes</th> </tr> <tr> <th>Frontage</th> <th>Depth</th> <th>Factor</th> <th>Code</th> </tr> </thead> <tbody> <tr><td>11.Regular Lot</td><td></td><td></td><td></td><td>%</td><td></td><td>1.Vacancy</td></tr> <tr><td>12.Delta Triangle</td><td></td><td></td><td></td><td>%</td><td></td><td>2.Unimproved</td></tr> <tr><td>13.Nabla Triangle</td><td></td><td></td><td></td><td>%</td><td></td><td>3.Topography</td></tr> <tr><td>14.Rear Land</td><td></td><td></td><td></td><td>%</td><td></td><td>4.Size/Shape</td></tr> <tr><td>15.Class I Road</td><td></td><td></td><td></td><td>%</td><td></td><td>5.Access</td></tr> <tr><td></td><td></td><td></td><td></td><td>%</td><td></td><td>6.Restriction</td></tr> <tr><td></td><td></td><td></td><td></td><td>%</td><td></td><td>7.Corner/Locatio</td></tr> <tr><td></td><td></td><td></td><td></td><td>%</td><td></td><td>8.View/Environme</td></tr> <tr><td></td><td></td><td></td><td></td><td>%</td><td></td><td>9.Fractional Sha</td></tr> <tr><td></td><td></td><td></td><td></td><td>%</td><td></td><td>Acres</td></tr> <tr><td></td><td></td><td></td><td></td><td>%</td><td></td><td>32.Pasture</td></tr> <tr><td></td><td></td><td></td><td></td><td>%</td><td></td><td>33.Orchard</td></tr> <tr><td></td><td></td><td></td><td></td><td>%</td><td></td><td>34.Softwood (FL)</td></tr> <tr><td></td><td></td><td></td><td></td><td>%</td><td></td><td>35.Mixed Wood (FL)</td></tr> <tr><td></td><td></td><td></td><td></td><td>%</td><td></td><td>36.Hardwood (FL)</td></tr> <tr><td></td><td></td><td></td><td></td><td>%</td><td></td><td>37.Softwood (TG)</td></tr> <tr><td></td><td></td><td></td><td></td><td>%</td><td></td><td>38.Mixed Wood (TG)</td></tr> <tr><td></td><td></td><td></td><td></td><td>%</td><td></td><td>39.Hardwood (TG)</td></tr> <tr><td></td><td></td><td></td><td></td><td>%</td><td></td><td>40.Wasteland</td></tr> <tr><td></td><td></td><td></td><td></td><td>%</td><td></td><td>41.Open Space</td></tr> <tr><td></td><td></td><td></td><td></td><td>%</td><td></td><td>42.Mobile Home Si</td></tr> <tr><td></td><td></td><td></td><td></td><td>%</td><td></td><td>43.Condo Site</td></tr> <tr><td></td><td></td><td></td><td></td><td>%</td><td></td><td>44.Lot Improvemen</td></tr> <tr><td></td><td></td><td></td><td></td><td>%</td><td></td><td>45.Subdivision Lo</td></tr> <tr><td></td><td></td><td></td><td></td><td>%</td><td></td><td>46.Heavy Ind Sit</td></tr> <tr> <td colspan="2">Total Acreage</td> <td>33.00</td> <td colspan="4"></td> </tr> </tbody> </table>					Front Foot	Type	Effective		Influence		Influence Codes	Frontage	Depth	Factor	Code	11.Regular Lot				%		1.Vacancy	12.Delta Triangle				%		2.Unimproved	13.Nabla Triangle				%		3.Topography	14.Rear Land				%		4.Size/Shape	15.Class I Road				%		5.Access					%		6.Restriction					%		7.Corner/Locatio					%		8.View/Environme					%		9.Fractional Sha					%		Acres					%		32.Pasture					%		33.Orchard					%		34.Softwood (FL)					%		35.Mixed Wood (FL)					%		36.Hardwood (FL)					%		37.Softwood (TG)					%		38.Mixed Wood (TG)					%		39.Hardwood (TG)					%		40.Wasteland					%		41.Open Space					%		42.Mobile Home Si					%		43.Condo Site					%		44.Lot Improvemen					%		45.Subdivision Lo					%		46.Heavy Ind Sit	Total Acreage		33.00				
Front Foot	Type	Effective								Influence		Influence Codes																																																																																																																																																																																												
		Frontage	Depth	Factor	Code																																																																																																																																																																																																			
11.Regular Lot				%		1.Vacancy																																																																																																																																																																																																		
12.Delta Triangle				%		2.Unimproved																																																																																																																																																																																																		
13.Nabla Triangle				%		3.Topography																																																																																																																																																																																																		
14.Rear Land				%		4.Size/Shape																																																																																																																																																																																																		
15.Class I Road				%		5.Access																																																																																																																																																																																																		
				%		6.Restriction																																																																																																																																																																																																		
				%		7.Corner/Locatio																																																																																																																																																																																																		
				%		8.View/Environme																																																																																																																																																																																																		
				%		9.Fractional Sha																																																																																																																																																																																																		
				%		Acres																																																																																																																																																																																																		
				%		32.Pasture																																																																																																																																																																																																		
				%		33.Orchard																																																																																																																																																																																																		
				%		34.Softwood (FL)																																																																																																																																																																																																		
				%		35.Mixed Wood (FL)																																																																																																																																																																																																		
				%		36.Hardwood (FL)																																																																																																																																																																																																		
				%		37.Softwood (TG)																																																																																																																																																																																																		
				%		38.Mixed Wood (TG)																																																																																																																																																																																																		
				%		39.Hardwood (TG)																																																																																																																																																																																																		
				%		40.Wasteland																																																																																																																																																																																																		
				%		41.Open Space																																																																																																																																																																																																		
				%		42.Mobile Home Si																																																																																																																																																																																																		
				%		43.Condo Site																																																																																																																																																																																																		
				%		44.Lot Improvemen																																																																																																																																																																																																		
				%		45.Subdivision Lo																																																																																																																																																																																																		
				%		46.Heavy Ind Sit																																																																																																																																																																																																		
Total Acreage		33.00																																																																																																																																																																																																						
Sale Data			<table border="1"> <thead> <tr> <th rowspan="2">Square Foot</th> <th rowspan="2">Type</th> <th colspan="2">Square Feet</th> <th rowspan="2">Factor</th> <th rowspan="2">Code</th> </tr> <tr> <th>Frontage</th> <th>Depth</th> </tr> </thead> <tbody> <tr><td>16.Class II Road</td><td></td><td></td><td></td><td>%</td><td></td></tr> <tr><td>17.Municipal Rese</td><td></td><td></td><td></td><td>%</td><td></td></tr> <tr><td>18.Munic Sep Lago</td><td></td><td></td><td></td><td>%</td><td></td></tr> <tr><td>19.Gravel Pit</td><td></td><td></td><td></td><td>%</td><td></td></tr> <tr><td>20.Industrial Bas</td><td></td><td></td><td></td><td>%</td><td></td></tr> <tr> <td>Fract. Acre</td> <td></td> <td colspan="2">Acreage/Sites</td> <td></td> <td></td> </tr> <tr><td>21.Developed Pave</td><td>21</td><td>1.00</td><td></td><td>100 %</td><td>0</td></tr> <tr><td>22.Undev Paved (F</td><td>32</td><td>3.00</td><td></td><td>100 %</td><td>0</td></tr> <tr><td>23.Developed Grav</td><td>38</td><td>23.50</td><td></td><td>100 %</td><td>0</td></tr> <tr><td>Acres</td><td>39</td><td>5.50</td><td></td><td>100 %</td><td>0</td></tr> <tr><td>24.Undev Gravel (</td><td></td><td></td><td></td><td>%</td><td></td></tr> <tr><td>26.Rear Land</td><td></td><td></td><td></td><td>%</td><td></td></tr> <tr><td>27.Backlot</td><td></td><td></td><td></td><td>%</td><td></td></tr> <tr><td>29.Pavement</td><td></td><td></td><td></td><td>%</td><td></td></tr> <tr><td>30.Utility R O W</td><td></td><td></td><td></td><td>%</td><td></td></tr> <tr><td>31.Tillable</td><td></td><td></td><td></td><td>%</td><td></td></tr> </tbody> </table>					Square Foot	Type	Square Feet		Factor	Code	Frontage	Depth	16.Class II Road				%		17.Municipal Rese				%		18.Munic Sep Lago				%		19.Gravel Pit				%		20.Industrial Bas				%		Fract. Acre		Acreage/Sites				21.Developed Pave	21	1.00		100 %	0	22.Undev Paved (F	32	3.00		100 %	0	23.Developed Grav	38	23.50		100 %	0	Acres	39	5.50		100 %	0	24.Undev Gravel (%		26.Rear Land				%		27.Backlot				%		29.Pavement				%		30.Utility R O W				%		31.Tillable				%																																																																																										
Square Foot	Type	Square Feet		Factor	Code																																																																																																																																																																																																			
		Frontage	Depth																																																																																																																																																																																																					
16.Class II Road				%																																																																																																																																																																																																				
17.Municipal Rese				%																																																																																																																																																																																																				
18.Munic Sep Lago				%																																																																																																																																																																																																				
19.Gravel Pit				%																																																																																																																																																																																																				
20.Industrial Bas				%																																																																																																																																																																																																				
Fract. Acre		Acreage/Sites																																																																																																																																																																																																						
21.Developed Pave	21	1.00		100 %	0																																																																																																																																																																																																			
22.Undev Paved (F	32	3.00		100 %	0																																																																																																																																																																																																			
23.Developed Grav	38	23.50		100 %	0																																																																																																																																																																																																			
Acres	39	5.50		100 %	0																																																																																																																																																																																																			
24.Undev Gravel (%																																																																																																																																																																																																				
26.Rear Land				%																																																																																																																																																																																																				
27.Backlot				%																																																																																																																																																																																																				
29.Pavement				%																																																																																																																																																																																																				
30.Utility R O W				%																																																																																																																																																																																																				
31.Tillable				%																																																																																																																																																																																																				
Validity																																																																																																																																																																																																								
1.Valid 4.Split 7.Renovate 2.Related 5.Partial 8.Other 3.Distress 6.Exempt 9.																																																																																																																																																																																																								
Verified																																																																																																																																																																																																								
1.Buyer 4.Agent 7.Family 2.Seller 5.Pub Rec 8.Other 3.Lender 6.MLS 9.																																																																																																																																																																																																								

Wade

Map Lot 003-014

Account 113

Location

Card 1 Of 1 1/09/2023

Building Style 0	SF Bsmt Living 0	Layout 0					
1.CONVENTI 5.GARRISON 9.GAMBREL	Fin Bsmt Grade 0 0	1.TYPICAL 4. 7.					
2.RANCH 6.SALT BOX 10.OTHER	DIRT FLOOR 0	2.INADEQUA 5. 8.					
3.RAISED R 7.CONTEMP 11.SPLIT	Heat Type 100% 0	3.POOR 6. 9.					
4.CAPE 8.LOG 12.NE	1.HWBB 5.FWA 9.NOT HEAT	Attic 0					
Dwelling Units 0	2.HWCI 6.GRAWWA 10.	1.1/4 FINI 4.FULL FIN 7.					
Other Units 0	3.HP 7.ELECTRIC 11.	2.1/2 FINI 5.FL / STA 8.					
Stories 0	4.STEAM 8.FL/WALL 12.	3.3/4 FINI 6. 9.NONE					
1.ONE STOR 4.1.5 STOR 7.1.25 STO	Cool Type 0% 9 NONE	Insulation 0					
2.TWO STOR 5.1.75 STO 8.	1.REFRIG A 4.W&C AIR 7.	1.FULLY IN 4.MINIMAL 7.					
3.THREE ST 6.2.5 STOR 9.	2.EVAPORAT 5. 8.	2.HEAVY 5.UNKNOWN 8.					
Exterior Walls 0	3.HEAT PUM 6. 9.NONE	3.CAPPED O 6. 9.NONE					
1.WOOD 5.STUCKO 9.T-111	Kitchen Style 0	Unfinished % 0%					
2.VIN/AL 6.BRICK 10.OTHER	1.GOOD 4.OBSOLETE 7.	Grade & Factor 0 0%					
3.COMPOS. 7.STONE 11.LOG	2.TYPICAL 5. 8.	1.E GRADE 4.B GRADE 7.					
4.ASBESTOS 8.CONCRETE 12.	3.OLD STYL 6. 9.NONE	2.D GRADE 5.A GRADE 8.					
Roof Surface 0	Bath(s) Style 0	3.C GRADE 6.AA GRADE 9.SAME					
1.ASPHALT 4.COMPOSIT 7.	1.GOOD 4.OBSOLETE 7.	SQFT (Footprint) 0					
2.SLATE 5.WOOD 8.	2.TYPICAL 5. 8.	Condition 0					
3.METAL 6.OTHER 9.	3.OLD STYL 6. 9.NONE	1.POOR 4.AVERAGE 7.VERY GOO					
SF Masonry Trim 0	# Rooms 0	2.FAIR 5.ABOVE AV 8.EXCELLEN					
0	# Bedrooms 0	3.BELOW AV 6.GOOD 9.SAME					
0	# Full Baths 0	Phys. % Good 0%					
Year Built 0	# Half Baths 0	Funct. % Good 100%					
Year Remodeled 0	# Addn Fixtures 0	Functional Code 9 None					
Foundation 0	# Fireplaces 0	1.Incomp 4.LongTerm 7.Layout					
1.CONCRETE 4.WOOD 7.	 <p>TRIO Software A Division of Harris Computer Systems</p>	2.Overbuil 5.Utility 8.Other					
2.CONCRETE 5.SLAB 8.		3.Delap 6.Style 9.None					
3.BRICK/ST 6.PIERS 9.		Econ. % Good 100%					
Basement 0		Economic Code NONE					
1.1/4 BASE 4.FULL BAS 7.		0.None 3.NO ELECT 6.					
2.1/2 BASE 5.CRAWL 8.		1.LOCATION 4.GENERATC 7.					
3.3/4 BASE 6. 9.NO BASEM		2.ENCROACH 5. 8.OTHER					
Bsmt Gar # Cars 0		Entrance Code 5 ESTIMATED					
Wet Basement 0		1.INTERIOR 4.UNOCCUPI 7.					
1.DRY BASE 4. 7.		2.REFUSED 5.ESTIMATE 8.					
2.DAMP BAS 5. 8.	3.INFO ONL 6. 9.						
3.WET BASE 6. 9.NO BASEM	Information Code 5 ESTIMATE						
	1.OWNER 4.AGENT 7.						
	2.RELATIVE 5.ESTIMATE 8.						
	3.TENANT 6.OTHER 9.						
Date Inspected 7/14/2022							
Additions, Outbuildings & Improvements							
Type	Year	Units	Grade	Cond	Phys.	Funct.	Sound Value
					%	%	1.One Story Fram
					%	%	2.Two Story Fram
					%	%	3.Three Story Fr
					%	%	4.1 & 1/2 Story
					%	%	5.1 & 3/4 Story
					%	%	6.2 & 1/2 Story
					%	%	21.Open Porch
					%	%	22.Enclosed Porch
					%	%	23.Frame Garage
					%	%	24.Frame Shed
					%	%	25.1SF Bay Window
					%	%	26.1SF Over Hang
					%	%	27.Unfinished Bas
					%	%	28.Unfinished Att
					%	%	29.Finished Basem

MCCOY, MICHAEL E
129 HAYNES ROAD
WADE ME 04786

B3754P66 B6243P152

Previous Owner
McCoy, Brenda
129 Haynes Road

Wade ME 04786
Sale Date: 10/26/2021

Inspection Witnessed By:

X	Date	Description	Date Insp.

Notes:

Wade

Property Data			Assessment Record																																																																																																																																																																																														
Neighborhood 1 Rural			Year	Land	Buildings	Exempt	Total																																																																																																																																																																																										
Tree Growth Year 0			2017	12,700	122,600	20,000	115,300																																																																																																																																																																																										
X Coordinate			2018	12,700	122,600	20,000	115,300																																																																																																																																																																																										
Y Coordinate			2020	12,700	122,600	25,000	110,300																																																																																																																																																																																										
Zone/Land Use 1 Residential			2021	13,700	122,600	25,000	111,300																																																																																																																																																																																										
Secondary Zone			2022	21,700	117,400	0	139,100																																																																																																																																																																																										
Topography 2 Rolling																																																																																																																																																																																																	
1.Level 4.Below Stre 7.Steep 2.Rolling 5.Low 8.Rough 3.Above Stre 6.Swampy 9.																																																																																																																																																																																																	
Utilities 1 Drilled Well / Septic																																																																																																																																																																																																	
1.Well+Septi 4.Public Wat 7.Cess Pool 2.Drilled We 5.Public Sew 8.Holding Ta 3.Septic Sys 6.Dug Well 9.NoW/NoSew																																																																																																																																																																																																	
Street 1 Paved																																																																																																																																																																																																	
1.Paved 4.Proposed 7. 2.Semi-Impro 5.Private 8. 3.Gravel 6. 9.No Street																																																																																																																																																																																																	
LAND USE 0			<table border="1"> <thead> <tr> <th rowspan="2">Front Foot</th> <th rowspan="2">Type</th> <th colspan="2">Effective</th> <th colspan="2">Influence</th> <th rowspan="2">Influence Codes</th> </tr> <tr> <th>Frontage</th> <th>Depth</th> <th>Factor</th> <th>Code</th> </tr> </thead> <tbody> <tr> <td>11.Regular Lot</td> <td></td> <td></td> <td></td> <td>%</td> <td></td> <td>1.Vacancy</td> </tr> <tr> <td>12.Delta Triangle</td> <td></td> <td></td> <td></td> <td>%</td> <td></td> <td>2.Unimproved</td> </tr> <tr> <td>13.Nabla Triangle</td> <td></td> <td></td> <td></td> <td>%</td> <td></td> <td>3.Topography</td> </tr> <tr> <td>14.Rear Land</td> <td></td> <td></td> <td></td> <td>%</td> <td></td> <td>4.Size/Shape</td> </tr> <tr> <td>15.Class I Road</td> <td></td> <td></td> <td></td> <td>%</td> <td></td> <td>5.Access</td> </tr> <tr> <td></td> <td></td> <td></td> <td></td> <td>%</td> <td></td> <td>6.Restriction</td> </tr> <tr> <td></td> <td></td> <td></td> <td></td> <td>%</td> <td></td> <td>7.Corner/Locatio</td> </tr> <tr> <td></td> <td></td> <td></td> <td></td> <td>%</td> <td></td> <td>8.View/Environme</td> </tr> <tr> <td></td> <td></td> <td></td> <td></td> <td>%</td> <td></td> <td>9.Fractional Sha</td> </tr> <tr> <td></td> <td></td> <td></td> <td></td> <td>%</td> <td></td> <td>Acres</td> </tr> <tr> <td></td> <td></td> <td></td> <td></td> <td>%</td> <td></td> <td>32.Pasture</td> </tr> <tr> <td></td> <td></td> <td></td> <td></td> <td>%</td> <td></td> <td>33.Orchard</td> </tr> <tr> <td></td> <td></td> <td></td> <td></td> <td>%</td> <td></td> <td>34.Softwood (FL)</td> </tr> <tr> <td></td> <td></td> <td></td> <td></td> <td>%</td> <td></td> <td>35.Mixed Wood (FL)</td> </tr> <tr> <td></td> <td></td> <td></td> <td></td> <td>%</td> <td></td> <td>36.Hardwood (FL)</td> </tr> <tr> <td></td> <td></td> <td></td> <td></td> <td>%</td> <td></td> <td>37.Softwood (TG)</td> </tr> <tr> <td></td> <td></td> <td></td> <td></td> <td>%</td> <td></td> <td>38.Mixed Wood (TG)</td> </tr> <tr> <td></td> <td></td> <td></td> <td></td> <td>%</td> <td></td> <td>39.Hardwood (TG)</td> </tr> <tr> <td></td> <td></td> <td></td> <td></td> <td>%</td> <td></td> <td>40.Wasteland</td> </tr> <tr> <td></td> <td></td> <td></td> <td></td> <td>%</td> <td></td> <td>41.Open Space</td> </tr> <tr> <td></td> <td></td> <td></td> <td></td> <td>%</td> <td></td> <td>42.Mobile Home Si</td> </tr> <tr> <td></td> <td></td> <td></td> <td></td> <td>%</td> <td></td> <td>43.Condo Site</td> </tr> <tr> <td></td> <td></td> <td></td> <td></td> <td>%</td> <td></td> <td>44.Lot Improvemen</td> </tr> <tr> <td></td> <td></td> <td></td> <td></td> <td>%</td> <td></td> <td>45.Subdivision Lo</td> </tr> <tr> <td></td> <td></td> <td></td> <td></td> <td>%</td> <td></td> <td>46.Heavy Ind Sit</td> </tr> </tbody> </table>					Front Foot	Type	Effective		Influence		Influence Codes	Frontage	Depth	Factor	Code	11.Regular Lot				%		1.Vacancy	12.Delta Triangle				%		2.Unimproved	13.Nabla Triangle				%		3.Topography	14.Rear Land				%		4.Size/Shape	15.Class I Road				%		5.Access					%		6.Restriction					%		7.Corner/Locatio					%		8.View/Environme					%		9.Fractional Sha					%		Acres					%		32.Pasture					%		33.Orchard					%		34.Softwood (FL)					%		35.Mixed Wood (FL)					%		36.Hardwood (FL)					%		37.Softwood (TG)					%		38.Mixed Wood (TG)					%		39.Hardwood (TG)					%		40.Wasteland					%		41.Open Space					%		42.Mobile Home Si					%		43.Condo Site					%		44.Lot Improvemen					%		45.Subdivision Lo					%		46.Heavy Ind Sit
Front Foot	Type	Effective								Influence		Influence Codes																																																																																																																																																																																					
		Frontage	Depth	Factor	Code																																																																																																																																																																																												
11.Regular Lot				%		1.Vacancy																																																																																																																																																																																											
12.Delta Triangle				%		2.Unimproved																																																																																																																																																																																											
13.Nabla Triangle				%		3.Topography																																																																																																																																																																																											
14.Rear Land				%		4.Size/Shape																																																																																																																																																																																											
15.Class I Road				%		5.Access																																																																																																																																																																																											
				%		6.Restriction																																																																																																																																																																																											
				%		7.Corner/Locatio																																																																																																																																																																																											
				%		8.View/Environme																																																																																																																																																																																											
				%		9.Fractional Sha																																																																																																																																																																																											
				%		Acres																																																																																																																																																																																											
				%		32.Pasture																																																																																																																																																																																											
				%		33.Orchard																																																																																																																																																																																											
				%		34.Softwood (FL)																																																																																																																																																																																											
				%		35.Mixed Wood (FL)																																																																																																																																																																																											
				%		36.Hardwood (FL)																																																																																																																																																																																											
				%		37.Softwood (TG)																																																																																																																																																																																											
				%		38.Mixed Wood (TG)																																																																																																																																																																																											
				%		39.Hardwood (TG)																																																																																																																																																																																											
				%		40.Wasteland																																																																																																																																																																																											
				%		41.Open Space																																																																																																																																																																																											
				%		42.Mobile Home Si																																																																																																																																																																																											
				%		43.Condo Site																																																																																																																																																																																											
				%		44.Lot Improvemen																																																																																																																																																																																											
				%		45.Subdivision Lo																																																																																																																																																																																											
				%		46.Heavy Ind Sit																																																																																																																																																																																											
Sale Date 10/26/2021			Land Data																																																																																																																																																																																														
Price			Front Foot		Square Foot																																																																																																																																																																																												
Sale Type 2 Land & Building			11.Regular Lot		16.Class II Road																																																																																																																																																																																												
1.Land 4.Mobile 7.C/I L&B			12.Delta Triangle		17.Municipal Rese																																																																																																																																																																																												
2.L & B 5.Other 8.			13.Nabla Triangle		18.Munic Sep Lago																																																																																																																																																																																												
3.Building 6.C/I Land 9.			14.Rear Land		19.Gravel Pit																																																																																																																																																																																												
Financing 9 Unknown			15.Class I Road		20.Industrial Bas																																																																																																																																																																																												
1.Convent 4.Seller 7.																																																																																																																																																																																																	
2.FHA/VA 5.Private 8.																																																																																																																																																																																																	
3.Assumed 6.Cash 9.Unknown																																																																																																																																																																																																	
Validity 8 Other Non Valid																																																																																																																																																																																																	
1.Valid 4.Split 7.Renovate																																																																																																																																																																																																	
2.Related 5.Partial 8.Other																																																																																																																																																																																																	
3.Distress 6.Exempt 9.																																																																																																																																																																																																	
Verified 8 Other Source																																																																																																																																																																																																	
1.Buyer 4.Agent 7.Family																																																																																																																																																																																																	
2.Seller 5.Pub Rec 8.Other																																																																																																																																																																																																	
3.Lender 6.MLS 9.																																																																																																																																																																																																	
			Fract. Acre		Acres/Sites																																																																																																																																																																																												
			21.Developed Pave		21 1.00 100 % 0																																																																																																																																																																																												
			22.Undev Paved (F		26 0.40 100 % 0																																																																																																																																																																																												
			23.Developed Grav																																																																																																																																																																																														
			Acres																																																																																																																																																																																														
			24.Undev Gravel (
			26.Rear Land																																																																																																																																																																																														
			27.Backlot																																																																																																																																																																																														
			29.Pavement																																																																																																																																																																																														
			30.Utility R O W																																																																																																																																																																																														
			31.Tillable																																																																																																																																																																																														
					Total Acreage 1.40																																																																																																																																																																																												

Wade

Map Lot 003-015

Account 134

Location 129 Haynes Road

Card 1 Of 1

1/09/2023

Building Style 2 RANCH	SF Bsmt Living 0	Layout 1 TYPICAL
1.CONVENTI 5.GARRISON 9.GAMBREL	Fin Bsmt Grade 0 0	1.TYPICAL 4. 7.
2.RANCH 6.SALT BOX 10.OTHER	DIRT FLOOR 0	2.INADEQUA 5. 8.
3.RAISED R 7.CONTEMP 11.SPLIT	Heat Type 100% 5 FORCED WARM AIR	3.POOR 6. 9.
4.CAPE 8.LOG 12.NE	1.HWBB 5.FWA 9.NOT HEAT	Attic 9 NONE
Dwelling Units 1	2.HWCI 6.GRAVWA 10.	1.1/4 FINI 4.FULL FIN 7.
Other Units 0	3.HP 7.ELECTRIC 11.	2.1/2 FINI 5.FL / STA 8.
Stories 1 ONE STORY	4.STEAM 8.FL/WALL 12.	3.3/4 FINI 6. 9.NONE
1.ONE STOR 4.1.5 STOR 7.1.25 STO	Cool Type 0% 9 NONE	Insulation 1 FULLY INSULATED
2.TWO STOR 5.1.75 STO 8.	1.REFRIG A 4.W&C AIR 7.	1.FULLY IN 4.MINIMAL 7.
3.THREE ST 6.2.5 STOR 9.	2.EVAPORAT 5. 8.	2.HEAVY 5.UNKNOWN 8.
Exterior Walls 2 VINYL/ALUMINUM	3.HEAT PUM 6. 9.NONE	3.CAPPED O 6. 9.NONE
1.WOOD 5.STUCKO 9.T-111	Kitchen Style 2 TYPICAL	Unfinished % 0%
2.VIN/AL 6.BRICK 10.OTHER	1.GOOD 4.OBSOLETE 7.	Grade & Factor 3 AVERAGE QUALITY
3.COMPOS. 7.STONE 11.LOG	2.TYPICAL 5. 8.	1.E GRADE 4.B GRADE 7.
4.ASBESTOS 8.CONCRETE 12.	3.OLD STYL 6. 9.NONE	2.D GRADE 5.A GRADE 8.
Roof Surface 3 METAL	Bath(s) Style 2 TYPICAL	3.C GRADE 6.AA GRADE 9.SAME
1.ASPHALT 4.COMPOSIT 7.	1.GOOD 4.OBSOLETE 7.	SQFT (Footprint) 1104
2.SLATE 5.WOOD 8.	2.TYPICAL 5. 8.	Condition 5 ABOVE AVERAGE
3.METAL 6.OTHER 9.	3.OLD STYL 6. 9.NONE	1.POOR 4.AVERAGE 7.VERY GOO
SF Masonry Trim 0	# Rooms 6	2.FAIR 5.ABOVE AV 8.EXCELLEN
0	# Bedrooms 3	3.BELOW AV 6.GOOD 9.SAME
0	# Full Baths 1	Phys. % Good 0%
Year Built 2000	# Half Baths 0	Funct. % Good 100%
Year Remodeled 0	# Addn Fixtures 0	Functional Code 9 None
Foundation 1 CONCRETE	# Fireplaces 0	1.Incomp 4.LongTerm 7.Layout
1.CONCRETE 4.WOOD 7.		2.Overbuil 5.Utility 8.Other
2.CONCRETE 5.SLAB 8.		3.Delap 6.Style 9.None
3.BRICK/ST 6.PIERS 9.		Econ. % Good 100%
Basement 4 FULL BASEMENT		Economic Code NONE
1.1/4 BASE 4.FULL BAS 7.		0.None 3.NO ELECT 6.
2.1/2 BASE 5.CRAWL 8.		1.LOCATION 4.GENERATC 7.
3.3/4 BASE 6. 9.NO BASEM		2.ENCROACH 5. 8.OTHER
Bsmt Gar # Cars 0		Entrance Code 2 REFUSED ENTRY
Wet Basement 1 DRY BASEMENT		1.INTERIOR 4.UNOCCUPI 7.
1.DRY BASE 4. 7.		2.REFUSED 5.ESTIMATE 8.
2.DAMP BAS 5. 8.	3.INFO ONL 6. 9.	
3.WET BASE 6. 9.NO BASEM	Information Code 1 OWNER	
		1.OWNER 4.AGENT 7.
		2.RELATIVE 5.ESTIMATE 8.
		3.TENANT 6.OTHER 9.

Date Inspected 7/11/2022

Additions, Outbuildings & Improvements

Type	Year	Units	Grade	Cond	Phys.	Funct.	Sound Value
1 One Story Frame	2000	192	9 100	9	0 %	100 %	
68 Deck	2000	560	3 100	5	0 %	100 %	
23 Frame Garage	2000	480	3 100	5	0 %	100 %	
96 Quonset Garage	1990	960	3 100	5	0 %	100 %	
					%	%	
					%	%	
					%	%	
					%	%	
					%	%	
					%	%	
					%	%	
					%	%	
					%	%	
					%	%	
					%	%	
					%	%	
					%	%	
					%	%	
					%	%	
					%	%	

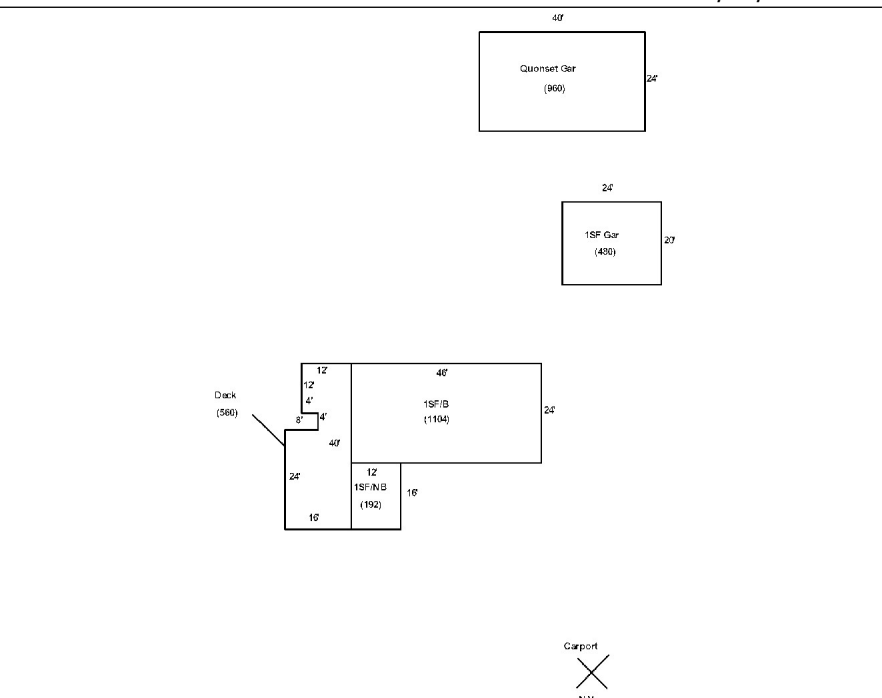

Klei, Jr., Herbert E.
76 Turnpike Road
Willington CT 06279

B1664P210

Inspection Witnessed By:

No./Date	Description	Date Insp.
X		

Notes:

Wade

Property Data			Assessment Record							
Neighborhood 1 Rural			Year	Land	Buildings	Exempt	Total			
Tree Growth Year 0			2017	2,100	0	0	2,100			
X Coordinate			2018	2,100	0	0	2,100			
Y Coordinate			2020	1,800	0	0	1,800			
Zone/Land Use 1 Residential			2021	1,600	0	0	1,600			
Secondary Zone			2022	1,700	0	0	1,700			
Topography 2 Rolling										
1.Level 4.Below Stre 7.Steep 2.Rolling 5.Low 8.Rough 3.Above Stre 6.Swampy 9.										
Utilities 9 NoWater/NoSewer										
1.Well+Septi 4.Public Wat 7.Cess Pool 2.Drilled We 5.Public Sew 8.Holding Ta 3.Septic Sys 6.Dug Well 9.NoW/NoSew										
Street 1 Paved										
1.Paved 4.Proposed 7. 2.Semi-Impro 5.Private 8. 3.Gravel 6. 9.No Street										
LAND USE 0										
Building Use 0										
Sale Data			Land Data							
Sale Date			Front Foot	Type	Effective		Influence		Influence Codes	
Price			11.Regular Lot		Frontage	Depth	Factor	Code		
Sale Type			12.Delta Triangle						1.Vacancy	
1.Land 4.Mobile 7.C/I L&B			13.Nabla Triangle						2.Unimproved	
2.L & B 5.Other 8.			14.Rear Land						3.Topography	
3.Building 6.C/I Land 9.			15.Class I Road						4.Size/Shape	
Financing									5.Access	
1.Convent 4.Seller 7.									6.Restriction	
2.FHA/VA 5.Private 8.			Square Foot		Square Feet				7.Corner/Locatio	
3.Assumed 6.Cash 9.Unknown			16.Class II Road						8.View/Environme	
Validity			17.Municipal Rese						9.Fractional Sha	
1.Valid 4.Split 7.Renovate			18.Munic Sep Lago						Acres	
2.Related 5.Partial 8.Other			19.Gravel Pit						32.Pasture	
3.Distress 6.Exempt 9.			20.Industrial Bas						33.Orchard	
Verified									34.Softwood (FL)	
1.Buyer 4.Agent 7.Family			Fract. Acre		Acreage/Sites				35.Mixed Wood (FL)	
2.Seller 5.Pub Rec 8.Other			21.Developed Pave	38		4.70	100	%	0	36.Hardwood (FL)
3.Lender 6.MLS 9.			22.Undev Paved (F	37		2.80	100	%	0	37.Softwood (TG)
			23.Developed Grav	39		4.50	100	%	0	38.Mixed Wood (TG)
			Acres							39.Hardwood (TG)
			24.Undev Gravel (40.Wasteland
			26.Rear Land							41.Open Space
			27.Backlot							42.Mobile Home Si
			29.Pavement							43.Condo Site
			30.Utility R O W							44.Lot Improvemen
			31.Tillable							45.Subdivision Lo
			Total Acreage 12.00							46.Heavy Ind Sit

Wade

Map Lot 003-016

Account 108

Location Haynes Rd

Card 1 Of 1 1/09/2023

Building Style 0	SF Bsmt Living 0	Layout 0
1.CONVENTI 5.GARRISON 9.GAMBREL	Fin Bsmt Grade 0 0	1.TYPICAL 4. 7.
2.RANCH 6.SALT BOX 10.OTHER	DIRT FLOOR 0	2.INADEQUA 5. 8.
3.RAISED R 7.CONTEMP 11.SPLIT	Heat Type 100% 0	3.POOR 6. 9.
4.CAPE 8.LOG 12.NE	1.HWBB 5.FWA 9.NOT HEAT	Attic 0
Dwelling Units 0	2.HWCI 6.GRAVWA 10.	1.1/4 FINI 4.FULL FIN 7.
Other Units 0	3.HP 7.ELECTRIC 11.	2.1/2 FINI 5.FL / STA 8.
Stories 0	4.STEAM 8.FL/WALL 12.	3.3/4 FINI 6. 9.NONE
1.ONE STOR 4.1.5 STOR 7.1.25 STO	Cool Type 0% 9 NONE	Insulation 0
2.TWO STOR 5.1.75 STO 8.	1.REFRIG A 4.W&C AIR 7.	1.FULLY IN 4.MINIMAL 7.
3.THREE ST 6.2.5 STOR 9.	2.EVAPORAT 5. 8.	2.HEAVY 5.UNKNOWN 8.
Exterior Walls 0	3.HEAT PUM 6. 9.NONE	3.CAPPED O 6. 9.NONE
1.WOOD 5.STUCKO 9.T-111	Kitchen Style 0	Unfinished % 0%
2.VIN/AL 6.BRICK 10.OTHER	1.GOOD 4.OBSOLETE 7.	Grade & Factor 0 0%
3.COMPOS. 7.STONE 11.LOG	2.TYPICAL 5. 8.	1.E GRADE 4.B GRADE 7.
4.ASBESTOS 8.CONCRETE 12.	3.OLD STYL 6. 9.NONE	2.D GRADE 5.A GRADE 8.
Roof Surface 0	Bath(s) Style 0	3.C GRADE 6.AA GRADE 9.SAME
1.ASPHALT 4.COMPOSIT 7.	1.GOOD 4.OBSOLETE 7.	SQFT (Footprint) 0
2.SLATE 5.WOOD 8.	2.TYPICAL 5. 8.	Condition 0
3.METAL 6.OTHER 9.	3.OLD STYL 6. 9.NONE	1.POOR 4.AVERAGE 7.VERY GOO
SF Masonry Trim 0	# Rooms 0	2.FAIR 5.ABOVE AV 8.EXCELLEN
0	# Bedrooms 0	3.BELOW AV 6.GOOD 9.SAME
0	# Full Baths 0	Phys. % Good 0%
Year Built 0	# Half Baths 0	Funct. % Good 100%
Year Remodeled 0	# Addn Fixtures 0	Functional Code 9 None
Foundation 0	# Fireplaces 0	1.Incomp 4.LongTerm 7.Layout
1.CONCRETE 4.WOOD 7.		2.Overbuil 5.Utility 8.Other
2.CONCRETE 5.SLAB 8.		3.Delap 6.Style 9.None
3.BRICK/ST 6.PIERS 9.		Econ. % Good 100%
Basement 0		Economic Code NONE
1.1/4 BASE 4.FULL BAS 7.		0.None 3.NO ELECT 6.
2.1/2 BASE 5.CRAWL 8.		1.LOCATION 4.GENERATC 7.
3.3/4 BASE 6. 9.NO BASEM		2.ENCROACH 5. 8.OTHER
Bsmt Gar # Cars 0		Entrance Code 5 ESTIMATED
Wet Basement 0		1.INTERIOR 4.UNOCCUPI 7.
1.DRY BASE 4. 7.		2.REFUSED 5.ESTIMATE 8.
2.DAMP BAS 5. 8.		3.INFO ONL 6. 9.
3.WET BASE 6. 9.NO BASEM		Information Code 5 ESTIMATE
		1.OWNER 4.AGENT 7.
		2.RELATIVE 5.ESTIMATE 8.
		3.TENANT 6.OTHER 9.



Date Inspected 7/14/2022

Additions, Outbuildings & Improvements								
Type	Year	Units	Grade	Cond	Phys.	Funct.	Sound Value	
					%	%		1.One Story Fram
					%	%		2.Two Story Fram
					%	%		3.Three Story Fr
					%	%		4.1 & 1/2 Story
					%	%		5.1 & 3/4 Story
					%	%		6.2 & 1/2 Story
					%	%		21.Open Porch
					%	%		22.Enclosed Porch
					%	%		23.Frame Garage
					%	%		24.Frame Shed
					%	%		25.1SF Bay Window
					%	%		26.1SF Over Hang
					%	%		27.Unfinished Bas
					%	%		28.Unfinished Att
					%	%		29.Finished Basem

Wade

Map Lot 003-017

Account 35

Location 97 Haynes Rd

Card 1 Of 1 1/09/2023

Building Style 1 CONVENTIONAL	SF Bsmt Living 0	Layout 1 TYPICAL
1.CONVENTI 5.GARRISON 9.GAMBREL	Fin Bsmt Grade 0 0	1.TYPICAL 4. 7.
2.RANCH 6.SALT BOX 10.OTHER	DIRT FLOOR 0	2.INADEQUA 5. 8.
3.RAISED R 7.CONTEMP 11.SPLIT	Heat Type 100% 5 FORCED WARM AIR	3.POOR 6. 9.
4.CAPE 8.LOG 12.NE	1.HWBB 5.FWA 9.NOT HEAT	Attic 9 NONE
Dwelling Units 1	2.HWCI 6.GRAVWA 10.	1.1/4 FINI 4.FULL FIN 7.
Other Units 0	3.HP 7.ELECTRIC 11.	2.1/2 FINI 5.FL / STA 8.
Stories 4 ONE & 1/2 STORY	4.STEAM 8.FL/WALL 12.	3.3/4 FINI 6. 9.NONE
1.ONE STOR 4.1.5 STOR 7.1.25 STO	Cool Type 0% 9 NONE	Insulation 1 FULLY INSULATED
2.TWO STOR 5.1.75 STO 8.	1.REFRIG A 4.W&C AIR 7.	1.FULLY IN 4.MINIMAL 7.
3.THREE ST 6.2.5 STOR 9.	2.EVAPORAT 5. 8.	2.HEAVY 5.UNKNOWN 8.
Exterior Walls 2 VINYL/ALUMINUM	3.HEAT PUM 6. 9.NONE	3.CAPPED O 6. 9.NONE
1.WOOD 5.STUCKO 9.T-111	Kitchen Style 2 TYPICAL	Unfinished % 0%
2.VIN/AL 6.BRICK 10.OTHER	1.GOOD 4.OBSOLETE 7.	Grade & Factor 3 AVERAGE QUALITY
3.COMPOS. 7.STONE 11.LOG	2.TYPICAL 5. 8.	1.E GRADE 4.B GRADE 7.
4.ASBESTOS 8.CONCRETE 12.	3.OLD STYL 6. 9.NONE	2.D GRADE 5.A GRADE 8.
Roof Surface 3 METAL	Bath(s) Style 2 TYPICAL	3.C GRADE 6.AA GRADE 9.SAME
1.ASPHALT 4.COMPOSIT 7.	1.GOOD 4.OBSOLETE 7.	SQFT (Footprint) 600
2.SLATE 5.WOOD 8.	2.TYPICAL 5. 8.	Condition 4 AVERAGE
3.METAL 6.OTHER 9.	3.OLD STYL 6. 9.NONE	1.POOR 4.AVERAGE 7.VERY GOO
SF Masonry Trim 0	# Rooms 8	2.FAIR 5.ABOVE AV 8.EXCELLEN
0	# Bedrooms 5	3.BELOW AV 6.GOOD 9.SAME
0	# Full Baths 1	Phys. % Good 0%
Year Built 1900	# Half Baths 0	Funct. % Good 100%
Year Remodeled 0	# Addn Fixtures 0	Functional Code 9 None
Foundation 6 PIERS	# Fireplaces 0	1.Incomp 4.LongTerm 7.Layout
1.CONCRETE 4.WOOD 7.	 <p>TRIO Software A Division of Harris Computer Systems</p>	2.Overbuil 5.Utility 8.Other
2.CONCRETE 5.SLAB 8.		3.Delap 6.Style 9.None
3.BRICK/ST 6.PIERS 9.		Econ. % Good 100%
Basement 5 CRAWL		Economic Code NONE
1.1/4 BASE 4.FULL BAS 7.		0.None 3.NO ELECT 6.
2.1/2 BASE 5.CRAWL 8.		1.LOCATION 4.GENERATC 7.
3.3/4 BASE 6. 9.NO BASEM		2.ENCROACH 5. 8.OTHER
Bsmt Gar # Cars 0		Entrance Code 3 INFORMATION ONLY
Wet Basement 9 NO BASEMENT		1.INTERIOR 4.UNOCCUPI 7.
1.DRY BASE 4. 7.		2.REFUSED 5.ESTIMATE 8.
2.DAMP BAS 5. 8.	3.INFO ONL 6. 9.	
3.WET BASE 6. 9.NO BASEM	Information Code 1 OWNER	
	1.OWNER 4.AGENT 7.	
	2.RELATIVE 5.ESTIMATE 8.	
	3.TENANT 6.OTHER 9.	

Date Inspected 7/11/2022

Additions, Outbuildings & Improvements

Type	Year	Units	Grade	Cond	Phys.	Funct.	Sound Value
22 Enclosed Porch	1960	132	3 100	4	0 %	100 %	
1 One Story Frame	1960	240	3 100	4	0 %	90 %	
23 Frame Garage	1960	1200	3 100	4	0 %	100 %	
23 Frame Garage	2000	988	3 105	4	0 %	100 %	
					%	%	
					%	%	
					%	%	
					%	%	
					%	%	
					%	%	
					%	%	
					%	%	

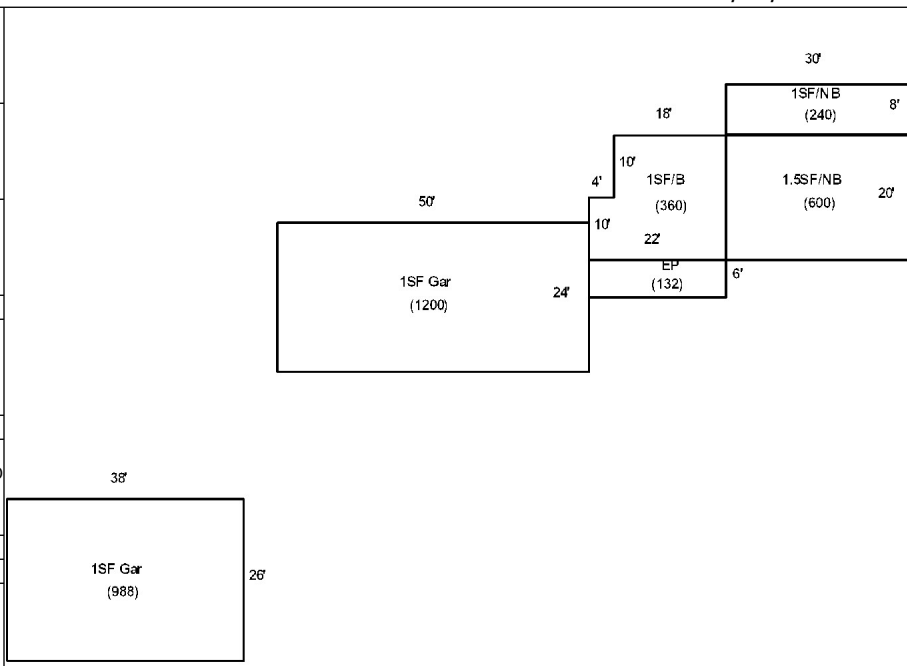

Wilcox, Sterling
85 Haynes Rd
Wade ME 04786

B1036P644

Inspection Witnessed By:

X		Date
No./Date	Description	Date Insp.

Notes:

* Dwelling (312), (336), and (416): -10% functional due to delap.

Wade

Property Data			Assessment Record				
Neighborhood 1 Rural			Year	Land	Buildings	Exempt	Total
Tree Growth Year 0			2017	33,500	34,400	26,000	41,900
X Coordinate			2018	33,500	34,400	26,000	41,900
Y Coordinate			2020	33,500	34,400	31,000	36,900
Zone/Land Use 1 Residential			2021	34,500	34,400	31,000	37,900
Secondary Zone			2022	47,100	56,200	31,000	72,300
Topography 2 Rolling							
1.Level 4.Below Stre 7.Steep 2.Rolling 5.Low 8.Rough 3.Above Stre 6.Swampy 9.							
Utilities 1 Drilled Well / Septic 1.Well+Septi 4.Public Wat 7.Cess Pool 2.Drilled We 5.Public Sew 8.Holding Ta 3.Septic Sys 6.Dug Well 9.NoW/NoSew							
Street 1 Paved 1.Paved 4.Proposed 7. 2.Semi-Impro 5.Private 8. 3.Gravel 6. 9.No Street							
LAND USE 0 Building Use 0			Land Data				
Sale Data Sale Date Price Sale Type 1.Land 4.Mobile 7.C/I L&B 2.L & B 5.Other 8. 3.Building 6.C/I Land 9. Financing 1.Convent 4.Seller 7. 2.FHA/VA 5.Private 8. 3.Assumed 6.Cash 9.Unknown Validity 1.Valid 4.Split 7.Renovate 2.Related 5.Partial 8.Other 3.Distress 6.Exempt 9. Verified 1.Buyer 4.Agent 7.Family 2.Seller 5.Pub Rec 8.Other 3.Lender 6.MLS 9.			Front Foot 11.Regular Lot 12.Delta Triangle 13.Nabla Triangle 14.Rear Land 15.Class I Road		Type Effective Frontage Depth Influence Factor Code Influence Codes 1.Vacancy 2.Unimproved 3.Topography 4.Size/Shape 5.Access 6.Restriction 7.Corner/Locatio 8.View/Environme 9.Fractional Sha Acres 32.Pasture 33.Orchard 34.Softwood (FL) 35.Mixed Wood (FL) 36.Hardwood (FL) 37.Softwood (TG) 38.Mixed Wood (TG) 39.Hardwood (TG) 40.Wasteland 41.Open Space 42.Mobile Home Si 43.Condo Site 44.Lot Improvemen 45.Subdivision Lo 46.Heavy Ind Sit		
			Square Foot 16.Class II Road 17.Municipal Rese 18.Munic Sep Lago 19.Gravel Pit 20.Industrial Bas			Square Feet 21 1.00 100 % 0 26 34.00 100 % 0 32 13.00 100 % 0	
Fract. Acre 21.Developed Pave 22.Undev Paved (F 23.Developed Grav Acres 24.Undev Gravel (26.Rear Land 27.Backlot 29.Pavement 30.Utility R O W 31.Tillable			Acres/Sites Total Acreage 48.00		0 0 0		

Wade

Map Lot 003-019

Account 79

Location 75 Haynes Rd

Card 1 Of 1 1/09/2023

Building Style 3 RAISED RANCH	SF Bsmt Living 462	Layout 1 TYPICAL
1.CONVENTI 5.GARRISON 9.GAMBREL	Fin Bsmt Grade 3 100	1.TYPICAL 4. 7.
2.RANCH 6.SALT BOX 10.OTHER	DIRT FLOOR 0	2.INADEQUA 5. 8.
3.RAISED R 7.CONTEMP 11.SPLIT	Heat Type 100% 1 HOT WATER BB	3.POOR 6. 9.
4.CAPE 8.LOG 12.NE	1.HWBB 5.FWA 9.NOT HEAT	Attic 9 NONE
Dwelling Units 1	2.HWCI 6.GRAWWA 10.	1.1/4 FINI 4.FULL FIN 7.
Other Units 0	3.HP 7.ELECTRIC 11.	2.1/2 FINI 5.FL / STA 8.
Stories 1 ONE STORY	4.STEAM 8.FL/WALL 12.	3.3/4 FINI 6. 9.NONE
1.ONE STOR 4.1.5 STOR 7.1.25 STO	Cool Type 0% 9 NONE	Insulation 1 FULLY INSULATED
2.TWO STOR 5.1.75 STO 8.	1.REFRIG A 4.W&C AIR 7.	1.FULLY IN 4.MINIMAL 7.
3.THREE ST 6.2.5 STOR 9.	2.EVAPORAT 5. 8.	2.HEAVY 5.UNKNOWN 8.
Exterior Walls 2 VINYL/ALUMINUM	3.HEAT PUM 6. 9.NONE	3.CAPPED O 6. 9.NONE
1.WOOD 5.STUCKO 9.T-111	Kitchen Style 2 TYPICAL	Unfinished % 0%
2.VIN/AL 6.BRICK 10.OTHER	1.GOOD 4.OBSOLETE 7.	Grade & Factor 3 AVERAGE QUALITY
3.COMPOS. 7.STONE 11.LOG	2.TYPICAL 5. 8.	1.E GRADE 4.B GRADE 7.
4.ASBESTOS 8.CONCRETE 12.	3.OLD STYL 6. 9.NONE	2.D GRADE 5.A GRADE 8.
Roof Surface 1 ASPHALT SHINGLES	Bath(s) Style 2 TYPICAL	3.C GRADE 6.AA GRADE 9.SAME
1.ASPHALT 4.COMPOSIT 7.	1.GOOD 4.OBSOLETE 7.	SQFT (Footprint) 924
2.SLATE 5.WOOD 8.	2.TYPICAL 5. 8.	Condition 4 AVERAGE
3.METAL 6.OTHER 9.	3.OLD STYL 6. 9.NONE	1.POOR 4.AVERAGE 7.VERY GOO
SF Masonry Trim 0	# Rooms 5	2.FAIR 5.ABOVE AV 8.EXCELLEN
0	# Bedrooms 3	3.BELOW AV 6.GOOD 9.SAME
0	# Full Baths 1	Phys. % Good 0%
Year Built 2000	# Half Baths 0	Funct. % Good 100%
Year Remodeled 0	# Addn Fixtures 0	Functional Code 9 None
Foundation 1 CONCRETE	# Fireplaces 0	1.Incomp 4.LongTerm 7.Layout
1.CONCRETE 4.WOOD 7.		2.Overbuil 5.Utility 8.Other
2.CONCRETE 5.SLAB 8.		3.Delap 6.Style 9.None
3.BRICK/ST 6.PIERS 9.		Econ. % Good 100%
Basement 4 FULL BASEMENT		Economic Code NONE
1.1/4 BASE 4.FULL BAS 7.		0.None 3.NO ELECT 6.
2.1/2 BASE 5.CRAWL 8.		1.LOCATION 4.GENERATC 7.
3.3/4 BASE 6. 9.NO BASEM		2.ENCROACH 5. 8.OTHER
Bsmt Gar # Cars 0		Entrance Code 3 INFORMATION ONLY
Wet Basement 1 DRY BASEMENT		1.INTERIOR 4.UNOCCUPI 7.
1.DRY BASE 4. 7.		2.REFUSED 5.ESTIMATE 8.
2.DAMP BAS 5. 8.	3.INFO ONL 6. 9.	
3.WET BASE 6. 9.NO BASEM	Information Code 1 OWNER	
	1.OWNER 4.AGENT 7.	
	2.RELATIVE 5.ESTIMATE 8.	
	3.TENANT 6.OTHER 9.	

Date Inspected 7/11/2022

Additions, Outbuildings & Improvements

Type	Year	Units	Grade	Cond	Phys.	Funct.	Sound Value
26 1SF Over Hang	2000	40	9 100	9	0 %	100 %	
26 1SF Over Hang	2000	32	9 100	9	0 %	100 %	
68 Deck	2010	252	3 100	4	0 %	100 %	
23 Frame Garage	2010	440	3 100	4	0 %	100 %	
24 Frame Shed	2000				%	%	1,000
24 Frame Shed	2021				%	%	3,000
					%	%	
					%	%	
					%	%	
					%	%	
					%	%	

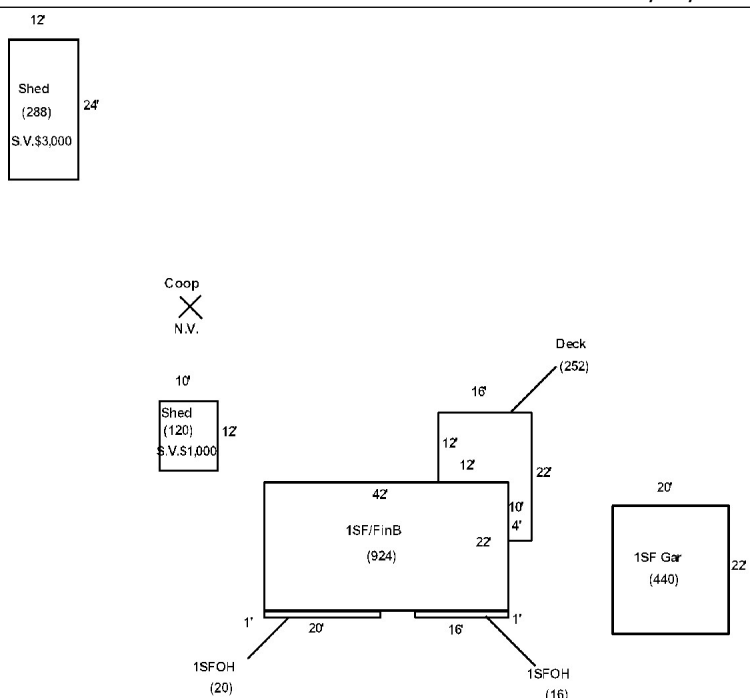

Wade

Map Lot 003-020

Account 24

Location 5 Haynes Rd

Card 1 Of 1 1/09/2023

Building Style 0	SF Bsmt Living 0	Layout 0
1.CONVENTI 5.GARRISON 9.GAMBREL	Fin Bsmt Grade 0 0	1.TYPICAL 4. 7.
2.RANCH 6.SALT BOX 10.OTHER	DIRT FLOOR 0	2.INADEQUA 5. 8.
3.RAISED R 7.CONTEMP 11.SPLIT	Heat Type 100% 0	3.POOR 6. 9.
4.CAPE 8.LOG 12.NE	1.HWBB 5.FWA 9.NOT HEAT	Attic 0
Dwelling Units 0	2.HWCI 6.GRAVWA 10.	1.1/4 FINI 4.FULL FIN 7.
Other Units 0	3.HP 7.ELECTRIC 11.	2.1/2 FINI 5.FL / STA 8.
Stories 0	4.STEAM 8.FL/WALL 12.	3.3/4 FINI 6. 9.NONE
1.ONE STOR 4.1.5 STOR 7.1.25 STO	Cool Type 0% 9 NONE	Insulation 0
2.TWO STOR 5.1.75 STO 8.	1.REFRIG A 4.W&C AIR 7.	1.FULLY IN 4.MINIMAL 7.
3.THREE ST 6.2.5 STOR 9.	2.EVAPORAT 5. 8.	2.HEAVY 5.UNKNOWN 8.
Exterior Walls 0	3.HEAT PUM 6. 9.NONE	3.CAPPED O 6. 9.NONE
1.WOOD 5.STUCKO 9.T-111	Kitchen Style 0	Unfinished % 0%
2.VIN/AL 6.BRICK 10.OTHER	1.GOOD 4.OBSOLETE 7.	Grade & Factor 0 0%
3.COMPOS. 7.STONE 11.LOG	2.TYPICAL 5. 8.	1.E GRADE 4.B GRADE 7.
4.ASBESTOS 8.CONCRETE 12.	3.OLD STYL 6. 9.NONE	2.D GRADE 5.A GRADE 8.
Roof Surface 0	Bath(s) Style 0	3.C GRADE 6.AA GRADE 9.SAME
1.ASPHALT 4.COMPOSIT 7.	1.GOOD 4.OBSOLETE 7.	SQFT (Footprint) 0
2.SLATE 5.WOOD 8.	2.TYPICAL 5. 8.	Condition 0
3.METAL 6.OTHER 9.	3.OLD STYL 6. 9.NONE	1.POOR 4.AVERAGE 7.VERY GOO
SF Masonry Trim 0	# Rooms 0	2.FAIR 5.ABOVE AV 8.EXCELLEN
0	# Bedrooms 0	3.BELOW AV 6.GOOD 9.SAME
0	# Full Baths 0	Phys. % Good 0%
Year Built 0	# Half Baths 0	Funct. % Good 100%
Year Remodeled 0	# Addn Fixtures 0	Functional Code 9 None
Foundation 0	# Fireplaces 0	1.Incomp 4.LongTerm 7.Layout
1.CONCRETE 4.WOOD 7.		2.Overbuil 5.Utility 8.Other
2.CONCRETE 5.SLAB 8.		3.Delap 6.Style 9.None
3.BRICK/ST 6.PIERS 9.		Econ. % Good 100%
Basement 0		Economic Code NONE
1.1/4 BASE 4.FULL BAS 7.		0.None 3.NO ELECT 6.
2.1/2 BASE 5.CRAWL 8.		1.LOCATION 4.GENERATC 7.
3.3/4 BASE 6. 9.NO BASEM		2.ENCROACH 5. 8.OTHER
Bsmt Gar # Cars 0		Entrance Code 0
Wet Basement 0		1.INTERIOR 4.UNOCCUPI 7.
1.DRY BASE 4. 7.		2.REFUSED 5.ESTIMATE 8.
2.DAMP BAS 5. 8.		3.INFO ONL 6. 9.
3.WET BASE 6. 9.NO BASEM		Information Code 0
		1.OWNER 4.AGENT 7.
		2.RELATIVE 5.ESTIMATE 8.
		3.TENANT 6.OTHER 9.



Date Inspected

Additions, Outbuildings & Improvements

Type	Year	Units	Grade	Cond	Phys.	Funct.	Sound Value
					%	%	1.One Story Fram
					%	%	2.Two Story Fram
					%	%	3.Three Story Fr
					%	%	4.1 & 1/2 Story
					%	%	5.1 & 3/4 Story
					%	%	6.2 & 1/2 Story
					%	%	21.Open Porch
					%	%	22.Enclosed Porch
					%	%	23.Frame Garage
					%	%	24.Frame Shed
					%	%	25.1SF Bay Window
					%	%	26.1SF Over Hang
					%	%	27.Unfinished Bas
					%	%	28.Unfinished Att
					%	%	29.Finished Basem