



## Washburn

Map Lot 012-076

Account 479

Location 17 PORTER STREET

Card 1 Of 1 12/09/2022

Building Style	<b>2 Ranch</b>		SF Bsmt Living	<b>288</b>		Layout	<b>1 Typical</b>				
1.Conv.	5.Garrison	9.Gambrel	Fin Bsmt Grade	<b>3 100</b>		1.Typical	4.	7.			
2.Ranch	6.Salt Box	10.Other	OPEN 5 OPTIONAL	<b>0</b>		2.Inadeq	5.	8.			
3.R Ranch	7.Contemp	11.Split	Heat Type	<b>100% 1 Hot Water BB</b>		3.Poor	6.	9.			
4.Cape	8.Log	12.	1.HWBB	5.FWA	9.No Heat	<b>Attic 9 None</b>					
Dwelling Units	<b>1</b>		2.HWCI	6.GravWA	10.	1.1/4 Fin	4.Full Fin	7.			
Other Units	<b>0</b>		3.H Pump	7.Electric	11.	2.1/2 Fin	5.FI/Stair	8.			
Stories	<b>1 One Story</b>		4.Steam	8.FI/Wall	12.	3.3/4 Fin	6.	9.None			
1.1	4.1.5	7.	Cool Type	<b>0% 9 None</b>		<b>Insulation 1 Full</b>					
2.2	5.1.75	8.	1.Refrig	4.W&C Air	7.	1.Full	4.Minimal	7.			
3.3	6.2.5	9.	2.Evapor	5.	8.	2.Heavy	5.Partial	8.			
Exterior Walls	<b>2 Vinyl/Aluminum</b>		3.H Pump	6.	9.None	3.Capped	6.	9.None			
1.Wood	5.Stucco	9.T-111	Kitchen Style	<b>2 Typical</b>		<b>Unfinished % 0%</b>					
2.Vin/Al	6.Brick	10.Other	1.Modern	4.Obsolete	7.	<b>Grade &amp; Factor 3 Average 105%</b>					
3.Compos.	7.Stone	11.	2.Typical	5.	8.	1.E Grade	4.B Grade	7.			
4.Asbestos	8.Concrete	12.	3.Old Type	6.	9.None	2.D Grade	5.A Grade	8.SC Grade			
Roof Surface	<b>1 Asphalt Shingles</b>		Bath(s) Style	<b>2 Typical Bath(s)</b>		3.C Grade	6.AA Grade	9.Same			
1.Asphalt	4.Composit	7.	1.Modern	4.Obsolete	7.	<b>SQFT (Footprint) 1196</b>					
2.Slate	5.Wood	8.	2.Typical	5.	8.	<b>Condition 7 Very Good</b>					
3.Metal	6.Other	9.	3.Old Type	6.	9.None	1.Poor	4.Avg	7.V G			
SF Masonry Trim	<b>0</b>		# Rooms	<b>5</b>		2.Fair	5.Avg+	8.Exc			
OPEN-3-CUSTOM	<b>0</b>		# Bedrooms	<b>3</b>		3.Avg-	6.Good	9.Same			
OPEN-4-CUSTOM	<b>0</b>		# Full Baths	<b>1</b>		<b>Phys. % Good 0%</b>					
Year Built	<b>1970</b>		# Half Baths	<b>0</b>		<b>Funct. % Good 100%</b>					
Year Remodeled	<b>0</b>		# Addn Fixtures	<b>0</b>		<b>Functional Code 9 None</b>					
Foundation	<b>1 Concrete</b>		# Fireplaces	<b>0</b>		1.Incomp	4.Delap	7.No Power			
1.Concrete	4.Wood	7.									
2.C Block	5.Slab	8.							<b>Economic Code None</b>		
3.Br/Stone	6.Piers	9.							0.None	3.No Power	7.
Basement	<b>4 Full Basement</b>								1.Location	4.Generate	8.
1.1/4 Bmt	4.Full Bmt	7.							2.Encroach	9.None	9.
2.1/2 Bmt	5.None	8.							<b>Entrance Code 1 Interior Inspect</b>		
3.3/4 Bmt	6.	9.None							1.Interior	4.Vacant	7.
Bsmt Gar # Cars	<b>0</b>								2.Refusal	5.Estimate	8.
Wet Basement	<b>2 Damp Basement</b>								3.Informed	6.Reviewed	9.
1.Dry	4.	7.							<b>Information Code 1 Owner</b>		
2.Damp	5.	8.	1.Owner	4.Agent	7.						
3.Wet	6.	9.	2.Relative	5.Estimate	8.						
			3.Tenant	6.Other	9.						

Date Inspected 11/12/2018

### Additions, Outbuildings & Improvements

Type	Year	Units	Grade	Cond	Phys.	Funct.	Sound Value
23 Frame Garage	1970	552	3 100	5	0 %	80 %	
					%	%	
					%	%	
					%	%	
					%	%	
					%	%	
					%	%	
					%	%	
					%	%	
					%	%	
					%	%	

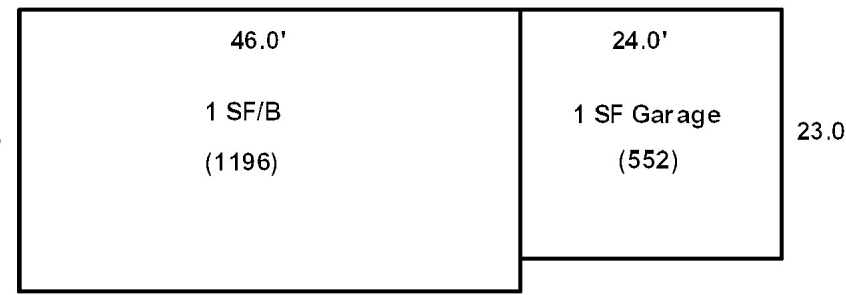

LaGASSE, RANDY R  
 LaGASSE, JODALE L  
 15 PORTER STREET  
 WASHBURN ME 04786

B5196P38

Previous Owner  
 Sjoberg, Craig C.  
 Sjoberg, Betty  
 15 Porter Street  
 Washburn ME 04786  
 Sale Date: 5/21/2013

Inspection Witnessed By:

No./Date	Description	Date Insp.
X		

Notes:

\*1-29-2019 -20% for attached garage and shed.

Washburn

Property Data			Assessment Record				
Neighborhood <b>1 Neighborhood One</b>			Year	Land	Buildings	Exempt	Total
Tree Growth Year <b>0</b>			2009	5,000	70,300	9,000	66,300
1ST MORTGAGE <b>0</b>			2012	5,000	70,300	8,800	66,500
2ND MORTGAGE <b>0</b>			2013	6,600	70,300	0	76,900
Zone/Land Use <b>1 Residential</b>			2015	6,600	70,300	9,000	67,900
Secondary Zone			2018	6,600	70,300	18,400	58,500
Topography <b>1 Level</b>			2019	11,600	66,400	20,000	58,000
1.Level 4.Below St 7.LevelBog			2020	11,600	65,600	25,000	52,200
2.Rolling 5.Low 8.			2021	11,600	66,400	25,000	53,000
3.Above St 6.Swampy 9.			2022	11,600	69,700	25,000	56,300
Utilities <b>2 Public Water 3 Public Sewer</b>							
1.Public 4.Dr Well 7.Cesspool							
2.Water 5.Dug Well 8.							
3.Sewer 6.Septic 9.None							
Street <b>1 Paved</b>							
1.Paved 4.Proposed 7.							
2.Semi Imp 5.R/O/W 8.							
3.Gravel 6. 9.None							
TG PLAN YEAR <b>0</b>							
Tif District # <b>0</b>							
Sale Data							
Sale Date <b>5/21/2013</b>							
Price <b>69,000</b>							
Sale Type <b>2 Land &amp; Buildings</b>							
1.Land 4.Mobile 7.C/I L&B							
2.L & B 5.Other 8.							
3.Building 6.C/I Land 9.							
Financing <b>1 Conventional</b>							
1.Convent 4.Seller 7.							
2.FHA/VA 5.Private 8.							
3.Assumed 6.Cash 9.Unknown							
Validity <b>1 Arms Length Sale</b>							
1.Valid 4.Split 7.Renovate							
2.Related 5.Partial 8.Other							
3.Distress 6.Exempt 9.							
Verified <b>5 Public Record</b>							
1.Buyer 4.Agent 7.Family							
2.Seller 5.Pub Rec 8.Other							
3.Lender 6.MLS 9.							

Land Data						
Front Foot	Type	Effective		Influence		Influence Codes
		Frontage	Depth	Factor	Code	
11.Regular Lot				%		1.Unimproved
12.Delta Triangle				%		2.Excess Frtg
13.Nabla Triangle				%		3.Topography
14.Rear Land				%		4.Size/Shape
15.Class I Road				%		5.Access
				%		6.Restriction
				%		7.Open Space
				%		8.View/Environ
				%		9.Fract Share
Square Foot		Square Feet				Acres
16.Class II Road	29	900		75	%	0
17.Municipal Rese				%		30.Utility R O W
18.Munic Sep Lago				%		31.Tillable
19.Gravel Pit				%		32.Pasture
20.Industrial Bas				%		33.Orchard
				%		34.Software F&O
				%		35.Mixed Wood F&O
				%		36.Hardwood F&O
				%		37.Software TG
				%		38.Mixed Wood TG
				%		39.Hardwood TG
				%		40.Wasteland
				%		41.Open Space
				%		42.Mobile Home Si
				%		43.Condo Site
				%		44.Lot Improvemen
				%		45.Subdivision Lo
				%		46.Heavy Ind Sit
<b>Total Acreage</b>				0.36		

### Washburn

Map Lot 012-077

Account 834

Location 15 PORTER STREET

Card 1

Of 1

12/09/2022

Building Style	<b>2 Ranch</b>			SF Bsmt Living	<b>0</b>			Layout	<b>1 Typical</b>		
1.Conv.	5.Garrison	9.Gambrel		Fin Bsmt Grade	<b>0 0</b>			1.Typical	4.	7.	
2.Ranch	6.Salt Box	10.Other		OPEN 5 OPTIONAL	<b>0</b>			2.Inadeq	5.	8.	
3.R Ranch	7.Contemp	11.Split		Heat Type	<b>100% 5 Forced Warm Air</b>			3.Poor	6.	9.	
4.Cape	8.Log	12.		1.HWBB	5.FWA	9.No Heat	Attic	<b>9 None</b>			
Dwelling Units	<b>1</b>			2.HWCI	6.GravWA	10.	1.1/4 Fin	4.Full Fin	7.		
Other Units	<b>0</b>			3.H Pump	7.Electric	11.	2.1/2 Fin	5.F/Stair	8.		
Stories	<b>1 One Story</b>			4.Steam	8.F/Wall	12.	3.3/4 Fin	6.	9.None		
1.1	4.1.5	7.		Cool Type	<b>0% 9 None</b>			Insulation	<b>1 Full</b>		
2.2	5.1.75	8.		1.Refrig	4.W&C Air	7.	1.Full	4.Minimal	7.		
3.3	6.2.5	9.		2.Evapor	5.	8.	2.Heavy	5.Partial	8.		
Exterior Walls	<b>4 Asbestos Siding</b>			3.H Pump	6.	9.None	3.Capped	6.	9.None		
1.Wood	5.Stucco	9.T-111		Kitchen Style	<b>2 Typical</b>			Unfinished %	<b>0%</b>		
2.Vin/Al	6.Brick	10.Other		1.Modern	4.Obsolete	7.	Grade & Factor	<b>3 Average 100%</b>			
3.Compos.	7.Stone	11.		2.Typical	5.	8.	1.E Grade	4.B Grade	7.		
4.Asbestos	8.Concrete	12.		3.Old Type	6.	9.None	2.D Grade	5.A Grade	8.SC Grade		
Roof Surface	<b>1 Asphalt Shingles</b>			Bath(s) Style	<b>2 Typical Bath(s)</b>			3.C Grade	6.AA Grade	9.Same	
1.Asphalt	4.Composit	7.		1.Modern	4.Obsolete	7.	SQFT (Footprint)	<b>1196</b>			
2.Slate	5.Wood	8.		2.Typical	5.	8.	Condition	<b>5 Above Average</b>			
3.Metal	6.Other	9.		3.Old Type	6.	9.None	1.Poor	4.Avg	7.V G		
SF Masonry Trim	<b>0</b>			# Rooms	<b>6</b>			2.Fair	5.Avg+	8.Exc	
OPEN-3-CUSTOM	<b>0</b>			# Bedrooms	<b>3</b>			3.Avg-	6.Good	9.Same	
OPEN-4-CUSTOM	<b>0</b>			# Full Baths	<b>2</b>			Phys. % Good	<b>0%</b>		
Year Built	<b>1970</b>			# Half Baths	<b>0</b>			Funct. % Good	<b>100%</b>		
Year Remodeled	<b>0</b>			# Addn Fixtures	<b>0</b>			Functional Code	<b>9 None</b>		
Foundation	<b>1 Concrete</b>			# Fireplaces	<b>1</b>			1.Incomp	4.Delap	7.No Power	
1.Concrete	4.Wood	7.		 <p><b>TRIO</b> Software A Division of Harris Computer Systems</p>	2.O-Built	5.Bsmt	8.LongTerm				
2.C Block	5.Slab	8.	3.Damage		6.Common	9.None					
3.Br/Stone	6.Piers	9.	Econ. % Good		<b>100%</b>						
Basement	<b>4 Full Basement</b>				Economic Code	<b>None</b>					
1.1/4 Bmt	4.Full Bmt	7.	0.None		3.No Power	7.					
2.1/2 Bmt	5.None	8.	1.Location		4.Generate	8.					
3.3/4 Bmt	6.	9.None	2.Encroach		9.None	9.					
Bsmt Gar # Cars	<b>0</b>				Entrance Code	<b>1 Interior Inspect</b>					
Wet Basement	<b>2 Damp Basement</b>				1.Interior	4.Vacant	7.				
1.Dry	4.	7.	2.Refusal		5.Estimate	8.					
2.Damp	5.	8.	3.Informed	6.Reviewed	9.						
3.Wet	6.	9.	Information Code	<b>1 Owner</b>							
			1.Owner	4.Agent	7.						
			2.Relative	5.Estimate	8.						
			3.Tenant	6.Other	9.						

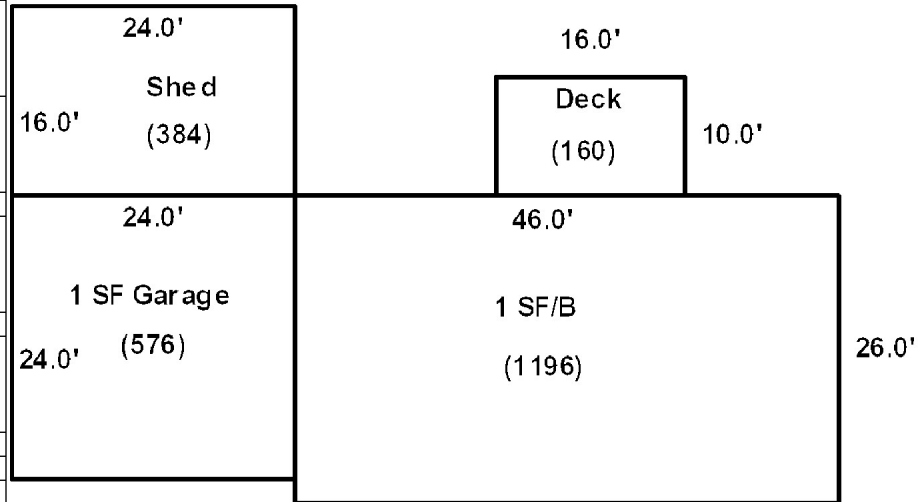

Date Inspected 11/12/2018

#### Additions, Outbuildings & Improvements

Type	Year	Units	Grade	Cond	Phys.	Funct.	Sound Value
23 Frame Garage	1970	576	3 100	4	0 %	80 %	
68 Wood Deck	1990	160	3 95	4	0 %	100 %	
24 Frame Shed	1970	384	3 90	4	0 %	80 %	
					%	%	
					%	%	
					%	%	
					%	%	
					%	%	
					%	%	
					%	%	
					%	%	
					%	%	





## Washburn

Map Lot 012-078

Account 170

Location 5 PORTER STREET

Card 1 Of 1 12/09/2022

Building Style	<b>2 Ranch</b>		SF Bsmt Living	<b>0</b>		Layout	<b>1 Typical</b>							
1.Conv.	5.Garrison	9.Gambrel	Fin Bsmt Grade	<b>0 0</b>		1.Typical	4.	7.						
2.Ranch	6.Salt Box	10.Other	OPEN 5 OPTIONAL	<b>0</b>		2.Inadeq	5.	8.						
3.R Ranch	7.Contemp	11.Split	Heat Type	<b>100% 5 Forced Warm Air</b>		3.Poor	6.	9.						
4.Cape	8.Log	12.	1.HWBB	5.FWA	9.No Heat	Attic	<b>9 None</b>							
Dwelling Units	<b>1</b>		2.HWCI	6.GravWA	10.	1.1/4 Fin	4.Full Fin	7.						
Other Units	<b>0</b>		3.H Pump	7.Electric	11.	2.1/2 Fin	5.FI/Stair	8.						
Stories	<b>1 One Story</b>		4.Steam	8.FI/Wall	12.	3.3/4 Fin	6.	9.None						
1.1	4.1.5	7.	Cool Type	<b>0% 9 None</b>		Insulation	<b>1 Full</b>							
2.2	5.1.75	8.	1.Refrig	4.W&C Air	7.	1.Full	4.Minimal	7.						
3.3	6.2.5	9.	2.Evapor	5.	8.	2.Heavy	5.Partial	8.						
Exterior Walls	<b>4 Asbestos Siding</b>		3.H Pump	6.	9.None	3.Capped	6.	9.None						
1.Wood	5.Stucco	9.T-111	Kitchen Style	<b>2 Typical</b>		Unfinished %	<b>0%</b>							
2.Vin/Al	6.Brick	10.Other	1.Modern	4.Obsolete	7.	Grade & Factor	<b>3 Average 100%</b>							
3.Compos.	7.Stone	11.	2.Typical	5.	8.	1.E Grade	4.B Grade	7.						
4.Asbestos	8.Concrete	12.	3.Old Type	6.	9.None	2.D Grade	5.A Grade	8.SC Grade						
Roof Surface	<b>1 Asphalt Shingles</b>		Bath(s) Style	<b>2 Typical Bath(s)</b>		3.C Grade	6.AA Grade	9.Same						
1.Asphalt	4.Composit	7.	1.Modern	4.Obsolete	7.	SQFT (Footprint)	<b>1040</b>							
2.Slate	5.Wood	8.	2.Typical	5.	8.	Condition	<b>5 Above Average</b>							
3.Metal	6.Other	9.	3.Old Type	6.	9.None	1.Poor	4.Avg	7.V G						
SF Masonry Trim	<b>0</b>		# Rooms	<b>5</b>		2.Fair	5.Avg+	8.Exc						
OPEN-3-CUSTOM	<b>0</b>		# Bedrooms	<b>3</b>		3.Avg-	6.Good	9.Same						
OPEN-4-CUSTOM	<b>0</b>		# Full Baths	<b>1</b>		Phys. % Good	<b>0%</b>							
Year Built	<b>1970</b>		# Half Baths	<b>0</b>		Funct. % Good	<b>100%</b>							
Year Remodeled	<b>0</b>		# Addn Fixtures	<b>0</b>		Functional Code	<b>9 None</b>							
Foundation	<b>1 Concrete</b>		# Fireplaces	<b>0</b>		1.Incomp	4.Delap	7.No Power						
1.Concrete	4.Wood	7.							2.O-Built	5.Bsmt	8.LongTerm			
2.C Block	5.Slab	8.							Economic Code	<b>None</b>		3.Damage	6.Common	9.None
3.Br/Stone	6.Piers	9.							0.None	3.No Power	7.	Econ. % Good	<b>100%</b>	
Basement	<b>4 Full Basement</b>								1.Location	4.Generate	8.	Entrance Code	<b>5 Estimated</b>	
1.1/4 Bmt	4.Full Bmt	7.							2.Encroach	9.None	9.	1.Interior	4.Vacant	7.
2.1/2 Bmt	5.None	8.							Information Code	<b>5 Estimate</b>		2.Refusal	5.Estimate	8.
3.3/4 Bmt	6.	9.None							1.Owner	4.Agent	7.	3.Informed	6.Reviewed	9.
Bsmt Gar # Cars	<b>0</b>								2.Relative	5.Estimate	8.	Information Code	<b>5 Estimate</b>	
Wet Basement	<b>1 Dry Basement</b>								3.Tenant	6.Other	9.	1.Owner	4.Agent	7.
1.Dry	4.	7.												
2.Damp	5.	8.							3.Tenant	6.Other	9.			
3.Wet	6.	9.												

Date Inspected 11/12/2018

### Additions, Outbuildings & Improvements

Type	Year	Units	Grade	Cond	Phys.	Funct.	Sound Value
23 Frame Garage	1970	576	3 100	4	0 %	80 %	
40 Basement Entry	1970	25	9 100	9	0 %	100 %	
24 Frame Shed	1990	256	3 100	4	0 %	80 %	
22 Encl Frame Porch	1990	200	3 100	4	0 %	100 %	
					%	%	
					%	%	
					%	%	
					%	%	
					%	%	
					%	%	
					%	%	

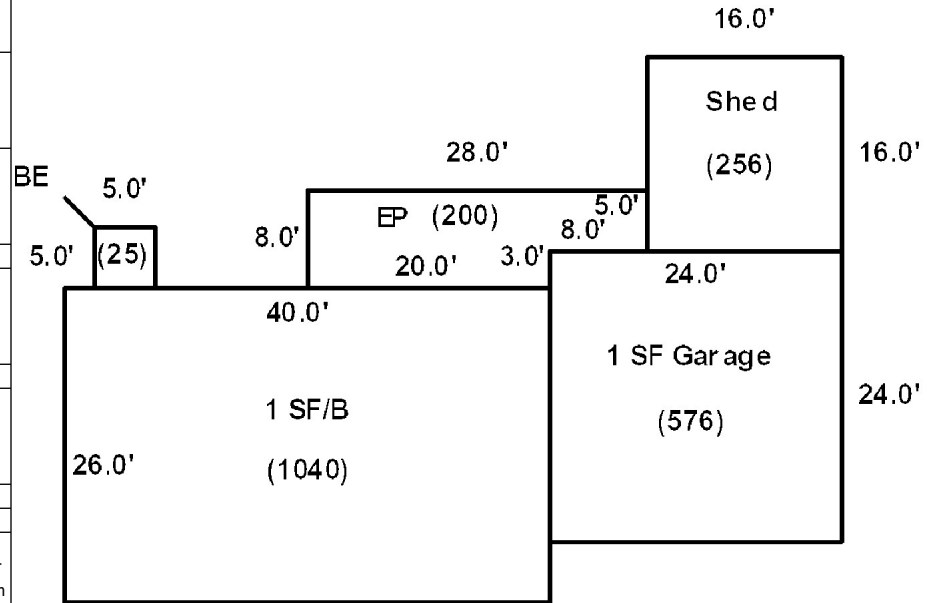



## Washburn

Map Lot 012-079

Account 490

Location 9 PORTER STREET

Card 1 Of 1 12/09/2022

Building Style	<b>3 Raised Ranch</b>			SF Bsmt Living	<b>300</b>			Layout	<b>1 Typical</b>		
1.Conv.	5.Garrison	9.Gambrel		Fin Bsmt Grade	<b>3 100</b>			1.Typical	4.	7.	
2.Ranch	6.Salt Box	10.Other		OPEN 5 OPTIONAL	<b>0</b>			2.Inadeq	5.	8.	
3.R Ranch	7.Contemp	11.Split		Heat Type	<b>100% 1 Hot Water BB</b>			3.Poor	6.	9.	
4.Cape	8.Log	12.		1.HWBB	5.FWA	9.No Heat	Attic	<b>9 None</b>			
Dwelling Units	<b>1</b>			2.HWCI	6.GravWA	10.	1.1/4 Fin	4.Full Fin	7.		
Other Units	<b>0</b>			3.H Pump	7.Electric	11.	2.1/2 Fin	5.FI/Stair	8.		
Stories	<b>1 One Story</b>			4.Steam	8.FI/Wall	12.	3.3/4 Fin	6.	9.None		
1.1	4.1.5	7.		Cool Type	<b>0% 9 None</b>			Insulation	<b>1 Full</b>		
2.2	5.1.75	8.		1.Refrig	4.W&C Air	7.	1.Full	4.Minimal	7.		
3.3	6.2.5	9.		2.Evapor	5.	8.	2.Heavy	5.Partial	8.		
Exterior Walls	<b>4 Asbestos Siding</b>			3.H Pump	6.	9.None	3.Capped	6.	9.None		
1.Wood	5.Stucco	9.T-111		Kitchen Style	<b>2 Typical</b>			Unfinished %	<b>0%</b>		
2.Vin/Al	6.Brick	10.Other		1.Modern	4.Obsolete	7.	Grade & Factor	<b>3 Average 110%</b>			
3.Compos.	7.Stone	11.		2.Typical	5.	8.	1.E Grade	4.B Grade	7.		
4.Asbestos	8.Concrete	12.		3.Old Type	6.	9.None	2.D Grade	5.A Grade	8.SC Grade		
Roof Surface	<b>3 Sheet Metal</b>			Bath(s) Style	<b>2 Typical Bath(s)</b>			3.C Grade	6.AA Grade	9.Same	
1.Asphalt	4.Composit	7.		1.Modern	4.Obsolete	7.	SQFT (Footprint)	<b>814</b>			
2.Slate	5.Wood	8.		2.Typical	5.	8.	Condition	<b>6 Good</b>			
3.Metal	6.Other	9.		3.Old Type	6.	9.None	1.Poor	4.Avg	7.V G		
SF Masonry Trim	<b>0</b>			# Rooms	<b>7</b>			2.Fair	5.Avg+	8.Exc	
OPEN-3-CUSTOM	<b>0</b>			# Bedrooms	<b>4</b>			3.Avg-	6.Good	9.Same	
OPEN-4-CUSTOM	<b>0</b>			# Full Baths	<b>1</b>			Phys. % Good	<b>0%</b>		
Year Built	<b>1970</b>			# Half Baths	<b>1</b>			Funct. % Good	<b>100%</b>		
Year Remodeled	<b>0</b>			# Addn Fixtures	<b>0</b>			Functional Code	<b>9 None</b>		
Foundation	<b>1 Concrete</b>			# Fireplaces	<b>0</b>			1.Incomp	4.Delap	7.No Power	
1.Concrete	4.Wood	7.		 <p><b>TRIO</b> Software <small>A Division of Harris Computer Systems</small></p>	2.O-Built	5.Bsmt	8.LongTerm	Econ. % Good	<b>100%</b>		
2.C Block	5.Slab	8.			3.Damage	6.Common	9.None	Economic Code	<b>None</b>		
3.Br/Stone	6.Piers	9.			Economic Code	<b>None</b>			0.None	3.No Power	7.
Basement	<b>4 Full Basement</b>				Entrance Code	<b>5 Estimated</b>			1.Location	4.Generate	8.
1.1/4 Bmt	4.Full Bmt	7.			1.Interior	4.Vacant	7.	2.Encroach	9.None	9.	
2.1/2 Bmt	5.None	8.			2.Refusal	5.Estimate	8.	Information Code	<b>5 Estimate</b>		
3.3/4 Bmt	6.	9.None			3.Informed	6.Reviewed	9.	1.Owner	4.Agent	7.	
Bsmt Gar # Cars	<b>0</b>				2.Relative	5.Estimate	8.	2.Relative	5.Estimate	8.	
Wet Basement	<b>1 Dry Basement</b>				3.Tenant	6.Other	9.	3.Tenant	6.Other	9.	
1.Dry	4.	7.									
2.Damp	5.	8.									
3.Wet	6.	9.									

Date Inspected 11/12/2018

### Additions, Outbuildings & Improvements

Type	Year	Units	Grade	Cond	Phys.	Funct.	Sound Value
26 1SFr Overhang	1970	62	9 100	9	0 %	100 %	
24 Frame Shed	0				%	%	2,000
					%	%	
					%	%	
					%	%	
					%	%	
					%	%	
					%	%	
					%	%	
					%	%	
					%	%	
					%	%	

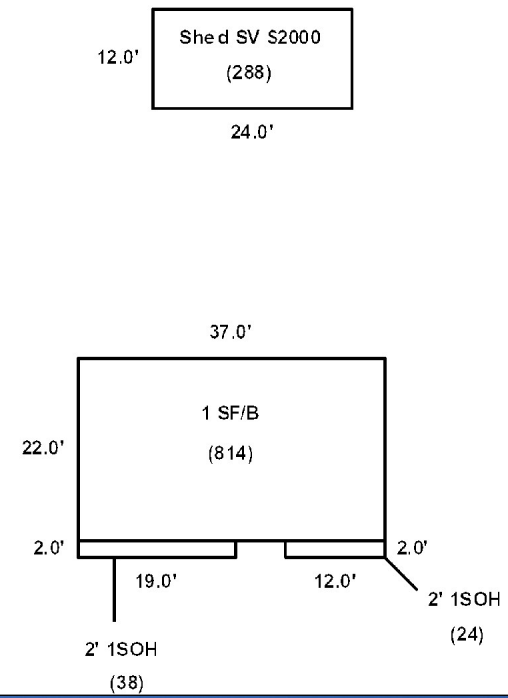





## Washburn

Map Lot 012-080

Account 447

Location 3 PORTER STREET

Card 1

Of 1

12/09/2022

Building Style <b>11 Split</b>	SF Bsmt Living <b>384</b>	Layout <b>1 Typical</b>
1.Conv. 5.Garrison 9.Gambrel	Fin Bsmt Grade <b>3 100</b>	1.Typical 4. 7.
2.Ranch 6.Salt Box 10.Other	OPEN 5 OPTIONAL <b>0</b>	2.Inadeq 5. 8.
3.R Ranch 7.Contemp 11.Split	Heat Type <b>100% 1 Hot Water BB</b>	3.Poor 6. 9.
4.Cape 8.Log 12.	1.HWB 5.FWA 9.No Heat	Attic <b>9 None</b>
Dwelling Units <b>1</b>	2.HWCI 6.GravWA 10.	1.1/4 Fin 4.Full Fin 7.
Other Units <b>0</b>	3.H Pump 7.Electric 11.	2.1/2 Fin 5.FI/Stair 8.
Stories <b>1 One Story</b>	4.Steam 8.FI/Wall 12.	3.3/4 Fin 6. 9.None
1.1 4.1.5 7.	Cool Type <b>0% 9 None</b>	Insulation <b>4 Minimal</b>
2.2 5.1.75 8.	1.Refrig 4.W&C Air 7.	1.Full 4.Minimal 7.
3.3 6.2.5 9.	2.Evapor 5. 8.	2.Heavy 5.Partial 8.
Exterior Walls <b>2 Vinyl/Aluminum</b>	3.H Pump 6. 9.None	3.Capped 6. 9.None
1.Wood 5.Stucco 9.T-111	Kitchen Style <b>2 Typical</b>	Unfinished % <b>0%</b>
2.Vin/Al 6.Brick 10.Other	1.Modern 4.Obsolete 7.	Grade & Factor <b>3 Average 105%</b>
3.Compos. 7.Stone 11.	2.Typical 5. 8.	1.E Grade 4.B Grade 7.
4.Asbestos 8.Concrete 12.	3.Old Type 6. 9.None	2.D Grade 5.A Grade 8.SC Grade
Roof Surface <b>1 Asphalt Shingles</b>	Bath(s) Style <b>2 Typical Bath(s)</b>	3.C Grade 6.AA Grade 9.Same
1.Asphalt 4.Composit 7.	1.Modern 4.Obsolete 7.	SQFT (Footprint) <b>720</b>
2.Slate 5.Wood 8.	2.Typical 5. 8.	Condition <b>6 Good</b>
3.Metal 6.Other 9.	3.Old Type 6. 9.None	1.Poor 4.Avg 7.V G
SF Masonry Trim <b>0</b>	# Rooms <b>4</b>	2.Fair 5.Avg+ 8.Exc
OPEN-3-CUSTOM <b>0</b>	# Bedrooms <b>3</b>	3.Avg- 6.Good 9.Same
OPEN-4-CUSTOM <b>0</b>	# Full Baths <b>2</b>	Phys. % Good <b>0%</b>
Year Built <b>1975</b>	# Half Baths <b>0</b>	Funct. % Good <b>100%</b>
Year Remodeled <b>0</b>	# Addn Fixtures <b>0</b>	Functional Code <b>9 None</b>
Foundation <b>1 Concrete</b>	# Fireplaces <b>1</b>	1.Incomp 4.Delap 7.No Power
1.Concrete 4.Wood 7.		2.O-Built 5.Bsmt 8.LongTerm
2.C Block 5.Slab 8.		3.Damage 6.Common 9.None
3.Br/Stone 6.Piers 9.		Econ. % Good <b>100%</b>
Basement <b>4 Full Basement</b>		Economic Code <b>None</b>
1.1/4 Bmt 4.Full Bmt 7.		0.None 3.No Power 7.
2.1/2 Bmt 5.None 8.		1.Location 4.Generate 8.
3.3/4 Bmt 6. 9.None		2.Encroach 9.None 9.
Bsmt Gar # Cars <b>1</b>		Entrance Code <b>1 Interior Inspect</b>
Wet Basement <b>2 Damp Basement</b>		1.Interior 4.Vacant 7.
1.Dry 4. 7.		2.Refusal 5.Estimate 8.
2.Damp 5. 8.		3.Informed 6.Reviewed 9.
3.Wet 6. 9.		Information Code <b>1 Owner</b>
		1.Owner 4.Agent 7.
		2.Relative 5.Estimate 8.
		3.Tenant 6.Other 9.

Date Inspected 11/12/2018

### Additions, Outbuildings & Improvements

Type	Year	Units	Grade	Cond	Phys.	Funct.	Sound Value
20 1 Story/Bsmt	1975	572	3 90	4	0 %	100 %	
68 Wood Deck	2020	263	3 110	4	0 %	100 %	
					%	%	
					%	%	
					%	%	
					%	%	
					%	%	
					%	%	
					%	%	
					%	%	
					%	%	

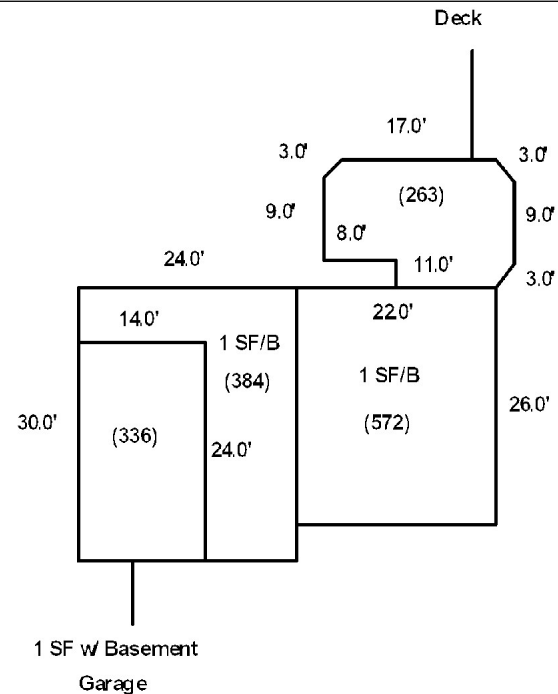



## Washburn

Map Lot 012-081

Account 433

Location 12 BERCE STREET

Card 1 Of 1 12/09/2022

Building Style	<b>2 Ranch</b>			SF Bsmt Living	<b>0</b>			Layout	<b>1 Typical</b>		
1.Conv.	5.Garrison	9.Gambrel		Fin Bsmt Grade	<b>0 0</b>			1.Typical	4.	7.	
2.Ranch	6.Salt Box	10.Other		OPEN 5 OPTIONAL	<b>0</b>			2.Inadeq	5.	8.	
3.R Ranch	7.Contemp	11.Split		Heat Type	<b>100% 7 Electric</b>			3.Poor	6.	9.	
4.Cape	8.Log	12.		1.HWBB	5.FWA	9.No Heat	Attic	<b>9 None</b>			
Dwelling Units	<b>1</b>			2.HWCI	6.GravWA	10.	1.1/4 Fin	4.Full Fin	7.		
Other Units	<b>0</b>			3.H Pump	7.Electric	11.	2.1/2 Fin	5.F/Stair	8.		
Stories	<b>1 One Story</b>			4.Steam	8.F/Wall	12.	3.3/4 Fin	6.	9.None		
1.1	4.1.5	7.		Cool Type	<b>0% 9 None</b>			Insulation	<b>1 Full</b>		
2.2	5.1.75	8.		1.Refrig	4.W&C Air	7.	1.Full	4.Minimal	7.		
3.3	6.2.5	9.		2.Evapor	5.	8.	2.Heavy	5.Partial	8.		
Exterior Walls	<b>1 Wood Siding</b>			3.H Pump	6.	9.None	3.Capped	6.	9.None		
1.Wood	5.Stucco	9.T-111		Kitchen Style	<b>2 Typical</b>			Unfinished %	<b>0%</b>		
2.Vin/Al	6.Brick	10.Other		1.Modern	4.Obsolete	7.	Grade & Factor	<b>3 Average 90%</b>			
3.Compos.	7.Stone	11.		2.Typical	5.	8.	1.E Grade	4.B Grade	7.		
4.Asbestos	8.Concrete	12.		3.Old Type	6.	9.None	2.D Grade	5.A Grade	8.SC Grade		
Roof Surface	<b>1 Asphalt Shingles</b>			Bath(s) Style	<b>2 Typical Bath(s)</b>			3.C Grade	6.AA Grade	9.Same	
1.Asphalt	4.Composit	7.		1.Modern	4.Obsolete	7.	SQFT (Footprint)	<b>1120</b>			
2.Slate	5.Wood	8.		2.Typical	5.	8.	Condition	<b>3 Below Average</b>			
3.Metal	6.Other	9.		3.Old Type	6.	9.None	1.Poor	4.Avg	7.V G		
SF Masonry Trim	<b>0</b>			# Rooms	<b>5</b>			2.Fair	5.Avg+	8.Exc	
OPEN-3-CUSTOM	<b>0</b>			# Bedrooms	<b>3</b>			3.Avg-	6.Good	9.Same	
OPEN-4-CUSTOM	<b>0</b>			# Full Baths	<b>1</b>			Phys. % Good	<b>0%</b>		
Year Built	<b>1964</b>			# Half Baths	<b>0</b>			Funct. % Good	<b>100%</b>		
Year Remodeled	<b>0</b>			# Addn Fixtures	<b>0</b>			Functional Code	<b>9 None</b>		
Foundation	<b>1 Concrete</b>			# Fireplaces	<b>0</b>			1.Incomp	4.Delap	7.No Power	
1.Concrete	4.Wood	7.									
2.C Block	5.Slab	8.									
3.Br/Stone	6.Piers	9.									
Basement	<b>4 Full Basement</b>										
1.1/4 Bmt	4.Full Bmt	7.									
2.1/2 Bmt	5.None	8.									
3.3/4 Bmt	6.	9.None									
Bsmt Gar # Cars	<b>0</b>										
Wet Basement	<b>2 Damp Basement</b>										
1.Dry	4.	7.									
2.Damp	5.	8.									
3.Wet	6.	9.									
Date Inspected				5/01/2019				Econ. % Good <b>100%</b>			
								Economic Code <b>None</b>			
								0.None 3.No Power 7.			
								1.Location 4.Generate 8.			
								2.Encroach 9.None 9.			
								Entrance Code <b>1 Interior Inspect</b>			
								1.Interior 4.Vacant 7.			
								2.Refusal 5.Estimate 8.			
								3.Informed 6.Reviewed 9.			
								Information Code <b>1 Owner</b>			
								1.Owner 4.Agent 7.			
								2.Relative 5.Estimate 8.			
								3.Tenant 6.Other 9.			

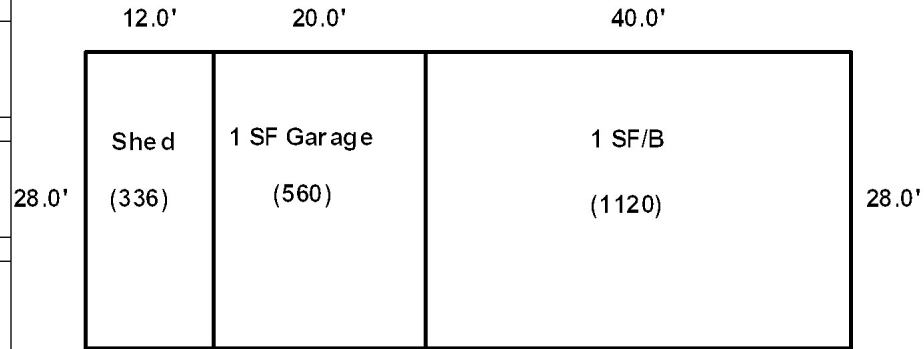

Additions, Outbuildings & Improvements							
Type	Year	Units	Grade	Cond	Phys.	Funct.	Sound Value
23 Frame Garage	1965	560	3 95	3	0 %	80 %	
24 Frame Shed	1967	336	2 115	3	0 %	80 %	
					%	%	
					%	%	
					%	%	
					%	%	
					%	%	
					%	%	
					%	%	
					%	%	
					%	%	





## Washburn

Map Lot 012-082

Account 708

Location 10 Porter Street

Card 1 Of 1 12/09/2022

Building Style	<b>2 Ranch</b>		SF Bsmt Living	<b>200</b>		Layout	<b>1 Typical</b>							
1.Conv.	5.Garrison	9.Gambrel	Fin Bsmt Grade	<b>3 100</b>		1.Typical	4.	7.						
2.Ranch	6.Salt Box	10.Other	OPEN 5 OPTIONAL	<b>0</b>		2.Inadeq	5.	8.						
3.R Ranch	7.Contemp	11.Split	Heat Type	<b>100% 1 Hot Water BB</b>		3.Poor	6.	9.						
4.Cape	8.Log	12.	1.HWBB	5.FWA	9.No Heat	Attic	<b>9 None</b>							
Dwelling Units	<b>1</b>		2.HWCI	6.GravWA	10.	1.1/4 Fin	4.Full Fin	7.						
Other Units	<b>0</b>		3.H Pump	7.Electric	11.	2.1/2 Fin	5.FI/Stair	8.						
Stories	<b>1 One Story</b>		4.Steam	8.FI/Wall	12.	3.3/4 Fin	6.	9.None						
1.1	4.1.5	7.	Cool Type	<b>50% 3 Heat Pump</b>		Insulation	<b>1 Full</b>							
2.2	5.1.75	8.	1.Refrig	4.W&C Air	7.	1.Full	4.Minimal	7.						
3.3	6.2.5	9.	2.Evapor	5.	8.	2.Heavy	5.Partial	8.						
Exterior Walls	<b>2 Vinyl/Aluminum</b>		3.H Pump	6.	9.None	3.Capped	6.	9.None						
1.Wood	5.Stucco	9.T-111	Kitchen Style	<b>2 Typical</b>		Unfinished %	<b>0%</b>							
2.Vin/Al	6.Brick	10.Other	1.Modern	4.Obsolete	7.	Grade & Factor	<b>3 Average 115%</b>							
3.Compos.	7.Stone	11.	2.Typical	5.	8.	1.E Grade	4.B Grade	7.						
4.Asbestos	8.Concrete	12.	3.Old Type	6.	9.None	2.D Grade	5.A Grade	8.SC Grade						
Roof Surface	<b>1 Asphalt Shingles</b>		Bath(s) Style	<b>2 Typical Bath(s)</b>		3.C Grade	6.AA Grade	9.Same						
1.Asphalt	4.Composit	7.	1.Modern	4.Obsolete	7.	SQFT (Footprint)	<b>1772</b>							
2.Slate	5.Wood	8.	2.Typical	5.	8.	Condition	<b>6 Good</b>							
3.Metal	6.Other	9.	3.Old Type	6.	9.None	1.Poor	4.Avg	7.V G						
SF Masonry Trim	<b>200</b>		# Rooms	<b>6</b>		2.Fair	5.Avg+	8.Exc						
OPEN-3-CUSTOM	<b>0</b>		# Bedrooms	<b>3</b>		3.Avg-	6.Good	9.Same						
OPEN-4-CUSTOM	<b>0</b>		# Full Baths	<b>2</b>		Phys. % Good	<b>0%</b>							
Year Built	<b>1977</b>		# Half Baths	<b>0</b>		Funcnt. % Good	<b>100%</b>							
Year Remodeled	<b>0</b>		# Addn Fixtures	<b>0</b>		Functional Code	<b>9 None</b>							
Foundation	<b>1 Concrete</b>		# Fireplaces	<b>0</b>		1.Incomp	4.Delap	7.No Power						
1.Concrete	4.Wood	7.							2.O-Built	5.Bsmt	8.LongTerm			
2.C Block	5.Slab	8.							Econ. % Good	<b>100%</b>		3.Damage	6.Common	9.None
3.Br/Stone	6.Piers	9.							Economic Code	<b>None</b>		0.None	3.No Power	7.
Basement	<b>4 Full Basement</b>								1.Location	4.Generate	8.	1.Encroach	9.None	9.
1.1/4 Bmt	4.Full Bmt	7.							Entrance Code	<b>5 Estimated</b>		1.Interior	4.Vacant	7.
2.1/2 Bmt	5.None	8.							1.Refusal	5.Estimate	8.	2.Informed	6.Reviewed	9.
3.3/4 Bmt	6.	9.None							Information Code	<b>5 Estimate</b>		1.Owner	4.Agent	7.
Bsmt Gar # Cars	<b>0</b>								2.Relative	5.Estimate	8.	3.Tenant	6.Other	9.
Wet Basement	<b>1 Dry Basement</b>													
1.Dry	4.	7.												
2.Damp	5.	8.												
3.Wet	6.	9.												

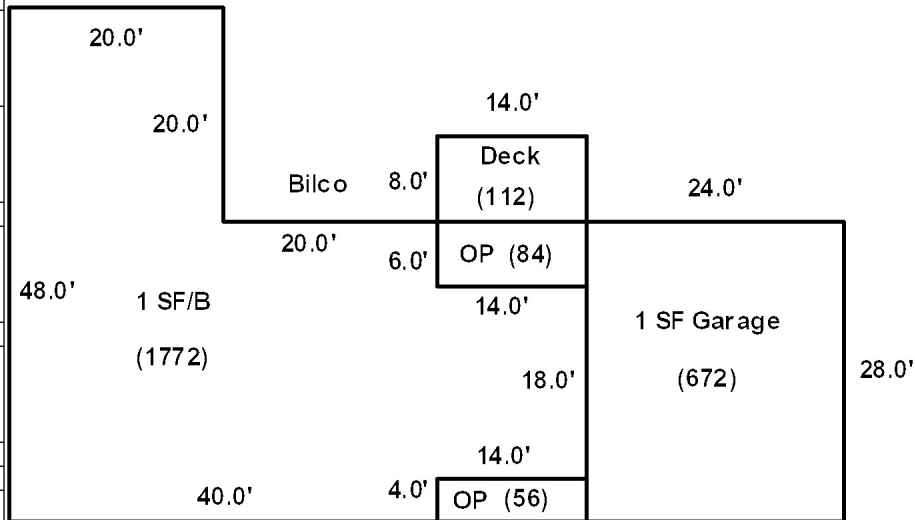

Date Inspected 11/12/2018

### Additions, Outbuildings & Improvements

Type	Year	Units	Grade	Cond	Phys.	Funcnt.	Sound Value
21 Open Frame	1970	56	3 100	6	0 %	100 %	
23 Frame Garage	1970	672	3 100	6	0 %	80 %	
21 Open Frame	1970	84	3 100	6	0 %	100 %	
68 Wood Deck	2000	112	3 100	4	0 %	100 %	
					%	%	
					%	%	
					%	%	
					%	%	
					%	%	
					%	%	
					%	%	











## Washburn

Map Lot 012-085

Account 91

Location 22 PORTER STREET

Card 1 Of 1 12/09/2022

Building Style <b>2 Ranch</b>	SF Bsmt Living <b>0</b>	Layout <b>1 Typical</b>
1.Conv. 5.Garrison 9.Gambrel	Fin Bsmt Grade <b>0 0</b>	1.Typical 4. 7.
2.Ranch 6.Salt Box 10.Other	OPEN 5 OPTIONAL <b>0</b>	2.Inadeq 5. 8.
3.R Ranch 7.Contemp 11.Split	Heat Type <b>100% 1 Hot Water BB</b>	3.Poor 6. 9.
4.Cape 8.Log 12.	1.HWBB 5.FWA 9.No Heat	Attic <b>9 None</b>
Dwelling Units <b>1</b>	2.HWCI 6.GravWA 10.	1.1/4 Fin 4.Full Fin 7.
Other Units <b>0</b>	3.H Pump 7.Electric 11.	2.1/2 Fin 5.F/ Stair 8.
Stories <b>1 One Story</b>	4.Steam 8.F/ Wall 12.	3.3/4 Fin 6. 9.None
1.1 4.1.5 7.	Cool Type <b>0% 9 None</b>	Insulation <b>1 Full</b>
2.2 5.1.75 8.	1.Refrig 4.W&C Air 7.	1.Full 4.Minimal 7.
3.3 6.2.5 9.	2.Evapor 5. 8.	2.Heavy 5.Partial 8.
Exterior Walls <b>1 Wood Siding</b>	3.H Pump 6. 9.None	3.Capped 6. 9.None
1.Wood 5.Stucco 9.T-111	Kitchen Style <b>2 Typical</b>	Unfinished % <b>0%</b>
2.Vin/Al 6.Brick 10.Other	1.Modern 4.Obsolete 7.	Grade & Factor <b>3 Average 110%</b>
3.Compos. 7.Stone 11.	2.Typical 5. 8.	1.E Grade 4.B Grade 7.
4.Asbestos 8.Concrete 12.	3.Old Type 6. 9.None	2.D Grade 5.A Grade 8.SC Grade
Roof Surface <b>1 Asphalt Shingles</b>	Bath(s) Style <b>2 Typical Bath(s)</b>	3.C Grade 6.AA Grade 9.Same
1.Asphalt 4.Composit 7.	1.Modern 4.Obsolete 7.	SQFT (Footprint) <b>1210</b>
2.Slate 5.Wood 8.	2.Typical 5. 8.	Condition <b>6 Good</b>
3.Metal 6.Other 9.	3.Old Type 6. 9.None	1.Poor 4.Avg 7.V G
SF Masonry Trim <b>100</b>	# Rooms <b>4</b>	2.Fair 5.Avg+ 8.Exc
OPEN-3-CUSTOM <b>0</b>	# Bedrooms <b>2</b>	3.Avg- 6.Good 9.Same
OPEN-4-CUSTOM <b>0</b>	# Full Baths <b>1</b>	Phys. % Good <b>0%</b>
Year Built <b>1975</b>	# Half Baths <b>1</b>	Funct. % Good <b>100%</b>
Year Remodeled <b>0</b>	# Addn Fixtures <b>0</b>	Functional Code <b>9 None</b>
Foundation <b>1 Concrete</b>	# Fireplaces <b>1</b>	1.Incomp 4.Delap 7.No Power
1.Concrete 4.Wood 7.		2.O-Built 5.Bsmt 8.LongTerm
2.C Block 5.Slab 8.		3.Damage 6.Common 9.None
3.Br/Stone 6.Piers 9.		Econ. % Good <b>100%</b>
Basement <b>4 Full Basement</b>		Economic Code <b>None</b>
1.1/4 Bmt 4.Full Bmt 7.		0.None 3.No Power 7.
2.1/2 Bmt 5.None 8.		1.Location 4.Generate 8.
3.3/4 Bmt 6. 9.None		2.Encroach 9.None 9.
Bsmt Gar # Cars <b>0</b>		Entrance Code <b>1 Interior Inspect</b>
Wet Basement <b>1 Dry Basement</b>		1.Interior 4.Vacant 7.
1.Dry 4. 7.		2.Refusal 5.Estimate 8.
2.Damp 5. 8.		3.Informed 6.Reviewed 9.
3.Wet 6. 9.		Information Code <b>1 Owner</b>
		1.Owner 4.Agent 7.
		2.Relative 5.Estimate 8.
		3.Tenant 6.Other 9.

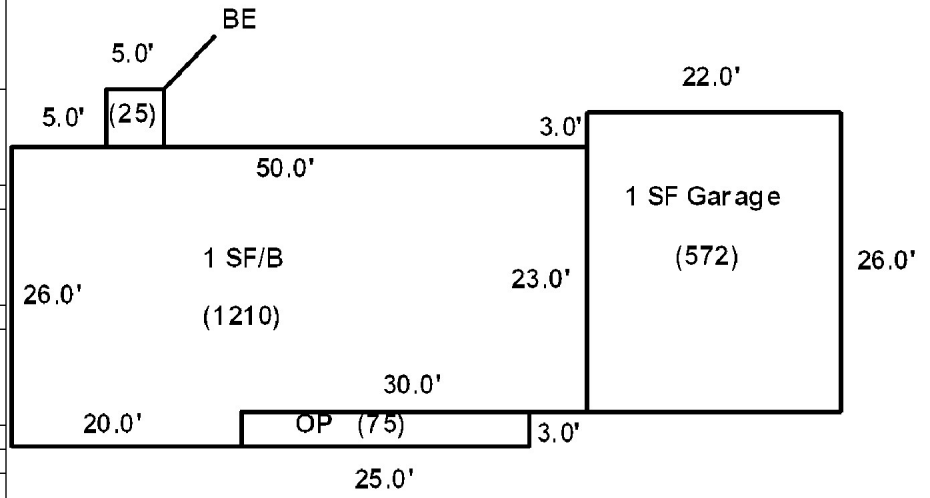

Date Inspected 11/12/2018

### Additions, Outbuildings & Improvements

Type	Year	Units	Grade	Cond	Phys.	Funct.	Sound Value
21 Open Frame	1975	75	3 100	5	0 %	100 %	
23 Frame Garage	1975	572	3 100	4	0 %	85 %	
40 Basement Entry	1975	25	9 100	9	0 %	100 %	
					%	%	
					%	%	
					%	%	
					%	%	
					%	%	
					%	%	
					%	%	
					%	%	



Town of Washburn  
1287 MAIN STREET  
WASHBURN ME 04786

			Property Data			Assessment Record												
			Neighborhood	1 Neighborhood One		Year	Land	Buildings	Exempt	Total								
			Tree Growth Year		0	2009	1,300	0	1,300	0								
			1ST MORTGAGE		0	2012	1,300	0	1,300	0								
			2ND MORTGAGE		0	2013	1,600	0	1,600	0								
			Zone/Land Use		1 Residential			2015	1,600	0	1,600	0						
			Secondary Zone			2018	1,600	0	1,600	0								
			Topography		1 Level			2019	3,400	0	3,400	0						
			1.Level		4.Below St	7.LevelBog	2020	3,400	0	3,400	0							
			2.Rolling		5.Low	8.	2021	3,400	0	3,400	0							
			3.Above St		6.Swampy	9.	2022	3,400	0	3,400	0							
			Utilities															
			1.Public		4.Dr Well	7.Cesspool												
			2.Water		5.Dug Well	8.												
			3.Sewer		6.Septic	9.None												
			Street		1 Paved													
			1.Paved		4.Proposed	7.	<b>Land Data</b>											
			2.Semi Imp		5.R/O/W	8.												
			3.Gravel		6.	9.None	<b>Front Foot</b>		<b>Type</b>		<b>Effective</b>		<b>Influence</b>		<b>Influence Codes</b>			
			TG PLAN YEAR		0			11.Regular Lot				Frontage		Depth		Factor		Code
Inspection Witnessed By:			Tif District #		0			12.Delta Triangle								1.Unimproved		
			<b>Sale Data</b>						13.Nabla Triangle								2.Excess Frtg	
X			Sale Date					14.Rear Land								3.Topography		
			Price					15.Class I Road										4.Size/Shape
No./Date			Description		Date Insp.			16.Class II Road								5.Access		
			Sale Type					17.Municipal Rese										6.Restriction
			1.Land		4.Mobile	7.C/I L&B	18.Munic Sep Lago										7.Open Space	
			2.L & B		5.Other	8.	19.Gravel Pit										8.View/Environ	
			3.Building		6.C/I Land	9.	20.Industrial Bas										9.Fract Share	
			Financing						21.Developed Pave									
Notes:			1.Convent		4.Seller	7.	22.Undev Paved (F										31.Tillable	
			2.FHA/VA		5.Private	8.	23.Developed Grav											
			3.Assumed		6.Cash	9.Unknown	24.Undev Gravel (										33.Orchard	
			Validity						25.Comm Base Pave									
			1.Valid		4.Split	7.Renovate	26.Comm Base Grav										35.Mixed Wood F&O	
			2.Related		5.Partial	8.Other	27.Backlot											
			3.Distress		6.Exempt	9.	28.Rear Land										37.Softwood TG	
			Verified						29.Pavement									
			1.Buyer		4.Agent	7.Family											39.Hardwood TG	
			2.Seller		5.Pub Rec	8.Other												
			3.Lender		6.MLS	9.											41.Open Space	
			Total Acreage			0.14												

**Washburn**

Map Lot 012-090

Account 937

Location Main Street

Card 1 Of 1 12/09/2022

Building Style <b>0</b>	SF Bsmt Living <b>0</b>	Layout <b>0</b>
1.Conv. 5.Garrison 9.Gambrel	Fin Bsmt Grade <b>0 0</b>	1.Typical 4. 7.
2.Ranch 6.Salt Box 10.Other	OPEN 5 OPTIONAL <b>0</b>	2.Inadeq 5. 8.
3.R Ranch 7.Contemp 11.Split	Heat Type <b>100% 0</b>	3.Poor 6. 9.
4.Cape 8.Log 12.	1.HWBB 5.FWA 9.No Heat	Attic <b>0</b>
Dwelling Units <b>0</b>	2.HWCI 6.GravWA 10.	1.1/4 Fin 4.Full Fin 7.
Other Units <b>0</b>	3.H Pump 7.Electric 11.	2.1/2 Fin 5.FI/Stair 8.
Stories <b>0</b>	4.Steam 8.FI/Wall 12.	3.3/4 Fin 6. 9.None
1.1 4.1.5 7.	Cool Type <b>0% 9 None</b>	Insulation <b>0</b>
2.2 5.1.75 8.	1.Refrig 4.W&C Air 7.	1.Full 4.Minimal 7.
3.3 6.2.5 9.	2.Evapor 5. 8.	2.Heavy 5.Partial 8.
Exterior Walls <b>0</b>	3.H Pump 6. 9.None	3.Capped 6. 9.None
1.Wood 5.Stucco 9.T-111	Kitchen Style <b>0</b>	Unfinished % <b>0%</b>
2.Vin/Al 6.Brick 10.Other	1.Modern 4.Obsolete 7.	Grade & Factor <b>0 0%</b>
3.Compos. 7.Stone 11.	2.Typical 5. 8.	1.E Grade 4.B Grade 7.
4.Asbestos 8.Concrete 12.	3.Old Type 6. 9.None	2.D Grade 5.A Grade 8.SC Grade
Roof Surface <b>0</b>	Bath(s) Style <b>0</b>	3.C Grade 6.AA Grade 9.Same
1.Asphalt 4.Composit 7.	1.Modern 4.Obsolete 7.	SQFT (Footprint) <b>0</b>
2.Slate 5.Wood 8.	2.Typical 5. 8.	Condition <b>0</b>
3.Metal 6.Other 9.	3.Old Type 6. 9.None	1.Poor 4.Avg 7.V G
SF Masonry Trim <b>0</b>	# Rooms <b>0</b>	2.Fair 5.Avg+ 8.Exc
OPEN-3-CUSTOM <b>0</b>	# Bedrooms <b>0</b>	3.Avg- 6.Good 9.Same
OPEN-4-CUSTOM <b>0</b>	# Full Baths <b>0</b>	Phys. % Good <b>0%</b>
Year Built <b>0</b>	# Half Baths <b>0</b>	Funct. % Good <b>100%</b>
Year Remodeled <b>0</b>	# Addn Fixtures <b>0</b>	Functional Code <b>9 None</b>
Foundation <b>0</b>	# Fireplaces <b>0</b>	1.Incomp 4.Delap 7.No Power
1.Concrete 4.Wood 7.		2.O-Built 5.Bsmt 8.LongTerm
2.C Block 5.Slab 8.		3.Damage 6.Common 9.None
3.Br/Stone 6.Piers 9.		Econ. % Good <b>100%</b>
Basement <b>0</b>		Economic Code <b>None</b>
1.1/4 Bmt 4.Full Bmt 7.		0.None 3.No Power 7.
2.1/2 Bmt 5.None 8.		1.Location 4.Generate 8.
3.3/4 Bmt 6. 9.None		2.Encroach 9.None 9.
Bsmt Gar # Cars <b>0</b>		Entrance Code <b>0</b>
Wet Basement <b>0</b>		1.Interior 4.Vacant 7.
1.Dry 4. 7.		2.Refusal 5.Estimate 8.
2.Damp 5. 8.	3.Informed 6.Reviewed 9.	
3.Wet 6. 9.	Information Code <b>0</b>	
		1.Owner 4.Agent 7.
		2.Relative 5.Estimate 8.
		3.Tenant 6.Other 9.

Date Inspected

**Additions, Outbuildings & Improvements**

Type	Year	Units	Grade	Cond	Phys.	Funct.	Sound Value
					%	%	1.One Story Fram
					%	%	2.Two Story Fram
					%	%	3.Three Story Fr
					%	%	4.1 & 1/2 Story
					%	%	5.1 & 3/4 Story
					%	%	6.2 & 1/2 Story
					%	%	21.Open Frame Por
					%	%	22.Encl Frame Por
					%	%	23.Frame Garage
					%	%	24.Frame Shed
					%	%	25.Frame Bay Wind
					%	%	26.1SFr Overhang
					%	%	27.Unfin Basement
					%	%	28.Unfinished Att
					%	%	29.Finished Attic

BROWN, EUGENE B JR  
BROWN, LONDA Y  
PO BOX 11  
WASHBURN ME 04786

B3607P5

Inspection Witnessed By:

No./Date	Description	Date Insp.
X		

Notes:

Washburn

Property Data			Assessment Record						
Neighborhood <b>1 Neighborhood One</b>			Year	Land	Buildings	Exempt	Total		
Tree Growth Year <b>0</b>			2009	6,200	0	0	6,200		
1ST MORTGAGE <b>0</b>			2012	6,200	0	0	6,200		
2ND MORTGAGE <b>0</b>			2013	8,100	0	0	8,100		
Zone/Land Use <b>1 Residential</b>			2015	8,100	0	0	8,100		
Secondary Zone			2018	8,100	0	0	8,100		
Topography <b>1 Level</b>			2019	6,200	0	0	6,200		
1.Level 4.Below St 7.LevelBog			2020	6,200	0	0	6,200		
2.Rolling 5.Low 8.			2021	6,200	0	0	6,200		
3.Above St 6.Swampy 9.			2022	6,200	0	0	6,200		
Utilities									
1.Public 4.Dr Well 7.Cesspool									
2.Water 5.Dug Well 8.									
3.Sewer 6.Septic 9.None									
Street <b>1 Paved</b>									
1.Paved 4.Proposed 7.									
2.Semi Imp 5.R/O/W 8.									
3.Gravel 6. 9.None									
TG PLAN YEAR <b>0</b>									
Tif District # <b>0</b>									
Sale Data			<b>Land Data</b>						
Sale Date <b>11/28/2001</b>			<b>Front Foot</b>	<b>Type</b>	<b>Effective</b>		<b>Influence</b>		<b>Influence Codes</b>
Price					Frontage	Depth	Factor	Code	
Sale Type <b>1 Land Only</b>			11.Regular Lot					1.Unimproved	
1.Land 4.Mobile 7.C/I L&B			12.Delta Triangle					2.Excess Frtg	
2.L & B 5.Other 8.			13.Nabla Triangle					3.Topography	
3.Building 6.C/I Land 9.			14.Rear Land					4.Size/Shape	
Financing			15.Class I Road					5.Access	
1.Convent 4.Seller 7.								6.Restriction	
2.FHA/VA 5.Private 8.								7.Open Space	
3.Assumed 6.Cash 9.Unknown								8.View/Environ	
Validity <b>1 Arms Length Sale</b>								9.Fract Share	
1.Valid 4.Split 7.Renovate			<b>Square Foot</b>	<b>Square Feet</b>				<b>Acres</b>	
2.Related 5.Partial 8.Other			16.Class II Road					30.Utility R O W	
3.Distress 6.Exempt 9.			17.Municipal Rese					31.Tillable	
Verified <b>5 Public Record</b>			18.Munic Sep Lago					32.Pasture	
1.Buyer 4.Agent 7.Family			19.Gravel Pit					33.Orchard	
2.Seller 5.Pub Rec 8.Other			20.Industrial Bas					34.Softwood F&O	
3.Lender 6.MLS 9.			<b>Fract. Acre</b>	<b>Acres/Sites</b>				35.Mixed Wood F&O	
			21.Developed Pave	22	0.48	100	%	0	
			22.Undev Paved (F					36.Hardwood F&O	
			23.Developed Grav					37.Softwood TG	
			<b>Acres</b>					38.Mixed Wood TG	
			24.Undev Gravel (					39.Hardwood TG	
			25.Comm Base Pave					40.Wasteland	
			26.Comm Base Grav					41.Open Space	
			27.Backlot					42.Mobile Home Si	
			28.Rear Land					43.Condo Site	
			29.Pavement					44.Lot Improvemen	
				<b>Total Acreage</b>		0.48		45.Subdivision Lo	
								46.Heavy Ind Sit	

**Washburn**

Map Lot 012-095

Account 51

Location PORTER STREET

Card 1 Of 1 12/09/2022

Building Style <b>0</b>	SF Bsmt Living <b>0</b>	Layout <b>0</b>
1.Conv. 5.Garrison 9.Gambrel	Fin Bsmt Grade <b>0 0</b>	1.Typical 4. 7.
2.Ranch 6.Salt Box 10.Other	OPEN 5 OPTIONAL <b>0</b>	2.Inadeq 5. 8.
3.R Ranch 7.Contemp 11.Split	Heat Type <b>100% 0</b>	3.Poor 6. 9.
4.Cape 8.Log 12.	1.HWBB 5.FWA 9.No Heat	Attic <b>0</b>
Dwelling Units <b>0</b>	2.HWCI 6.GravWA 10.	1.1/4 Fin 4.Full Fin 7.
Other Units <b>0</b>	3.H Pump 7.Electric 11.	2.1/2 Fin 5.F/Stair 8.
Stories <b>0</b>	4.Steam 8.F/Wall 12.	3.3/4 Fin 6. 9.None
1.1 4.1.5 7.	Cool Type <b>0% 9 None</b>	Insulation <b>0</b>
2.2 5.1.75 8.	1.Refrig 4.W&C Air 7.	1.Full 4.Minimal 7.
3.3 6.2.5 9.	2.Evapor 5. 8.	2.Heavy 5.Partial 8.
Exterior Walls <b>0</b>	3.H Pump 6. 9.None	3.Capped 6. 9.None
1.Wood 5.Stucco 9.T-111	Kitchen Style <b>0</b>	Unfinished % <b>0%</b>
2.Vin/Al 6.Brick 10.Other	1.Modern 4.Obsolete 7.	Grade & Factor <b>0 0%</b>
3.Compos. 7.Stone 11.	2.Typical 5. 8.	1.E Grade 4.B Grade 7.
4.Asbestos 8.Concrete 12.	3.Old Type 6. 9.None	2.D Grade 5.A Grade 8.SC Grade
Roof Surface <b>0</b>	Bath(s) Style <b>0</b>	3.C Grade 6.AA Grade 9.Same
1.Asphalt 4.Composit 7.	1.Modern 4.Obsolete 7.	SQFT (Footprint) <b>0</b>
2.Slate 5.Wood 8.	2.Typical 5. 8.	Condition <b>0</b>
3.Metal 6.Other 9.	3.Old Type 6. 9.None	1.Poor 4.Avg 7.V G
SF Masonry Trim <b>0</b>	# Rooms <b>0</b>	2.Fair 5.Avg+ 8.Exc
OPEN-3-CUSTOM <b>0</b>	# Bedrooms <b>0</b>	3.Avg- 6.Good 9.Same
OPEN-4-CUSTOM <b>0</b>	# Full Baths <b>0</b>	Phys. % Good <b>0%</b>
Year Built <b>0</b>	# Half Baths <b>0</b>	Funct. % Good <b>100%</b>
Year Remodeled <b>0</b>	# Addn Fixtures <b>0</b>	Functional Code <b>9 None</b>
Foundation <b>0</b>	# Fireplaces <b>0</b>	1.Incomp 4.Delap 7.No Power
1.Concrete 4.Wood 7.		2.O-Built 5.Bsmt 8.LongTerm
2.C Block 5.Slab 8.		3.Damage 6.Common 9.None
3.Br/Stone 6.Piers 9.		Econ. % Good <b>100%</b>
Basement <b>0</b>		Economic Code <b>None</b>
1.1/4 Bmt 4.Full Bmt 7.		0.None 3.No Power 7.
2.1/2 Bmt 5.None 8.		1.Location 4.Generate 8.
3.3/4 Bmt 6. 9.None		2.Encroach 9.None 9.
Bsmt Gar # Cars <b>0</b>		Entrance Code <b>0</b>
Wet Basement <b>0</b>		1.Interior 4.Vacant 7.
1.Dry 4. 7.		2.Refusal 5.Estimate 8.
2.Damp 5. 8.	3.Informed 6.Reviewed 9.	
3.Wet 6. 9.	Information Code <b>0</b>	
		1.Owner 4.Agent 7.
		2.Relative 5.Estimate 8.
		3.Tenant 6.Other 9.

Date Inspected

Additions, Outbuildings & Improvements								
Type	Year	Units	Grade	Cond	Phys.	Funct.	Sound Value	
					%	%		1.One Story Fram
					%	%		2.Two Story Fram
					%	%		3.Three Story Fr
					%	%		4.1 & 1/2 Story
					%	%		5.1 & 3/4 Story
					%	%		6.2 & 1/2 Story
					%	%		21.Open Frame Por
					%	%		22.Encl Frame Por
					%	%		23.Frame Garage
					%	%		24.Frame Shed
					%	%		25.Frame Bay Wind
					%	%		26.1SFr Overhang
					%	%		27.Unfin Basement
					%	%		28.Unfinished Att
					%	%		29.Finished Attic



## Washburn

Map Lot 012-096

Account 443

Location 36 Porter Street

Card 1

Of 1

12/09/2022

Building Style <b>2 Ranch</b>	SF Bsmt Living <b>0</b>	Layout <b>1 Typical</b>
1.Conv. 5.Garrison 9.Gambrel	Fin Bsmt Grade <b>0 0</b>	1.Typical 4. 7.
2.Ranch 6.Salt Box 10.Other	OPEN 5 OPTIONAL <b>0</b>	2.Inadeq 5. 8.
3.R Ranch 7.Contemp 11.Split	Heat Type <b>100% 1 Hot Water BB</b>	3.Poor 6. 9.
4.Cape 8.Log 12.	1.HWBB 5.FWA 9.No Heat	Attic <b>9 None</b>
Dwelling Units <b>1</b>	2.HWCI 6.GravWA 10.	1.1/4 Fin 4.Full Fin 7.
Other Units <b>0</b>	3.H Pump 7.Electric 11.	2.1/2 Fin 5.FI/Stair 8.
Stories <b>1 One Story</b>	4.Steam 8.FI/Wall 12.	3.3/4 Fin 6. 9.None
1.1 4.1.5 7.	Cool Type <b>0% 9 None</b>	Insulation <b>1 Full</b>
2.2 5.1.75 8.	1.Refrig 4.W&C Air 7.	1.Full 4.Minimal 7.
3.3 6.2.5 9.	2.Evapor 5. 8.	2.Heavy 5.Partial 8.
Exterior Walls <b>2 Vinyl/Aluminum</b>	3.H Pump 6. 9.None	3.Capped 6. 9.None
1.Wood 5.Stucco 9.T-111	Kitchen Style <b>2 Typical</b>	Unfinished % <b>0%</b>
2.Vin/Al 6.Brick 10.Other	1.Modern 4.Obsolete 7.	Grade & Factor <b>4 Good 100%</b>
3.Compos. 7.Stone 11.	2.Typical 5. 8.	1.E Grade 4.B Grade 7.
4.Asbestos 8.Concrete 12.	3.Old Type 6. 9.None	2.D Grade 5.A Grade 8.SC Grade
Roof Surface <b>1 Asphalt Shingles</b>	Bath(s) Style <b>2 Typical Bath(s)</b>	3.C Grade 6.AA Grade 9.Same
1.Asphalt 4.Composit 7.	1.Modern 4.Obsolete 7.	SQFT (Footprint) <b>1624</b>
2.Slate 5.Wood 8.	2.Typical 5. 8.	Condition <b>5 Above Average</b>
3.Metal 6.Other 9.	3.Old Type 6. 9.None	1.Poor 4.Avg 7.V G
SF Masonry Trim <b>0</b>	# Rooms <b>5</b>	2.Fair 5.Avg+ 8.Exc
OPEN-3-CUSTOM <b>0</b>	# Bedrooms <b>3</b>	3.Avg- 6.Good 9.Same
OPEN-4-CUSTOM <b>0</b>	# Full Baths <b>2</b>	Phys. % Good <b>0%</b>
Year Built <b>2007</b>	# Half Baths <b>0</b>	Funct. % Good <b>100%</b>
Year Remodeled <b>0</b>	# Addn Fixtures <b>0</b>	Functional Code <b>9 None</b>
Foundation <b>1 Concrete</b>	# Fireplaces <b>0</b>	1.Incomp 4.Delap 7.No Power
1.Concrete 4.Wood 7.	 <p><b>TRIO</b> Software A Division of Harris Computer Systems</p>	2.O-Built 5.Bsmt 8.LongTerm
2.C Block 5.Slab 8.		3.Damage 6.Common 9.None
3.Br/Stone 6.Piers 9.		Econ. % Good <b>100%</b>
Basement <b>4 Full Basement</b>		Economic Code <b>None</b>
1.1/4 Bmt 4.Full Bmt 7.		0.None 3.No Power 7.
2.1/2 Bmt 5.None 8.		1.Location 4.Generate 8.
3.3/4 Bmt 6. 9.None		2.Encroach 9.None 9.
Bsmt Gar # Cars <b>0</b>		Entrance Code <b>3 Information Only</b>
Wet Basement <b>2 Damp Basement</b>		1.Interior 4.Vacant 7.
1.Dry 4. 7.		2.Refusal 5.Estimate 8.
2.Damp 5. 8.	3.Informed 6.Reviewed 9.	
3.Wet 6. 9.	Information Code <b>1 Owner</b>	
	1.Owner 4.Agent 7.	
	2.Relative 5.Estimate 8.	
	3.Tenant 6.Other 9.	

Date Inspected 11/12/2018

### Additions, Outbuildings & Improvements

Type	Year	Units	Grade	Cond	Phys.	Funct.	Sound Value
21 Open Frame	2007	48	3 100	4	0 %	100 %	
68 Wood Deck	2007	256	3 100	4	0 %	100 %	
24 Frame Shed	0				%	%	200
					%	%	
					%	%	
					%	%	
					%	%	
					%	%	
					%	%	
					%	%	
					%	%	

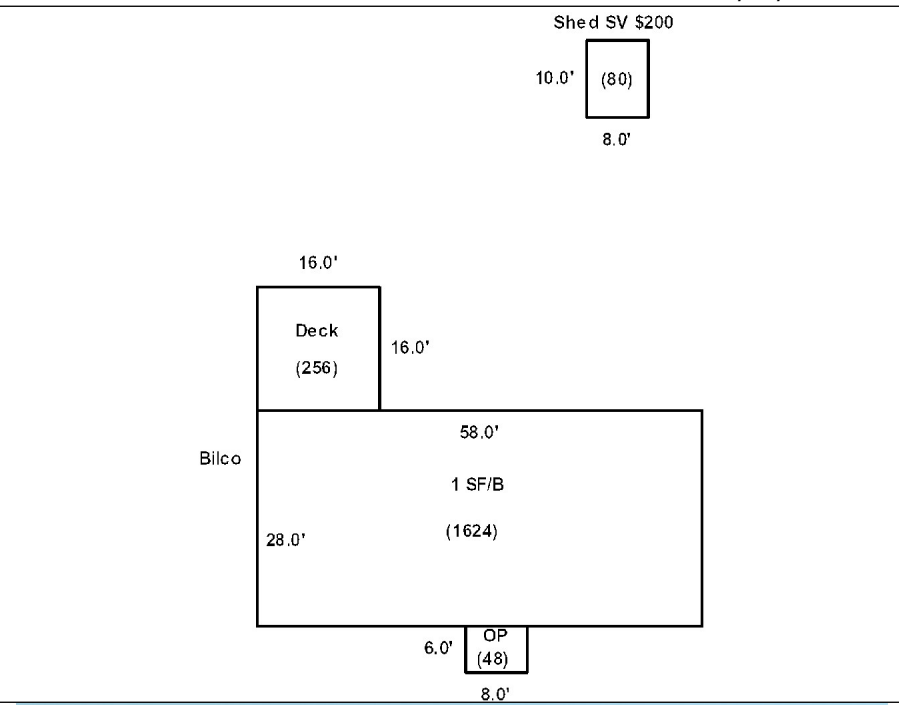



Barker, Michael  
Berube, Amy  
36 PORTER ST  
WASHBURN ME 04786  
  
B4069P105 B4165P271

Property Data			Assessment Record				
Neighborhood <b>1 Neighborhood One</b>			Year	Land	Buildings	Exempt	Total
Tree Growth Year <b>0</b>			2009	5,700	0	0	5,700
1ST MORTGAGE <b>0</b>			2012	5,700	0	0	5,700
2ND MORTGAGE <b>0</b>			2013	7,400	0	0	7,400
Zone/Land Use <b>1 Residential</b>			2015	7,400	0	0	7,400
Secondary Zone			2018	7,400	0	0	7,400
Topography <b>1 Level</b>			2019	5,800	0	0	5,800
1.Level 4.Below St 7.LevelBog			2020	5,800	0	0	5,800
2.Rolling 5.Low 8.			2021	5,800	0	0	5,800
3.Above St 6.Swampy 9.			2022	5,800	0	0	5,800
Utilities							
1.Public 4.Dr Well 7.Cesspool							
2.Water 5.Dug Well 8.							
3.Sewer 6.Septic 9.None							
Street <b>1 Paved</b>							
1.Paved 4.Proposed 7.							
2.Semi Imp 5.R/O/W 8.							
3.Gravel 6. 9.None							

Inspection Witnessed By:

X	Date
No./Date	Description
	Date Insp.

Notes:

Sale Data		
TG PLAN YEAR <b>0</b>		
Tif District # <b>0</b>		
Sale Date <b>12/23/2004</b>		
Price		
Sale Type <b>1 Land Only</b>		
1.Land 4.Mobile 7.C/I L&B		
2.L & B 5.Other 8.		
3.Building 6.C/I Land 9.		
Financing <b>1 Conventional</b>		
1.Convent 4.Seller 7.		
2.FHA/VA 5.Private 8.		
3.Assumed 6.Cash 9.Unknown		
Validity <b>1 Arms Length Sale</b>		
1.Valid 4.Split 7.Renovate		
2.Related 5.Partial 8.Other		
3.Distress 6.Exempt 9.		
Verified <b>5 Public Record</b>		
1.Buyer 4.Agent 7.Family		
2.Seller 5.Pub Rec 8.Other		
3.Lender 6.MLS 9.		

Land Data						
Front Foot	Type	Effective		Influence		Influence Codes
		Frontage	Depth	Factor	Code	
11.Regular Lot				%		1.Unimproved
12.Delta Triangle				%		2.Excess Frtg
13.Nabla Triangle				%		3.Topography
14.Rear Land				%		4.Size/Shape
15.Class I Road				%		5.Access
				%		6.Restriction
				%		7.Open Space
				%		8.View/Environ
				%		9.Fract Share
				%		<b>Acres</b>
				%		30.Utility R O W
				%		31.Tillable
				%		32.Pasture
				%		33.Orchard
				%		34.Softwood F&O
				%		35.Mixed Wood F&O
				%		36.Hardwood F&O
				%		37.Softwood TG
				%		38.Mixed Wood TG
				%		39.Hardwood TG
				%		40.Wasteland
				%		41.Open Space
				%		42.Mobile Home Si
				%		43.Condo Site
				%		44.Lot Improvemen
				%		45.Subdivision Lo
				%		46.Heavy Ind Sit
<b>Total Acreage</b>		<b>0.42</b>				

**Washburn**

Map Lot 012-097

Account 444

Location 36 Porter Street

Card 1 Of 1 12/09/2022

Building Style <b>0</b>	SF Bsmt Living <b>0</b>	Layout <b>0</b>
1.Conv. 5.Garrison 9.Gambrel	Fin Bsmt Grade <b>0 0</b>	1.Typical 4. 7.
2.Ranch 6.Salt Box 10.Other	OPEN 5 OPTIONAL <b>0</b>	2.Inadeq 5. 8.
3.R Ranch 7.Contemp 11.Split	Heat Type <b>100% 0</b>	3.Poor 6. 9.
4.Cape 8.Log 12.	1.HWBB 5.FWA 9.No Heat	Attic <b>0</b>
Dwelling Units <b>0</b>	2.HWCI 6.GravWA 10.	1.1/4 Fin 4.Full Fin 7.
Other Units <b>0</b>	3.H Pump 7.Electric 11.	2.1/2 Fin 5.F/Stair 8.
Stories <b>0</b>	4.Steam 8.F/Wall 12.	3.3/4 Fin 6. 9.None
1.1 4.1.5 7.	Cool Type <b>0% 9 None</b>	Insulation <b>0</b>
2.2 5.1.75 8.	1.Refrig 4.W&C Air 7.	1.Full 4.Minimal 7.
3.3 6.2.5 9.	2.Evapor 5. 8.	2.Heavy 5.Partial 8.
Exterior Walls <b>0</b>	3.H Pump 6. 9.None	3.Capped 6. 9.None
1.Wood 5.Stucco 9.T-111	Kitchen Style <b>0</b>	Unfinished % <b>0%</b>
2.Vin/Al 6.Brick 10.Other	1.Modern 4.Obsolete 7.	Grade & Factor <b>0 0%</b>
3.Compos. 7.Stone 11.	2.Typical 5. 8.	1.E Grade 4.B Grade 7.
4.Asbestos 8.Concrete 12.	3.Old Type 6. 9.None	2.D Grade 5.A Grade 8.SC Grade
Roof Surface <b>0</b>	Bath(s) Style <b>0</b>	3.C Grade 6.AA Grade 9.Same
1.Asphalt 4.Composit 7.	1.Modern 4.Obsolete 7.	SQFT (Footprint) <b>0</b>
2.Slate 5.Wood 8.	2.Typical 5. 8.	Condition <b>0</b>
3.Metal 6.Other 9.	3.Old Type 6. 9.None	1.Poor 4.Avg 7.V G
SF Masonry Trim <b>0</b>	# Rooms <b>0</b>	2.Fair 5.Avg+ 8.Exc
OPEN-3-CUSTOM <b>0</b>	# Bedrooms <b>0</b>	3.Avg- 6.Good 9.Same
OPEN-4-CUSTOM <b>0</b>	# Full Baths <b>0</b>	Phys. % Good <b>0%</b>
Year Built <b>0</b>	# Half Baths <b>0</b>	Funct. % Good <b>100%</b>
Year Remodeled <b>0</b>	# Addn Fixtures <b>0</b>	Functional Code <b>9 None</b>
Foundation <b>0</b>	# Fireplaces <b>0</b>	1.Incomp 4.Delap 7.No Power
1.Concrete 4.Wood 7.		2.O-Built 5.Bsmt 8.LongTerm
2.C Block 5.Slab 8.		3.Damage 6.Common 9.None
3.Br/Stone 6.Piers 9.		Econ. % Good <b>100%</b>
Basement <b>0</b>		Economic Code <b>None</b>
1.1/4 Bmt 4.Full Bmt 7.		0.None 3.No Power 7.
2.1/2 Bmt 5.None 8.		1.Location 4.Generate 8.
3.3/4 Bmt 6. 9.None		2.Encroach 9.None 9.
Bsmt Gar # Cars <b>0</b>		Entrance Code <b>0</b>
Wet Basement <b>0</b>		1.Interior 4.Vacant 7.
1.Dry 4. 7.		2.Refusal 5.Estimate 8.
2.Damp 5. 8.	3.Informed 6.Reviewed 9.	
3.Wet 6. 9.	Information Code <b>0</b>	
		1.Owner 4.Agent 7.
		2.Relative 5.Estimate 8.
		3.Tenant 6.Other 9.

Date Inspected

Additions, Outbuildings & Improvements							
Type	Year	Units	Grade	Cond	Phys.	Funct.	Sound Value
					%	%	1.One Story Fram
					%	%	2.Two Story Fram
					%	%	3.Three Story Fr
					%	%	4.1 & 1/2 Story
					%	%	5.1 & 3/4 Story
					%	%	6.2 & 1/2 Story
					%	%	21.Open Frame Por
					%	%	22.Encl Frame Por
					%	%	23.Frame Garage
					%	%	24.Frame Shed
					%	%	25.Frame Bay Wind
					%	%	26.1SFr Overhang
					%	%	27.Unfin Basement
					%	%	28.Unfinished Att
					%	%	29.Finished Attic



**Washburn**

Map Lot 012-098

Account 193

Location 62 Porter Street

Card 1 Of 1 12/09/2022

Building Style <b>0</b>	SF Bsmt Living <b>0</b>	Layout <b>0</b>
1.Conv. 5.Garrison 9.Gambrel	Fin Bsmt Grade <b>0 0</b>	1.Typical 4. 7.
2.Ranch 6.Salt Box 10.Other	OPEN 5 OPTIONAL <b>0</b>	2.Inadeq 5. 8.
3.R Ranch 7.Contemp 11.Split	Heat Type <b>100% 0</b>	3.Poor 6. 9.
4.Cape 8.Log 12.	1.HWBB 5.FWA 9.No Heat	Attic <b>0</b>
Dwelling Units <b>0</b>	2.HWCI 6.GravWA 10.	1.1/4 Fin 4.Full Fin 7.
Other Units <b>0</b>	3.H Pump 7.Electric 11.	2.1/2 Fin 5.FI/Stair 8.
Stories <b>0</b>	4.Steam 8.FI/Wall 12.	3.3/4 Fin 6. 9.None
1.1 4.1.5 7.	Cool Type <b>0% 9 None</b>	Insulation <b>0</b>
2.2 5.1.75 8.	1.Refrig 4.W&C Air 7.	1.Full 4.Minimal 7.
3.3 6.2.5 9.	2.Evapor 5. 8.	2.Heavy 5.Partial 8.
Exterior Walls <b>0</b>	3.H Pump 6. 9.None	3.Capped 6. 9.None
1.Wood 5.Stucco 9.T-111	Kitchen Style <b>0</b>	Unfinished % <b>0%</b>
2.Vin/Al 6.Brick 10.Other	1.Modern 4.Obsolete 7.	Grade & Factor <b>0 0%</b>
3.Compos. 7.Stone 11.	2.Typical 5. 8.	1.E Grade 4.B Grade 7.
4.Asbestos 8.Concrete 12.	3.Old Type 6. 9.None	2.D Grade 5.A Grade 8.SC Grade
Roof Surface <b>0</b>	Bath(s) Style <b>0</b>	3.C Grade 6.AA Grade 9.Same
1.Asphalt 4.Composit 7.	1.Modern 4.Obsolete 7.	SQFT (Footprint) <b>0</b>
2.Slate 5.Wood 8.	2.Typical 5. 8.	Condition <b>0</b>
3.Metal 6.Other 9.	3.Old Type 6. 9.None	1.Poor 4.Avg 7.V G
SF Masonry Trim <b>0</b>	# Rooms <b>0</b>	2.Fair 5.Avg+ 8.Exc
OPEN-3-CUSTOM <b>0</b>	# Bedrooms <b>0</b>	3.Avg- 6.Good 9.Same
OPEN-4-CUSTOM <b>0</b>	# Full Baths <b>0</b>	Phys. % Good <b>0%</b>
Year Built <b>0</b>	# Half Baths <b>0</b>	Funct. % Good <b>100%</b>
Year Remodeled <b>0</b>	# Addn Fixtures <b>0</b>	Functional Code <b>9 None</b>
Foundation <b>0</b>	# Fireplaces <b>0</b>	1.Incomp 4.Delap 7.No Power
1.Concrete 4.Wood 7.		2.O-Built 5.Bsmt 8.LongTerm
2.C Block 5.Slab 8.		3.Damage 6.Common 9.None
3.Br/Stone 6.Piers 9.		Econ. % Good <b>100%</b>
Basement <b>0</b>		Economic Code <b>None</b>
1.1/4 Bmt 4.Full Bmt 7.		0.None 3.No Power 7.
2.1/2 Bmt 5.None 8.		1.Location 4.Generate 8.
3.3/4 Bmt 6. 9.None		2.Encroach 9.None 9.
Bsmt Gar # Cars <b>0</b>		Entrance Code <b>0</b>
Wet Basement <b>0</b>		1.Interior 4.Vacant 7.
1.Dry 4. 7.		2.Refusal 5.Estimate 8.
2.Damp 5. 8.	3.Informed 6.Reviewed 9.	
3.Wet 6. 9.	Information Code <b>0</b>	
		1.Owner 4.Agent 7.
		2.Relative 5.Estimate 8.
		3.Tenant 6.Other 9.

Date Inspected

**Additions, Outbuildings & Improvements**

Type	Year	Units	Grade	Cond	Phys.	Funct.	Sound Value
					%	%	1.One Story Fram
					%	%	2.Two Story Fram
					%	%	3.Three Story Fr
					%	%	4.1 & 1/2 Story
					%	%	5.1 & 3/4 Story
					%	%	6.2 & 1/2 Story
					%	%	21.Open Frame Por
					%	%	22.Encl Frame Por
					%	%	23.Frame Garage
					%	%	24.Frame Shed
					%	%	25.Frame Bay Wind
					%	%	26.1SFr Overhang
					%	%	27.Unfin Basement
					%	%	28.Unfinished Att
					%	%	29.Finished Attic



# Washburn

Map Lot 012-099

Account 192

Location 62 Porter Street

Card 1

Of 1

12/09/2022

Building Style	<b>4 Cape Cod</b>		SF Bsmt Living	<b>0</b>		Layout	<b>1 Typical</b>				
1.Conv.	5.Garrison	9.Gambrel	Fin Bsmt Grade	<b>0 0</b>		1.Typical	4.	7.			
2.Ranch	6.Salt Box	10.Other	OPEN 5 OPTIONAL	<b>0</b>		2.Inadeq	5.	8.			
3.R Ranch	7.Contemp	11.Split	Heat Type	<b>100% 1 Hot Water BB</b>		3.Poor	6.	9.			
4.Cape	8.Log	12.	1.HWBB	5.FWA	9.No Heat	<b>Attic 9 None</b>					
Dwelling Units	<b>1</b>		2.HWCI	6.GravWA	10.	1.1/4 Fin	4.Full Fin	7.			
Other Units	<b>0</b>		3.H Pump	7.Electric	11.	2.1/2 Fin	5.FI/Stair	8.			
Stories	<b>4 One &amp; 1/2 Story</b>		4.Steam	8.FI/Wall	12.	3.3/4 Fin	6.	9.None			
1.1	4.1.5	7.	Cool Type	<b>0% 9 None</b>		<b>Insulation 1 Full</b>					
2.2	5.1.75	8.	1.Refrig	4.W&C Air	7.	1.Full	4.Minimal	7.			
3.3	6.2.5	9.	2.Evapor	5.	8.	2.Heavy	5.Partial	8.			
Exterior Walls	<b>2 Vinyl/Aluminum</b>		3.H Pump	6.	9.None	3.Capped	6.	9.None			
1.Wood	5.Stucco	9.T-111	Kitchen Style	<b>2 Typical</b>		<b>Unfinished % 0%</b>					
2.Vin/Al	6.Brick	10.Other	1.Modern	4.Obsolete	7.	<b>Grade &amp; Factor 3 Average 105%</b>					
3.Compos.	7.Stone	11.	2.Typical	5.	8.	1.E Grade	4.B Grade	7.			
4.Asbestos	8.Concrete	12.	3.Old Type	6.	9.None	2.D Grade	5.A Grade	8.SC Grade			
Roof Surface	<b>1 Asphalt Shingles</b>		Bath(s) Style	<b>2 Typical Bath(s)</b>		3.C Grade	6.AA Grade	9.Same			
1.Asphalt	4.Composit	7.	1.Modern	4.Obsolete	7.	<b>SQFT (Footprint) 1144</b>					
2.Slate	5.Wood	8.	2.Typical	5.	8.	<b>Condition 5 Above Average</b>					
3.Metal	6.Other	9.	3.Old Type	6.	9.None	1.Poor	4.Avg	7.V G			
SF Masonry Trim	<b>0</b>		# Rooms	<b>5</b>		2.Fair	5.Avg+	8.Exc			
OPEN-3-CUSTOM	<b>0</b>		# Bedrooms	<b>3</b>		3.Avg-	6.Good	9.Same			
OPEN-4-CUSTOM	<b>0</b>		# Full Baths	<b>1</b>		<b>Phys. % Good 0%</b>					
Year Built	<b>1989</b>		# Half Baths	<b>1</b>		<b>Funct. % Good 100%</b>					
Year Remodeled	<b>0</b>		# Addn Fixtures	<b>0</b>		<b>Functional Code 9 None</b>					
Foundation	<b>1 Concrete</b>		# Fireplaces	<b>0</b>		1.Incomp	4.Delap	7.No Power			
1.Concrete	4.Wood	7.									
2.C Block	5.Slab	8.							<b>Economic Code None</b>		
3.Br/Stone	6.Piers	9.							0.None 3.No Power 7.		
Basement	<b>4 Full Basement</b>								1.Location 4.Generate 8.		
1.1/4 Bmt	4.Full Bmt	7.							2.Encroach 9.None 9.		
2.1/2 Bmt	5.None	8.							<b>Entrance Code 1 Interior Inspect</b>		
3.3/4 Bmt	6.	9.None							1.Interior 4.Vacant 7.		
Bsmt Gar # Cars	<b>0</b>								2.Refusal 5.Estimate 8.		
Wet Basement	<b>3 Wet Basement</b>								3.Informed 6.Reviewed 9.		
1.Dry	4.	7.							<b>Information Code 1 Owner</b>		
2.Damp	5.	8.	1.Owner 4.Agent 7.								
3.Wet	6.	9.	2.Relative 5.Estimate 8.								
			3.Tenant 6.Other 9.								

Date Inspected 11/12/2018

### Additions, Outbuildings & Improvements

Type	Year	Units	Grade	Cond	Phys.	Funct.	Sound Value
68 Wood Deck	1990	80	3 90	4	0 %	100 %	
23 Frame Garage	1990	624	3 100	4	0 %	100 %	
1 One Story Frame	1989	616	9 100	9	0 %	100 %	
68 Wood Deck	2000	384	3 100	4	0 %	100 %	
62 Patio	2000	160	3 105	4	0 %	100 %	
					%	%	
					%	%	
					%	%	
					%	%	
					%	%	
					%	%	

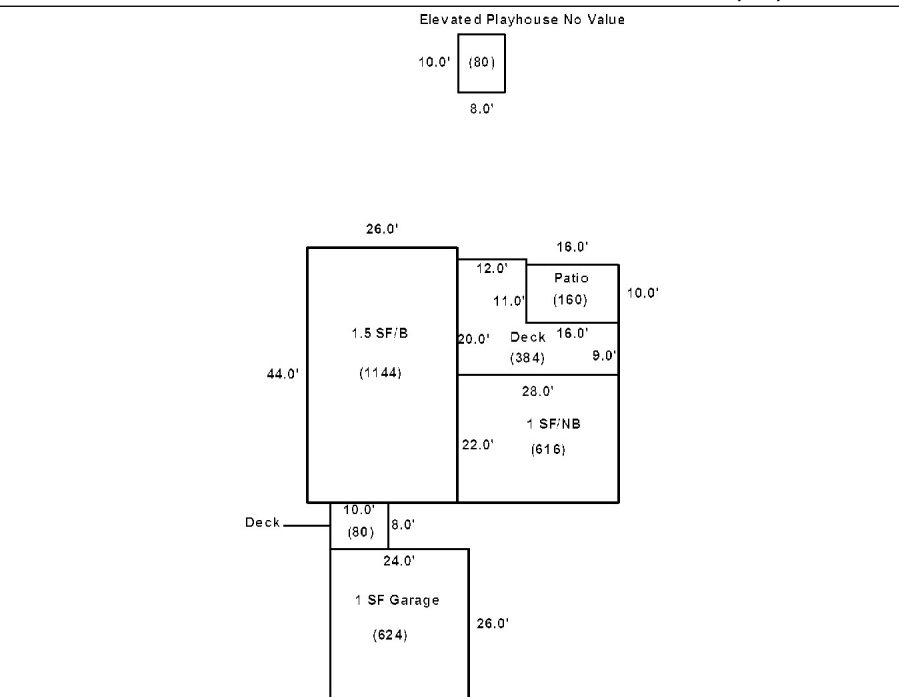



# Washburn

Map Lot 012-100

Account 755

Location 72 PORTER STREET

Card 1 Of 1 12/09/2022

Building Style	<b>2 Ranch</b>		SF Bsmt Living	<b>0</b>		Layout	<b>1 Typical</b>							
1.Conv.	5.Garrison	9.Gambrel	Fin Bsmt Grade	<b>0 0</b>		1.Typical	4.	7.						
2.Ranch	6.Salt Box	10.Other	OPEN 5 OPTIONAL	<b>0</b>		2.Inadeq	5.	8.						
3.R Ranch	7.Contemp	11.Split	Heat Type	<b>100% 1 Hot Water BB</b>		3.Poor	6.	9.						
4.Cape	8.Log	12.	1.HWB	5.FWA	9.No Heat	Attic	<b>9 None</b>							
Dwelling Units	<b>1</b>		2.HWCI	6.GravWA	10.	1.1/4 Fin	4.Full Fin	7.						
Other Units	<b>0</b>		3.H Pump	7.Electric	11.	2.1/2 Fin	5.FI/Stair	8.						
Stories	<b>1 One Story</b>		4.Steam	8.FI/Wall	12.	3.3/4 Fin	6.	9.None						
1.1	4.1.5	7.	Cool Type	<b>0% 9 None</b>		Insulation	<b>1 Full</b>							
2.2	5.1.75	8.	1.Refrig	4.W&C Air	7.	1.Full	4.Minimal	7.						
3.3	6.2.5	9.	2.Evapor	5.	8.	2.Heavy	5.Partial	8.						
Exterior Walls	<b>2 Vinyl/Aluminum</b>		3.H Pump	6.	9.None	3.Capped	6.	9.None						
1.Wood	5.Stucco	9.T-111	Kitchen Style	<b>2 Typical</b>		Unfinished %	<b>0%</b>							
2.Vin/Al	6.Brick	10.Other	1.Modern	4.Obsolete	7.	Grade & Factor	<b>3 Average 105%</b>							
3.Compos.	7.Stone	11.	2.Typical	5.	8.	1.E Grade	4.B Grade	7.						
4.Asbestos	8.Concrete	12.	3.Old Type	6.	9.None	2.D Grade	5.A Grade	8.SC Grade						
Roof Surface	<b>1 Asphalt Shingles</b>		Bath(s) Style	<b>2 Typical Bath(s)</b>		3.C Grade	6.AA Grade	9.Same						
1.Asphalt	4.Composit	7.	1.Modern	4.Obsolete	7.	SQFT (Footprint)	<b>1196</b>							
2.Slate	5.Wood	8.	2.Typical	5.	8.	Condition	<b>5 Above Average</b>							
3.Metal	6.Other	9.	3.Old Type	6.	9.None	1.Poor	4.Avg	7.V G						
SF Masonry Trim	<b>0</b>		# Rooms	<b>5</b>		2.Fair	5.Avg+	8.Exc						
OPEN-3-CUSTOM	<b>0</b>		# Bedrooms	<b>3</b>		3.Avg-	6.Good	9.Same						
OPEN-4-CUSTOM	<b>0</b>		# Full Baths	<b>1</b>		Phys. % Good	<b>0%</b>							
Year Built	<b>1975</b>		# Half Baths	<b>0</b>		Funct. % Good	<b>100%</b>							
Year Remodeled	<b>0</b>		# Addn Fixtures	<b>0</b>		Functional Code	<b>9 None</b>							
Foundation	<b>1 Concrete</b>		# Fireplaces	<b>0</b>		1.Incomp	4.Delap	7.No Power						
1.Concrete	4.Wood	7.							2.O-Built	5.Bsmt	8.LongTerm			
2.C Block	5.Slab	8.							Economic Code	<b>None</b>		3.Damage	6.Common	9.None
3.Br/Stone	6.Piers	9.							0.None	3.No Power	7.	Econ. % Good	<b>100%</b>	
Basement	<b>4 Full Basement</b>								1.Location	4.Generate	8.	Entrance Code	<b>5 Estimated</b>	
1.1/4 Bmt	4.Full Bmt	7.							2.Encroach	9.None	9.	1.Interior	4.Vacant	7.
2.1/2 Bmt	5.None	8.							Information Code	<b>5 Estimate</b>		2.Refusal	5.Estimate	8.
3.3/4 Bmt	6.	9.None							1.Owner	4.Agent	7.	3.Informed	6.Reviewed	9.
Bsmt Gar # Cars	<b>0</b>								2.Relative	5.Estimate	8.	Information Code	<b>5 Estimate</b>	
Wet Basement	<b>1 Dry Basement</b>								3.Tenant	6.Other	9.	1.Owner	4.Agent	7.
1.Dry	4.	7.												
2.Damp	5.	8.												
3.Wet	6.	9.												

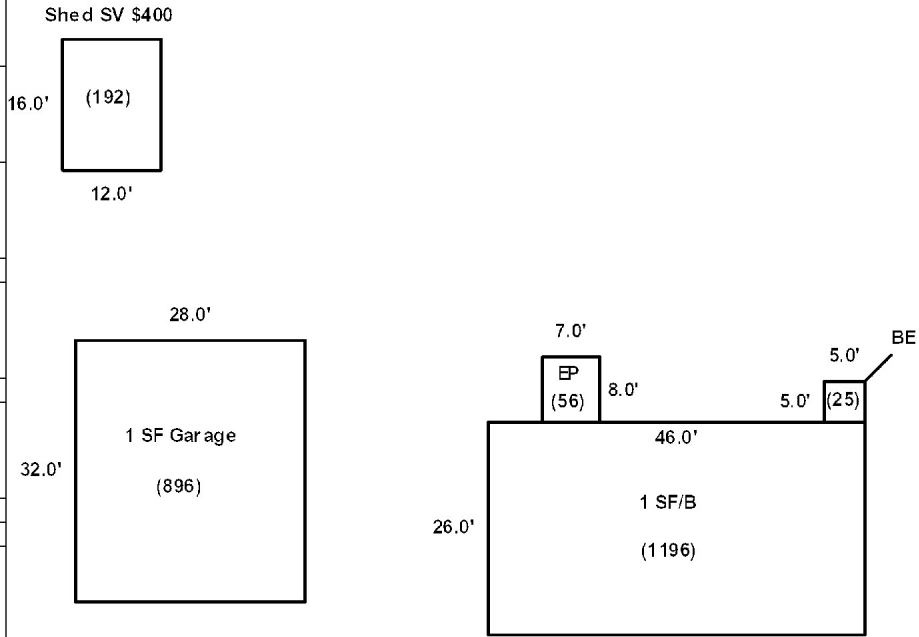

Date Inspected 11/12/2018

### Additions, Outbuildings & Improvements

Type	Year	Units	Grade	Cond	Phys.	Funct.	Sound Value
40 Basement Entry	1975	25	9 100	9	0 %	100 %	
22 Encl Frame Porch	1975	56	3 100	5	0 %	100 %	
23 Frame Garage	1975	896	3 100	4	0 %	100 %	
24 Frame Shed	0				%	%	400
					%	%	
					%	%	
					%	%	
					%	%	
					%	%	
					%	%	
					%	%	



- 1.One Story Fram
- 2.Two Story Fram
- 3.Three Story Fr
- 4.1 & 1/2 Story
- 5.1 & 3/4 Story
- 6.2 & 1/2 Story
- 21.Open Frame Por
- 22.Encl Frame Por
- 23.Frame Garage
- 24.Frame Shed
- 25.Frame Bay Wind
- 26.1SFr Overhang
- 27.Unfin Basement
- 28.Unfinished Att
- 29.Finished Attic