



## Washburn

Map Lot 012-026

Account 871

Location 1216 MAIN STREET

Card 1 Of 1 12/09/2022

Building Style <b>4 Cape Cod</b>	SF Bsmt Living <b>0</b>	Layout <b>1 Typical</b>
1.Conv. 5.Garrison 9.Gambrel	Fin Bsmt Grade <b>0 0</b>	1.Typical 4. 7.
2.Ranch 6.Salt Box 10.Other	OPEN 5 OPTIONAL <b>0</b>	2.Inadeq 5. 8.
3.R Ranch 7.Contemp 11.Split	Heat Type <b>100% 5 Forced Warm Air</b>	3.Poor 6. 9.
4.Cape 8.Log 12.	1.HWBB 5.FWA 9.No Heat	Attic <b>9 None</b>
Dwelling Units <b>1</b>	2.HWCI 6.GravWA 10.	1.1/4 Fin 4.Full Fin 7.
Other Units <b>0</b>	3.H Pump 7.Electric 11.	2.1/2 Fin 5.FI/Stair 8.
Stories <b>4 One &amp; 1/2 Story</b>	4.Steam 8.FI/Wall 12.	3.3/4 Fin 6. 9.None
1.1 4.1.5 7.	Cool Type <b>0% 9 None</b>	Insulation <b>1 Full</b>
2.2 5.1.75 8.	1.Refrig 4.W&C Air 7.	1.Full 4.Minimal 7.
3.3 6.2.5 9.	2.Evapor 5. 8.	2.Heavy 5.Partial 8.
Exterior Walls <b>2 Vinyl/Aluminum</b>	3.H Pump 6. 9.None	3.Capped 6. 9.None
1.Wood 5.Stucco 9.T-111	Kitchen Style <b>2 Typical</b>	Unfinished % <b>0%</b>
2.Vin/Al 6.Brick 10.Other	1.Modern 4.Obsolete 7.	Grade & Factor <b>2 Fair 110%</b>
3.Compos. 7.Stone 11.	2.Typical 5. 8.	1.E Grade 4.B Grade 7.
4.Asbestos 8.Concrete 12.	3.Old Type 6. 9.None	2.D Grade 5.A Grade 8.SC Grade
Roof Surface <b>1 Asphalt Shingles</b>	Bath(s) Style <b>2 Typical Bath(s)</b>	3.C Grade 6.AA Grade 9.Same
1.Asphalt 4.Composit 7.	1.Modern 4.Obsolete 7.	SQFT (Footprint) <b>852</b>
2.Slate 5.Wood 8.	2.Typical 5. 8.	Condition <b>5 Above Average</b>
3.Metal 6.Other 9.	3.Old Type 6. 9.None	1.Poor 4.Avg 7.V G
SF Masonry Trim <b>0</b>	# Rooms <b>7</b>	2.Fair 5.Avg+ 8.Exc
OPEN-3-CUSTOM <b>0</b>	# Bedrooms <b>3</b>	3.Avg- 6.Good 9.Same
OPEN-4-CUSTOM <b>0</b>	# Full Baths <b>1</b>	Phys. % Good <b>0%</b>
Year Built <b>1913</b>	# Half Baths <b>1</b>	Funct. % Good <b>100%</b>
Year Remodeled <b>0</b>	# Addn Fixtures <b>0</b>	Functional Code <b>9 None</b>
Foundation <b>2 Concrete Block</b>	# Fireplaces <b>0</b>	1.Incomp 4.Delap 7.No Power
1.Concrete 4.Wood 7.	 <p><b>TRIO</b> Software <small>A Division of Harris Computer Systems</small></p>	2.O-Built 5.Bsmt 8.LongTerm
2.C Block 5.Slab 8.		3.Damage 6.Common 9.None
3.Br/Stone 6.Piers 9.		Econ. % Good <b>100%</b>
Basement <b>4 Full Basement</b>		Economic Code <b>None</b>
1.1/4 Bmt 4.Full Bmt 7.		0.None 3.No Power 7.
2.1/2 Bmt 5.None 8.		1.Location 4.Generate 8.
3.3/4 Bmt 6. 9.None		2.Encroach 9.None 9.
Bsmt Gar # Cars <b>1</b>		Entrance Code <b>1 Interior Inspect</b>
Wet Basement <b>3 Wet Basement</b>		1.Interior 4.Vacant 7.
1.Dry 4. 7.		2.Refusal 5.Estimate 8.
2.Damp 5. 8.	3.Informed 6.Reviewed 9.	
3.Wet 6. 9.	Information Code <b>1 Owner</b>	
		1.Owner 4.Agent 7.
		2.Relative 5.Estimate 8.
		3.Tenant 6.Other 9.

Date Inspected 10/22/2018

### Additions, Outbuildings & Improvements

Type	Year	Units	Grade	Cond	Phys.	Funct.	Sound Value
20 1 Story/Bsmt	1990	520	3 100	4	0 %	100 %	
68 Wood Deck	1990	60	3 100	4	0 %	100 %	
25 Frame Bay	1990	12	3 90	4	0 %	100 %	
					%	%	
					%	%	
					%	%	
					%	%	
					%	%	
					%	%	
					%	%	
					%	%	

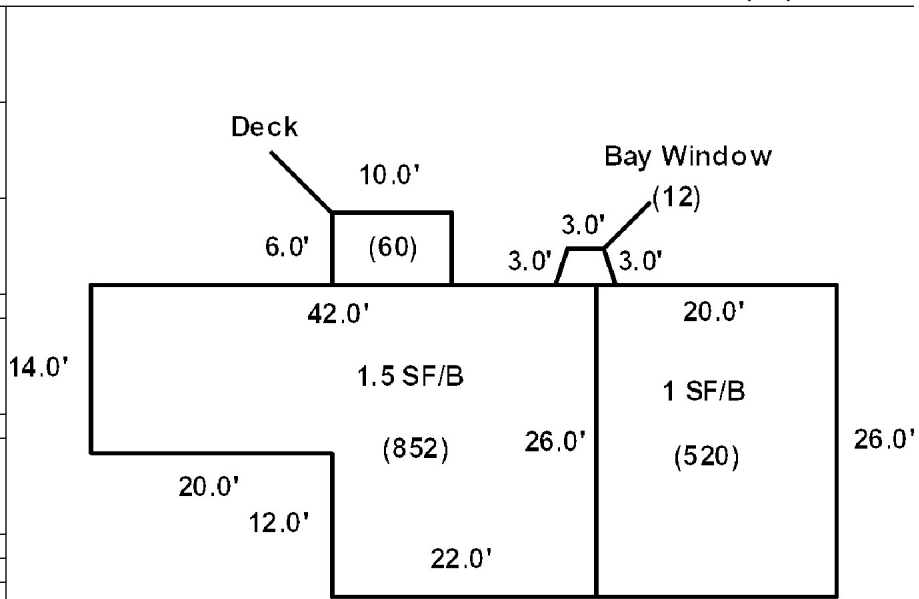







## Washburn

Map Lot 012-028

Account 92

Location 1226 Main Street

Card 1 Of 1 12/09/2022

Building Style <b>4 Cape Cod</b>	SF Bsmt Living <b>0</b>	Layout <b>1 Typical</b>	
1.Conv. 5.Garrison 9.Gambrel	Fin Bsmt Grade <b>0 0</b>	1.Typical 4. 7.	Canopy SV \$250 6.0' <span style="border: 1px solid black; padding: 2px;">(72)</span> 12.0'
2.Ranch 6.Salt Box 10.Other	OPEN 5 OPTIONAL <b>0</b>	2.Inadeq 5. 8.	
3.R Ranch 7.Contemp 11.Split	Heat Type <b>100% 5 Forced Warm Air</b>	3.Poor 6. 9.	
4.Cape 8.Log 12.	1.HWBB 5.FWA 9.No Heat	Attic <b>9 None</b>	
Dwelling Units <b>1</b>	2.HWCI 6.GravWA 10.	1.1/4 Fin 4.Full Fin 7.	
Other Units <b>0</b>	3.H Pump 7.Electric 11.	2.1/2 Fin 5.FI/Stair 8.	
Stories <b>4 One &amp; 1/2 Story</b>	4.Steam 8.FI/Wall 12.	3.3/4 Fin 6. 9.None	
1.1 4.1.5 7.	Cool Type <b>0% 9 None</b>	Insulation <b>4 Minimal</b>	
2.2 5.1.75 8.	1.Refrig 4.W&C Air 7.	1.Full 4.Minimal 7.	
3.3 6.2.5 9.	2.Evapor 5. 8.	2.Heavy 5.Partial 8.	
Exterior Walls <b>4 Asbestos Siding</b>	3.H Pump 6. 9.None	3.Capped 6. 9.None	
1.Wood 5.Stucco 9.T-111	Kitchen Style <b>2 Typical</b>	Unfinished % <b>0%</b>	
2.Vin/Al 6.Brick 10.Other	1.Modern 4.Obsolete 7.	Grade & Factor <b>3 Average 100%</b>	
3.Compos. 7.Stone 11.	2.Typical 5. 8.	1.E Grade 4.B Grade 7.	
4.Asbestos 8.Concrete 12.	3.Old Type 6. 9.None	2.D Grade 5.A Grade 8.SC Grade	
Roof Surface <b>3 Sheet Metal</b>	Bath(s) Style <b>2 Typical Bath(s)</b>	3.C Grade 6.AA Grade 9.Same	
1.Asphalt 4.Composit 7.	1.Modern 4.Obsolete 7.	SQFT (Footprint) <b>672</b>	
2.Slate 5.Wood 8.	2.Typical 5. 8.	Condition <b>5 Above Average</b>	
3.Metal 6.Other 9.	3.Old Type 6. 9.None	1.Poor 4.Avg 7.V G	
SF Masonry Trim <b>0</b>	# Rooms <b>7</b>	2.Fair 5.Avg+ 8.Exc	
OPEN-3-CUSTOM <b>0</b>	# Bedrooms <b>2</b>	3.Avg- 6.Good 9.Same	
OPEN-4-CUSTOM <b>0</b>	# Full Baths <b>1</b>	Phys. % Good <b>0%</b>	
Year Built <b>1948</b>	# Half Baths <b>0</b>	Funct. % Good <b>100%</b>	
Year Remodeled <b>0</b>	# Addn Fixtures <b>0</b>	Functional Code <b>9 None</b>	
Foundation <b>1 Concrete</b>	# Fireplaces <b>1</b>	1.Incomp 4.Delap 7.No Power	
1.Concrete 4.Wood 7.	 <p><b>TRIO</b> Software <small>A Division of Harris Computer Systems</small></p>	2.O-Built 5.Bsmt 8.LongTerm	
2.C Block 5.Slab 8.		Econ. % Good <b>100%</b>	
3.Br/Stone 6.Piers 9.		Economic Code <b>None</b>	
Basement <b>4 Full Basement</b>		0.None 3.No Power 7.	
1.1/4 Bmt 4.Full Bmt 7.		1.Location 4.Generate 8.	
2.1/2 Bmt 5.None 8.		2.Encroach 9.None 9.	
3.3/4 Bmt 6. 9.None		Entrance Code <b>1 Interior Inspect</b>	
Bsmt Gar # Cars <b>0</b>		1.Interior 4.Vacant 7.	
Wet Basement <b>2 Damp Basement</b>		2.Refusal 5.Estimate 8.	
1.Dry 4. 7.		3.Informed 6.Reviewed 9.	
2.Damp 5. 8.	Information Code <b>1 Owner</b>		
3.Wet 6. 9.	1.Owner 4.Agent 7.		
	2.Relative 5.Estimate 8.		
	3.Tenant 6.Other 9.		

Date Inspected 10/22/2018

### Additions, Outbuildings & Improvements

Type	Year	Units	Grade	Cond	Phys.	Funct.	Sound Value
68 Wood Deck	1980	84	3 100	4	0 %	100 %	
22 Encl Frame Porch	1948	144	9 100	9	0 %	100 %	
23 Frame Garage	1948	336	3 100	5	0 %	90 %	
27 Unfin Basement	1948	336	2 100	4	0 %	100 %	
61 Canopy	0				%	%	250
					%	%	
					%	%	
					%	%	
					%	%	
					%	%	
					%	%	

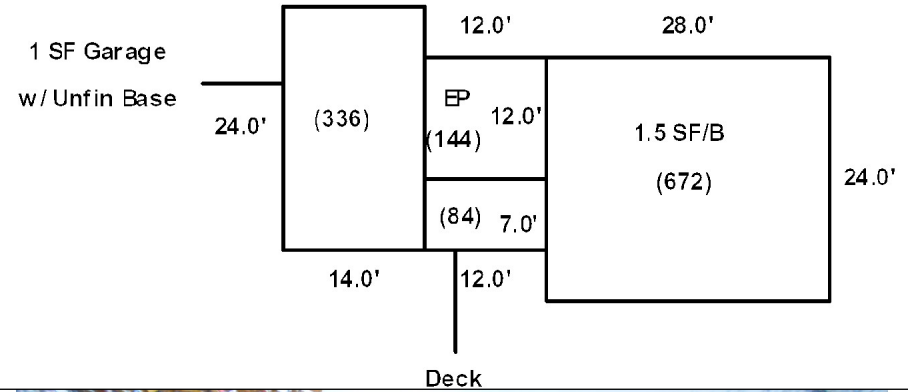



## Washburn

Map Lot 012-029

Account 370

Location 8 Thompson Street

Card 1

Of 1

12/09/2022

Building Style	<b>4 Cape Cod</b>		SF Bsmt Living	<b>0</b>		Layout	<b>1 Typical</b>		
1.Conv.	5.Garrison	9.Gambrel	Fin Bsmt Grade	<b>0 0</b>		1.Typical	4.	7.	
2.Ranch	6.Salt Box	10.Other	OPEN 5 OPTIONAL	<b>0</b>		2.Inadeq	5.	8.	
3.R Ranch	7.Contemp	11.Split	Heat Type	<b>100% 1 Hot Water BB</b>		3.Poor	6.	9.	
4.Cape	8.Log	12.	1.HWBB	5.FWA	9.No Heat	Attic	<b>9 None</b>		
Dwelling Units	<b>1</b>		2.HWCI	6.GravWA	10.	1.1/4 Fin	4.Full Fin	7.	
Other Units	<b>0</b>		3.H Pump	7.Electric	11.	2.1/2 Fin	5.FI/Stair	8.	
Stories	<b>5 One &amp; 3/4 Story</b>		4.Steam	8.FI/Wall	12.	3.3/4 Fin	6.	9.None	
1.1	4.1.5	7.	Cool Type	<b>0% 9 None</b>		Insulation	<b>1 Full</b>		
2.2	5.1.75	8.	1.Refrig	4.W&C Air	7.	1.Full	4.Minimal	7.	
3.3	6.2.5	9.	2.Evapor	5.	8.	2.Heavy	5.Partial	8.	
Exterior Walls	<b>4 Asbestos Siding</b>		3.H Pump	6.	9.None	3.Capped	6.	9.None	
1.Wood	5.Stucco	9.T-111	Kitchen Style	<b>2 Typical</b>		Unfinished %	<b>0%</b>		
2.Vin/Al	6.Brick	10.Other	1.Modern	4.Obsolete	7.	Grade & Factor	<b>3 Average 105%</b>		
3.Compos.	7.Stone	11.	2.Typical	5.	8.	1.E Grade	4.B Grade	7.	
4.Asbestos	8.Concrete	12.	3.Old Type	6.	9.None	2.D Grade	5.A Grade	8.SC Grade	
Roof Surface	<b>1 Asphalt Shingles</b>		Bath(s) Style	<b>2 Typical Bath(s)</b>		3.C Grade	6.AA Grade	9.Same	
1.Asphalt	4.Composit	7.	1.Modern	4.Obsolete	7.	SQFT (Footprint)	<b>736</b>		
2.Slate	5.Wood	8.	2.Typical	5.	8.	Condition	<b>4 Average</b>		
3.Metal	6.Other	9.	3.Old Type	6.	9.None	1.Poor	4.Avg	7.V G	
SF Masonry Trim	<b>0</b>		# Rooms	<b>6</b>		2.Fair	5.Avg+	8.Exc	
OPEN-3-CUSTOM	<b>0</b>		# Bedrooms	<b>3</b>		3.Avg-	6.Good	9.Same	
OPEN-4-CUSTOM	<b>0</b>		# Full Baths	<b>1</b>		Phys. % Good	<b>0%</b>		
Year Built	<b>1970</b>		# Half Baths	<b>1</b>		Funct. % Good	<b>100%</b>		
Year Remodeled	<b>0</b>		# Addn Fixtures	<b>0</b>		Functional Code	<b>9 None</b>		
Foundation	<b>1 Concrete</b>		# Fireplaces	<b>0</b>		1.Incomp	4.Delap	7.No Power	
1.Concrete	4.Wood	7.		2.O-Built	5.Bsmt	8.LongTerm	Economic Code	<b>None</b>	
2.C Block	5.Slab	8.		3.Damage	6.Common	9.None	0.None	3.No Power	7.
3.Br/Stone	6.Piers	9.		Econ. % Good	<b>100%</b>		1.Location	4.Generate	8.
Basement	<b>4 Full Basement</b>			Entrance Code	<b>5 Estimated</b>		2.Encroach	9.None	9.
1.1/4 Bmt	4.Full Bmt	7.		1.Interior	4.Vacant	7.	Information Code	<b>5 Estimate</b>	
2.1/2 Bmt	5.None	8.		2.Refusal	5.Estimate	8.	1.Owner	4.Agent	7.
3.3/4 Bmt	6.	9.None		3.Informed	6.Reviewed	9.	2.Relative	5.Estimate	8.
Bsmt Gar # Cars	<b>0</b>			Information Code	<b>5 Estimate</b>		3.Tenant	6.Other	9.
Wet Basement	<b>1 Dry Basement</b>			1.One Story Fram					
1.Dry	4.	7.		2.Two Story Fram					
2.Damp	5.	8.	3.Three Story Fr						
3.Wet	6.	9.	4.1 & 1/2 Story						

Date Inspected 10/27/2018

### Additions, Outbuildings & Improvements

Type	Year	Units	Grade	Cond	Phys.	Funct.	Sound Value
1 One Story Frame	1970	32	3 100	4	0 %	100 %	
21 Open Frame	1970	24	3 100	4	0 %	100 %	
62 Patio	2000	119	3 105	4	0 %	100 %	
68 Wood Deck	2000	42	3 100	4	0 %	100 %	
25 Frame Bay	1970	7	9 100	9	0 %	100 %	
23 Frame Garage	1970	480	3 100	4	0 %	85 %	
23 Frame Garage	1990	480	3 100	4	0 %	100 %	
21 Open Frame	1990	160	3 100	4	0 %	100 %	
					%	%	
					%	%	

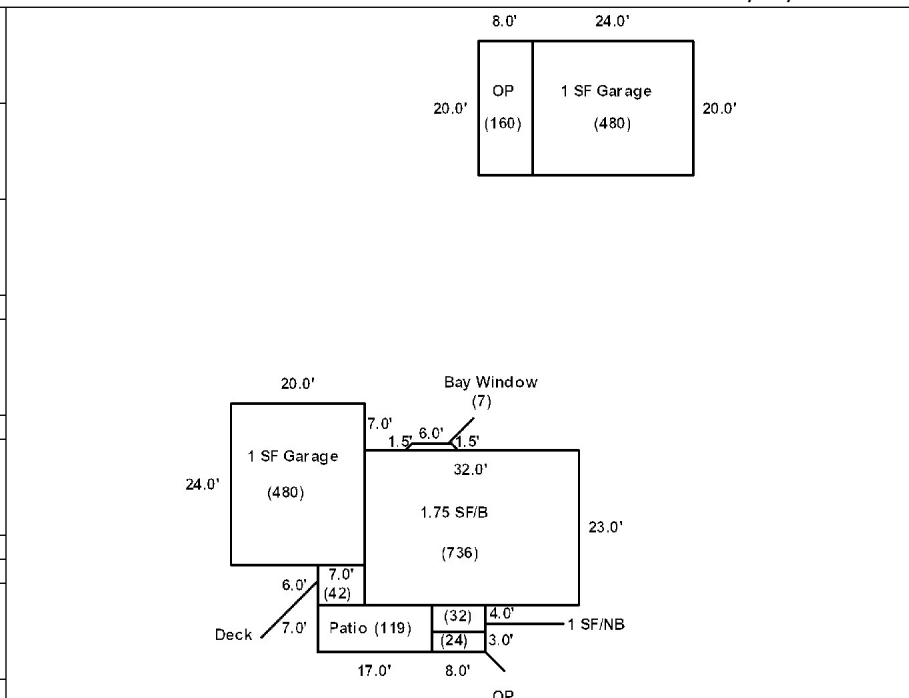





## Washburn

Map Lot 012-030

Account 779

Location 10 LORETTA LANE

Card 1 Of 1 12/09/2022

Building Style <b>2 Ranch</b>	SF Bsmt Living <b>0</b>	Layout <b>1 Typical</b>
1.Conv. 5.Garrison 9.Gambrel	Fin Bsmt Grade <b>0 0</b>	1.Typical 4. 7.
2.Ranch 6.Salt Box 10.Other	OPEN 5 OPTIONAL <b>0</b>	2.Inadeq 5. 8.
3.R Ranch 7.Contemp 11.Split	Heat Type <b>100% 1 Hot Water BB</b>	3.Poor 6. 9.
4.Cape 8.Log 12.	1.HWBB 5.FWA 9.No Heat	Attic <b>9 None</b>
Dwelling Units <b>1</b>	2.HWCI 6.GravWA 10.	1.1/4 Fin 4.Full Fin 7.
Other Units <b>0</b>	3.H Pump 7.Electric 11.	2.1/2 Fin 5.FI/Stair 8.
Stories <b>1 One Story</b>	4.Steam 8.FI/Wall 12.	3.3/4 Fin 6. 9.None
1.1 4.1.5 7.	Cool Type <b>100% 3 Heat Pump</b>	Insulation <b>1 Full</b>
2.2 5.1.75 8.	1.Refrig 4.W&C Air 7.	1.Full 4.Minimal 7.
3.3 6.2.5 9.	2.Evapor 5. 8.	2.Heavy 5.Partial 8.
Exterior Walls <b>9 T-111</b>	3.H Pump 6. 9.None	3.Capped 6. 9.None
1.Wood 5.Stucco 9.T-111	Kitchen Style <b>2 Typical</b>	Unfinished % <b>0%</b>
2.Vin/Al 6.Brick 10.Other	1.Modern 4.Obsolete 7.	Grade & Factor <b>3 Average 100%</b>
3.Compos. 7.Stone 11.	2.Typical 5. 8.	1.E Grade 4.B Grade 7.
4.Asbestos 8.Concrete 12.	3.Old Type 6. 9.None	2.D Grade 5.A Grade 8.SC Grade
Roof Surface <b>1 Asphalt Shingles</b>	Bath(s) Style <b>2 Typical Bath(s)</b>	3.C Grade 6.AA Grade 9.Same
1.Asphalt 4.Composit 7.	1.Modern 4.Obsolete 7.	SQFT (Footprint) <b>1080</b>
2.Slate 5.Wood 8.	2.Typical 5. 8.	Condition <b>6 Good</b>
3.Metal 6.Other 9.	3.Old Type 6. 9.None	1.Poor 4.Avg 7.V G
SF Masonry Trim <b>0</b>	# Rooms <b>6</b>	2.Fair 5.Avg+ 8.Exc
OPEN-3-CUSTOM <b>0</b>	# Bedrooms <b>2</b>	3.Avg- 6.Good 9.Same
OPEN-4-CUSTOM <b>0</b>	# Full Baths <b>1</b>	Phys. % Good <b>0%</b>
Year Built <b>1970</b>	# Half Baths <b>0</b>	Funct. % Good <b>100%</b>
Year Remodeled <b>0</b>	# Addn Fixtures <b>0</b>	Functional Code <b>9 None</b>
Foundation <b>1 Concrete</b>	# Fireplaces <b>0</b>	1.Incomp 4.Delap 7.No Power
1.Concrete 4.Wood 7.		2.O-Built 5.Bsmt 8.LongTerm
2.C Block 5.Slab 8.		3.Damage 6.Common 9.None
3.Br/Stone 6.Piers 9.		Econ. % Good <b>100%</b>
Basement <b>4 Full Basement</b>		Economic Code <b>None</b>
1.1/4 Bmt 4.Full Bmt 7.		0.None 3.No Power 7.
2.1/2 Bmt 5.None 8.		1.Location 4.Generate 8.
3.3/4 Bmt 6. 9.None		2.Encroach 9.None 9.
Bsmt Gar # Cars <b>0</b>		Entrance Code <b>1 Interior Inspect</b>
Wet Basement <b>1 Dry Basement</b>		1.Interior 4.Vacant 7.
1.Dry 4. 7.		2.Refusal 5.Estimate 8.
2.Damp 5. 8.	3.Informed 6.Reviewed 9.	
3.Wet 6. 9.	Information Code <b>3 Tenant</b>	
	1.Owner 4.Agent 7.	
	2.Relative 5.Estimate 8.	
	3.Tenant 6.Other 9.	

Date Inspected 10/27/2018

### Additions, Outbuildings & Improvements

Type	Year	Units	Grade	Cond	Phys.	Funct.	Sound Value
40 Basement Entry	1970	36	9 100	9	0 %	100 %	
21 Open Frame	1970	90	3 100	3	0 %	100 %	
22 Encl Frame Porch	1970	64	9 100	9	0 %	100 %	
23 Frame Garage	1970	567	3 100	4	0 %	95 %	
24 Frame Shed	0				%	%	350
					%	%	
					%	%	
					%	%	
					%	%	
					%	%	
					%	%	
					%	%	

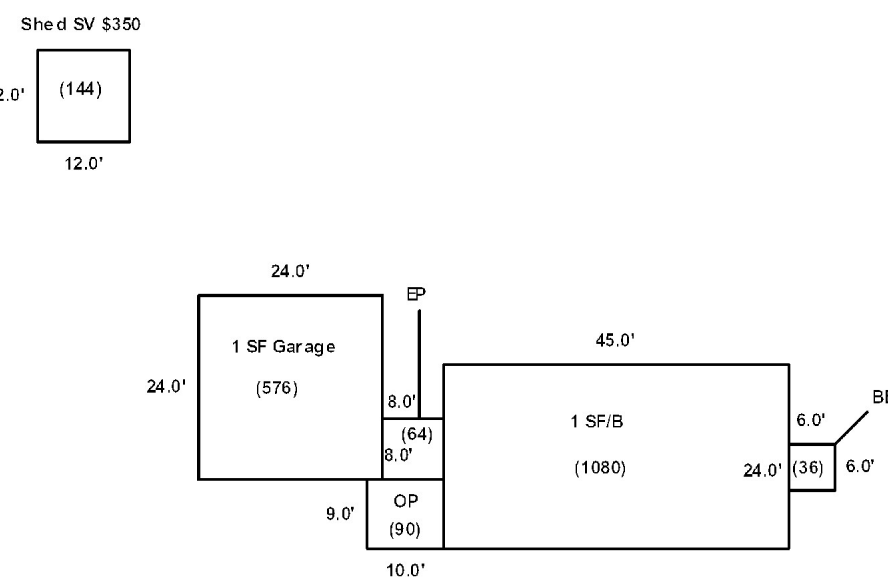



## Washburn

Map Lot 012-031

Account 877

Location 7 LORETTA LANE

Card 1 Of 1 12/09/2022

Building Style	<b>2 Ranch</b>			SF Bsmt Living	<b>0</b>			Layout	<b>1 Typical</b>									
1.Conv.	5.Garrison	9.Gambrel		Fin Bsmt Grade	<b>0 0</b>			1.Typical	4.	7.								
2.Ranch	6.Salt Box	10.Other		OPEN 5 OPTIONAL	<b>0</b>			2.Inadeq	5.	8.								
3.R Ranch	7.Contemp	11.Split		Heat Type	<b>100% 5 Forced Warm Air</b>			3.Pool	6.	9.								
4.Cape	8.Log	12.		1.HWBB	5.FWA	9.No Heat	Attic	<b>9 None</b>										
Dwelling Units	<b>1</b>			2.HWCI	6.GravWA	10.	1.1/4 Fin	4.Full Fin	7.									
Other Units	<b>0</b>			3.H Pump	7.Electric	11.	2.1/2 Fin	5.F/Stair	8.									
Stories	<b>1 One Story</b>			4.Steam	8.F/Wall	12.	3.3/4 Fin	6.	9.None									
1.1	4.1.5	7.		Cool Type	<b>0% 9 None</b>			Insulation	<b>1 Full</b>									
2.2	5.1.75	8.		1.Refrig	4.W&C Air	7.	1.Full	4.Minimal	7.									
3.3	6.2.5	9.		2.Evapor	5.	8.	2.Heavy	5.Partial	8.									
Exterior Walls	<b>4 Asbestos Siding</b>			3.H Pump	6.	9.None	3.Capped	6.	9.None									
1.Wood	5.Stucco	9.T-111		Kitchen Style	<b>2 Typical</b>			Unfinished %	<b>0%</b>									
2.Vin/Al	6.Brick	10.Other		1.Modern	4.Obsolete	7.	Grade & Factor	<b>3 Average 100%</b>										
3.Compos.	7.Stone	11.		2.Typical	5.	8.	1.E Grade	4.B Grade	7.									
4.Asbestos	8.Concrete	12.		3.Old Type	6.	9.None	2.D Grade	5.A Grade	8.SC Grade									
Roof Surface	<b>1 Asphalt Shingles</b>			Bath(s) Style	<b>2 Typical Bath(s)</b>			3.C Grade	6.AA Grade	9.Same								
1.Asphalt	4.Composit	7.		1.Modern	4.Obsolete	7.	SQFT (Footprint) <b>952</b>											
2.Slate	5.Wood	8.		2.Typical	5.	8.	Condition <b>5 Above Average</b>											
3.Metal	6.Other	9.		3.Old Type	6.	9.None	1.Poor	4.Avg	7.V G									
SF Masonry Trim	<b>0</b>			# Rooms	<b>5</b>			2.Fair	5.Avg+	8.Exc								
OPEN-3-CUSTOM	<b>0</b>			# Bedrooms	<b>3</b>			3.Avg-	6.Good	9.Same								
OPEN-4-CUSTOM	<b>0</b>			# Full Baths	<b>1</b>			Phys. % Good	<b>0%</b>									
Year Built	<b>1965</b>			# Half Baths	<b>0</b>			Funct. % Good	<b>100%</b>									
Year Remodeled	<b>0</b>			# Addn Fixtures	<b>0</b>			Functional Code	<b>9 None</b>									
Foundation	<b>1 Concrete</b>			# Fireplaces	<b>0</b>			1.Incomp	4.Delap	7.No Power								
1.Concrete	4.Wood	7.									2.O-Built	5.Bsmt	8.LongTerm					
2.C Block	5.Slab	8.									Econ. % Good	<b>100%</b>			3.Damage	6.Common	9.None	
3.Br/Stone	6.Piers	9.									Economic Code	<b>None</b>			0.None	3.No Power	7.	
Basement	<b>4 Full Basement</b>										1.1/4 Bmt	4.Full Bmt	7.	1.Location	4.Generate	8.		
1.1/4 Bmt	4.Full Bmt	7.									2.1/2 Bmt	5.None	8.	2.Encroach	9.None	9.		
2.1/2 Bmt	5.None	8.									Bsmt Gar # Cars	<b>0</b>			Entrance Code	<b>5 Estimated</b>		
3.3/4 Bmt	6.	9.None									Wet Basement	<b>2 Damp Basement</b>			1.Interior	4.Vacant	7.	
1.Dry	4.	7.									1.Dry	4.	7.	2.Refusal	5.Estimate	8.		
2.Damp	5.	8.									3.Wet	6.	9.	3.Informed	6.Reviewed	9.		
3.Wet	6.	9.									Information Code <b>5 Estimate</b>							
Date Inspected 10/27/2018							1.Owner		4.Agent	7.								
Date Inspected 10/27/2018							2.Relative		5.Estimate	8.								
Date Inspected 10/27/2018							3.Tenant		6.Other	9.								

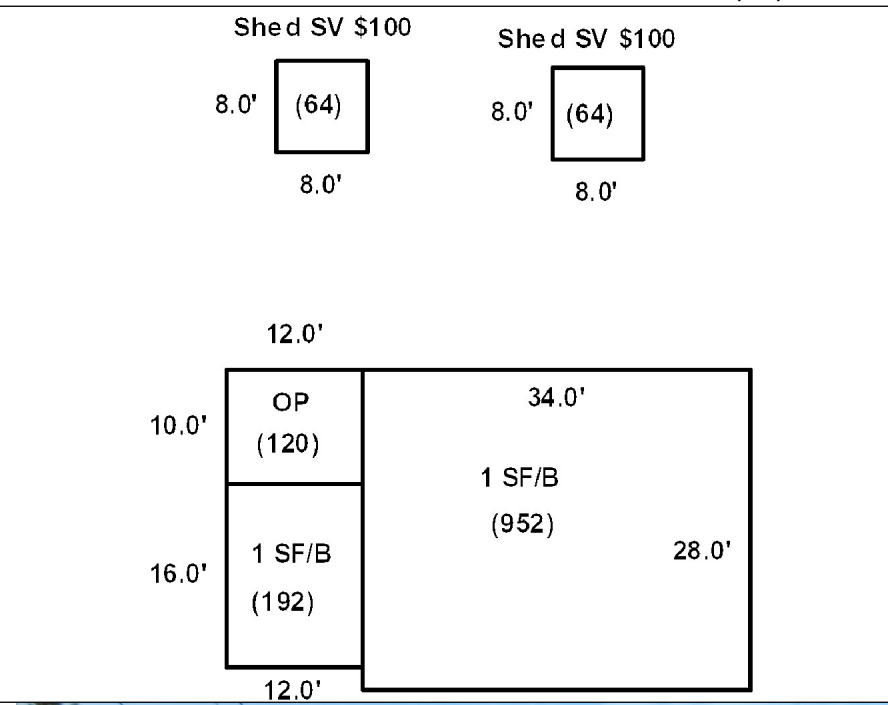

Additions, Outbuildings & Improvements							
Type	Year	Units	Grade	Cond	Phys.	Funct.	Sound Value
20 1 Story/Bsmt	1965	192	9 100	9	0 %	100 %	
21 Open Frame	1965	120	3 100	3	0 %	100 %	
24 Frame Shed	0				%	%	100
24 Frame Shed	0				%	%	100
					%	%	
					%	%	
					%	%	
					%	%	
					%	%	
					%	%	
					%	%	





## Washburn

Map Lot 012-032

Account 836

Location 3 Loretta Lane

Card 1

Of 1

12/09/2022

Building Style <b>2 Ranch</b>	SF Bsmt Living <b>0</b>	Layout <b>1 Typical</b>
1.Conv. 5.Garrison 9.Gambrel	Fin Bsmt Grade <b>0 0</b>	1.Typical 4. 7.
2.Ranch 6.Salt Box 10.Other	OPEN 5 OPTIONAL <b>0</b>	2.Inadeq 5. 8.
3.R Ranch 7.Contemp 11.Split	Heat Type <b>100% 1 Hot Water BB</b>	3.Poor 6. 9.
4.Cape 8.Log 12.	1.HWBB 5.FWA 9.No Heat	Attic <b>9 None</b>
Dwelling Units <b>1</b>	2.HWCI 6.GravWA 10.	1.1/4 Fin 4.Full Fin 7.
Other Units <b>0</b>	3.H Pump 7.Electric 11.	2.1/2 Fin 5.FI/Stair 8.
Stories <b>1 One Story</b>	4.Steam 8.FI/Wall 12.	3.3/4 Fin 6. 9.None
1.1 4.1.5 7.	Cool Type <b>0% 9 None</b>	Insulation <b>1 Full</b>
2.2 5.1.75 8.	1.Refrig 4.W&C Air 7.	1.Full 4.Minimal 7.
3.3 6.2.5 9.	2.Evapor 5. 8.	2.Heavy 5.Partial 8.
Exterior Walls <b>10 Other</b>	3.H Pump 6. 9.None	3.Capped 6. 9.None
1.Wood 5.Stucco 9.T-111	Kitchen Style <b>2 Typical</b>	Unfinished % <b>0%</b>
2.Vin/Al 6.Brick 10.Other	1.Modern 4.Obsolete 7.	Grade & Factor <b>3 Average 100%</b>
3.Compos. 7.Stone 11.	2.Typical 5. 8.	1.E Grade 4.B Grade 7.
4.Asbestos 8.Concrete 12.	3.Old Type 6. 9.None	2.D Grade 5.A Grade 8.SC Grade
Roof Surface <b>3 Sheet Metal</b>	Bath(s) Style <b>2 Typical Bath(s)</b>	3.C Grade 6.AA Grade 9.Same
1.Asphalt 4.Composit 7.	1.Modern 4.Obsolete 7.	SQFT (Footprint) <b>988</b>
2.Slate 5.Wood 8.	2.Typical 5. 8.	Condition <b>6 Good</b>
3.Metal 6.Other 9.	3.Old Type 6. 9.None	1.Poor 4.Avg 7.V G
SF Masonry Trim <b>0</b>	# Rooms <b>5</b>	2.Fair 5.Avg+ 8.Exc
OPEN-3-CUSTOM <b>0</b>	# Bedrooms <b>2</b>	3.Avg- 6.Good 9.Same
OPEN-4-CUSTOM <b>0</b>	# Full Baths <b>1</b>	Phys. % Good <b>0%</b>
Year Built <b>1961</b>	# Half Baths <b>0</b>	Funct. % Good <b>100%</b>
Year Remodeled <b>0</b>	# Addn Fixtures <b>0</b>	Functional Code <b>9 None</b>
Foundation <b>1 Concrete</b>	# Fireplaces <b>0</b>	1.Incomp 4.Delap 7.No Power
1.Concrete 4.Wood 7.	 <p><b>TRIO</b> Software <i>A Division of Harris Computer Systems</i></p>	2.O-Built 5.Bsmt 8.LongTerm
2.C Block 5.Slab 8.		3.Damage 6.Common 9.None
3.Br/Stone 6.Piers 9.		Econ. % Good <b>100%</b>
Basement <b>4 Full Basement</b>		Economic Code <b>None</b>
1.1/4 Bmt 4.Full Bmt 7.		0.None 3.No Power 7.
2.1/2 Bmt 5.None 8.		1.Location 4.Generate 8.
3.3/4 Bmt 6. 9.None		2.Encroach 9.None 9.
Bsmt Gar # Cars <b>0</b>		Entrance Code <b>1 Interior Inspect</b>
Wet Basement <b>3 Wet Basement</b>		1.Interior 4.Vacant 7.
1.Dry 4. 7.		2.Refusal 5.Estimate 8.
2.Damp 5. 8.	3.Informed 6.Reviewed 9.	
3.Wet 6. 9.	Information Code <b>1 Owner</b>	
	1.Owner 4.Agent 7.	
	2.Relative 5.Estimate 8.	
	3.Tenant 6.Other 9.	

Date Inspected 10/27/2018

### Additions, Outbuildings & Improvements

Type	Year	Units	Grade	Cond	Phys.	Funct.	Sound Value
21 Open Frame	1970	56	3 100	4	0 %	100 %	
21 Open Frame	1985	80	3 100	4	0 %	100 %	
23 Frame Garage	1985	752	3 100	4	0 %	100 %	
24 Frame Shed	0				%	%	250
					%	%	
					%	%	
					%	%	
					%	%	
					%	%	
					%	%	
					%	%	

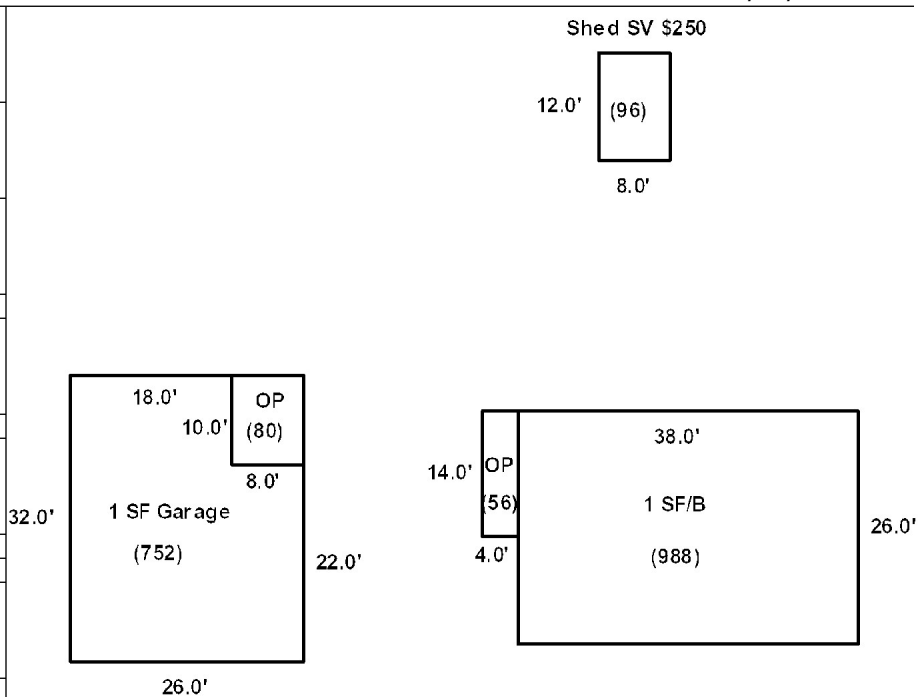

White Farms Inc.  
311 CROSS ROAD  
WASHBURN ME 04786

			Property Data			Assessment Record														
			Neighborhood	1 Neighborhood One		Year	Land	Buildings	Exempt	Total										
			Tree Growth Year		0	2009	1,500	0	0	1,500										
			1ST MORTGAGE		0	2012	1,500	0	0	1,500										
			2ND MORTGAGE		0	2013	1,900	0	0	1,900										
			Zone/Land Use		1 Residential			2015	1,900	0	0	1,900								
			Secondary Zone			2018	1,900	0	0	1,900										
			Topography		1 Level			2019	2,200	0	0	2,200								
			1.Level		4.Below St	7.LevelBog	2020	2,200	0	0	2,200									
			2.Rolling		5.Low	8.	2021	2,200	0	0	2,200									
			3.Above St		6.Swampy	9.	2022	2,200	0	0	2,200									
			Utilities																	
			1.Public		4.Dr Well	7.Cesspool														
			2.Water		5.Dug Well	8.														
			3.Sewer		6.Septic	9.None														
			Street		1 Paved															
			1.Paved		4.Proposed	7.	<b>Land Data</b>													
			2.Semi Imp		5.R/O/W	8.														
			3.Gravel		6.	9.None	<b>Front Foot</b>		<b>Type</b>		<b>Effective</b>		<b>Influence</b>		<b>Influence Codes</b>					
			TG PLAN YEAR		0			11.Regular Lot				Frontage		Depth		Factor		Code		
Inspection Witnessed By:			Tif District #		0			12.Delta Triangle								1.Unimproved				
			<b>Sale Data</b>						13.Nabla Triangle								2.Excess Frtg			
X			Sale Date					14.Rear Land								3.Topography				
			Price					15.Class I Road										4.Size/Shape		
No./Date			Description		Date Insp.			16.Class II Road								5.Access				
			Sale Type		1 Land Only			17.Municipal Rese										6.Restriction		
			1.Land		4.Mobile	7.C/I L&B	18.Munic Sep Lago										7.Open Space			
			2.L & B		5.Other	8.	19.Gravel Pit										8.View/Environ			
			3.Building		6.C/I Land	9.	20.Industrial Bas										9.Fract Share			
			Financing						Fract. Acre		Square Feet								Acres	
Notes:			1.Convent		4.Seller	7.	21.Developed Pave		22		0.06		100		%		0			
			2.FHA/VA		5.Private	8.	22.Undev Paved (F												%	
			3.Assumed		6.Cash	9.Unknown	23.Developed Grav												%	
			Validity					Acres												%
			1.Valid		4.Split	7.Renovate	24.Undev Gravel (												%	
			2.Related		5.Partial	8.Other	25.Comm Base Pave												%	
			3.Distress		6.Exempt	9.	26.Comm Base Grav												%	
			Verified					Acres												%
			1.Buyer		4.Agent	7.Family	27.Backlot												%	
			2.Seller		5.Pub Rec	8.Other	28.Rear Land												%	
			3.Lender		6.MLS	9.	29.Pavement												%	
			Total Acreage			0.06														

## Washburn

Map Lot 012-033

Account 1024

Location Thompson Street

Card 1 Of 1 12/09/2022

Building Style <b>0</b>	SF Bsmt Living <b>0</b>	Layout <b>0</b>			
1.Conv. 5.Garrison 9.Gambrel	Fin Bsmt Grade <b>0 0</b>	1.Typical 4. 7.			
2.Ranch 6.Salt Box 10.Other	OPEN 5 OPTIONAL <b>0</b>	2.Inadeq 5. 8.			
3.R Ranch 7.Contemp 11.Split	Heat Type <b>100% 0</b>	3.Poor 6. 9.			
4.Cape 8.Log 12.	1.HWBB 5.FWA 9.No Heat	Attic <b>0</b>			
Dwelling Units <b>0</b>	2.HWCI 6.GravWA 10.	1.1/4 Fin 4.Full Fin 7.			
Other Units <b>0</b>	3.H Pump 7.Electric 11.	2.1/2 Fin 5.F/Stair 8.			
Stories <b>0</b>	4.Steam 8.F/Wall 12.	3.3/4 Fin 6. 9.None			
1.1 4.1.5 7.	Cool Type <b>0% 9 None</b>	Insulation <b>0</b>			
2.2 5.1.75 8.	1.Refrig 4.W&C Air 7.	1.Full 4.Minimal 7.			
3.3 6.2.5 9.	2.Evapor 5. 8.	2.Heavy 5.Partial 8.			
Exterior Walls <b>0</b>	3.H Pump 6. 9.None	3.Capped 6. 9.None			
1.Wood 5.Stucco 9.T-111	Kitchen Style <b>0</b>	Unfinished % <b>0%</b>			
2.Vin/Al 6.Brick 10.Other	1.Modern 4.Obsolete 7.	Grade & Factor <b>0 0%</b>			
3.Compos. 7.Stone 11.	2.Typical 5. 8.	1.E Grade 4.B Grade 7.			
4.Asbestos 8.Concrete 12.	3.Old Type 6. 9.None	2.D Grade 5.A Grade 8.SC Grade			
Roof Surface <b>0</b>	Bath(s) Style <b>0</b>	3.C Grade 6.AA Grade 9.Same			
1.Asphalt 4.Composit 7.	1.Modern 4.Obsolete 7.	SQFT (Footprint) <b>0</b>			
2.Slate 5.Wood 8.	2.Typical 5. 8.	Condition <b>0</b>			
3.Metal 6.Other 9.	3.Old Type 6. 9.None	1.Poor 4.Avg 7.V G			
SF Masonry Trim <b>0</b>	# Rooms <b>0</b>	2.Fair 5.Avg+ 8.Exc			
OPEN-3-CUSTOM <b>0</b>	# Bedrooms <b>0</b>	3.Avg- 6.Good 9.Same			
OPEN-4-CUSTOM <b>0</b>	# Full Baths <b>0</b>	Phys. % Good <b>0%</b>			
Year Built <b>0</b>	# Half Baths <b>0</b>	Funct. % Good <b>100%</b>			
Year Remodeled <b>0</b>	# Addn Fixtures <b>0</b>	Functional Code <b>9 None</b>			
Foundation <b>0</b>	# Fireplaces <b>0</b>	1.Incomp 4.Delap 7.No Power			
1.Concrete 4.Wood 7.		2.O-Built 5.Bsmt 8.LongTerm			
2.C Block 5.Slab 8.		3.Damage 6.Common 9.None			
3.Br/Stone 6.Piers 9.		Econ. % Good <b>100%</b>			
Basement <b>0</b>		Economic Code <b>None</b>			
1.1/4 Bmt 4.Full Bmt 7.		0.None 3.No Power 7.			
2.1/2 Bmt 5.None 8.		1.Location 4.Generate 8.			
3.3/4 Bmt 6. 9.None		2.Encroach 9.None 9.			
Bsmt Gar # Cars <b>0</b>		Entrance Code <b>0</b>			
Wet Basement <b>0</b>		1.Interior 4.Vacant 7.			
1.Dry 4. 7.		2.Refusal 5.Estimate 8.			
2.Damp 5. 8.		3.Informed 6.Reviewed 9.			
3.Wet 6. 9.		Information Code <b>0</b>			
		1.Owner 4.Agent 7.			
		2.Relative 5.Estimate 8.			
		3.Tenant 6.Other 9.			



Date Inspected

Additions, Outbuildings & Improvements								
Type	Year	Units	Grade	Cond	Phys.	Funct.	Sound Value	
					%	%		1.One Story Fram
					%	%		2.Two Story Fram
					%	%		3.Three Story Fr
					%	%		4.1 & 1/2 Story
					%	%		5.1 & 3/4 Story
					%	%		6.2 & 1/2 Story
					%	%		21.Open Frame Por
					%	%		22.Encl Frame Por
					%	%		23.Frame Garage
					%	%		24.Frame Shed
					%	%		25.Frame Bay Wind
					%	%		26.1SFr Overhang
					%	%		27.Unfin Basement
					%	%		28.Unfinished Att
					%	%		29.Finished Attic



Chandler Family LLC  
1634 STATE ROAD  
MAPLETON ME 04757

B3706P302

Inspection Witnessed By:

No./Date	Description	Date Insp.
X		

Notes:

Washburn

Property Data			Assessment Record						
Neighborhood <b>1 Neighborhood One</b>			Year	Land	Buildings	Exempt	Total		
Tree Growth Year <b>0</b>			2009	1,500	0	0	1,500		
1ST MORTGAGE <b>0</b>			2012	1,500	0	0	1,500		
2ND MORTGAGE <b>0</b>			2013	1,900	0	0	1,900		
Zone/Land Use <b>1 Residential</b>			2015	1,900	0	0	1,900		
Secondary Zone			2018	1,900	0	0	1,900		
Topography <b>1 Level</b>			2019	2,200	0	0	2,200		
1.Level 4.Below St 7.LevelBog			2020	2,200	0	0	2,200		
2.Rolling 5.Low 8.			2021	2,200	0	0	2,200		
3.Above St 6.Swampy 9.			2022	2,200	0	0	2,200		
Utilities									
1.Public 4.Dr Well 7.Cesspool									
2.Water 5.Dug Well 8.									
3.Sewer 6.Septic 9.None									
Street <b>1 Paved</b>									
1.Paved 4.Proposed 7.									
2.Semi Imp 5.R/O/W 8.									
3.Gravel 6. 9.None									
TG PLAN YEAR <b>0</b>									
Tif District # <b>0</b>									
Sale Data			<b>Land Data</b>						
Sale Date			<b>Front Foot</b>	<b>Type</b>	<b>Effective</b>		<b>Influence</b>		<b>Influence Codes</b>
Price			11.Regular Lot		<b>Frontage</b>	<b>Depth</b>	<b>Factor</b>	<b>Code</b>	
Sale Type <b>1 Land Only</b>			12.Delta Triangle				%		1.Unimproved
1.Land 4.Mobile 7.C/I L&B			13.Nabla Triangle				%		2.Excess Frtg
2.L & B 5.Other 8.			14.Rear Land				%		3.Topography
3.Building 6.C/I Land 9.			15.Class I Road				%		4.Size/Shape
Financing							%		5.Access
1.Convent 4.Seller 7.							%		6.Restriction
2.FHA/VA 5.Private 8.							%		7.Open Space
3.Assumed 6.Cash 9.Unknown							%		8.View/Environ
Validity							%		9.Fract Share
1.Valid 4.Split 7.Renovate			<b>Square Foot</b>		<b>Square Feet</b>				<b>Acres</b>
2.Related 5.Partial 8.Other			16.Class II Road				%		30.Utility R O W
3.Distress 6.Exempt 9.			17.Municipal Rese				%		31.Tillable
Verified			18.Munic Sep Lago				%		32.Pasture
1.Buyer 4.Agent 7.Family			19.Gravel Pit				%		33.Orchard
2.Seller 5.Pub Rec 8.Other			20.Industrial Bas				%		34.Softwood F&O
3.Lender 6.MLS 9.							%		35.Mixed Wood F&O
			<b>Fract. Acre</b>		<b>Acreege/Sites</b>				36.Hardwood F&O
			21.Developed Pave	22	0.06	100	%	0	37.Softwood TG
			22.Undev Paved (F				%		38.Mixed Wood TG
			23.Developed Grav				%		39.Hardwood TG
			<b>Acres</b>				%		40.Wasteland
			24.Undev Gravel (				%		41.Open Space
			25.Comm Base Pave				%		42.Mobile Home Si
			26.Comm Base Grav				%		43.Condo Site
			27.Backlot				%		44.Lot Improvemen
			28.Rear Land				%		45.Subdivision Lo
			29.Pavement				%		46.Heavy Ind Sit
			<b>Total Acreage</b>		0.06				

## Washburn

Map Lot 012-034

Account 109

Location Thompson Street

Card 1 Of 1 12/09/2022

Building Style <b>0</b>	SF Bsmt Living <b>0</b>	Layout <b>0</b>			
1.Conv. 5.Garrison 9.Gambrel	Fin Bsmt Grade <b>0 0</b>	1.Typical 4. 7.			
2.Ranch 6.Salt Box 10.Other	OPEN 5 OPTIONAL <b>0</b>	2.Inadeq 5. 8.			
3.R Ranch 7.Contemp 11.Split	Heat Type <b>100% 0</b>	3.Poor 6. 9.			
4.Cape 8.Log 12.	1.HWBB 5.FWA 9.No Heat	Attic <b>0</b>			
Dwelling Units <b>0</b>	2.HWCI 6.GravWA 10.	1.1/4 Fin 4.Full Fin 7.			
Other Units <b>0</b>	3.H Pump 7.Electric 11.	2.1/2 Fin 5.F/Stair 8.			
Stories <b>0</b>	4.Steam 8.F/Wall 12.	3.3/4 Fin 6. 9.None			
1.1 4.1.5 7.	Cool Type <b>0% 9 None</b>	Insulation <b>0</b>			
2.2 5.1.75 8.	1.Refrig 4.W&C Air 7.	1.Full 4.Minimal 7.			
3.3 6.2.5 9.	2.Evapor 5. 8.	2.Heavy 5.Partial 8.			
Exterior Walls <b>0</b>	3.H Pump 6. 9.None	3.Capped 6. 9.None			
1.Wood 5.Stucco 9.T-111	Kitchen Style <b>0</b>	Unfinished % <b>0%</b>			
2.Vin/Al 6.Brick 10.Other	1.Modern 4.Obsolete 7.	Grade & Factor <b>0 0%</b>			
3.Compos. 7.Stone 11.	2.Typical 5. 8.	1.E Grade 4.B Grade 7.			
4.Asbestos 8.Concrete 12.	3.Old Type 6. 9.None	2.D Grade 5.A Grade 8.SC Grade			
Roof Surface <b>0</b>	Bath(s) Style <b>0</b>	3.C Grade 6.AA Grade 9.Same			
1.Asphalt 4.Composit 7.	1.Modern 4.Obsolete 7.	SQFT (Footprint) <b>0</b>			
2.Slate 5.Wood 8.	2.Typical 5. 8.	Condition <b>0</b>			
3.Metal 6.Other 9.	3.Old Type 6. 9.None	1.Poor 4.Avg 7.V G			
SF Masonry Trim <b>0</b>	# Rooms <b>0</b>	2.Fair 5.Avg+ 8.Exc			
OPEN-3-CUSTOM <b>0</b>	# Bedrooms <b>0</b>	3.Avg- 6.Good 9.Same			
OPEN-4-CUSTOM <b>0</b>	# Full Baths <b>0</b>	Phys. % Good <b>0%</b>			
Year Built <b>0</b>	# Half Baths <b>0</b>	Funct. % Good <b>100%</b>			
Year Remodeled <b>0</b>	# Addn Fixtures <b>0</b>	Functional Code <b>9 None</b>			
Foundation <b>0</b>	# Fireplaces <b>0</b>	1.Incomp 4.Delap 7.No Power			
1.Concrete 4.Wood 7.		2.O-Built 5.Bsmt 8.LongTerm			
2.C Block 5.Slab 8.		3.Damage 6.Common 9.None			
3.Br/Stone 6.Piers 9.		Econ. % Good <b>100%</b>			
Basement <b>0</b>		Economic Code <b>None</b>			
1.1/4 Bmt 4.Full Bmt 7.		0.None 3.No Power 7.			
2.1/2 Bmt 5.None 8.		1.Location 4.Generate 8.			
3.3/4 Bmt 6. 9.None		2.Encroach 9.None 9.			
Bsmt Gar # Cars <b>0</b>		Entrance Code <b>0</b>			
Wet Basement <b>0</b>		1.Interior 4.Vacant 7.			
1.Dry 4. 7.		2.Refusal 5.Estimate 8.			
2.Damp 5. 8.		3.Informed 6.Reviewed 9.			
3.Wet 6. 9.		Information Code <b>0</b>			
		1.Owner 4.Agent 7.			
		2.Relative 5.Estimate 8.			
		3.Tenant 6.Other 9.			



Date Inspected

Additions, Outbuildings & Improvements								
Type	Year	Units	Grade	Cond	Phys.	Funct.	Sound Value	
					%	%		1.One Story Fram
					%	%		2.Two Story Fram
					%	%		3.Three Story Fr
					%	%		4.1 & 1/2 Story
					%	%		5.1 & 3/4 Story
					%	%		6.2 & 1/2 Story
					%	%		21.Open Frame Por
					%	%		22.Encl Frame Por
					%	%		23.Frame Garage
					%	%		24.Frame Shed
					%	%		25.Frame Bay Wind
					%	%		26.1SFr Overhang
					%	%		27.Unfin Basement
					%	%		28.Unfinished Att
					%	%		29.Finished Attic



**Washburn**

Map Lot 012-037

Account 430

Location THOMPSON STREET

Card 1 Of 1 12/09/2022

Building Style <b>0</b>	SF Bsmt Living <b>0</b>	Layout <b>0</b>
1.Conv. 5.Garrison 9.Gambrel	Fin Bsmt Grade <b>0 0</b>	1.Typical 4. 7.
2.Ranch 6.Salt Box 10.Other	OPEN 5 OPTIONAL <b>0</b>	2.Inadeq 5. 8.
3.R Ranch 7.Contemp 11.Split	Heat Type <b>100% 0</b>	3.Poor 6. 9.
4.Cape 8.Log 12.	1.HWBB 5.FWA 9.No Heat	Attic <b>0</b>
Dwelling Units <b>0</b>	2.HWCI 6.GravWA 10.	1.1/4 Fin 4.Full Fin 7.
Other Units <b>0</b>	3.H Pump 7.Electric 11.	2.1/2 Fin 5.FI/Stair 8.
Stories <b>0</b>	4.Steam 8.FI/Wall 12.	3.3/4 Fin 6. 9.None
1.1 4.1.5 7.	Cool Type <b>0% 9 None</b>	Insulation <b>0</b>
2.2 5.1.75 8.	1.Refrig 4.W&C Air 7.	1.Full 4.Minimal 7.
3.3 6.2.5 9.	2.Evapor 5. 8.	2.Heavy 5.Partial 8.
Exterior Walls <b>0</b>	3.H Pump 6. 9.None	3.Capped 6. 9.None
1.Wood 5.Stucco 9.T-111	Kitchen Style <b>0</b>	Unfinished % <b>0%</b>
2.Vin/Al 6.Brick 10.Other	1.Modern 4.Obsolete 7.	Grade & Factor <b>0 0%</b>
3.Compos. 7.Stone 11.	2.Typical 5. 8.	1.E Grade 4.B Grade 7.
4.Asbestos 8.Concrete 12.	3.Old Type 6. 9.None	2.D Grade 5.A Grade 8.SC Grade
Roof Surface <b>0</b>	Bath(s) Style <b>0</b>	3.C Grade 6.AA Grade 9.Same
1.Asphalt 4.Composit 7.	1.Modern 4.Obsolete 7.	SQFT (Footprint) <b>0</b>
2.Slate 5.Wood 8.	2.Typical 5. 8.	Condition <b>0</b>
3.Metal 6.Other 9.	3.Old Type 6. 9.None	1.Poor 4.Avg 7.V G
SF Masonry Trim <b>0</b>	# Rooms <b>0</b>	2.Fair 5.Avg+ 8.Exc
OPEN-3-CUSTOM <b>0</b>	# Bedrooms <b>0</b>	3.Avg- 6.Good 9.Same
OPEN-4-CUSTOM <b>0</b>	# Full Baths <b>0</b>	Phys. % Good <b>0%</b>
Year Built <b>0</b>	# Half Baths <b>0</b>	Funct. % Good <b>100%</b>
Year Remodeled <b>0</b>	# Addn Fixtures <b>0</b>	Functional Code <b>9 None</b>
Foundation <b>0</b>	# Fireplaces <b>0</b>	1.Incomp 4.Delap 7.No Power
1.Concrete 4.Wood 7.		2.O-Built 5.Bsmt 8.LongTerm
2.C Block 5.Slab 8.		3.Damage 6.Common 9.None
3.Br/Stone 6.Piers 9.		Econ. % Good <b>100%</b>
Basement <b>0</b>		Economic Code <b>None</b>
1.1/4 Bmt 4.Full Bmt 7.		0.None 3.No Power 7.
2.1/2 Bmt 5.None 8.		1.Location 4.Generate 8.
3.3/4 Bmt 6. 9.None		2.Encroach 9.None 9.
Bsmt Gar # Cars <b>0</b>		Entrance Code <b>0</b>
Wet Basement <b>0</b>		1.Interior 4.Vacant 7.
1.Dry 4. 7.		2.Refusal 5.Estimate 8.
2.Damp 5. 8.	3.Informed 6.Reviewed 9.	
3.Wet 6. 9.	Information Code <b>0</b>	
		1.Owner 4.Agent 7.
		2.Relative 5.Estimate 8.
		3.Tenant 6.Other 9.

Date Inspected

**Additions, Outbuildings & Improvements**

Type	Year	Units	Grade	Cond	Phys.	Funct.	Sound Value
					%	%	1.One Story Fram
					%	%	2.Two Story Fram
					%	%	3.Three Story Fr
					%	%	4.1 & 1/2 Story
					%	%	5.1 & 3/4 Story
					%	%	6.2 & 1/2 Story
					%	%	21.Open Frame Por
					%	%	22.Encl Frame Por
					%	%	23.Frame Garage
					%	%	24.Frame Shed
					%	%	25.Frame Bay Wind
					%	%	26.1SFr Overhang
					%	%	27.Unfin Basement
					%	%	28.Unfinished Att
					%	%	29.Finished Attic



## Washburn

Map Lot 012-038

Account 870

Location 13 Thompson Street

Card 1 Of 1 12/09/2022

Building Style	<b>2 Ranch</b>		SF Bsmt Living	<b>0</b>		Layout	<b>1 Typical</b>	
1.Conv.	5.Garrison	9.Gambrel	Fin Bsmt Grade	<b>0 0</b>		1.Typical	4.	7.
2.Ranch	6.Salt Box	10.Other	OPEN 5 OPTIONAL	<b>0</b>		2.Inadeq	5.	8.
3.R Ranch	7.Contemp	11.Split	Heat Type	<b>100% 1 Hot Water BB</b>		3.Poor	6.	9.
4.Cape	8.Log	12.	1.HWB	5.FWA	9.No Heat	<b>Attic 9 None</b>		
Dwelling Units <b>1</b>			2.HWCI	6.GravWA	10.	1.1/4 Fin	4.Full Fin	7.
Other Units <b>0</b>			3.H Pump	7.Electric	11.	2.1/2 Fin	5.FI/Stair	8.
Stories <b>1 One Story</b>			4.Steam	8.FI/Wall	12.	3.3/4 Fin	6.	9.None
1.1	4.1.5	7.	<b>Cool Type 0% 9 None</b>			<b>Insulation 1 Full</b>		
2.2	5.1.75	8.	1.Refrig	4.W&C Air	7.	1.Full	4.Minimal	7.
3.3	6.2.5	9.	2.Evapor	5.	8.	2.Heavy	5.Partial	8.
Exterior Walls <b>2 Vinyl/Aluminum</b>			3.H Pump	6.	9.None	3.Capped	6.	9.None
1.Wood	5.Stucco	9.T-111	<b>Kitchen Style 2 Typical</b>			<b>Unfinished % 0%</b>		
2.Vin/Al	6.Brick	10.Other	1.Modern	4.Obsolete	7.	<b>Grade &amp; Factor 3 Average 105%</b>		
3.Compos.	7.Stone	11.	2.Typical	5.	8.	1.E Grade	4.B Grade	7.
4.Asbestos	8.Concrete	12.	3.Old Type	6.	9.None	2.D Grade	5.A Grade	8.SC Grade
Roof Surface <b>3 Sheet Metal</b>			<b>Bath(s) Style 2 Typical Bath(s)</b>			3.C Grade	6.AA Grade	9.Same
1.Asphalt	4.Composit	7.	1.Modern	4.Obsolete	7.	<b>SQFT (Footprint) 988</b>		
2.Slate	5.Wood	8.	2.Typical	5.	8.	<b>Condition 5 Above Average</b>		
3.Metal	6.Other	9.	3.Old Type	6.	9.None	1.Poor	4.Avg	7.V G
SF Masonry Trim <b>0</b>			<b># Rooms 4</b>			2.Fair	5.Avg+	8.Exc
OPEN-3-CUSTOM <b>0</b>			<b># Bedrooms 2</b>			3.Avg-	6.Good	9.Same
OPEN-4-CUSTOM <b>0</b>			<b># Full Baths 1</b>			<b>Phys. % Good 0%</b>		
Year Built <b>1972</b>			<b># Half Baths 0</b>			<b>Funct. % Good 100%</b>		
Year Remodeled <b>0</b>			<b># Addn Fixtures 0</b>			<b>Functional Code 9 None</b>		
Foundation <b>1 Concrete</b>			<b># Fireplaces 0</b>			1.Incomp	4.Delap	7.No Power
1.Concrete	4.Wood	7.						
2.C Block	5.Slab	8.						
3.Br/Stone	6.Piers	9.						
Basement <b>4 Full Basement</b>								
1.1/4 Bmt	4.Full Bmt	7.						
2.1/2 Bmt	5.None	8.						
3.3/4 Bmt	6.	9.None						
Bsmt Gar # Cars <b>1</b>								
Wet Basement <b>1 Dry Basement</b>								
1.Dry	4.	7.						
2.Damp	5.	8.						
3.Wet	6.	9.						
Date Inspected 10/27/2018			Economic Code <b>None</b>			Entrance Code <b>1 Interior Inspect</b>		
			0.None			1.Interior		
			1.Location			4.Vacant		
			2.O-Built			5.Estimate		
			3.Damage			6.Reviewed		
			Econ. % Good <b>100%</b>			Information Code <b>1 Owner</b>		
			1.Owner			4.Agent		
			2.Relative			5.Estimate		
			3.Tenant			6.Other		

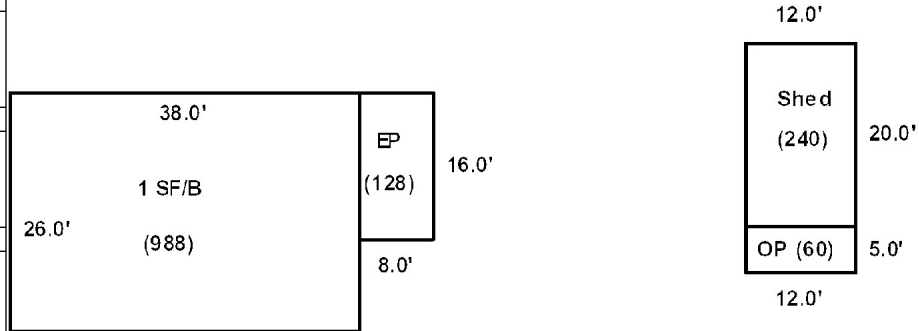

Additions, Outbuildings & Improvements								
Type	Year	Units	Grade	Cond	Phys.	Funct.	Sound Value	
22 Encl Frame Porch	1972	128	3 100	5	0 %	100 %		1.One Story Fram
24 Frame Shed	1985	240	3 100	3	0 %	100 %		2.Two Story Fram
21 Open Frame	1985	60	3 95	4	0 %	100 %		3.Three Story Fr
					%	%		4.1 & 1/2 Story
					%	%		5.1 & 3/4 Story
					%	%		6.2 & 1/2 Story
					%	%		21.Open Frame Por
					%	%		22.Encl Frame Por
					%	%		23.Frame Garage
					%	%		24.Frame Shed
					%	%		25.Frame Bay Wind
					%	%		26.1SFr Overhang
					%	%		27.Unfin Basement
					%	%		28.Unfinished Att
					%	%		29.Finished Attic









## Washburn

Map Lot 012-040

Account 520

Location 7 THOMPSON STREET

Card 1 Of 1 12/09/2022

Building Style	<b>2 Ranch</b>			SF Bsmt Living	<b>0</b>			Layout	<b>1 Typical</b>		
1.Conv.	5.Garrison	9.Gambrel		Fin Bsmt Grade	<b>0 0</b>			1.Typical	4.	7.	
2.Ranch	6.Salt Box	10.Other		OPEN 5 OPTIONAL	<b>0</b>			2.Inadeq	5.	8.	
3.R Ranch	7.Contemp	11.Split		Heat Type	<b>100% 5 Forced Warm Air</b>			3.Poor	6.	9.	
4.Cape	8.Log	12.		1.HWBB	5.FWA	9.No Heat	Attic	<b>9 None</b>			
Dwelling Units	<b>1</b>			2.HWCI	6.GravWA	10.	1.1/4 Fin	4.Full Fin	7.		
Other Units	<b>0</b>			3.H Pump	7.Electric	11.	2.1/2 Fin	5.F/ Stair	8.		
Stories	<b>1 One Story</b>			4.Steam	8.F/Wall	12.	3.3/4 Fin	6.	9.None		
1.1	4.1.5	7.		Cool Type	<b>0% 9 None</b>			Insulation	<b>1 Full</b>		
2.2	5.1.75	8.		1.Refrig	4.W&C Air	7.	1.Full	4.Minimal	7.		
3.3	6.2.5	9.		2.Evapor	5.	8.	2.Heavy	5.Partial	8.		
Exterior Walls	<b>1 Wood Siding</b>			3.H Pump	6.	9.None	3.Capped	6.	9.None		
1.Wood	5.Stucco	9.T-111		Kitchen Style	<b>2 Typical</b>			Unfinished %	<b>0%</b>		
2.Vin/Al	6.Brick	10.Other		1.Modern	4.Obsolete	7.	Grade & Factor	<b>3 Average 105%</b>			
3.Compos.	7.Stone	11.		2.Typical	5.	8.	1.E Grade	4.B Grade	7.		
4.Asbestos	8.Concrete	12.		3.Old Type	6.	9.None	2.D Grade	5.A Grade	8.SC Grade		
Roof Surface	<b>3 Sheet Metal</b>			Bath(s) Style	<b>2 Typical Bath(s)</b>			3.C Grade	6.AA Grade	9.Same	
1.Asphalt	4.Composit	7.		1.Modern	4.Obsolete	7.	SQFT (Footprint)	<b>1000</b>			
2.Slate	5.Wood	8.		2.Typical	5.	8.	Condition	<b>6 Good</b>			
3.Metal	6.Other	9.		3.Old Type	6.	9.None	1.Poor	4.Avg	7.V G		
SF Masonry Trim	<b>0</b>			# Rooms	<b>5</b>			2.Fair	5.Avg+	8.Exc	
OPEN-3-CUSTOM	<b>0</b>			# Bedrooms	<b>3</b>			3.Avg-	6.Good	9.Same	
OPEN-4-CUSTOM	<b>0</b>			# Full Baths	<b>1</b>			Phys. % Good	<b>0%</b>		
Year Built	<b>1960</b>			# Half Baths	<b>0</b>			Funct. % Good	<b>100%</b>		
Year Remodeled	<b>0</b>			# Addn Fixtures	<b>0</b>			Functional Code	<b>9 None</b>		
Foundation	<b>1 Concrete</b>			# Fireplaces	<b>0</b>			1.Incomp	4.Delap	7.No Power	
1.Concrete	4.Wood	7.									
2.C Block	5.Slab	8.									
3.Br/Stone	6.Piers	9.									
Basement	<b>4 Full Basement</b>										
1.1/4 Bmt	4.Full Bmt	7.									
2.1/2 Bmt	5.None	8.									
3.3/4 Bmt	6.	9.None									
Bsmt Gar # Cars	<b>0</b>										
Wet Basement	<b>2 Damp Basement</b>										
1.Dry	4.	7.									
2.Damp	5.	8.									
3.Wet	6.	9.									
								Econ. % Good	<b>100%</b>		
								Economic Code	<b>None</b>		
								0.None	3.No Power	7.	
								1.Location	4.Generate	8.	
								2.Encroach	9.None	9.	
								Entrance Code	<b>3 Information Only</b>		
								1.Interior	4.Vacant	7.	
								2.Refusal	5.Estimate	8.	
								3.Informed	6.Reviewed	9.	
								Information Code	<b>1 Owner</b>		
								1.Owner	4.Agent	7.	
								2.Relative	5.Estimate	8.	
								3.Tenant	6.Other	9.	

Date Inspected 10/27/2018

### Additions, Outbuildings & Improvements

Type	Year	Units	Grade	Cond	Phys.	Funct.	Sound Value
23 Frame Garage	1960	432	3 100	4	0 %	90 %	
					%	%	
					%	%	
					%	%	
					%	%	
					%	%	
					%	%	
					%	%	
					%	%	
					%	%	
					%	%	

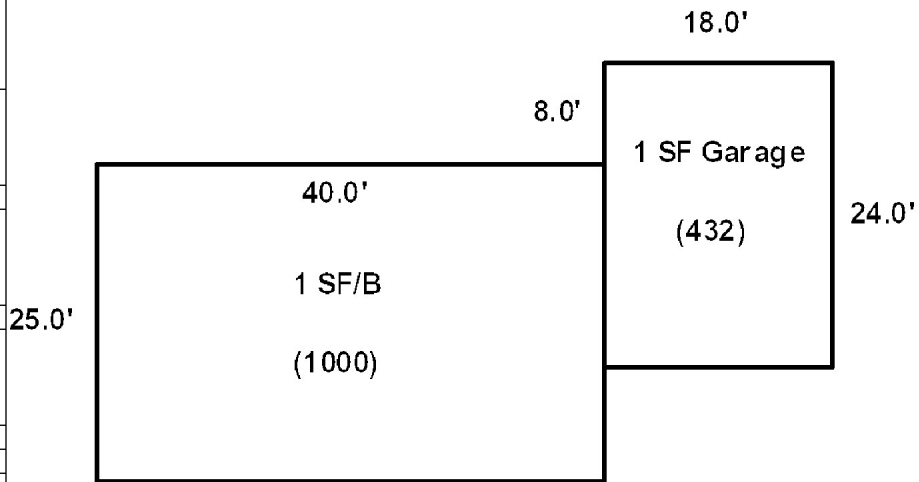



## Washburn

Map Lot 012-041

Account 498

Location 1232 MAIN STREET

Card 1 Of 1

12/09/2022

Building Style <b>1 Conventional</b>	SF Bsmt Living <b>0</b>	Layout <b>1 Typical</b>
1.Conv. 5.Garrison 9.Gambrel	Fin Bsmt Grade <b>0 0</b>	1.Typical 4. 7.
2.Ranch 6.Salt Box 10.Other	OPEN 5 OPTIONAL <b>0</b>	2.Inadeq 5. 8.
3.R Ranch 7.Contemp 11.Split	Heat Type <b>100% 5 Forced Warm Air</b>	3.Poor 6. 9.
4.Cape 8.Log 12.	1.HWBB 5.FWA 9.No Heat	Attic <b>9 None</b>
Dwelling Units <b>1</b>	2.HWCI 6.GravWA 10.	1.1/4 Fin 4.Full Fin 7.
Other Units <b>0</b>	3.H Pump 7.Electric 11.	2.1/2 Fin 5.FI/Stair 8.
Stories <b>2 Two Story</b>	4.Steam 8.FI/Wall 12.	3.3/4 Fin 6. 9.None
1.1 4.1.5 7.	Cool Type <b>0% 9 None</b>	Insulation <b>4 Minimal</b>
2.2 5.1.75 8.	1.Refrig 4.W&C Air 7.	1.Full 4.Minimal 7.
3.3 6.2.5 9.	2.Evapor 5. 8.	2.Heavy 5.Partial 8.
Exterior Walls <b>2 Vinyl/Aluminum</b>	3.H Pump 6. 9.None	3.Capped 6. 9.None
1.Wood 5.Stucco 9.T-111	Kitchen Style <b>2 Typical</b>	Unfinished % <b>0%</b>
2.Vin/Al 6.Brick 10.Other	1.Modern 4.Obsolete 7.	Grade & Factor <b>2 Fair 115%</b>
3.Compos. 7.Stone 11.	2.Typical 5. 8.	1.E Grade 4.B Grade 7.
4.Asbestos 8.Concrete 12.	3.Old Type 6. 9.None	2.D Grade 5.A Grade 8.SC Grade
Roof Surface <b>1 Asphalt Shingles</b>	Bath(s) Style <b>2 Typical Bath(s)</b>	3.C Grade 6.AA Grade 9.Same
1.Asphalt 4.Composit 7.	1.Modern 4.Obsolete 7.	SQFT (Footprint) <b>728</b>
2.Slate 5.Wood 8.	2.Typical 5. 8.	Condition <b>6 Good</b>
3.Metal 6.Other 9.	3.Old Type 6. 9.None	1.Poor 4.Avg 7.V G
SF Masonry Trim <b>0</b>	# Rooms <b>5</b>	2.Fair 5.Avg+ 8.Exc
OPEN-3-CUSTOM <b>0</b>	# Bedrooms <b>3</b>	3.Avg- 6.Good 9.Same
OPEN-4-CUSTOM <b>0</b>	# Full Baths <b>2</b>	Phys. % Good <b>0%</b>
Year Built <b>1900</b>	# Half Baths <b>0</b>	Funct. % Good <b>100%</b>
Year Remodeled <b>0</b>	# Addn Fixtures <b>0</b>	Functional Code <b>9 None</b>
Foundation <b>1 Concrete</b>	# Fireplaces <b>0</b>	1.Incomp 4.Delap 7.No Power
1.Concrete 4.Wood 7.		2.O-Built 5.Bsmt 8.LongTerm
2.C Block 5.Slab 8.		3.Damage 6.Common 9.None
3.Br/Stone 6.Piers 9.		Econ. % Good <b>100%</b>
Basement <b>4 Full Basement</b>		Economic Code <b>None</b>
1.1/4 Bmt 4.Full Bmt 7.		0.None 3.No Power 7.
2.1/2 Bmt 5.None 8.		1.Location 4.Generate 8.
3.3/4 Bmt 6. 9.None		2.Encroach 9.None 9.
Bsmt Gar # Cars <b>0</b>		Entrance Code <b>1 Interior Inspect</b>
Wet Basement <b>1 Dry Basement</b>		1.Interior 4.Vacant 7.
1.Dry 4. 7.		2.Refusal 5.Estimate 8.
2.Damp 5. 8.	3.Informed 6.Reviewed 9.	
3.Wet 6. 9.	Information Code <b>1 Owner</b>	
		1.Owner 4.Agent 7.
		2.Relative 5.Estimate 8.
		3.Tenant 6.Other 9.

Date Inspected 10/27/2018

### Additions, Outbuildings & Improvements

Type	Year	Units	Grade	Cond	Phys.	Funct.	Sound Value
25 Frame Bay	1900	16	9 100	9	0 %	100 %	
68 Wood Deck	2000	168	3 100	4	0 %	100 %	
21 Open Frame	1970	16	3 100	5	0 %	100 %	
23 Frame Garage	1970	380	3 100	5	0 %	90 %	
24 Frame Shed	0				%	%	150
					%	%	
					%	%	
					%	%	
					%	%	
					%	%	
					%	%	
					%	%	

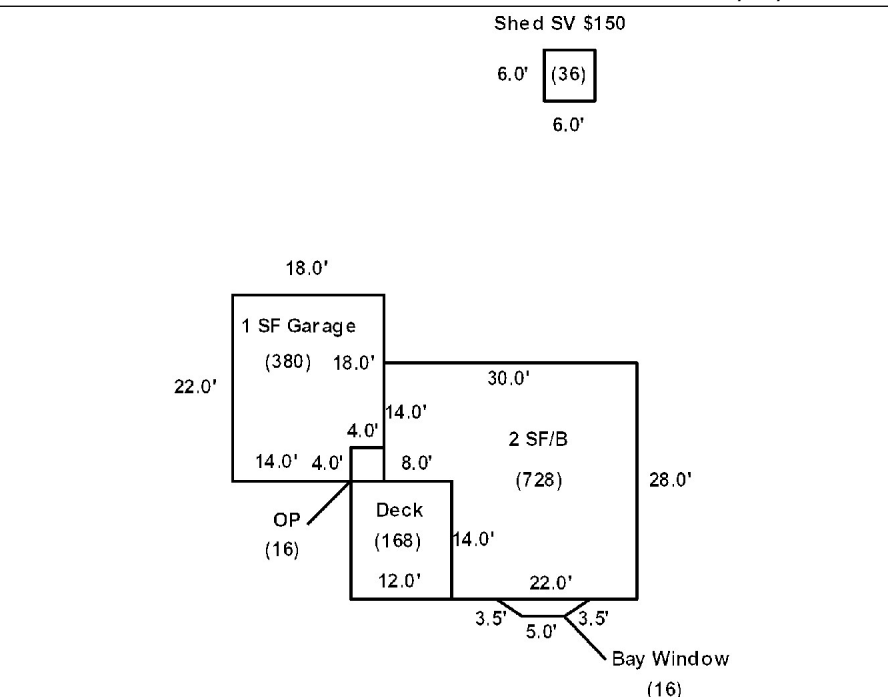



## Washburn

Map Lot 012-042

Account 881

Location 1236 Main Street

Card 1 Of 1 12/09/2022

Building Style <b>4 Cape Cod</b>	SF Bsmt Living <b>0</b>	Layout <b>1 Typical</b>
1.Conv. 5.Garrison 9.Gambrel	Fin Bsmt Grade <b>0 0</b>	1.Typical 4. 7.
2.Ranch 6.Salt Box 10.Other	OPEN 5 OPTIONAL <b>0</b>	2.Inadeq 5. 8.
3.R Ranch 7.Contemp 11.Split	Heat Type <b>100% 5 Forced Warm Air</b>	3.Pool 6. 9.
4.Cape 8.Log 12.	1.HWBB 5.FWA 9.No Heat	Attic <b>9 None</b>
Dwelling Units <b>1</b>	2.HWCI 6.GravWA 10.	1.1/4 Fin 4.Full Fin 7.
Other Units <b>0</b>	3.H Pump 7.Electric 11.	2.1/2 Fin 5.FI/Stair 8.
Stories <b>4 One &amp; 1/2 Story</b>	4.Steam 8.FI/Wall 12.	3.3/4 Fin 6. 9.None
1.1 4.1.5 7.	Cool Type <b>100% 3 Heat Pump</b>	Insulation <b>1 Full</b>
2.2 5.1.75 8.	1.Refrig 4.W&C Air 7.	1.Full 4.Minimal 7.
3.3 6.2.5 9.	2.Evapor 5. 8.	2.Heavy 5.Partial 8.
Exterior Walls <b>2 Vinyl/Aluminum</b>	3.H Pump 6. 9.None	3.Capped 6. 9.None
1.Wood 5.Stucco 9.T-111	Kitchen Style <b>2 Typical</b>	Unfinished % <b>0%</b>
2.Vin/Al 6.Brick 10.Other	1.Modern 4.Obsolete 7.	Grade & Factor <b>3 Average 90%</b>
3.Compos. 7.Stone 11.	2.Typical 5. 8.	1.E Grade 4.B Grade 7.
4.Asbestos 8.Concrete 12.	3.Old Type 6. 9.None	2.D Grade 5.A Grade 8.SC Grade
Roof Surface <b>3 Sheet Metal</b>	Bath(s) Style <b>2 Typical Bath(s)</b>	3.C Grade 6.AA Grade 9.Same
1.Asphalt 4.Composit 7.	1.Modern 4.Obsolete 7.	SQFT (Footprint) <b>1048</b>
2.Slate 5.Wood 8.	2.Typical 5. 8.	Condition <b>6 Good</b>
3.Metal 6.Other 9.	3.Old Type 6. 9.None	1.Poor 4.Avg 7.V G
SF Masonry Trim <b>0</b>	# Rooms <b>7</b>	2.Fair 5.Avg+ 8.Exc
OPEN-3-CUSTOM <b>0</b>	# Bedrooms <b>3</b>	3.Avg- 6.Good 9.Same
OPEN-4-CUSTOM <b>0</b>	# Full Baths <b>2</b>	Phys. % Good <b>0%</b>
Year Built <b>1900</b>	# Half Baths <b>0</b>	Funct. % Good <b>100%</b>
Year Remodeled <b>1990</b>	# Addn Fixtures <b>0</b>	Functional Code <b>9 None</b>
Foundation <b>1 Concrete</b>	# Fireplaces <b>0</b>	1.Incomp 4.Delap 7.No Power
1.Concrete 4.Wood 7.	 <p><b>TRIO</b> Software <i>A Division of Harris Computer Systems</i></p>	2.O-Built 5.Bsmt 8.LongTerm
2.C Block 5.Slab 8.		3.Damage 6.Common 9.None
3.Br/Stone 6.Piers 9.		Econ. % Good <b>100%</b>
Basement <b>4 Full Basement</b>		Economic Code <b>None</b>
1.1/4 Bmt 4.Full Bmt 7.		0.None 3.No Power 7.
2.1/2 Bmt 5.None 8.		1.Location 4.Generate 8.
3.3/4 Bmt 6. 9.None		2.Encroach 9.None 9.
Bsmt Gar # Cars <b>0</b>		Entrance Code <b>5 Estimated</b>
Wet Basement <b>3 Wet Basement</b>		1.Interior 4.Vacant 7.
1.Dry 4. 7.		2.Refusal 5.Estimate 8.
2.Damp 5. 8.	3.Informed 6.Reviewed 9.	
3.Wet 6. 9.	Information Code <b>5 Estimate</b>	
	1.Owner 4.Agent 7.	
	2.Relative 5.Estimate 8.	
	3.Tenant 6.Other 9.	

Date Inspected 10/27/2018

### Additions, Outbuildings & Improvements

Type	Year	Units	Grade	Cond	Phys.	Funct.	Sound Value
21 Open Frame	1950	24	3 100	4	0 %	100 %	
22 Encl Frame Porch	1950	120	3 105	4	0 %	100 %	
68 Wood Deck	2000	496	3 100	4	0 %	100 %	
78 3/4S-Ad/Gar	1900	952	3 95	6	0 %	90 %	
					%	%	
					%	%	
					%	%	
					%	%	
					%	%	
					%	%	
					%	%	

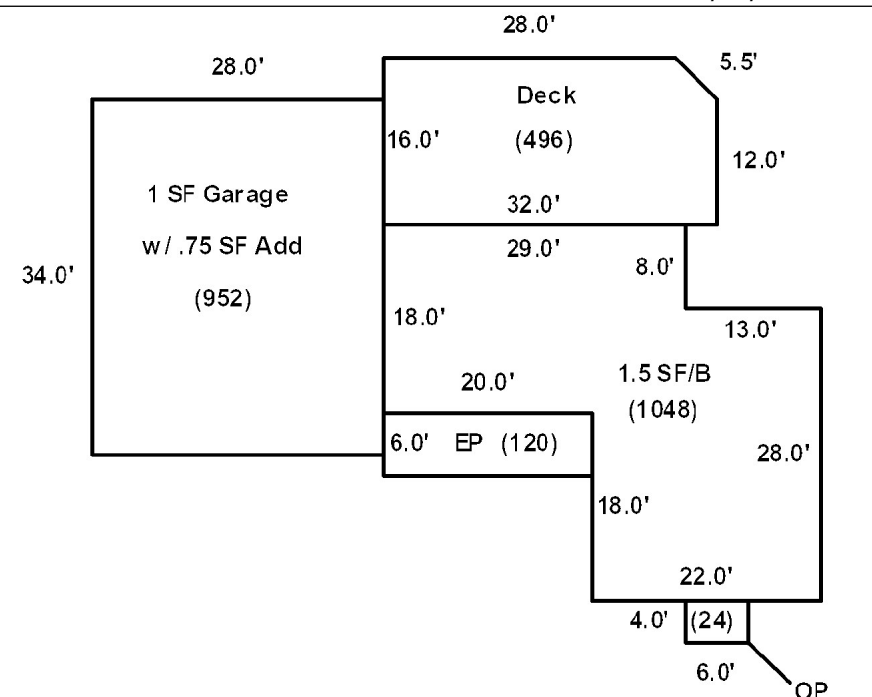



**Washburn**

Map Lot 012-043

Account 746

Location 1240 Main Street - McKay

Card 1 Of 1 12/09/2022

Building Style <b>0</b>	SF Bsmt Living <b>0</b>	Layout <b>0</b>
1.Conv. 5.Garrison 9.Gambrel	Fin Bsmt Grade <b>0 0</b>	1.Typical 4. 7.
2.Ranch 6.Salt Box 10.Other	OPEN 5 OPTIONAL <b>0</b>	2.Inadeq 5. 8.
3.R Ranch 7.Contemp 11.Split	Heat Type <b>100% 0</b>	3.Poor 6. 9.
4.Cape 8.Log 12.	1.HWBB 5.FWA 9.No Heat	Attic <b>0</b>
Dwelling Units <b>0</b>	2.HWCI 6.GravWA 10.	1.1/4 Fin 4.Full Fin 7.
Other Units <b>0</b>	3.H Pump 7.Electric 11.	2.1/2 Fin 5.F/Stair 8.
Stories <b>0</b>	4.Steam 8.F/Wall 12.	3.3/4 Fin 6. 9.None
1.1 4.1.5 7.	Cool Type <b>0% 9 None</b>	Insulation <b>0</b>
2.2 5.1.75 8.	1.Refrig 4.W&C Air 7.	1.Full 4.Minimal 7.
3.3 6.2.5 9.	2.Evapor 5. 8.	2.Heavy 5.Partial 8.
Exterior Walls <b>0</b>	3.H Pump 6. 9.None	3.Capped 6. 9.None
1.Wood 5.Stucco 9.T-111	Kitchen Style <b>0</b>	Unfinished % <b>0%</b>
2.Vin/Al 6.Brick 10.Other	1.Modern 4.Obsolete 7.	Grade & Factor <b>0 0%</b>
3.Compos. 7.Stone 11.	2.Typical 5. 8.	1.E Grade 4.B Grade 7.
4.Asbestos 8.Concrete 12.	3.Old Type 6. 9.None	2.D Grade 5.A Grade 8.SC Grade
Roof Surface <b>0</b>	Bath(s) Style <b>0</b>	3.C Grade 6.AA Grade 9.Same
1.Asphalt 4.Composit 7.	1.Modern 4.Obsolete 7.	SQFT (Footprint) <b>0</b>
2.Slate 5.Wood 8.	2.Typical 5. 8.	Condition <b>0</b>
3.Metal 6.Other 9.	3.Old Type 6. 9.None	1.Poor 4.Avg 7.V G
SF Masonry Trim <b>0</b>	# Rooms <b>0</b>	2.Fair 5.Avg+ 8.Exc
OPEN-3-CUSTOM <b>0</b>	# Bedrooms <b>0</b>	3.Avg- 6.Good 9.Same
OPEN-4-CUSTOM <b>0</b>	# Full Baths <b>0</b>	Phys. % Good <b>0%</b>
Year Built <b>0</b>	# Half Baths <b>0</b>	Funct. % Good <b>100%</b>
Year Remodeled <b>0</b>	# Addn Fixtures <b>0</b>	Functional Code <b>9 None</b>
Foundation <b>0</b>	# Fireplaces <b>0</b>	1.Incomp 4.Delap 7.No Power
1.Concrete 4.Wood 7.		2.O-Built 5.Bsmt 8.LongTerm
2.C Block 5.Slab 8.		3.Damage 6.Common 9.None
3.Br/Stone 6.Piers 9.		Econ. % Good <b>100%</b>
Basement <b>0</b>		Economic Code <b>None</b>
1.1/4 Bmt 4.Full Bmt 7.		0.None 3.No Power 7.
2.1/2 Bmt 5.None 8.		1.Location 4.Generate 8.
3.3/4 Bmt 6. 9.None		2.Encroach 9.None 9.
Bsmt Gar # Cars <b>0</b>		Entrance Code <b>0</b>
Wet Basement <b>0</b>		1.Interior 4.Vacant 7.
1.Dry 4. 7.		2.Refusal 5.Estimate 8.
2.Damp 5. 8.	3.Informed 6.Reviewed 9.	
3.Wet 6. 9.	Information Code <b>0</b>	
		1.Owner 4.Agent 7.
		2.Relative 5.Estimate 8.
		3.Tenant 6.Other 9.

Date Inspected

**Additions, Outbuildings & Improvements**

Type	Year	Units	Grade	Cond	Phys.	Funct.	Sound Value
					%	%	1.One Story Fram
					%	%	2.Two Story Fram
					%	%	3.Three Story Fr
					%	%	4.1 & 1/2 Story
					%	%	5.1 & 3/4 Story
					%	%	6.2 & 1/2 Story
					%	%	21.Open Frame Por
					%	%	22.Encl Frame Por
					%	%	23.Frame Garage
					%	%	24.Frame Shed
					%	%	25.Frame Bay Wind
					%	%	26.1SFr Overhang
					%	%	27.Unfin Basement
					%	%	28.Unfinished Att
					%	%	29.Finished Attic



SPERREY, RODNEY R  
SPERREY, CHERYL M  
PO BOX 284  
WASHBURN ME 04786  
  
B1941P39 B5144P147

Property Data			Assessment Record				
Neighborhood <b>1 Neighborhood One</b>			Year	Land	Buildings	Exempt	Total
Tree Growth Year <b>0</b>			2009	9,500	42,400	9,000	42,900
1ST MORTGAGE <b>0</b>			2012	9,500	42,400	8,800	43,100
2ND MORTGAGE <b>0</b>			2013	9,500	42,400	8,800	43,100
Zone/Land Use <b>1 Residential</b>			2015	9,500	42,400	9,000	42,900
Secondary Zone			2018	9,500	42,400	18,400	33,500
Topography <b>1 Level</b>			2019	16,900	69,000	20,000	65,900
1.Level 4.Below St 7.LevelBog			2020	16,900	69,000	25,000	60,900
2.Rolling 5.Low 8.			2021	16,900	69,000	25,000	60,900
3.Above St 6.Swampy 9.			2022	16,900	72,400	25,000	64,300
Utilities <b>2 Public Water 3 Public Sewer</b>							
1.Public 4.Dr Well 7.Cesspool							
2.Water 5.Dug Well 8.							
3.Sewer 6.Septic 9.None							
Street <b>1 Paved</b>							
1.Paved 4.Proposed 7.							
2.Semi Imp 5.R/O/W 8.							
3.Gravel 6. 9.None							
TG PLAN YEAR <b>0</b>							
Tif District # <b>0</b>							
Sale Data							
Sale Date <b>11/05/1986</b>							
Price							
Sale Type <b>2 Land &amp; Buildings</b>							
1.Land 4.Mobile 7.C/I L&B							
2.L & B 5.Other 8.							
3.Building 6.C/I Land 9.							
Financing							
1.Convent 4.Seller 7.							
2.FHA/VA 5.Private 8.							
3.Assumed 6.Cash 9.Unknown							
Validity <b>1 Arms Length Sale</b>							
1.Valid 4.Split 7.Renovate							
2.Related 5.Partial 8.Other							
3.Distress 6.Exempt 9.							
Verified <b>5 Public Record</b>							
1.Buyer 4.Agent 7.Family							
2.Seller 5.Pub Rec 8.Other							
3.Lender 6.MLS 9.							

Inspection Witnessed By:

No./Date	Description	Date Insp.
X		

Notes:  
\*5-10-2019 -5% for attached 1.75 SF Barn and -50% for delap.

Washburn

Land Data						
Front Foot	Type	Effective		Influence		Influence Codes
		Frontage	Depth	Factor	Code	
11.Regular Lot				%		1.Unimproved
12.Delta Triangle				%		2.Excess Frtg
13.Nabla Triangle				%		3.Topography
14.Rear Land				%		4.Size/Shape
15.Class I Road				%		5.Access
				%		6.Restriction
				%		7.Open Space
				%		8.View/Environ
				%		9.Fract Share
				%		<b>Acres</b>
				%		30.Utility R O W
				%		31.Tillable
				%		32.Pasture
				%		33.Orchard
				%		34.Softwood F&O
				%		35.Mixed Wood F&O
				%		36.Hardwood F&O
				%		37.Softwood TG
				%		38.Mixed Wood TG
				%		39.Hardwood TG
				%		40.Wasteland
				%		41.Open Space
				%		42.Mobile Home Si
				%		43.Condo Site
				%		44.Lot Improvemen
				%		45.Subdivision Lo
				%		46.Heavy Ind Sit
<b>Total Acreage</b>		1.76				

## Washburn

Map Lot 012-044

Account 861

Location 1248 MAIN STREET

Card 1

Of 1

12/09/2022

Building Style <b>4 Cape Cod</b> 1.Conv. 5.Garrison 9.Gambrel 2.Ranch 6.Salt Box 10.Other 3.R Ranch 7.Contemp 11.Split 4.Cape 8.Log 12.	SF Bsmt Living <b>0</b> Fin Bsmt Grade <b>0 0</b> OPEN 5 OPTIONAL <b>0</b> Heat Type <b>100% 5 Forced Warm Air</b> 1.HWBB 5.FWA 9.No Heat 2.HWCI 6.GravWA 10. 3.H Pump 7.Electric 11. 4.Steam 8.Fi/Wall 12.	Layout <b>1 Typical</b> 1.Typical 4. 7. 2.Inadeq 5. 8. 3.Poor 6. 9. Attic <b>9 None</b> 1.1/4 Fin 4.Full Fin 7. 2.1/2 Fin 5.Fi/Stair 8. 3.3/4 Fin 6. 9.None	
Dwelling Units <b>1</b> Other Units <b>0</b> Stories <b>4 One &amp; 1/2 Story</b> 1.1 4.1.5 7. 2.2 5.1.75 8. 3.3 6.2.5 9.	Cool Type <b>0% 9 None</b> 1.Refrig 4.W&C Air 7. 2.Evapor 5. 8. 3.H Pump 6. 9.None	Insulation <b>4 Minimal</b> 1.Full 4.Minimal 7. 2.Heavy 5.Partial 8. 3.Capped 6. 9.None	
Exterior Walls <b>1 Wood Siding</b> 1.Wood 5.Stucco 9.T-111 2.Vin/Al 6.Brick 10.Other 3.Compos. 7.Stone 11. 4.Asbestos 8.Concrete 12.	Kitchen Style <b>2 Typical</b> 1.Modern 4.Obsolete 7. 2.Typical 5. 8. 3.Old Type 6. 9.None	Unfinished % <b>0%</b> Grade & Factor <b>2 Fair 110%</b> 1.E Grade 4.B Grade 7. 2.D Grade 5.A Grade 8.SC Grade 3.C Grade 6.AA Grade 9.Same	
Roof Surface <b>1 Asphalt Shingles</b> 1.Asphalt 4.Composit 7. 2.Slate 5.Wood 8. 3.Metal 6.Other 9.	Bath(s) Style <b>2 Typical Bath(s)</b> 1.Modern 4.Obsolete 7. 2.Typical 5. 8. 3.Old Type 6. 9.None	SQFT (Footprint) <b>884</b> Condition <b>5 Above Average</b> 1.Poor 4.Avg 7.V G 2.Fair 5.Avg+ 8.Exc 3.Avg- 6.Good 9.Same	
SF Masonry Trim <b>0</b> OPEN-3-CUSTOM <b>0</b> OPEN-4-CUSTOM <b>0</b> Year Built <b>1897</b> Year Remodeled <b>0</b> Foundation <b>3 Brick &amp;/or Stone</b> 1.Concrete 4.Wood 7. 2.C Block 5.Slab 8. 3.Br/Stone 6.Piers 9.	# Rooms <b>7</b> # Bedrooms <b>4</b> # Full Baths <b>2</b> # Half Baths <b>0</b> # Addn Fixtures <b>0</b> # Fireplaces <b>1</b>	Phys. % Good <b>0%</b> Funct. % Good <b>100%</b> Functional Code <b>9 None</b> 1.Incomp 4.Delap 7.No Power 2.O-Built 5.Bsmt 8.LongTerm 3.Damage 6.Common 9.None Econ. % Good <b>100%</b> Economic Code <b>None</b> 0.None 3.No Power 7. 1.Location 4.Generate 8. 2.Encroach 9.None 9.	
Basement <b>4 Full Basement</b> 1.1/4 Bmt 4.Full Bmt 7. 2.1/2 Bmt 5.None 8. 3.3/4 Bmt 6. 9.None Bsmt Gar # Cars <b>0</b> Wet Basement <b>1 Dry Basement</b> 1.Dry 4. 7. 2.Damp 5. 8. 3.Wet 6. 9.			
Entrance Code <b>1 Interior Inspect</b> 1.Interior 4.Vacant 7. 2.Refusal 5.Estimate 8. 3.Informed 6.Reviewed 9.			
Information Code <b>1 Owner</b> 1.Owner 4.Agent 7. 2.Relative 5.Estimate 8. 3.Tenant 6.Other 9.			

Date Inspected 10/27/2018

### Additions, Outbuildings & Improvements

Type	Year	Units	Grade	Cond	Phys.	Funct.	Sound Value
116 1.75 Story Barn	1900	1800	2 110	2	0 %	45 %	
21 Open Frame	1897	531	3 90	5	0 %	100 %	
20 1 Story/Bsmt	1897	21	9 100	9	0 %	100 %	
20 1 Story/Bsmt	1897	42	9 100	9	0 %	100 %	
20 1 Story/Bsmt	1920	80	3 90	5	0 %	100 %	
1 One Story Frame	1950	48	3 90	4	0 %	100 %	
					%	%	
					%	%	
					%	%	
					%	%	













## Washburn

Map Lot 012-047

Account 1010

Location 1260 Main St - Health Care Ctr

Card 1

Of 1

12/09/2022

Building Style <b>0</b>	SF Bsmt Living <b>0</b>	Layout <b>0</b>
1.Conv. 5.Garrison 9.Gambrel	Fin Bsmt Grade <b>0 0</b>	1.Typical 4. 7.
2.Ranch 6.Salt Box 10.Other	OPEN 5 OPTIONAL <b>0</b>	2.Inadeq 5. 8.
3.R Ranch 7.Contemp 11.Split	Heat Type <b>100% 0</b>	3.Poor 6. 9.
4.Cape 8.Log 12.	1.HWBB 5.FWA 9.No Heat	Attic <b>0</b>
Dwelling Units <b>0</b>	2.HWCI 6.GravWA 10.	1.1/4 Fin 4.Full Fin 7.
Other Units <b>0</b>	3.H Pump 7.Electric 11.	2.1/2 Fin 5.F/Stair 8.
Stories <b>0</b>	4.Steam 8.F/Wall 12.	3.3/4 Fin 6. 9.None
1.1 4.1.5 7.	Cool Type <b>0% 9 None</b>	Insulation <b>0</b>
2.2 5.1.75 8.	1.Refrig 4.W&C Air 7.	1.Full 4.Minimal 7.
3.3 6.2.5 9.	2.Evapor 5. 8.	2.Heavy 5.Partial 8.
Exterior Walls <b>0</b>	3.H Pump 6. 9.None	3.Capped 6. 9.None
1.Wood 5.Stucco 9.T-111	Kitchen Style <b>0</b>	Unfinished % <b>0%</b>
2.Vin/Al 6.Brick 10.Other	1.Modern 4.Obsolete 7.	Grade & Factor <b>0 0%</b>
3.Compos. 7.Stone 11.	2.Typical 5. 8.	1.E Grade 4.B Grade 7.
4.Asbestos 8.Concrete 12.	3.Old Type 6. 9.None	2.D Grade 5.A Grade 8.SC Grade
Roof Surface <b>0</b>	Bath(s) Style <b>0</b>	3.C Grade 6.AA Grade 9.Same
1.Asphalt 4.Composit 7.	1.Modern 4.Obsolete 7.	SQFT (Footprint) <b>0</b>
2.Slate 5.Wood 8.	2.Typical 5. 8.	Condition <b>0</b>
3.Metal 6.Other 9.	3.Old Type 6. 9.None	1.Poor 4.Avg 7.V G
SF Masonry Trim <b>0</b>	# Rooms <b>0</b>	2.Fair 5.Avg+ 8.Exc
OPEN-3-CUSTOM <b>0</b>	# Bedrooms <b>0</b>	3.Avg- 6.Good 9.Same
OPEN-4-CUSTOM <b>0</b>	# Full Baths <b>0</b>	Phys. % Good <b>0%</b>
Year Built <b>0</b>	# Half Baths <b>0</b>	Funct. % Good <b>100%</b>
Year Remodeled <b>0</b>	# Addn Fixtures <b>0</b>	Functional Code <b>9 None</b>
Foundation <b>0</b>	# Fireplaces <b>0</b>	1.Incomp 4.Delap 7.No Power
1.Concrete 4.Wood 7.		2.O-Built 5.Bsmt 8.LongTerm
2.C Block 5.Slab 8.		3.Damage 6.Common 9.None
3.Br/Stone 6.Piers 9.		Econ. % Good <b>100%</b>
Basement <b>0</b>		Economic Code <b>None</b>
1.1/4 Bmt 4.Full Bmt 7.		0.None 3.No Power 7.
2.1/2 Bmt 5.None 8.		1.Location 4.Generate 8.
3.3/4 Bmt 6. 9.None		2.Encroach 9.None 9.
Bsmt Gar # Cars <b>0</b>		Entrance Code <b>5 Estimated</b>
Wet Basement <b>0</b>		1.Interior 4.Vacant 7.
1.Dry 4. 7.		2.Refusal 5.Estimate 8.
2.Damp 5. 8.		3.Informed 6.Reviewed 9.
3.Wet 6. 9.		Information Code <b>5 Estimate</b>
		1.Owner 4.Agent 7.
		2.Relative 5.Estimate 8.
		3.Tenant 6.Other 9.



Date Inspected 10/27/2018

### Additions, Outbuildings & Improvements

Type	Year	Units	Grade	Cond	Phys.	Funct.	Sound Value
20 1 Story/Bsmt	2000	2012	3 110	4	0 %	100 %	
21 Open Frame	2000	136	3 100	4	0 %	100 %	
40 Basement Entry	2000	95	3 100	4	0 %	100 %	
					%	%	
					%	%	
					%	%	
					%	%	
					%	%	
					%	%	
					%	%	
					%	%	

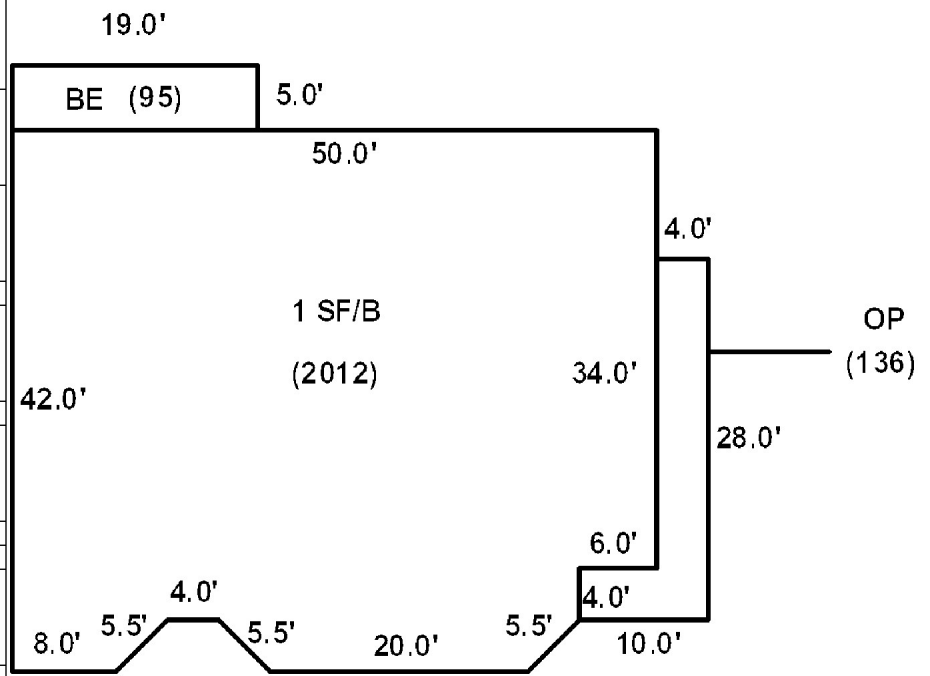





## Washburn

Map Lot 012-048

Account 1057

Location 1266 MAIN STREET

Card 1 Of 1 12/09/2022

Building Style <b>1 Conventional</b> 1.Conv. 5.Garrison 9.Gambrel 2.Ranch 6.Salt Box 10.Other 3.R Ranch 7.Contemp 11.Split 4.Cape 8.Log 12.	SF Bsmt Living <b>0</b> Fin Bsmt Grade <b>0 0</b> OPEN 5 OPTIONAL <b>0</b> Heat Type <b>100% 5 Forced Warm Air</b> 1.HWBB 5.FWA 9.No Heat 2.HWCI 6.GravWA 10. 3.H Pump 7.Electric 11. 4.Steam 8.Fi/Wall 12.	Layout <b>1 Typical</b> 1.Typical 4. 7. 2.Inadeq 5. 8. 3.Poor 6. 9. Attic <b>9 None</b> 1.1/4 Fin 4.Full Fin 7. 2.1/2 Fin 5.Fi/Stair 8. 3.3/4 Fin 6. 9.None		
Dwelling Units <b>1</b> Other Units <b>0</b>	Cool Type <b>0% 9 None</b> 1.Refrig 4.W&C Air 7. 2.Evapor 5. 8. 3.H Pump 6. 9.None	Insulation <b>1 Full</b> 1.Full 4.Minimal 7. 2.Heavy 5.Partial 8. 3.Capped 6. 9.None		
Stories <b>2 Two Story</b> 1.1 4.1.5 7. 2.2 5.1.75 8. 3.3 6.2.5 9.	Kitchen Style <b>2 Typical</b> 1.Modern 4.Obsolete 7. 2.Typical 5. 8. 3.Old Type 6. 9.None	Unfinished % <b>0%</b> Grade & Factor <b>2 Fair 110%</b> 1.E Grade 4.B Grade 7. 2.D Grade 5.A Grade 8.SC Grade 3.C Grade 6.AA Grade 9.Same		
Exterior Walls <b>2 Vinyl/Aluminum</b> 1.Wood 5.Stucco 9.T-111 2.Vin/Al 6.Brick 10.Other 3.Compos. 7.Stone 11. 4.Asbestos 8.Concrete 12.	Bath(s) Style <b>2 Typical Bath(s)</b> 1.Modern 4.Obsolete 7. 2.Typical 5. 8. 3.Old Type 6. 9.None	SQFT (Footprint) <b>644</b> Condition <b>6 Good</b> 1.Poor 4.Avg 7.V G 2.Fair 5.Avg+ 8.Exc 3.Avg- 6.Good 9.Same		
Roof Surface <b>1 Asphalt Shingles</b> 1.Asphalt 4.Composit 7. 2.Slate 5.Wood 8. 3.Metal 6.Other 9.	SF Masonry Trim <b>0</b> OPEN-3-CUSTOM <b>0</b> OPEN-4-CUSTOM <b>0</b>	Phys. % Good <b>0%</b> Funct. % Good <b>100%</b> Functional Code <b>9 None</b> 1.Incomp 4.Delap 7.No Power 2.O-Built 5.Bsmt 8.LongTerm 3.Damage 6.Common 9.None		
Foundation <b>1 Concrete</b> 1.Concrete 4.Wood 7. 2.C Block 5.Slab 8. 3.Br/Stone 6.Piers 9.	# Rooms <b>8</b> # Bedrooms <b>4</b> # Full Baths <b>1</b> # Half Baths <b>1</b> # Addn Fixtures <b>0</b> # Fireplaces <b>1</b>	Econ. % Good <b>100%</b> Economic Code <b>None</b> 0.None 3.No Power 7. 1.Location 4.Generate 8. 2.Encroach 9.None 9.		
Basement <b>4 Full Basement</b> 1.1/4 Bmt 4.Full Bmt 7. 2.1/2 Bmt 5.None 8. 3.3/4 Bmt 6. 9.None		Entrance Code <b>3 Information Only</b> 1.Interior 4.Vacant 7. 2.Refusal 5.Estimate 8. 3.Informed 6.Reviewed 9.		
Bsmt Gar # Cars <b>0</b> Wet Basement <b>1 Dry Basement</b> 1.Dry 4. 7. 2.Damp 5. 8. 3.Wet 6. 9.		Information Code <b>1 Owner</b> 1.Owner 4.Agent 7. 2.Relative 5.Estimate 8. 3.Tenant 6.Other 9.		

Date Inspected 10/27/2018

### Additions, Outbuildings & Improvements

Type	Year	Units	Grade	Cond	Phys.	Funct.	Sound Value
22 Encl Frame Porch	1940	182	3 90	5	0 %	100 %	
61 Canopy	1950	277	3 95	4	0 %	100 %	
1 One Story Frame	1940	40	2 110	6	0 %	100 %	
40 Basement Entry	1940	220	2 115	4	0 %	100 %	
14 1.5 Story/Bsmt	1940	512	9 100	9	0 %	100 %	
21 Open Frame	1960	216	3 100	4	0 %	100 %	
23 Frame Garage	1940	252	2 100	3	0 %	100 %	
					%	%	
					%	%	
					%	%	





## Washburn

Map Lot 012-049

Account 177

Location 1268 Main Street

Card 1 Of 1 12/09/2022

Building Style <b>0</b>	SF Bsmt Living <b>0</b>	Layout <b>0</b>
1.Conv. 5.Garrison 9.Gambrel	Fin Bsmt Grade <b>0 0</b>	1.Typical 4. 7.
2.Ranch 6.Salt Box 10.Other	OPEN 5 OPTIONAL <b>0</b>	2.Inadeq 5. 8.
3.R Ranch 7.Contemp 11.Split	Heat Type <b>100% 0</b>	3.Poor 6. 9.
4.Cape 8.Log 12.	1.HWBB 5.FWA 9.No Heat	Attic <b>0</b>
Dwelling Units <b>0</b>	2.HWCI 6.GravWA 10.	1.1/4 Fin 4.Full Fin 7.
Other Units <b>0</b>	3.H Pump 7.Electric 11.	2.1/2 Fin 5.FI/Stair 8.
Stories <b>0</b>	4.Steam 8.FI/Wall 12.	3.3/4 Fin 6. 9.None
1.1 4.1.5 7.	Cool Type <b>0% 9 None</b>	Insulation <b>0</b>
2.2 5.1.75 8.	1.Refrig 4.W&C Air 7.	1.Full 4.Minimal 7.
3.3 6.2.5 9.	2.Evapor 5. 8.	2.Heavy 5.Partial 8.
Exterior Walls <b>0</b>	3.H Pump 6. 9.None	3.Capped 6. 9.None
1.Wood 5.Stucco 9.T-111	Kitchen Style <b>0</b>	Unfinished % <b>0%</b>
2.Vin/Al 6.Brick 10.Other	1.Modern 4.Obsolete 7.	Grade & Factor <b>0 0%</b>
3.Compos. 7.Stone 11.	2.Typical 5. 8.	1.E Grade 4.B Grade 7.
4.Asbestos 8.Concrete 12.	3.Old Type 6. 9.None	2.D Grade 5.A Grade 8.SC Grade
Roof Surface <b>0</b>	Bath(s) Style <b>0</b>	3.C Grade 6.AA Grade 9.Same
1.Asphalt 4.Composit 7.	1.Modern 4.Obsolete 7.	SQFT (Footprint) <b>0</b>
2.Slate 5.Wood 8.	2.Typical 5. 8.	Condition <b>0</b>
3.Metal 6.Other 9.	3.Old Type 6. 9.None	1.Poor 4.Avg 7.V G
SF Masonry Trim <b>0</b>	# Rooms <b>0</b>	2.Fair 5.Avg+ 8.Exc
OPEN-3-CUSTOM <b>0</b>	# Bedrooms <b>0</b>	3.Avg- 6.Good 9.Same
OPEN-4-CUSTOM <b>0</b>	# Full Baths <b>0</b>	Phys. % Good <b>0%</b>
Year Built <b>0</b>	# Half Baths <b>0</b>	Funct. % Good <b>100%</b>
Year Remodeled <b>0</b>	# Addn Fixtures <b>0</b>	Functional Code <b>9 None</b>
Foundation <b>0</b>	# Fireplaces <b>0</b>	1.Incomp 4.Delap 7.No Power
1.Concrete 4.Wood 7.		2.O-Built 5.Bsmt 8.LongTerm
2.C Block 5.Slab 8.		3.Damage 6.Common 9.None
3.Br/Stone 6.Piers 9.		Econ. % Good <b>100%</b>
Basement <b>0</b>		Economic Code <b>None</b>
1.1/4 Bmt 4.Full Bmt 7.		0.None 3.No Power 7.
2.1/2 Bmt 5.None 8.		1.Location 4.Generate 8.
3.3/4 Bmt 6. 9.None		2.Encroach 9.None 9.
Bsmt Gar # Cars <b>0</b>		Entrance Code <b>5 Estimated</b>
Wet Basement <b>0</b>		1.Interior 4.Vacant 7.
1.Dry 4. 7.		2.Refusal 5.Estimate 8.
2.Damp 5. 8.		3.Informed 6.Reviewed 9.
3.Wet 6. 9.		Information Code <b>5 Estimate</b>
		1.Owner 4.Agent 7.
		2.Relative 5.Estimate 8.
		3.Tenant 6.Other 9.

Date Inspected 10/27/2018

### Additions, Outbuildings & Improvements

Type	Year	Units	Grade	Cond	Phys.	Funct.	Sound Value
228 Church	1950	2392	2 110	6	0 %	80 %	
1 One Story Frame	1950	90	3 90	4	0 %	100 %	
1 One Story Frame	1950	64	3 90	4	0 %	100 %	
					%	%	
					%	%	
					%	%	
					%	%	
					%	%	
					%	%	
					%	%	
					%	%	

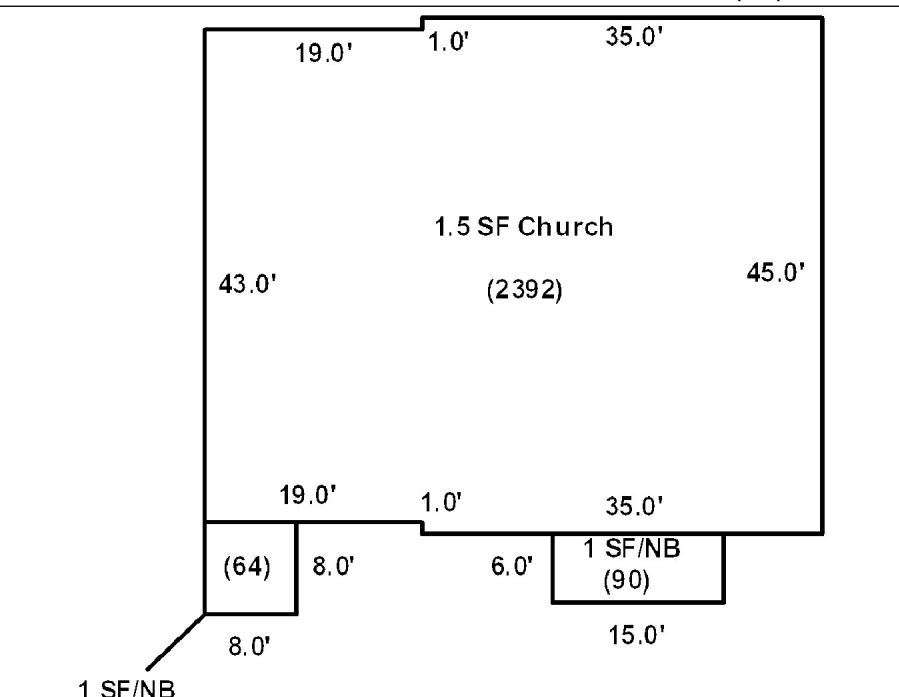



## Washburn

Map Lot 012-050

Account 449

Location 1272 MAIN STREET

Card 1

Of 1

12/09/2022

Building Style <b>1 Conventional</b>	SF Bsmt Living <b>0</b>	Layout <b>1 Typical</b>
1.Conv. 5.Garrison 9.Gambrel	Fin Bsmt Grade <b>0 0</b>	1.Typical 4. 7.
2.Ranch 6.Salt Box 10.Other	OPEN 5 OPTIONAL <b>0</b>	2.Inadeq 5. 8.
3.R Ranch 7.Contemp 11.Split	Heat Type <b>100% 1 Hot Water BB</b>	3.Poor 6. 9.
4.Cape 8.Log 12.	1.HWBB 5.FWA 9.No Heat	Attic <b>9 None</b>
Dwelling Units <b>2</b>	2.HWCI 6.GravWA 10.	1.1/4 Fin 4.Full Fin 7.
Other Units <b>0</b>	3.H Pump 7.Electric 11.	2.1/2 Fin 5.F/Stair 8.
Stories <b>2 Two Story</b>	4.Steam 8.F/Wall 12.	3.3/4 Fin 6. 9.None
1.1 4.1.5 7.	Cool Type <b>0% 9 None</b>	Insulation <b>1 Full</b>
2.2 5.1.75 8.	1.Refrig 4.W&C Air 7.	1.Full 4.Minimal 7.
3.3 6.2.5 9.	2.Evapor 5. 8.	2.Heavy 5.Partial 8.
Exterior Walls <b>2 Vinyl/Aluminum</b>	3.H Pump 6. 9.None	3.Capped 6. 9.None
1.Wood 5.Stucco 9.T-111	Kitchen Style <b>2 Typical</b>	Unfinished % <b>0%</b>
2.Vin/Al 6.Brick 10.Other	1.Modern 4.Obsolete 7.	Grade & Factor <b>2 Fair 110%</b>
3.Compos. 7.Stone 11.	2.Typical 5. 8.	1.E Grade 4.B Grade 7.
4.Asbestos 8.Concrete 12.	3.Old Type 6. 9.None	2.D Grade 5.A Grade 8.SC Grade
Roof Surface <b>3 Sheet Metal</b>	Bath(s) Style <b>2 Typical Bath(s)</b>	3.C Grade 6.AA Grade 9.Same
1.Asphalt 4.Composit 7.	1.Modern 4.Obsolete 7.	SQFT (Footprint) <b>1044</b>
2.Slate 5.Wood 8.	2.Typical 5. 8.	Condition <b>5 Above Average</b>
3.Metal 6.Other 9.	3.Old Type 6. 9.None	1.Poor 4.Avg 7.V G
SF Masonry Trim <b>0</b>	# Rooms <b>10</b>	2.Fair 5.Avg+ 8.Exc
OPEN-3-CUSTOM <b>0</b>	# Bedrooms <b>4</b>	3.Avg- 6.Good 9.Same
OPEN-4-CUSTOM <b>0</b>	# Full Baths <b>2</b>	Phys. % Good <b>0%</b>
Year Built <b>1920</b>	# Half Baths <b>0</b>	Funct. % Good <b>100%</b>
Year Remodeled <b>0</b>	# Addn Fixtures <b>0</b>	Functional Code <b>9 None</b>
Foundation <b>1 Concrete</b>	# Fireplaces <b>0</b>	1.Incomp 4.Delap 7.No Power
1.Concrete 4.Wood 7.	 <p><b>TRIO</b> Software A Division of Harris Computer Systems</p>	2.O-Built 5.Bsmt 8.LongTerm
2.C Block 5.Slab 8.		Econ. % Good <b>100%</b>
3.Br/Stone 6.Piers 9.		Economic Code <b>None</b>
Basement <b>4 Full Basement</b>		0.None 3.No Power 7.
1.1/4 Bmt 4.Full Bmt 7.		1.Location 4.Generate 8.
2.1/2 Bmt 5.None 8.		2.Encroach 9.None 9.
3.3/4 Bmt 6. 9.None		Entrance Code <b>5 Estimated</b>
Bsmt Gar # Cars <b>0</b>		1.Interior 4.Vacant 7.
Wet Basement <b>1 Dry Basement</b>		2.Refusal 5.Estimate 8.
1.Dry 4. 7.		3.Informed 6.Reviewed 9.
2.Damp 5. 8.	Information Code <b>5 Estimate</b>	
3.Wet 6. 9.	1.Owner 4.Agent 7.	
	2.Relative 5.Estimate 8.	
	3.Tenant 6.Other 9.	

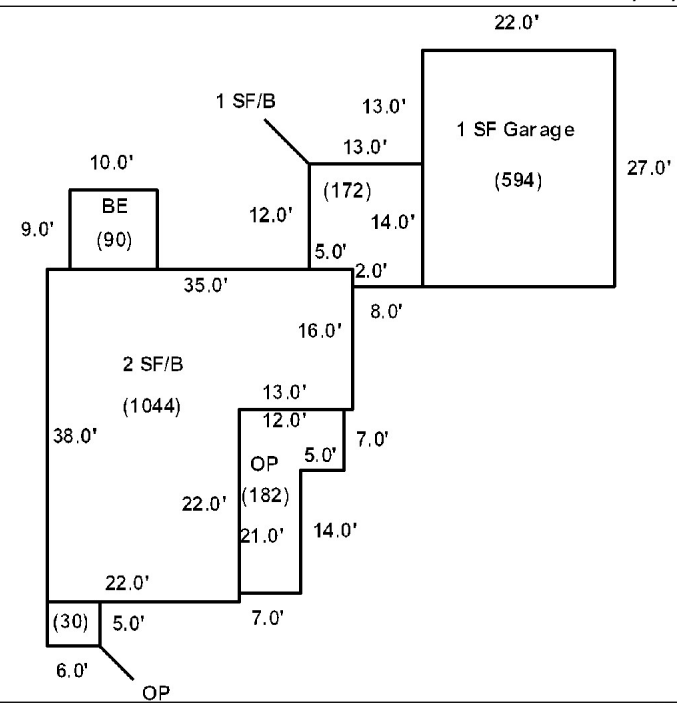

Date Inspected 10/27/2018

### Additions, Outbuildings & Improvements

Type	Year	Units	Grade	Cond	Phys.	Funct.	Sound Value
21 Open Frame	1960	30	9 100	9	0 %	100 %	
21 Open Frame	1960	182	3 100	5	0 %	100 %	
40 Basement Entry	1960	90	3 90	4	0 %	100 %	
20 1 Story/Bsmt	1960	172	9 100	9	0 %	100 %	
23 Frame Garage	1960	594	3 100	5	0 %	90 %	
					%	%	
					%	%	
					%	%	
					%	%	
					%	%	
					%	%	

