

Washburn

Map Lot 001-027

Account 173

Location 1056 WASHBURN ROAD

Card 1 Of 1

12/09/2022

Building Style	1 Conventional		SF Bsmt Living	0		Layout	1 Typical		
1.Conv.	5.Garrison	9.Gambrel	Fin Bsmt Grade	0 0		1.Typical	4.	7.	
2.Ranch	6.Salt Box	10.Other	OPEN 5 OPTIONAL	0		2.Inadeq	5.	8.	
3.R Ranch	7.Contemp	11.Split	Heat Type	100% 8 Floor/Wall Unit		3.Poor	6.	9.	
4.Cape	8.Log	12.	1.HWBB	5.FWA	9.No Heat	Attic	9 None		
Dwelling Units	1		2.HWCI	6.GravWA	10.	1.1/4 Fin	4.Full Fin	7.	
Other Units	0		3.H Pump	7.Electric	11.	2.1/2 Fin	5.FI/Stair	8.	
Stories	1 One Story		4.Steam	8.FI/Wall	12.	3.3/4 Fin	6.	9.None	
1.1	4.1.5	7.	Cool Type	100% 3 Heat Pump		Insulation	1 Full		
2.2	5.1.75	8.	1.Refrig	4.W&C Air	7.	1.Full	4.Minimal	7.	
3.3	6.2.5	9.	2.Evapor	5.	8.	2.Heavy	5.Partial	8.	
Exterior Walls	2 Vinyl/Aluminum		3.H Pump	6.	9.None	3.Capped	6.	9.None	
1.Wood	5.Stucco	9.T-111	Kitchen Style	2 Typical		Unfinished %	0%		
2.Vin/Al	6.Brick	10.Other	1.Modern	4.Obsolete	7.	Grade & Factor	3 Average 95%		
3.Compos.	7.Stone	11.	2.Typical	5.	8.	1.E Grade	4.B Grade	7.	
4.Asbestos	8.Concrete	12.	3.Old Type	6.	9.None	2.D Grade	5.A Grade	8.SC Grade	
Roof Surface	1 Asphalt Shingles		Bath(s) Style	2 Typical Bath(s)		3.C Grade	6.AA Grade	9.Same	
1.Asphalt	4.Composit	7.	1.Modern	4.Obsolete	7.	SQFT (Footprint)	1800		
2.Slate	5.Wood	8.	2.Typical	5.	8.	Condition	5 Above Average		
3.Metal	6.Other	9.	3.Old Type	6.	9.None	1.Poor	4.Avg	7.V G	
SF Masonry Trim	0		# Rooms	5		2.Fair	5.Avg+	8.Exc	
OPEN-3-CUSTOM	0		# Bedrooms	3		3.Avg-	6.Good	9.Same	
OPEN-4-CUSTOM	0		# Full Baths	1		Phys. % Good	0%		
Year Built	2000		# Half Baths	1		Funct. % Good	100%		
Year Remodeled	0		# Addn Fixtures	0		Functional Code	9 None		
Foundation	5 Concrete Slab		# Fireplaces	0		1.Incomp	4.Delap	7.No Power	
1.Concrete	4.Wood	7.	 <p>TRIO Software A Division of Harris Computer Systems</p>	2.O-Built	5.Bsmt	8.LongTerm	3.Damage	6.Common	9.None
2.C Block	5.Slab	8.		Econ. % Good	100%		Economic Code	None	
3.Br/Stone	6.Piers	9.		0.None	3.No Power	7.	1.Location	4.Generate	8.
Basement	9 No Basement			1.Encroach	9.None	9.	2.Inform	6.Reviewed	9.
1.1/4 Bmt	4.Full Bmt	7.		Entrance Code	1 Interior Inspect		1.Interior	4.Vacant	7.
2.1/2 Bmt	5.None	8.		1.Refusal	5.Estimate	8.	2.Inform	6.Reviewed	9.
3.3/4 Bmt	6.	9.None		Information Code	1 Owner		1.Owner	4.Agent	7.
Bsmt Gar # Cars	0			2.Relative	5.Estimate	8.	2.Relative	5.Estimate	8.
Wet Basement	9 No Basement			3.Tenant	6.Other	9.	3.Tenant	6.Other	9.
1.Dry	4.	7.							
2.Damp	5.	8.							
3.Wet	6.	9.							

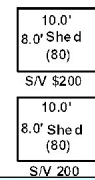
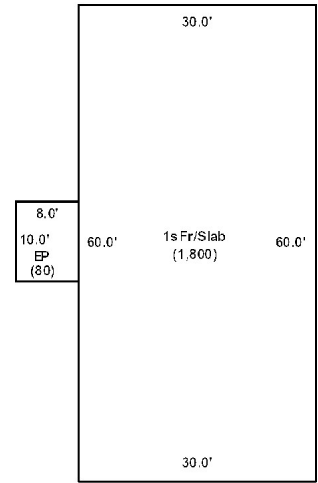

Date Inspected 7/28/2018

Additions, Outbuildings & Improvements

Type	Year	Units	Grade	Cond	Phys.	Funct.	Sound Value
22 Encl Frame Porch	0	80	0 0	0	0 %	0 %	
24 Frame Shed	0				%	%	200
24 Frame Shed	0				%	%	200
					%	%	
					%	%	
					%	%	
					%	%	
					%	%	
					%	%	
					%	%	
					%	%	



- 1.One Story Fram
- 2.Two Story Fram
- 3.Three Story Fr
- 4.1 & 1/2 Story
- 5.1 & 3/4 Story
- 6.2 & 1/2 Story
- 21.Open Frame Por
- 22.Encl Frame Por
- 23.Frame Garage
- 24.Frame Shed
- 25.Frame Bay Wind
- 26.1SFr Overhang
- 27.Unfin Basement
- 28.Unfinished Att
- 29.Finished Attic

Washburn

Map Lot 001-027A

Account 172

Location 1060 WASHBURN ROAD

Card 1 Of 1 12/09/2022

Building Style	3 Raised Ranch			SF Bsmt Living	500			Layout	1 Typical		
1.Conv.	5.Garrison	9.Gambrel		Fin Bsmt Grade	9 100			1.Typical	4.	7.	
2.Ranch	6.Salt Box	10.Other		OPEN 5 OPTIONAL	0			2.Inadeq	5.	8.	
3.R Ranch	7.Contemp	11.Split		Heat Type	100% 1 Hot Water BB			3.Poor	6.	9.	
4.Cape	8.Log	12.		1.HWBB	5.FWA	9.No Heat	Attic	9 None			
Dwelling Units	1			2.HWCI	6.GravWA	10.	1.1/4 Fin	4.Full Fin	7.		
Other Units	0			3.H Pump	7.Electric	11.	2.1/2 Fin	5.FI/Stair	8.		
Stories	1 One Story			4.Steam	8.FI/Wall	12.	3.3/4 Fin	6.	9.None		
1.1	4.1.5	7.		Cool Type	100% 3 Heat Pump			Insulation	1 Full		
2.2	5.1.75	8.		1.Refrig	4.W&C Air	7.	1.Full	4.Minimal	7.		
3.3	6.2.5	9.		2.Evapor	5.	8.	2.Heavy	5.Partial	8.		
Exterior Walls	2 Vinyl/Aluminum			3.H Pump	6.	9.None	3.Capped	6.	9.None		
1.Wood	5.Stucco	9.T-111		Kitchen Style	2 Typical			Unfinished %	0%		
2.Vin/Al	6.Brick	10.Other		1.Modern	4.Obsolete	7.	Grade & Factor	3 Average 110%			
3.Compos.	7.Stone	11.		2.Typical	5.	8.	1.E Grade	4.B Grade	7.		
4.Asbestos	8.Concrete	12.		3.Old Type	6.	9.None	2.D Grade	5.A Grade	8.SC Grade		
Roof Surface	1 Asphalt Shingles			Bath(s) Style	2 Typical Bath(s)			3.C Grade	6.AA Grade	9.Same	
1.Asphalt	4.Composit	7.		1.Modern	4.Obsolete	7.	SQFT (Footprint)	1232			
2.Slate	5.Wood	8.		2.Typical	5.	8.	Condition	5 Above Average			
3.Metal	6.Other	9.		3.Old Type	6.	9.None	1.Poor	4.Avg	7.V G		
SF Masonry Trim	0			# Rooms	6			2.Fair	5.Avg+	8.Exc	
OPEN-3-CUSTOM	0			# Bedrooms	3			3.Avg-	6.Good	9.Same	
OPEN-4-CUSTOM	0			# Full Baths	2			Phys. % Good	0%		
Year Built	2005			# Half Baths	0			Funct. % Good	100%		
Year Remodeled	0			# Addn Fixtures	0			Functional Code	9 None		
Foundation	1 Concrete			# Fireplaces	0			1.Incomp	4.Delap	7.No Power	
1.Concrete	4.Wood	7.		 <p>TRIO Software A Division of Harris Computer Systems</p>	2.O-Built	5.Bsmt	8.LongTerm	Econ. % Good	100%		
2.C Block	5.Slab	8.			3.Damage	6.Common	9.None	Economic Code	None		
3.Br/Stone	6.Piers	9.			0.None	3.No Power	7.	1.Location	4.Generate	8.	
Basement	4 Full Basement				Entrance Code	5 Estimated			2.Encroach	9.None	9.
1.1/4 Bmt	4.Full Bmt	7.			1.Interior	4.Vacant	7.	Information Code	5 Estimate		
2.1/2 Bmt	5.None	8.			2.Refusal	5.Estimate	8.	1.Owner	4.Agent	7.	
3.3/4 Bmt	6.	9.None			3.Informed	6.Reviewed	9.	2.Relative	5.Estimate	8.	
Bsmt Gar # Cars	0				3.Tenant	6.Other	9.	2.Relative	5.Estimate	8.	
Wet Basement	1 Dry Basement							3.Tenant	6.Other	9.	
1.Dry	4.	7.									
2.Damp	5.	8.									
3.Wet	6.	9.									

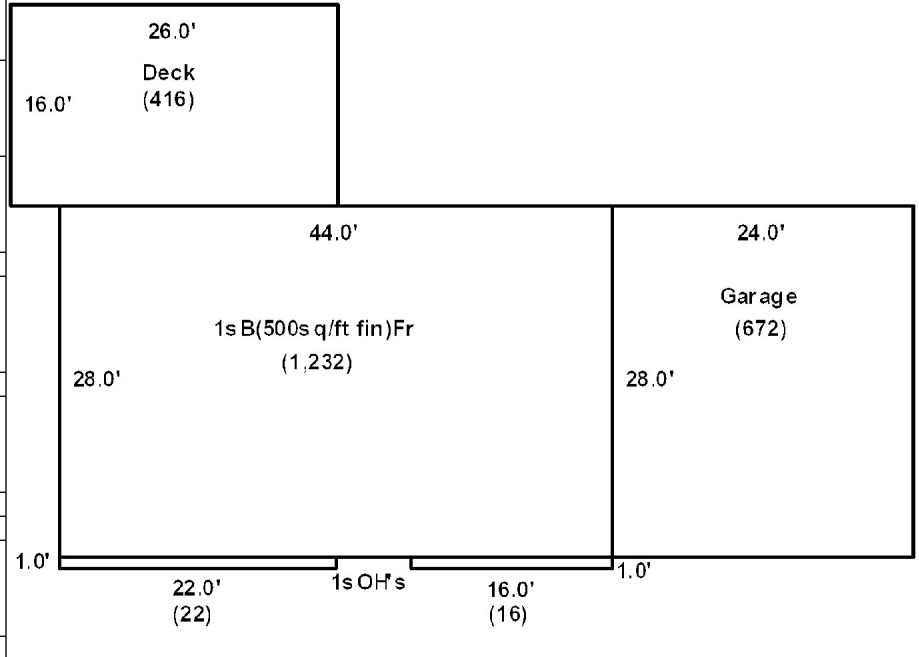

Date Inspected 7/28/2018

Additions, Outbuildings & Improvements

Type	Year	Units	Grade	Cond	Phys.	Funct.	Sound Value	
26 1SFr Overhang	0	22	0 0	0	0 %	0 %		1.One Story Fram
26 1SFr Overhang	0	16	0 0	0	0 %	0 %		2.Two Story Fram
23 Frame Garage	0	672	0 0	0	0 %	80 %		3.Three Story Fr
68 Wood Deck	0	416	3 100	2	0 %	100 %		4.1 & 1/2 Story
					%	%		5.1 & 3/4 Story
					%	%		6.2 & 1/2 Story
					%	%		21.Open Frame Por
					%	%		22.Encl Frame Por
					%	%		23.Frame Garage
					%	%		24.Frame Shed
					%	%		25.Frame Bay Wind
					%	%		26.1SFr Overhang
					%	%		27.Unfin Basement
					%	%		28.Unfinished Att
					%	%		29.Finished Attic



Washburn

Map Lot 001-029

Account 425

Location 40 Riverside Drive S

Card 1

Of 1

12/09/2022

Building Style 0	SF Bsmt Living 0	Layout 0
1.Conv. 5.Garrison 9.Gambrel	Fin Bsmt Grade 0 0	1.Typical 4. 7.
2.Ranch 6.Salt Box 10.Other	OPEN 5 OPTIONAL 0	2.Inadeq 5. 8.
3.R Ranch 7.Contemp 11.Split	Heat Type 100% 0	3.Poor 6. 9.
4.Cape 8.Log 12.	1.HWBB 5.FWA 9.No Heat	Attic 0
Dwelling Units 0	2.HWCI 6.GravWA 10.	1.1/4 Fin 4.Full Fin 7.
Other Units 0	3.H Pump 7.Electric 11.	2.1/2 Fin 5.FI/Stair 8.
Stories 0	4.Steam 8.FI/Wall 12.	3.3/4 Fin 6. 9.None
1.1 4.1.5 7.	Cool Type 0% 9 None	Insulation 0
2.2 5.1.75 8.	1.Refrig 4.W&C Air 7.	1.Full 4.Minimal 7.
3.3 6.2.5 9.	2.Evapor 5. 8.	2.Heavy 5.Partial 8.
Exterior Walls 0	3.H Pump 6. 9.None	3.Capped 6. 9.None
1.Wood 5.Stucco 9.T-111	Kitchen Style 0	Unfinished % 0%
2.Vin/Al 6.Brick 10.Other	1.Modern 4.Obsolete 7.	Grade & Factor 0 0%
3.Compos. 7.Stone 11.	2.Typical 5. 8.	1.E Grade 4.B Grade 7.
4.Asbestos 8.Concrete 12.	3.Old Type 6. 9.None	2.D Grade 5.A Grade 8.SC Grade
Roof Surface 0	Bath(s) Style 0	3.C Grade 6.AA Grade 9.Same
1.Asphalt 4.Composit 7.	1.Modern 4.Obsolete 7.	SQFT (Footprint) 0
2.Slate 5.Wood 8.	2.Typical 5. 8.	Condition 0
3.Metal 6.Other 9.	3.Old Type 6. 9.None	1.Poor 4.Avg 7.V G
SF Masonry Trim 0	# Rooms 0	2.Fair 5.Avg+ 8.Exc
OPEN-3-CUSTOM 0	# Bedrooms 0	3.Avg- 6.Good 9.Same
OPEN-4-CUSTOM 0	# Full Baths 0	Phys. % Good 0%
Year Built 0	# Half Baths 0	Funct. % Good 100%
Year Remodeled 0	# Addn Fixtures 0	Functional Code 9 None
Foundation 0	# Fireplaces 0	1.Incomp 4.Delap 7.No Power
1.Concrete 4.Wood 7.	 <p>TRIO Software A Division of Harris Computer Systems</p>	2.O-Built 5.Bsmt 8.LongTerm
2.C Block 5.Slab 8.		3.Damage 6.Common 9.None
3.Br/Stone 6.Piers 9.		Econ. % Good 100%
Basement 0		Economic Code None
1.1/4 Bmt 4.Full Bmt 7.		0.None 3.No Power 7.
2.1/2 Bmt 5.None 8.		1.Location 4.Generate 8.
3.3/4 Bmt 6. 9.None		2.Encroach 9.None 9.
Bsmt Gar # Cars 0		Entrance Code 5 Estimated
Wet Basement 0		1.Interior 4.Vacant 7.
1.Dry 4. 7.		2.Refusal 5.Estimate 8.
2.Damp 5. 8.	3.Informed 6.Reviewed 9.	
3.Wet 6. 9.	Information Code 5 Estimate	
		1.Owner 4.Agent 7.
		2.Relative 5.Estimate 8.
		3.Tenant 6.Other 9.

Date Inspected 7/28/2018

Additions, Outbuildings & Improvements

Type	Year	Units	Grade	Cond	Phys.	Funct.	Sound Value
998 14Mobile Home	1990	14x66	4 100	4	0 %	100 %	
22 Encl Frame Porch	1990	160	2 100	3	0 %	100 %	
24 Frame Shed	1990	960	3 100	4	0 %	100 %	
998 14Mobile Home	1990	14x48	4 100	4	0 %	100 %	
22 Encl Frame Porch	2021	160	3 100	4	0 %	100 %	
21 Open Frame	2021	60	3 100	4	0 %	100 %	
48 Concrete Slab	1990	924	3 100	4	0 %	100 %	
48 Concrete Slab	1990	672	3 100	4	0 %	100 %	
					%	%	
					%	%	

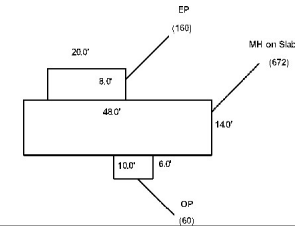
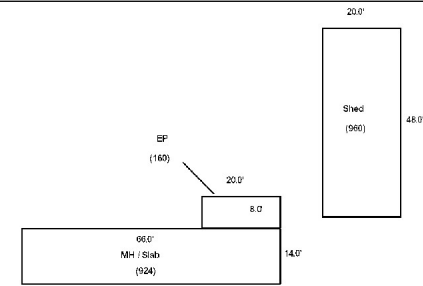

Washburn

Map Lot 001-030

Account 265

Location 67 RIVERSIDE DRIVE S

Card 1 Of 1 12/09/2022

Building Style 0	SF Bsmt Living 0	Layout 0			
1.Conv. 5.Garrison 9.Gambrel	Fin Bsmt Grade 0 0	1.Typical 4. 7.			
2.Ranch 6.Salt Box 10.Other	OPEN 5 OPTIONAL 0	2.Inadeq 5. 8.			
3.R Ranch 7.Contemp 11.Split	Heat Type 100% 0	3.Poor 6. 9.			
4.Cape 8.Log 12.	1.HWBB 5.FWA 9.No Heat	Attic 0			
Dwelling Units 0	2.HWCI 6.GravWA 10.	1.1/4 Fin 4.Full Fin 7.			
Other Units 0	3.H Pump 7.Electric 11.	2.1/2 Fin 5.F/Stair 8.			
Stories 0	4.Steam 8.F/Wall 12.	3.3/4 Fin 6. 9.None			
1.1 4.1.5 7.	Cool Type 0% 9 None	Insulation 0			
2.2 5.1.75 8.	1.Refrig 4.W&C Air 7.	1.Full 4.Minimal 7.			
3.3 6.2.5 9.	2.Evapor 5. 8.	2.Heavy 5.Partial 8.			
Exterior Walls 0	3.H Pump 6. 9.None	3.Capped 6. 9.None			
1.Wood 5.Stucco 9.T-111	Kitchen Style 0	Unfinished % 0%			
2.Vin/Al 6.Brick 10.Other	1.Modern 4.Obsolete 7.	Grade & Factor 0 0%			
3.Compos. 7.Stone 11.	2.Typical 5. 8.	1.E Grade 4.B Grade 7.			
4.Asbestos 8.Concrete 12.	3.Old Type 6. 9.None	2.D Grade 5.A Grade 8.SC Grade			
Roof Surface 0	Bath(s) Style 0	3.C Grade 6.AA Grade 9.Same			
1.Asphalt 4.Composit 7.	1.Modern 4.Obsolete 7.	SQFT (Footprint) 0			
2.Slate 5.Wood 8.	2.Typical 5. 8.	Condition 0			
3.Metal 6.Other 9.	3.Old Type 6. 9.None	1.Poor 4.Avg 7.V G			
SF Masonry Trim 0	# Rooms 0	2.Fair 5.Avg+ 8.Exc			
OPEN-3-CUSTOM 0	# Bedrooms 0	3.Avg- 6.Good 9.Same			
OPEN-4-CUSTOM 0	# Full Baths 0	Phys. % Good 0%			
Year Built 0	# Half Baths 0	Funct. % Good 100%			
Year Remodeled 0	# Addn Fixtures 0	Functional Code 9 None			
Foundation 0	# Fireplaces 0	1.Incomp 4.Delap 7.No Power			
1.Concrete 4.Wood 7.		2.O-Built 5.Bsmt 8.LongTerm			
2.C Block 5.Slab 8.		3.Damage 6.Common 9.None			
3.Br/Stone 6.Piers 9.		Econ. % Good 100%			
Basement 0		Economic Code None			
1.1/4 Bmt 4.Full Bmt 7.		0.None 3.No Power 7.			
2.1/2 Bmt 5.None 8.		1.Location 4.Generate 8.			
3.3/4 Bmt 6. 9.None		2.Encroach 9.None 9.			
Bsmt Gar # Cars 0		Entrance Code 0			
Wet Basement 0		1.Interior 4.Vacant 7.			
1.Dry 4. 7.		2.Refusal 5.Estimate 8.			
2.Damp 5. 8.		3.Informed 6.Reviewed 9.			
3.Wet 6. 9.		Information Code 0			
		1.Owner 4.Agent 7.			
		2.Relative 5.Estimate 8.			
		3.Tenant 6.Other 9.			



Date Inspected

Additions, Outbuildings & Improvements								
Type	Year	Units	Grade	Cond	Phys.	Funct.	Sound Value	
					%	%		1.One Story Fram
					%	%		2.Two Story Fram
					%	%		3.Three Story Fr
					%	%		4.1 & 1/2 Story
					%	%		5.1 & 3/4 Story
					%	%		6.2 & 1/2 Story
					%	%		21.Open Frame Por
					%	%		22.Encl Frame Por
					%	%		23.Frame Garage
					%	%		24.Frame Shed
					%	%		25.Frame Bay Wind
					%	%		26.1SFr Overhang
					%	%		27.Unfin Basement
					%	%		28.Unfinished Att
					%	%		29.Finished Attic

CONLEY, MARK
P.O. BOX 163
WASHBURN ME 04786

B5242P301

Inspection Witnessed By:

No./Date	Description	Date Insp.
X		

Notes:
*-15% for size of MH during reval.

Washburn

Property Data			Assessment Record																																																																																																																																																																																																												
Neighborhood 1 Neighborhood One			Year	Land	Buildings	Exempt	Total																																																																																																																																																																																																								
Tree Growth Year 0			2009	6,800	13,000	0	19,800																																																																																																																																																																																																								
1ST MORTGAGE 0			2012	6,800	13,000	0	19,800																																																																																																																																																																																																								
2ND MORTGAGE 0			2013	8,800	13,000	0	21,800																																																																																																																																																																																																								
Zone/Land Use 1 Residential			2015	8,800	13,000	0	21,800																																																																																																																																																																																																								
Secondary Zone			2018	8,800	13,000	0	21,800																																																																																																																																																																																																								
Topography 1 Level			2019	16,800	5,700	0	22,500																																																																																																																																																																																																								
1.Level 4.Below St 7.LevelBog			2020	16,800	5,700	0	22,500																																																																																																																																																																																																								
2.Rolling 5.Low 8.			2021	16,800	5,700	0	22,500																																																																																																																																																																																																								
3.Above St 6.Swampy 9.			2022	16,800	6,000	0	22,800																																																																																																																																																																																																								
Utilities 3 Public Sewer 4 Drilled Well																																																																																																																																																																																																															
1.Public 4.Dr Well 7.Cesspool																																																																																																																																																																																																															
2.Water 5.Dug Well 8.																																																																																																																																																																																																															
3.Sewer 6.Septic 9.None																																																																																																																																																																																																															
Street 1 Paved																																																																																																																																																																																																															
1.Paved 4.Proposed 7.																																																																																																																																																																																																															
2.Semi Imp 5.R/O/W 8.																																																																																																																																																																																																															
3.Gravel 6. 9.None																																																																																																																																																																																																															
TG PLAN YEAR 0																																																																																																																																																																																																															
Tif District # 0																																																																																																																																																																																																															
Sale Data			Land Data <table border="1"> <thead> <tr> <th rowspan="2">Front Foot</th> <th rowspan="2">Type</th> <th colspan="2">Effective</th> <th colspan="2">Influence</th> <th rowspan="2">Influence Codes</th> </tr> <tr> <th>Frontage</th> <th>Depth</th> <th>Factor</th> <th>Code</th> </tr> </thead> <tbody> <tr><td>11.Regular Lot</td><td></td><td></td><td></td><td>%</td><td></td><td>1.Unimproved</td></tr> <tr><td>12.Delta Triangle</td><td></td><td></td><td></td><td>%</td><td></td><td>2.Excess Frtg</td></tr> <tr><td>13.Nabla Triangle</td><td></td><td></td><td></td><td>%</td><td></td><td>3.Topography</td></tr> <tr><td>14.Rear Land</td><td></td><td></td><td></td><td>%</td><td></td><td>4.Size/Shape</td></tr> <tr><td>15.Class I Road</td><td></td><td></td><td></td><td>%</td><td></td><td>5.Access</td></tr> <tr><td></td><td></td><td></td><td></td><td>%</td><td></td><td>6.Restriction</td></tr> <tr><td></td><td></td><td></td><td></td><td>%</td><td></td><td>7.Open Space</td></tr> <tr><td></td><td></td><td></td><td></td><td>%</td><td></td><td>8.View/Environ</td></tr> <tr><td></td><td></td><td></td><td></td><td>%</td><td></td><td>9.Fract Share</td></tr> <tr><td></td><td></td><td></td><td></td><td>%</td><td></td><td>Acres</td></tr> <tr><td></td><td></td><td></td><td></td><td>%</td><td></td><td>30.Utility R O W</td></tr> <tr><td></td><td></td><td></td><td></td><td>%</td><td></td><td>31.Tillable</td></tr> <tr><td></td><td></td><td></td><td></td><td>%</td><td></td><td>32.Pasture</td></tr> <tr><td></td><td></td><td></td><td></td><td>%</td><td></td><td>33.Orchard</td></tr> <tr><td></td><td></td><td></td><td></td><td>%</td><td></td><td>34.Softwood F&O</td></tr> <tr><td></td><td></td><td></td><td></td><td>%</td><td></td><td>35.Mixed Wood F&O</td></tr> <tr><td></td><td></td><td></td><td></td><td>%</td><td></td><td>36.Hardwood F&O</td></tr> <tr><td></td><td></td><td></td><td></td><td>%</td><td></td><td>37.Softwood TG</td></tr> <tr><td></td><td></td><td></td><td></td><td>%</td><td></td><td>38.Mixed Wood TG</td></tr> <tr><td></td><td></td><td></td><td></td><td>%</td><td></td><td>39.Hardwood TG</td></tr> <tr><td></td><td></td><td></td><td></td><td>%</td><td></td><td>40.Wasteland</td></tr> <tr><td></td><td></td><td></td><td></td><td>%</td><td></td><td>41.Open Space</td></tr> <tr><td></td><td></td><td></td><td></td><td>%</td><td></td><td>42.Mobile Home Si</td></tr> <tr><td></td><td></td><td></td><td></td><td>%</td><td></td><td>43.Condo Site</td></tr> <tr><td></td><td></td><td></td><td></td><td>%</td><td></td><td>44.Lot Improvemen</td></tr> <tr><td></td><td></td><td></td><td></td><td>%</td><td></td><td>45.Subdivision Lo</td></tr> <tr><td></td><td></td><td></td><td></td><td>%</td><td></td><td>46.Heavy Ind Sit</td></tr> </tbody> </table>					Front Foot	Type	Effective		Influence		Influence Codes	Frontage	Depth	Factor	Code	11.Regular Lot				%		1.Unimproved	12.Delta Triangle				%		2.Excess Frtg	13.Nabla Triangle				%		3.Topography	14.Rear Land				%		4.Size/Shape	15.Class I Road				%		5.Access					%		6.Restriction					%		7.Open Space					%		8.View/Environ					%		9.Fract Share					%		Acres					%		30.Utility R O W					%		31.Tillable					%		32.Pasture					%		33.Orchard					%		34.Softwood F&O					%		35.Mixed Wood F&O					%		36.Hardwood F&O					%		37.Softwood TG					%		38.Mixed Wood TG					%		39.Hardwood TG					%		40.Wasteland					%		41.Open Space					%		42.Mobile Home Si					%		43.Condo Site					%		44.Lot Improvemen					%		45.Subdivision Lo					%		46.Heavy Ind Sit
Front Foot	Type	Effective								Influence		Influence Codes																																																																																																																																																																																																			
		Frontage	Depth	Factor	Code																																																																																																																																																																																																										
11.Regular Lot				%		1.Unimproved																																																																																																																																																																																																									
12.Delta Triangle				%		2.Excess Frtg																																																																																																																																																																																																									
13.Nabla Triangle				%		3.Topography																																																																																																																																																																																																									
14.Rear Land				%		4.Size/Shape																																																																																																																																																																																																									
15.Class I Road				%		5.Access																																																																																																																																																																																																									
				%		6.Restriction																																																																																																																																																																																																									
				%		7.Open Space																																																																																																																																																																																																									
				%		8.View/Environ																																																																																																																																																																																																									
				%		9.Fract Share																																																																																																																																																																																																									
				%		Acres																																																																																																																																																																																																									
				%		30.Utility R O W																																																																																																																																																																																																									
				%		31.Tillable																																																																																																																																																																																																									
				%		32.Pasture																																																																																																																																																																																																									
				%		33.Orchard																																																																																																																																																																																																									
				%		34.Softwood F&O																																																																																																																																																																																																									
				%		35.Mixed Wood F&O																																																																																																																																																																																																									
				%		36.Hardwood F&O																																																																																																																																																																																																									
				%		37.Softwood TG																																																																																																																																																																																																									
				%		38.Mixed Wood TG																																																																																																																																																																																																									
				%		39.Hardwood TG																																																																																																																																																																																																									
				%		40.Wasteland																																																																																																																																																																																																									
				%		41.Open Space																																																																																																																																																																																																									
				%		42.Mobile Home Si																																																																																																																																																																																																									
				%		43.Condo Site																																																																																																																																																																																																									
				%		44.Lot Improvemen																																																																																																																																																																																																									
				%		45.Subdivision Lo																																																																																																																																																																																																									
				%		46.Heavy Ind Sit																																																																																																																																																																																																									
Sale Date			Front Foot	Square Feet																																																																																																																																																																																																											
Price			16.Class II Road																																																																																																																																																																																																												
Sale Type 2 Land & Buildings			17.Municipal Rese																																																																																																																																																																																																												
1.Land 4.Mobile 7.C/I L&B			18.Munic Sep Lago																																																																																																																																																																																																												
2.L & B 5.Other 8.			19.Gravel Pit																																																																																																																																																																																																												
3.Building 6.C/I Land 9.			20.Industrial Bas																																																																																																																																																																																																												
Financing			Square Foot																																																																																																																																																																																																												
1.Convent 4.Seller 7.			21.Developed Pave	21	1.00	100	% 0																																																																																																																																																																																																								
2.FHA/VA 5.Private 8.			22.Undev Paved (F	28	0.50	100	% 0																																																																																																																																																																																																								
3.Assumed 6.Cash 9.Unknown			23.Developed Grav				%																																																																																																																																																																																																								
Validity 2 Related Parties			Acres																																																																																																																																																																																																												
1.Valid 4.Split 7.Renovate			24.Undev Gravel (%																																																																																																																																																																																																								
2.Related 5.Partial 8.Other			25.Comm Base Pave				%																																																																																																																																																																																																								
3.Distress 6.Exempt 9.			26.Comm Base Grav				%																																																																																																																																																																																																								
Verified 5 Public Record			27.Backlot				%																																																																																																																																																																																																								
1.Buyer 4.Agent 7.Family			28.Rear Land				%																																																																																																																																																																																																								
2.Seller 5.Pub Rec 8.Other			29.Pavement				%																																																																																																																																																																																																								
3.Lender 6.MLS 9.							%																																																																																																																																																																																																								
			Total Acreage	1.50																																																																																																																																																																																																											

Washburn

Map Lot 001-031

Account 1001

Location 61 RIVERSIDE DRIVE S

Card 1 Of 1

12/09/2022

Building Style 0	SF Bsmt Living 0	Layout 0
1.Conv. 5.Garrison 9.Gambrel	Fin Bsmt Grade 0 0	1.Typical 4. 7.
2.Ranch 6.Salt Box 10.Other	OPEN 5 OPTIONAL 0	2.Inadeq 5. 8.
3.R Ranch 7.Contemp 11.Split	Heat Type 100% 0	3.Poor 6. 9.
4.Cape 8.Log 12.	1.HWBB 5.FWA 9.No Heat	Attic 0
Dwelling Units 0	2.HWCI 6.GravWA 10.	1.1/4 Fin 4.Full Fin 7.
Other Units 0	3.H Pump 7.Electric 11.	2.1/2 Fin 5.FI/Stair 8.
Stories 0	4.Steam 8.FI/Wall 12.	3.3/4 Fin 6. 9.None
1.1 4.1.5 7.	Cool Type 0% 9 None	Insulation 0
2.2 5.1.75 8.	1.Refrig 4.W&C Air 7.	1.Full 4.Minimal 7.
3.3 6.2.5 9.	2.Evapor 5. 8.	2.Heavy 5.Partial 8.
Exterior Walls 0	3.H Pump 6. 9.None	3.Capped 6. 9.None
1.Wood 5.Stucco 9.T-111	Kitchen Style 0	Unfinished % 0%
2.Vin/Al 6.Brick 10.Other	1.Modern 4.Obsolete 7.	Grade & Factor 0 0%
3.Compos. 7.Stone 11.	2.Typical 5. 8.	1.E Grade 4.B Grade 7.
4.Asbestos 8.Concrete 12.	3.Old Type 6. 9.None	2.D Grade 5.A Grade 8.SC Grade
Roof Surface 0	Bath(s) Style 0	3.C Grade 6.AA Grade 9.Same
1.Asphalt 4.Composit 7.	1.Modern 4.Obsolete 7.	SQFT (Footprint) 0
2.Slate 5.Wood 8.	2.Typical 5. 8.	Condition 0
3.Metal 6.Other 9.	3.Old Type 6. 9.None	1.Poor 4.Avg 7.V G
SF Masonry Trim 0	# Rooms 0	2.Fair 5.Avg+ 8.Exc
OPEN-3-CUSTOM 0	# Bedrooms 0	3.Avg- 6.Good 9.Same
OPEN-4-CUSTOM 0	# Full Baths 0	Phys. % Good 0%
Year Built 0	# Half Baths 0	Funct. % Good 100%
Year Remodeled 0	# Addn Fixtures 0	Functional Code 9 None
Foundation 0	# Fireplaces 0	1.Incomp 4.Delap 7.No Power
1.Concrete 4.Wood 7.	 <p>TRIO Software A Division of Harris Computer Systems</p>	2.O-Built 5.Bsmt 8.LongTerm
2.C Block 5.Slab 8.		3.Damage 6.Common 9.None
3.Br/Stone 6.Piers 9.		Econ. % Good 100%
Basement 0		Economic Code None
1.1/4 Bmt 4.Full Bmt 7.		0.None 3.No Power 7.
2.1/2 Bmt 5.None 8.		1.Location 4.Generate 8.
3.3/4 Bmt 6. 9.None		2.Encroach 9.None 9.
Bsmt Gar # Cars 0		Entrance Code 5 Estimated
Wet Basement 0		1.Interior 4.Vacant 7.
1.Dry 4. 7.		2.Refusal 5.Estimate 8.
2.Damp 5. 8.	3.Informed 6.Reviewed 9.	
3.Wet 6. 9.	Information Code 5 Estimate	
	1.Owner 4.Agent 7.	
	2.Relative 5.Estimate 8.	
	3.Tenant 6.Other 9.	

Date Inspected 7/28/2018

Additions, Outbuildings & Improvements

Type	Year	Units	Grade	Cond	Phys.	Funct.	Sound Value
997 12Mobile Home	1970	12x66	3 100	4	0 %	85 %	
18 1 S-MH add	1980	192	2 100	3	0 %	100 %	
24 Frame Shed	0				%	%	150
68 Wood Deck	1980	116	2 100	3	0 %	100 %	
					%	%	
					%	%	
					%	%	
					%	%	
					%	%	
					%	%	
					%	%	
					%	%	

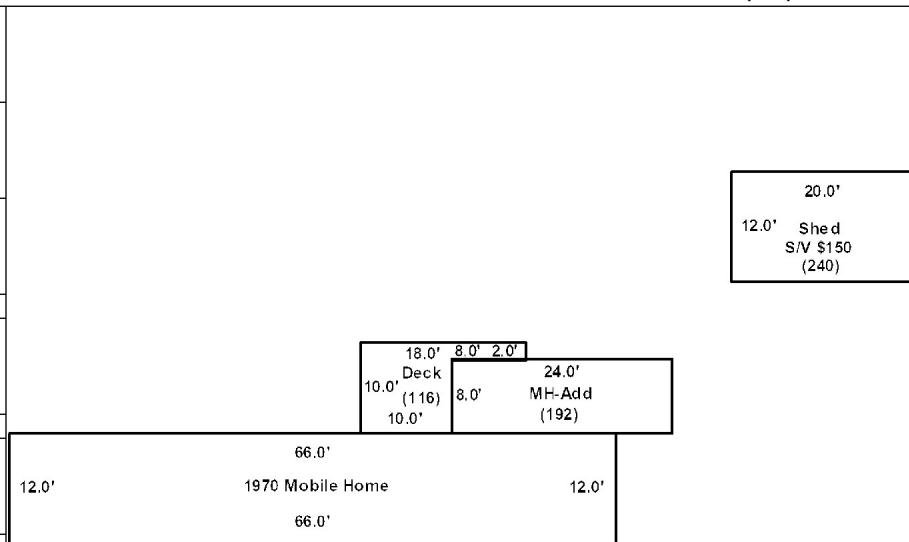

Washburn

Map Lot 001-032

Account 268

Location 43 RIVERSIDE DRIVE S

Card 1 Of 1 12/09/2022

Building Style 0	SF Bsmt Living 0	Layout 0
1.Conv. 5.Garrison 9.Gambrel	Fin Bsmt Grade 0 0	1.Typical 4. 7.
2.Ranch 6.Salt Box 10.Other	OPEN 5 OPTIONAL 0	2.Inadeq 5. 8.
3.R Ranch 7.Contemp 11.Split	Heat Type 100% 0	3.Poor 6. 9.
4.Cape 8.Log 12.	1.HWBB 5.FWA 9.No Heat	Attic 0
Dwelling Units 0	2.HWCI 6.GravWA 10.	1.1/4 Fin 4.Full Fin 7.
Other Units 0	3.H Pump 7.Electric 11.	2.1/2 Fin 5.FI/Stair 8.
Stories 0	4.Steam 8.FI/Wall 12.	3.3/4 Fin 6. 9.None
1.1 4.1.5 7.	Cool Type 0% 9 None	Insulation 0
2.2 5.1.75 8.	1.Refrig 4.W&C Air 7.	1.Full 4.Minimal 7.
3.3 6.2.5 9.	2.Evapor 5. 8.	2.Heavy 5.Partial 8.
Exterior Walls 0	3.H Pump 6. 9.None	3.Capped 6. 9.None
1.Wood 5.Stucco 9.T-111	Kitchen Style 0	Unfinished % 0%
2.Vin/Al 6.Brick 10.Other	1.Modern 4.Obsolete 7.	Grade & Factor 0 0%
3.Compos. 7.Stone 11.	2.Typical 5. 8.	1.E Grade 4.B Grade 7.
4.Asbestos 8.Concrete 12.	3.Old Type 6. 9.None	2.D Grade 5.A Grade 8.SC Grade
Roof Surface 0	Bath(s) Style 0	3.C Grade 6.AA Grade 9.Same
1.Asphalt 4.Composit 7.	1.Modern 4.Obsolete 7.	SQFT (Footprint) 0
2.Slate 5.Wood 8.	2.Typical 5. 8.	Condition 0
3.Metal 6.Other 9.	3.Old Type 6. 9.None	1.Poor 4.Avg 7.V G
SF Masonry Trim 0	# Rooms 0	2.Fair 5.Avg+ 8.Exc
OPEN-3-CUSTOM 0	# Bedrooms 0	3.Avg- 6.Good 9.Same
OPEN-4-CUSTOM 0	# Full Baths 0	Phys. % Good 0%
Year Built 0	# Half Baths 0	Funct. % Good 100%
Year Remodeled 0	# Addn Fixtures 0	Functional Code 9 None
Foundation 0	# Fireplaces 0	1.Incomp 4.Delap 7.No Power
1.Concrete 4.Wood 7.	 <p>TRIO Software A Division of Harris Computer Systems</p>	2.O-Built 5.Bsmt 8.LongTerm
2.C Block 5.Slab 8.		3.Damage 6.Common 9.None
3.Br/Stone 6.Piers 9.		Econ. % Good 100%
Basement 0		Economic Code None
1.1/4 Bmt 4.Full Bmt 7.		0.None 3.No Power 7.
2.1/2 Bmt 5.None 8.		1.Location 4.Generate 8.
3.3/4 Bmt 6. 9.None		2.Encroach 9.None 9.
Bsmt Gar # Cars 0		Entrance Code 5 Estimated
Wet Basement 0		1.Interior 4.Vacant 7.
1.Dry 4. 7.		2.Refusal 5.Estimate 8.
2.Damp 5. 8.	3.Informed 6.Reviewed 9.	
3.Wet 6. 9.	Information Code 5 Estimate	
	1.Owner 4.Agent 7.	
	2.Relative 5.Estimate 8.	
	3.Tenant 6.Other 9.	

Date Inspected 7/28/2018

Additions, Outbuildings & Improvements

Type	Year	Units	Grade	Cond	Phys.	Funct.	Sound Value
942 Skyline M/H	1999	14x66	5 100	4	0 %	100 %	
68 Wood Deck	1999	256	3 100	3	0 %	100 %	
24 Frame Shed	0				%	%	300
24 Frame Shed	0				%	%	50
24 Frame Shed	0				%	%	500
					%	%	
					%	%	
					%	%	
					%	%	
					%	%	
					%	%	

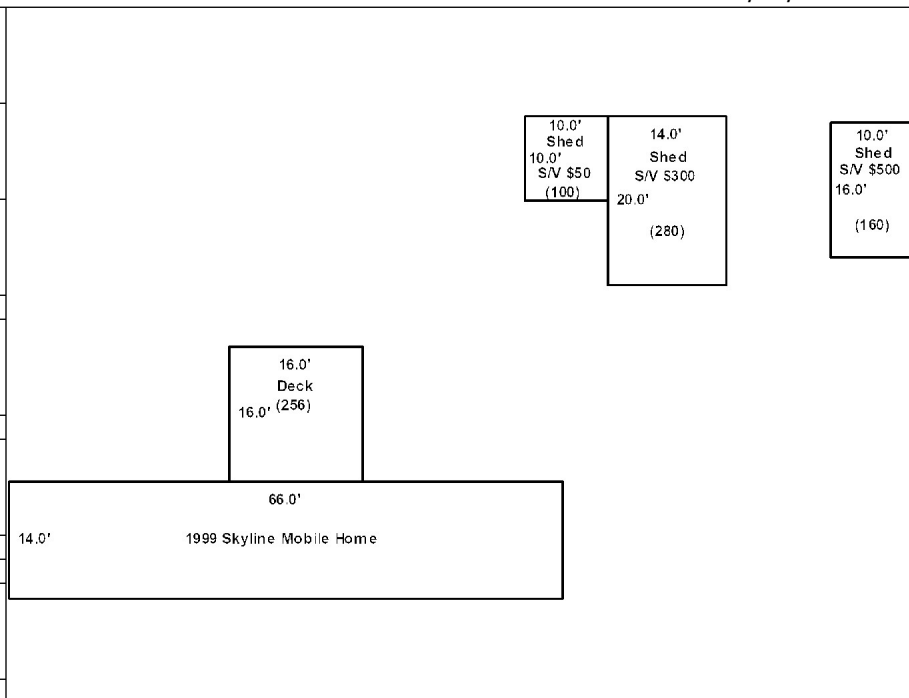

Washburn

Map Lot 001-033

Account 607

Location Parsons Road

Card 1 Of 1 12/09/2022

Building Style 0	SF Bsmt Living 0	Layout 0
1.Conv. 5.Garrison 9.Gambrel	Fin Bsmt Grade 0 0	1.Typical 4. 7.
2.Ranch 6.Salt Box 10.Other	OPEN 5 OPTIONAL 0	2.Inadeq 5. 8.
3.R Ranch 7.Contemp 11.Split	Heat Type 100% 0	3.Poor 6. 9.
4.Cape 8.Log 12.	1.HWBB 5.FWA 9.No Heat	Attic 0
Dwelling Units 0	2.HWCI 6.GravWA 10.	1.1/4 Fin 4.Full Fin 7.
Other Units 0	3.H Pump 7.Electric 11.	2.1/2 Fin 5.F/Stair 8.
Stories 0	4.Steam 8.F/Wall 12.	3.3/4 Fin 6. 9.None
1.1 4.1.5 7.	Cool Type 0% 9 None	Insulation 0
2.2 5.1.75 8.	1.Refrig 4.W&C Air 7.	1.Full 4.Minimal 7.
3.3 6.2.5 9.	2.Evapor 5. 8.	2.Heavy 5.Partial 8.
Exterior Walls 0	3.H Pump 6. 9.None	3.Capped 6. 9.None
1.Wood 5.Stucco 9.T-111	Kitchen Style 0	Unfinished % 0%
2.Vin/Al 6.Brick 10.Other	1.Modern 4.Obsolete 7.	Grade & Factor 0 0%
3.Compos. 7.Stone 11.	2.Typical 5. 8.	1.E Grade 4.B Grade 7.
4.Asbestos 8.Concrete 12.	3.Old Type 6. 9.None	2.D Grade 5.A Grade 8.SC Grade
Roof Surface 0	Bath(s) Style 0	3.C Grade 6.AA Grade 9.Same
1.Asphalt 4.Composit 7.	1.Modern 4.Obsolete 7.	SQFT (Footprint) 0
2.Slate 5.Wood 8.	2.Typical 5. 8.	Condition 0
3.Metal 6.Other 9.	3.Old Type 6. 9.None	1.Poor 4.Avg 7.V G
SF Masonry Trim 0	# Rooms 0	2.Fair 5.Avg+ 8.Exc
OPEN-3-CUSTOM 0	# Bedrooms 0	3.Avg- 6.Good 9.Same
OPEN-4-CUSTOM 0	# Full Baths 0	Phys. % Good 0%
Year Built 0	# Half Baths 0	Funct. % Good 100%
Year Remodeled 0	# Addn Fixtures 0	Functional Code 9 None
Foundation 0	# Fireplaces 0	1.Incomp 4.Delap 7.No Power
1.Concrete 4.Wood 7.		2.O-Built 5.Bsmt 8.LongTerm
2.C Block 5.Slab 8.		3.Damage 6.Common 9.None
3.Br/Stone 6.Piers 9.		Econ. % Good 100%
Basement 0		Economic Code None
1.1/4 Bmt 4.Full Bmt 7.		0.None 3.No Power 7.
2.1/2 Bmt 5.None 8.		1.Location 4.Generate 8.
3.3/4 Bmt 6. 9.None		2.Encroach 9.None 9.
Bsmt Gar # Cars 0		Entrance Code 0
Wet Basement 0		1.Interior 4.Vacant 7.
1.Dry 4. 7.		2.Refusal 5.Estimate 8.
2.Damp 5. 8.	3.Informed 6.Reviewed 9.	
3.Wet 6. 9.	Information Code 0	
		1.Owner 4.Agent 7.
		2.Relative 5.Estimate 8.
		3.Tenant 6.Other 9.

Date Inspected

Additions, Outbuildings & Improvements

Type	Year	Units	Grade	Cond	Phys.	Funct.	Sound Value
					%	%	1.One Story Fram
					%	%	2.Two Story Fram
					%	%	3.Three Story Fr
					%	%	4.1 & 1/2 Story
					%	%	5.1 & 3/4 Story
					%	%	6.2 & 1/2 Story
					%	%	21.Open Frame Por
					%	%	22.Encl Frame Por
					%	%	23.Frame Garage
					%	%	24.Frame Shed
					%	%	25.Frame Bay Wind
					%	%	26.1SFr Overhang
					%	%	27.Unfin Basement
					%	%	28.Unfinished Att
					%	%	29.Finished Attic

Washburn

Map Lot 001-034

Account 654

Location PARSONS ROAD

Card 1 Of 1 12/09/2022

Building Style 0	SF Bsmt Living 0	Layout 0
1.Conv. 5.Garrison 9.Gambrel	Fin Bsmt Grade 0 0	1.Typical 4. 7.
2.Ranch 6.Salt Box 10.Other	OPEN 5 OPTIONAL 0	2.Inadeq 5. 8.
3.R Ranch 7.Contemp 11.Split	Heat Type 100% 0	3.Poor 6. 9.
4.Cape 8.Log 12.	1.HWBB 5.FWA 9.No Heat	Attic 0
Dwelling Units 0	2.HWCI 6.GravWA 10.	1.1/4 Fin 4.Full Fin 7.
Other Units 0	3.H Pump 7.Electric 11.	2.1/2 Fin 5.FI/Stair 8.
Stories 0	4.Steam 8.FI/Wall 12.	3.3/4 Fin 6. 9.None
1.1 4.1.5 7.	Cool Type 0% 9 None	Insulation 0
2.2 5.1.75 8.	1.Refrig 4.W&C Air 7.	1.Full 4.Minimal 7.
3.3 6.2.5 9.	2.Evapor 5. 8.	2.Heavy 5.Partial 8.
Exterior Walls 0	3.H Pump 6. 9.None	3.Capped 6. 9.None
1.Wood 5.Stucco 9.T-111	Kitchen Style 0	Unfinished % 0%
2.Vin/Al 6.Brick 10.Other	1.Modern 4.Obsolete 7.	Grade & Factor 0 0%
3.Compos. 7.Stone 11.	2.Typical 5. 8.	1.E Grade 4.B Grade 7.
4.Asbestos 8.Concrete 12.	3.Old Type 6. 9.None	2.D Grade 5.A Grade 8.SC Grade
Roof Surface 0	Bath(s) Style 0	3.C Grade 6.AA Grade 9.Same
1.Asphalt 4.Composit 7.	1.Modern 4.Obsolete 7.	SQFT (Footprint) 0
2.Slate 5.Wood 8.	2.Typical 5. 8.	Condition 0
3.Metal 6.Other 9.	3.Old Type 6. 9.None	1.Poor 4.Avg 7.V G
SF Masonry Trim 0	# Rooms 0	2.Fair 5.Avg+ 8.Exc
OPEN-3-CUSTOM 0	# Bedrooms 0	3.Avg- 6.Good 9.Same
OPEN-4-CUSTOM 0	# Full Baths 0	Phys. % Good 0%
Year Built 0	# Half Baths 0	Funct. % Good 100%
Year Remodeled 0	# Addn Fixtures 0	Functional Code 9 None
Foundation 0	# Fireplaces 0	1.Incomp 4.Delap 7.No Power
1.Concrete 4.Wood 7.		2.O-Built 5.Bsmt 8.LongTerm
2.C Block 5.Slab 8.		3.Damage 6.Common 9.None
3.Br/Stone 6.Piers 9.		Econ. % Good 100%
Basement 0		Economic Code None
1.1/4 Bmt 4.Full Bmt 7.		0.None 3.No Power 7.
2.1/2 Bmt 5.None 8.		1.Location 4.Generate 8.
3.3/4 Bmt 6. 9.None		2.Encroach 9.None 9.
Bsmt Gar # Cars 0		Entrance Code 0
Wet Basement 0		1.Interior 4.Vacant 7.
1.Dry 4. 7.		2.Refusal 5.Estimate 8.
2.Damp 5. 8.	3.Informed 6.Reviewed 9.	
3.Wet 6. 9.	Information Code 0	
		1.Owner 4.Agent 7.
		2.Relative 5.Estimate 8.
		3.Tenant 6.Other 9.

Date Inspected

Additions, Outbuildings & Improvements

Type	Year	Units	Grade	Cond	Phys.	Funct.	Sound Value
					%	%	1.One Story Fram
					%	%	2.Two Story Fram
					%	%	3.Three Story Fr
					%	%	4.1 & 1/2 Story
					%	%	5.1 & 3/4 Story
					%	%	6.2 & 1/2 Story
					%	%	21.Open Frame Por
					%	%	22.Encl Frame Por
					%	%	23.Frame Garage
					%	%	24.Frame Shed
					%	%	25.Frame Bay Wind
					%	%	26.1SFr Overhang
					%	%	27.Unfin Basement
					%	%	28.Unfinished Att
					%	%	29.Finished Attic

Washburn

Map Lot 001-036

Account 606

Location Parsons Road

Card 1 Of 1 12/09/2022

Building Style 0	SF Bsmt Living 0	Layout 0
1.Conv. 5.Garrison 9.Gambrel	Fin Bsmt Grade 0 0	1.Typical 4. 7.
2.Ranch 6.Salt Box 10.Other	OPEN 5 OPTIONAL 0	2.Inadeq 5. 8.
3.R Ranch 7.Contemp 11.Split	Heat Type 100% 0	3.Poor 6. 9.
4.Cape 8.Log 12.	1.HWBB 5.FWA 9.No Heat	Attic 0
Dwelling Units 0	2.HWCI 6.GravWA 10.	1.1/4 Fin 4.Full Fin 7.
Other Units 0	3.H Pump 7.Electric 11.	2.1/2 Fin 5.F/Stair 8.
Stories 0	4.Steam 8.F/Wall 12.	3.3/4 Fin 6. 9.None
1.1 4.1.5 7.	Cool Type 0% 9 None	Insulation 0
2.2 5.1.75 8.	1.Refrig 4.W&C Air 7.	1.Full 4.Minimal 7.
3.3 6.2.5 9.	2.Evapor 5. 8.	2.Heavy 5.Partial 8.
Exterior Walls 0	3.H Pump 6. 9.None	3.Capped 6. 9.None
1.Wood 5.Stucco 9.T-111	Kitchen Style 0	Unfinished % 0%
2.Vin/Al 6.Brick 10.Other	1.Modern 4.Obsolete 7.	Grade & Factor 0 0%
3.Compos. 7.Stone 11.	2.Typical 5. 8.	1.E Grade 4.B Grade 7.
4.Asbestos 8.Concrete 12.	3.Old Type 6. 9.None	2.D Grade 5.A Grade 8.SC Grade
Roof Surface 0	Bath(s) Style 0	3.C Grade 6.AA Grade 9.Same
1.Asphalt 4.Composit 7.	1.Modern 4.Obsolete 7.	SQFT (Footprint) 0
2.Slate 5.Wood 8.	2.Typical 5. 8.	Condition 0
3.Metal 6.Other 9.	3.Old Type 6. 9.None	1.Poor 4.Avg 7.V G
SF Masonry Trim 0	# Rooms 0	2.Fair 5.Avg+ 8.Exc
OPEN-3-CUSTOM 0	# Bedrooms 0	3.Avg- 6.Good 9.Same
OPEN-4-CUSTOM 0	# Full Baths 0	Phys. % Good 0%
Year Built 0	# Half Baths 0	Funct. % Good 100%
Year Remodeled 0	# Addn Fixtures 0	Functional Code 9 None
Foundation 0	# Fireplaces 0	1.Incomp 4.Delap 7.No Power
1.Concrete 4.Wood 7.		2.O-Built 5.Bsmt 8.LongTerm
2.C Block 5.Slab 8.		3.Damage 6.Common 9.None
3.Br/Stone 6.Piers 9.		Econ. % Good 100%
Basement 0		Economic Code None
1.1/4 Bmt 4.Full Bmt 7.		0.None 3.No Power 7.
2.1/2 Bmt 5.None 8.		1.Location 4.Generate 8.
3.3/4 Bmt 6. 9.None		2.Encroach 9.None 9.
Bsmt Gar # Cars 0		Entrance Code 0
Wet Basement 0		1.Interior 4.Vacant 7.
1.Dry 4. 7.		2.Refusal 5.Estimate 8.
2.Damp 5. 8.	3.Informed 6.Reviewed 9.	
3.Wet 6. 9.	Information Code 0	
		1.Owner 4.Agent 7.
		2.Relative 5.Estimate 8.
		3.Tenant 6.Other 9.

Date Inspected

Additions, Outbuildings & Improvements								
Type	Year	Units	Grade	Cond	Phys.	Funct.	Sound Value	
					%	%		1.One Story Fram
					%	%		2.Two Story Fram
					%	%		3.Three Story Fr
					%	%		4.1 & 1/2 Story
					%	%		5.1 & 3/4 Story
					%	%		6.2 & 1/2 Story
					%	%		21.Open Frame Por
					%	%		22.Encl Frame Por
					%	%		23.Frame Garage
					%	%		24.Frame Shed
					%	%		25.Frame Bay Wind
					%	%		26.1SFr Overhang
					%	%		27.Unfin Basement
					%	%		28.Unfinished Att
					%	%		29.Finished Attic

Washburn

Map Lot 001-037

Account 1081

Location 2283 PARSONS ROAD

Card 1

Of 1

12/09/2022

Building Style	1 Conventional			SF Bsmt Living	0			Layout	1 Typical		
1.Conv.	5.Garrison	9.Gambrel		Fin Bsmt Grade	0 0			1.Typical	4.	7.	
2.Ranch	6.Salt Box	10.Other		OPEN 5 OPTIONAL	0			2.Inadeq	5.	8.	
3.R Ranch	7.Contemp	11.Split		Heat Type	100% 5 Forced Warm Air			3.Poor	6.	9.	
4.Cape	8.Log	12.		1.HWBB	5.FWA	9.No Heat	Attic	9 None			
Dwelling Units	1			2.HWCI	6.GravWA	10.	1.1/4 Fin	4.Full Fin	7.		
Other Units	0			3.H Pump	7.Electric	11.	2.1/2 Fin	5.FI/Stair	8.		
Stories	4 One & 1/2 Story			4.Steam	8.FI/Wall	12.	3.3/4 Fin	6.	9.None		
1.1	4.1.5	7.		Cool Type	0% 9 None			Insulation	4 Minimal		
2.2	5.1.75	8.		1.Refrig	4.W&C Air	7.	1.Full	4.Minimal	7.		
3.3	6.2.5	9.		2.Evapor	5.	8.	2.Heavy	5.Partial	8.		
Exterior Walls	2 Vinyl/Aluminum			3.H Pump	6.	9.None	3.Capped	6.	9.None		
1.Wood	5.Stucco	9.T-111		Kitchen Style	2 Typical			Unfinished %	0%		
2.Vin/Al	6.Brick	10.Other		1.Modern	4.Obsolete	7.	Grade & Factor	3 Average 90%			
3.Compos.	7.Stone	11.		2.Typical	5.	8.	1.E Grade	4.B Grade	7.		
4.Asbestos	8.Concrete	12.		3.Old Type	6.	9.None	2.D Grade	5.A Grade	8.SC Grade		
Roof Surface	3 Sheet Metal			Bath(s) Style	2 Typical Bath(s)			3.C Grade	6.AA Grade	9.Same	
1.Asphalt	4.Composit	7.		1.Modern	4.Obsolete	7.	SQFT (Footprint)	468			
2.Slate	5.Wood	8.		2.Typical	5.	8.	Condition	6 Good			
3.Metal	6.Other	9.		3.Old Type	6.	9.None	1.Poor	4.Avg	7.V G		
SF Masonry Trim	0			# Rooms	5			2.Fair	5.Avg+	8.Exc	
OPEN-3-CUSTOM	0			# Bedrooms	3			3.Avg-	6.Good	9.Same	
OPEN-4-CUSTOM	0			# Full Baths	1			Phys. % Good	0%		
Year Built	1890			# Half Baths	0			Funct. % Good	100%		
Year Remodeled	0			# Addn Fixtures	0			Functional Code	9 None		
Foundation	3 Brick &/or Stone			# Fireplaces	0			1.Incomp	4.Delap	7.No Power	
1.Concrete	4.Wood	7.			Economic Code	None			0.None	3.No Power	7.
2.C Block	5.Slab	8.			1.Location	4.Generate	8.				
3.Br/Stone	6.Piers	9.			2.Encroach	9.None	9.				
Basement	4 Full Basement				Entrance Code	1 Interior Inspect			1.Interior	4.Vacant	7.
1.1/4 Bmt	4.Full Bmt	7.			2.Refusal	5.Estimate	8.				
2.1/2 Bmt	5.None	8.			3.Informed	6.Reviewed	9.				
3.3/4 Bmt	6.	9.None			Information Code	1 Owner			1.Owner	4.Agent	7.
Bsmt Gar # Cars	0				2.Relative	5.Estimate	8.				
Wet Basement	3 Wet Basement				3.Tenant	6.Other	9.				
1.Dry	4.	7.									
2.Damp	5.	8.									
3.Wet	6.	9.									

Date Inspected 7/29/2018

Additions, Outbuildings & Improvements

Type	Year	Units	Grade	Cond	Phys.	Funct.	Sound Value
21 Open Frame	2012	119	3 100	4	0 %	100 %	
1 One Story Frame	2012	180	3 100	4	0 %	100 %	
22 Encl Frame Porch	2012	112	3 100	4	0 %	100 %	
83 1.75 S-Gar	2012	1152	3 100	4	0 %	85 %	
4 1 & 1/2 Story Fr	0	255	0 0	0	0 %	0 %	
27 Unfin Basement	0	255	0 0	0	0 %	0 %	
1 One Story Frame	0	88	0 0	0	0 %	0 %	
					%	%	
					%	%	
					%	%	

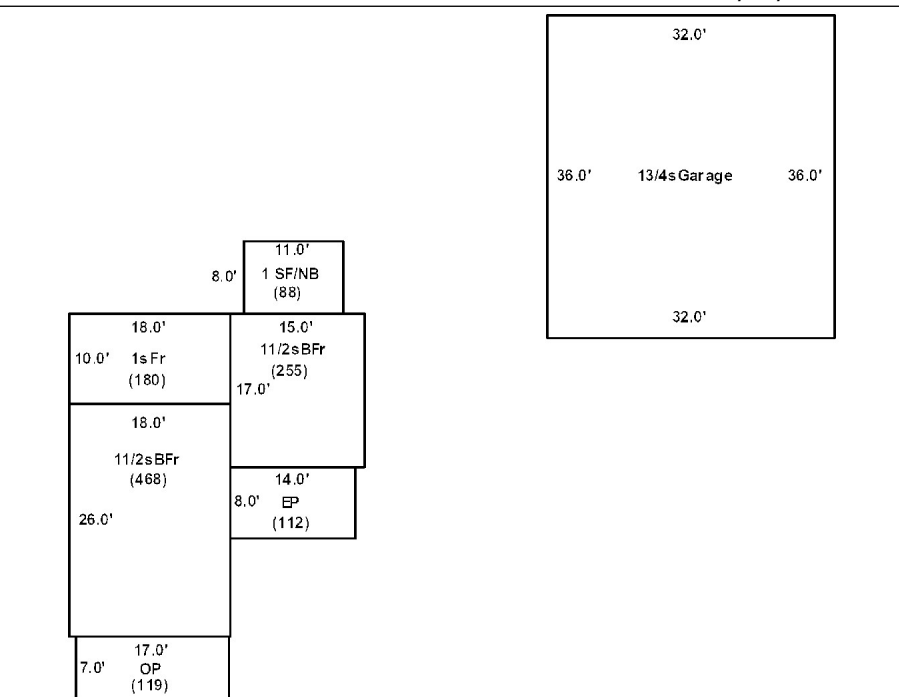

Washburn

Map Lot 001-038/41 & 42

Account 605

Location 2326 Parsons Road

Card 1 Of 2

12/09/2022

Building Style 0	SF Bsmt Living 0	Layout 0
1.Conv. 5.Garrison 9.Gambrel	Fin Bsmt Grade 0 0	1.Typical 4. 7.
2.Ranch 6.Salt Box 10.Other	OPEN 5 OPTIONAL 0	2.Inadeq 5. 8.
3.R Ranch 7.Contemp 11.Split	Heat Type 100% 0	3.Poor 6. 9.
4.Cape 8.Log 12.	1.HWBB 5.FWA 9.No Heat	Attic 0
Dwelling Units 0	2.HWCI 6.GravWA 10.	1.1/4 Fin 4.Full Fin 7.
Other Units 0	3.H Pump 7.Electric 11.	2.1/2 Fin 5.FI/Stair 8.
Stories 0	4.Steam 8.FI/Wall 12.	3.3/4 Fin 6. 9.None
1.1 4.1.5 7.	Cool Type 0% 9 None	Insulation 0
2.2 5.1.75 8.	1.Refrig 4.W&C Air 7.	1.Full 4.Minimal 7.
3.3 6.2.5 9.	2.Evapor 5. 8.	2.Heavy 5.Partial 8.
Exterior Walls 0	3.H Pump 6. 9.None	3.Capped 6. 9.None
1.Wood 5.Stucco 9.T-111	Kitchen Style 0	Unfinished % 0%
2.Vin/Al 6.Brick 10.Other	1.Modern 4.Obsolete 7.	Grade & Factor 0 0%
3.Compos. 7.Stone 11.	2.Typical 5. 8.	1.E Grade 4.B Grade 7.
4.Asbestos 8.Concrete 12.	3.Old Type 6. 9.None	2.D Grade 5.A Grade 8.SC Grade
Roof Surface 0	Bath(s) Style 0	3.C Grade 6.AA Grade 9.Same
1.Asphalt 4.Composit 7.	1.Modern 4.Obsolete 7.	SQFT (Footprint) 0
2.Slate 5.Wood 8.	2.Typical 5. 8.	Condition 0
3.Metal 6.Other 9.	3.Old Type 6. 9.None	1.Poor 4.Avg 7.V G
SF Masonry Trim 0	# Rooms 0	2.Fair 5.Avg+ 8.Exc
OPEN-3-CUSTOM 0	# Bedrooms 0	3.Avg- 6.Good 9.Same
OPEN-4-CUSTOM 0	# Full Baths 0	Phys. % Good 0%
Year Built 0	# Half Baths 0	Funct. % Good 100%
Year Remodeled 0	# Addn Fixtures 0	Functional Code 9 None
Foundation 0	# Fireplaces 0	1.Incomp 4.Delap 7.No Power
1.Concrete 4.Wood 7.		2.O-Built 5.Bsmt 8.LongTerm
2.C Block 5.Slab 8.		3.Damage 6.Common 9.None
3.Br/Stone 6.Piers 9.		Econ. % Good 100%
Basement 0		Economic Code None
1.1/4 Bmt 4.Full Bmt 7.		0.None 3.No Power 7.
2.1/2 Bmt 5.None 8.		1.Location 4.Generate 8.
3.3/4 Bmt 6. 9.None		2.Encroach 9.None 9.
Bsmt Gar # Cars 0		Entrance Code 0
Wet Basement 0		1.Interior 4.Vacant 7.
1.Dry 4. 7.		2.Refusal 5.Estimate 8.
2.Damp 5. 8.	3.Informed 6.Reviewed 9.	
3.Wet 6. 9.	Information Code 0	
	1.Owner 4.Agent 7.	
	2.Relative 5.Estimate 8.	
	3.Tenant 6.Other 9.	

Date Inspected

Additions, Outbuildings & Improvements

Type	Year	Units	Grade	Cond	Phys.	Funct.	Sound Value
223 1S Warehse	1980	20000	3 100	2	0 %	25 %	
223 1S Warehse	1975	52352	3 100	2	0 %	25 %	
24 Frame Shed	0				%	%	500
24 Frame Shed	0				%	%	2,000
183 Truck Scale	1990	480	2 100	4	0 %	25 %	
183 Truck Scale	1990	480	2 100	4	0 %	25 %	
22 Encl Frame Porch	1950	96	3 100	4	0 %	25 %	
					%	%	
					%	%	
					%	%	

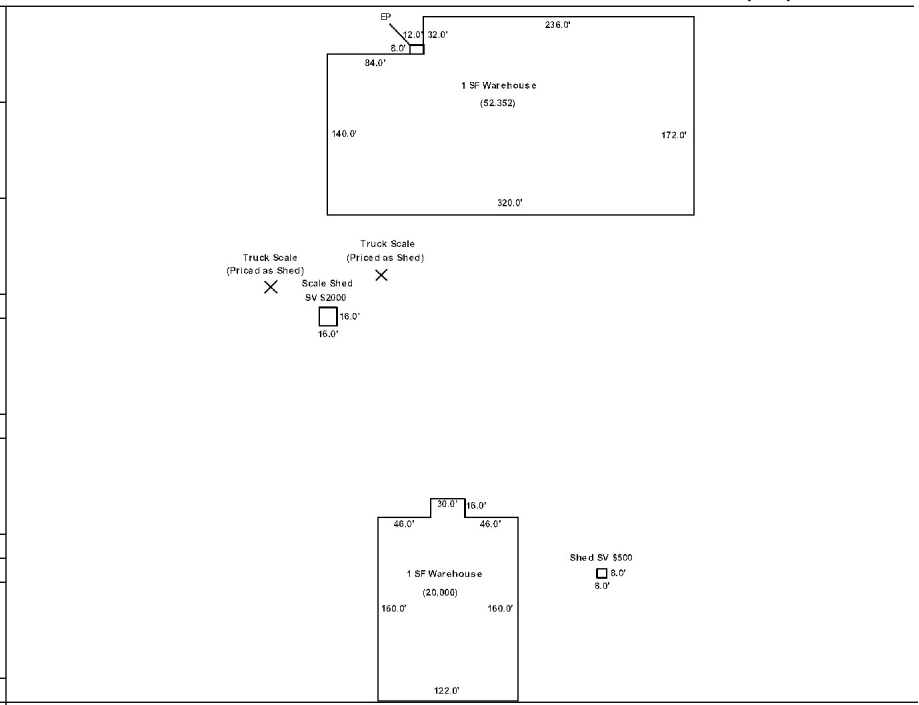

Penobscot McCrum LLC
 P.O. Box 229
 Belfast ME 04915

			Property Data			Assessment Record				
			Neighborhood	1 Neighborhood One		Year	Land	Buildings	Exempt	Total
			Tree Growth Year	0		2020	1,375,000	0	1,375,000	0
			1ST MORTGAGE	0		2021	1,375,000	97,200	1,472,200	0
			2ND MORTGAGE	0		2022	1,375,000	97,200	1,472,200	0
			Zone/Land Use	2 Commercial						
			Secondary Zone							
			Topography	1 Level						
			1.Level	4.Below St	7.LevelBog					
			2.Rolling	5.Low	8.					
			3.Above St	6.Swampy	9.					
			Utilities	4 Drilled Well 6 Septic System						
			1.Public	4.Dr Well	7.Cesspool					
			2.Water	5.Dug Well	8.					
			3.Sewer	6.Septic	9.None					
			Street	1 Paved						
			1.Paved	4.Proposed	7.					
			2.Semi Imp	5.R/O/W	8.					
			3.Gravel	6.	9.None					
			TG PLAN YEAR	0						
			Tif District #	0						
			Sale Data							
			Sale Date							
			Price							
			Sale Type							
			1.Land	4.Mobile	7.C/I L&B					
			2.L & B	5.Other	8.					
			3.Building	6.C/I Land	9.					
			Financing							
			1.Convent	4.Seller	7.					
			2.FHA/VA	5.Private	8.					
			3.Assumed	6.Cash	9.Unknown					
			Validity							
			1.Valid	4.Split	7.Renovate					
			2.Related	5.Partial	8.Other					
			3.Distress	6.Exempt	9.					
			Verified							
			1.Buyer	4.Agent	7.Family					
			2.Seller	5.Pub Rec	8.Other					
			3.Lender	6.MLS	9.					
			Fract. Acre							
			21.Developed Pave							
			22.Undev Paved (F							
			23.Developed Grav							
			Acres							
			24.Undev Gravel (
			25.Comm Base Pave							
			26.Comm Base Grav							
			27.Backlot							
			28.Rear Land							
			29.Pavement							
			Front Foot	Type	Effective		Influence		Influence Codes	
					Frontage	Depth	Factor	Code		
			11.Regular Lot				%	1.Unimproved		
			12.Delta Triangle				%	2.Excess Frtg		
			13.Nabla Triangle				%	3.Topography		
			14.Rear Land				%	4.Size/Shape		
			15.Class I Road				%	5.Access		
							%	6.Restriction		
							%	7.Open Space		
							%	8.View/Environ		
							%	9.Fract Share		
			Square Foot	Square Feet				Acres		
			16.Class II Road				%	30.Utility R O W		
			17.Municipal Rese				%	31.Tillable		
			18.Munic Sep Lago				%	32.Pasture		
			19.Gravel Pit				%	33.Orchard		
			20.Industrial Bas				%	34.Softwood F&O		
							%	35.Mixed Wood F&O		
							%	36.Hardwood F&O		
							%	37.Softwood TG		
			46		0.50	100	%	0		
							%	38.Mixed Wood TG		
							%	39.Hardwood TG		
							%	40.Wasteland		
							%	41.Open Space		
							%	42.Mobile Home Si		
							%	43.Condo Site		
							%	44.Lot Improvemen		
							%	45.Subdivision Lo		
							%	46.Heavy Ind Sit		
							%			
							%			
			Total Acreage		0.00					

Inspection Witnessed By:

X	Date	
No./Date	Description	Date Insp.

Notes:

Washburn

Washburn

Map Lot 001-038/41 &42-ON

Account 1140

Location Waste Water Treatment

Card 1 Of 1 12/09/2022

Building Style			SF Bsmt Living			Layout									
1.Conv.	5.Garrison	9.Gambrel	Fin Bsmt Grade			1.Typical	4.	7.							
2.Ranch	6.Salt Box	10.Other	OPEN 5 OPTIONAL			2.Inadeq	5.	8.							
3.R Ranch	7.Contemp	11.Split	Heat Type 100%			3.Poor	6.	9.							
4.Cape	8.Log	12.	1.HWBB	5.FWA	9.No Heat	Attic									
Dwelling Units			2.HWCI	6.GravWA	10.	1.1/4 Fin	4.Full Fin	7.							
Other Units			3.H Pump	7.Electric	11.	2.1/2 Fin	5.FI/Stair	8.							
Stories			4.Steam	8.FI/Wall	12.	3.3/4 Fin	6.	9.None							
1.1	4.1.5	7.	Cool Type 0%			Insulation									
2.2	5.1.75	8.	1.Refrig	4.W&C Air	7.	1.Full	4.Minimal	7.							
3.3	6.2.5	9.	2.Evapor	5.	8.	2.Heavy	5.Partial	8.							
Exterior Walls			3.H Pump	6.	9.None	3.Capped	6.	9.None							
1.Wood	5.Stucco	9.T-111	Kitchen Style			Unfinished %									
2.Vin/Al	6.Brick	10.Other	1.Modern	4.Obsolete	7.	Grade & Factor									
3.Compos.	7.Stone	11.	2.Typical	5.	8.	1.E Grade	4.B Grade	7.							
4.Asbestos	8.Concrete	12.	3.Old Type	6.	9.None	2.D Grade	5.A Grade	8.SC Grade							
Roof Surface			Bath(s) Style			3.C Grade	6.AA Grade	9.Same							
1.Asphalt	4.Composit	7.	1.Modern	4.Obsolete	7.	SQFT (Footprint)									
2.Slate	5.Wood	8.	2.Typical	5.	8.	Condition									
3.Metal	6.Other	9.	3.Old Type	6.	9.None	1.Poor	4.Avg	7.V G							
SF Masonry Trim			# Rooms			2.Fair	5.Avg+	8.Exc							
OPEN-3-CUSTOM			# Bedrooms			3.Avg-	6.Good	9.Same							
OPEN-4-CUSTOM			# Full Baths			Phys. % Good									
Year Built			# Half Baths			Funct. % Good									
Year Remodeled			# Addn Fixtures			Functional Code									
Foundation			# Fireplaces			1.Incomp	4.Delap	7.No Power							
1.Concrete	4.Wood	7.							2.O-Built	5.Bsmt	8.LongTerm				
2.C Block	5.Slab	8.							Econ. % Good			3.Damage	6.Common	9.None	
3.Br/Stone	6.Piers	9.							Economic Code			Entrance Code 0			
Basement									0.None			3.No Power	7.	1.Location	
1.1/4 Bmt	4.Full Bmt	7.							1.None			4.Generate	8.	2.Encroach	
2.1/2 Bmt	5.None	8.							1.Location			4.Generate	8.	3.Informed	
3.3/4 Bmt	6.	9.None							2.Encroach			9.None	9.	6.Reviewed	
Bsmt Gar # Cars									3.Informed			6.Reviewed	9.	Information Code 0	
Wet Basement									1.Owner			4.Agent	7.	2.Relative	
1.Dry	4.	7.							2.Relative			5.Estimate	8.	3.Tenant	
2.Damp	5.	8.	3.Tenant			6.Other	9.								
3.Wet	6.	9.													
Date Inspected															
Additions, Outbuildings & Improvements															
Type	Year	Units	Grade	Cond	Phys.	Funct.	Sound Value	1.One Story Fram							
23 Frame Garage	2020				%	%	97,200	2.Two Story Fram							
					%	%		3.Three Story Fr							
					%	%		4.1 & 1/2 Story							
					%	%		5.1 & 3/4 Story							
					%	%		6.2 & 1/2 Story							
					%	%		21.Open Frame Por							
					%	%		22.Encl Frame Por							
					%	%		23.Frame Garage							
					%	%		24.Frame Shed							
					%	%		25.Frame Bay Wind							
					%	%		26.1SFr Overhang							
					%	%		27.Unfin Basement							
					%	%		28.Unfinished Att							
					%	%		29.Finished Attic							



SMITH FARM PROPERTIES INC.
1407 STATE ROAD
MAPLETON ME 04757

B4117P343

Inspection Witnessed By:

No./Date	Description	Date Insp.
X		

Notes:

Washburn

Property Data			Assessment Record						
Neighborhood 1 Neighborhood One			Year	Land	Buildings	Exempt	Total		
Tree Growth Year 0			2009	35,900	0	0	35,900		
1ST MORTGAGE 0			2012	35,900	0	0	35,900		
2ND MORTGAGE 0			2013	46,600	0	0	46,600		
Zone/Land Use 1 Residential			2015	46,600	0	0	46,600		
Secondary Zone			2018	46,600	0	0	46,600		
Topography 2 Rolling			2019	91,000	0	0	91,000		
1.Level 4.Below St 7.LevelBog			2020	91,000	0	0	91,000		
2.Rolling 5.Low 8.			2021	91,000	0	0	91,000		
3.Above St 6.Swampy 9.			2022	91,000	0	0	91,000		
Utilities									
1.Public 4.Dr Well 7.Cesspool									
2.Water 5.Dug Well 8.									
3.Sewer 6.Septic 9.None									
Street 1 Paved									
1.Paved 4.Proposed 7.									
2.Semi Imp 5.R/O/W 8.									
3.Gravel 6. 9.None									
TG PLAN YEAR 0									
Tif District # 0									
Sale Data			Land Data						
Sale Date 5/10/2005			Front Foot	Type	Effective		Influence		Influence Codes
Price					Frontage	Depth	Factor	Code	
Sale Type 1 Land Only			11.Regular Lot					1.Unimproved	
1.Land 4.Mobile 7.C/I L&B			12.Delta Triangle					2.Excess Frtg	
2.L & B 5.Other 8.			13.Nabla Triangle					3.Topography	
3.Building 6.C/I Land 9.			14.Rear Land					4.Size/Shape	
Financing			15.Class I Road					5.Access	
1.Convent 4.Seller 7.								6.Restriction	
2.FHA/VA 5.Private 8.								7.Open Space	
3.Assumed 6.Cash 9.Unknown								8.View/Environ	
Validity 2 Related Parties			Square Foot	Square Feet				9.Fract Share	
1.Valid 4.Split 7.Renovate			16.Class II Road					Acres	
2.Related 5.Partial 8.Other			17.Municipal Rese					30.Utility R O W	
3.Distress 6.Exempt 9.			18.Munic Sep Lago					31.Tillable	
Verified 5 Public Record			19.Gravel Pit					32.Pasture	
1.Buyer 4.Agent 7.Family			20.Industrial Bas					33.Orchard	
2.Seller 5.Pub Rec 8.Other								34.Softwood F&O	
3.Lender 6.MLS 9.			Fract. Acre	Acres/Sites				35.Mixed Wood F&O	
			21.Developed Pave	22	1.00	100	%	0	
			22.Undev Paved (F	28	56.00	100	%	0	
			23.Developed Grav	31	54.00	100	%	0	
			Acres						
			24.Undev Gravel (%	
			25.Comm Base Pave					%	
			26.Comm Base Grav					%	
			27.Backlot					%	
			28.Rear Land					%	
			29.Pavement					%	
			Total Acreage		111.00				
							44.Lot Improvemen		
							45.Subdivision Lo		
							46.Heavy Ind Sit		

Washburn

Map Lot 001-039

Account 814

Location PARSONS ROAD

Card 1 Of 1 12/09/2022

Building Style 0	SF Bsmt Living 0	Layout 0
1.Conv. 5.Garrison 9.Gambrel	Fin Bsmt Grade 0 0	1.Typical 4. 7.
2.Ranch 6.Salt Box 10.Other	OPEN 5 OPTIONAL 0	2.Inadeq 5. 8.
3.R Ranch 7.Contemp 11.Split	Heat Type 100% 0	3.Poor 6. 9.
4.Cape 8.Log 12.	1.HWBB 5.FWA 9.No Heat	Attic 0
Dwelling Units 0	2.HWCI 6.GravWA 10.	1.1/4 Fin 4.Full Fin 7.
Other Units 0	3.H Pump 7.Electric 11.	2.1/2 Fin 5.FI/Stair 8.
Stories 0	4.Steam 8.FI/Wall 12.	3.3/4 Fin 6. 9.None
1.1 4.1.5 7.	Cool Type 0% 9 None	Insulation 0
2.2 5.1.75 8.	1.Refrig 4.W&C Air 7.	1.Full 4.Minimal 7.
3.3 6.2.5 9.	2.Evapor 5. 8.	2.Heavy 5.Partial 8.
Exterior Walls 0	3.H Pump 6. 9.None	3.Capped 6. 9.None
1.Wood 5.Stucco 9.T-111	Kitchen Style 0	Unfinished % 0%
2.Vin/Al 6.Brick 10.Other	1.Modern 4.Obsolete 7.	Grade & Factor 0 0%
3.Compos. 7.Stone 11.	2.Typical 5. 8.	1.E Grade 4.B Grade 7.
4.Asbestos 8.Concrete 12.	3.Old Type 6. 9.None	2.D Grade 5.A Grade 8.SC Grade
Roof Surface 0	Bath(s) Style 0	3.C Grade 6.AA Grade 9.Same
1.Asphalt 4.Composit 7.	1.Modern 4.Obsolete 7.	SQFT (Footprint) 0
2.Slate 5.Wood 8.	2.Typical 5. 8.	Condition 0
3.Metal 6.Other 9.	3.Old Type 6. 9.None	1.Poor 4.Avg 7.V G
SF Masonry Trim 0	# Rooms 0	2.Fair 5.Avg+ 8.Exc
OPEN-3-CUSTOM 0	# Bedrooms 0	3.Avg- 6.Good 9.Same
OPEN-4-CUSTOM 0	# Full Baths 0	Phys. % Good 0%
Year Built 0	# Half Baths 0	Funct. % Good 100%
Year Remodeled 0	# Addn Fixtures 0	Functional Code 9 None
Foundation 0	# Fireplaces 0	1.Incomp 4.Delap 7.No Power
1.Concrete 4.Wood 7.		2.O-Built 5.Bsmt 8.LongTerm
2.C Block 5.Slab 8.		3.Damage 6.Common 9.None
3.Br/Stone 6.Piers 9.		Econ. % Good 100%
Basement 0		Economic Code None
1.1/4 Bmt 4.Full Bmt 7.		0.None 3.No Power 7.
2.1/2 Bmt 5.None 8.		1.Location 4.Generate 8.
3.3/4 Bmt 6. 9.None		2.Encroach 9.None 9.
Bsmt Gar # Cars 0		Entrance Code 0
Wet Basement 0		1.Interior 4.Vacant 7.
1.Dry 4. 7.		2.Refusal 5.Estimate 8.
2.Damp 5. 8.	3.Informed 6.Reviewed 9.	
3.Wet 6. 9.	Information Code 0	
		1.Owner 4.Agent 7.
		2.Relative 5.Estimate 8.
		3.Tenant 6.Other 9.

Date Inspected

Additions, Outbuildings & Improvements							
Type	Year	Units	Grade	Cond	Phys.	Funct.	Sound Value
					%	%	1.One Story Fram
					%	%	2.Two Story Fram
					%	%	3.Three Story Fr
					%	%	4.1 & 1/2 Story
					%	%	5.1 & 3/4 Story
					%	%	6.2 & 1/2 Story
					%	%	21.Open Frame Por
					%	%	22.Encl Frame Por
					%	%	23.Frame Garage
					%	%	24.Frame Shed
					%	%	25.Frame Bay Wind
					%	%	26.1SFr Overhang
					%	%	27.Unfin Basement
					%	%	28.Unfinished Att
					%	%	29.Finished Attic

Washburn

Map Lot 001-043

Account 30

Location 2398 PARSONS ROAD

Card 1

Of 1

12/09/2022

Building Style	5 Garrison		SF Bsmt Living	300		Layout	1 Typical						
1.Conv.	5.Garrison	9.Gambrel	Fin Bsmt Grade	2 100		1.Typical	4.	7.					
2.Ranch	6.Salt Box	10.Other	OPEN 5 OPTIONAL	0		2.Inadeq	5.	8.					
3.R Ranch	7.Contemp	11.Split	Heat Type	100% 1 Hot Water BB		3.Poor	6.	9.					
4.Cape	8.Log	12.	1.HWBB	5.FWA	9.No Heat	Attic 5 Floor & Stairs							
Dwelling Units	1		2.HWCI	6.GravWA	10.	1.1/4 Fin	4.Full Fin	7.					
Other Units	0		3.H Pump	7.Electric	11.	2.1/2 Fin	5.F/Stair	8.					
Stories	2 Two Story		4.Steam	8.F/Wall	12.	3.3/4 Fin	6.	9.None					
1.1	4.1.5	7.	Cool Type	0% 9 None		Insulation 1 Full							
2.2	5.1.75	8.	1.Refrig	4.W&C Air	7.	1.Full	4.Minimal	7.					
3.3	6.2.5	9.	2.Evapor	5.	8.	2.Heavy	5.Partial	8.					
Exterior Walls	2 Vinyl/Aluminum		3.H Pump	6.	9.None	3.Capped	6.	9.None					
1.Wood	5.Stucco	9.T-111	Kitchen Style	2 Typical		Unfinished % 0%							
2.Vin/Al	6.Brick	10.Other	1.Modern	4.Obsolete	7.	Grade & Factor 3 Average 100%							
3.Compos.	7.Stone	11.	2.Typical	5.	8.	1.E Grade	4.B Grade	7.					
4.Asbestos	8.Concrete	12.	3.Old Type	6.	9.None	2.D Grade	5.A Grade	8.SC Grade					
Roof Surface	1 Asphalt Shingles		Bath(s) Style	2 Typical Bath(s)		3.C Grade	6.AA Grade	9.Same					
1.Asphalt	4.Composit	7.	1.Modern	4.Obsolete	7.	SQFT (Footprint) 864							
2.Slate	5.Wood	8.	2.Typical	5.	8.	Condition 5 Above Average							
3.Metal	6.Other	9.	3.Old Type	6.	9.None	1.Poor	4.Avg	7.V G					
SF Masonry Trim	0		# Rooms	7		2.Fair	5.Avg+	8.Exc					
OPEN-3-CUSTOM	0		# Bedrooms	4		3.Avg-	6.Good	9.Same					
OPEN-4-CUSTOM	0		# Full Baths	1		Phys. % Good 0%							
Year Built	1948		# Half Baths	1		Funct. % Good 100%							
Year Remodeled	0		# Addn Fixtures	0		Functional Code 9 None							
Foundation	1 Concrete		# Fireplaces	2		1.Incomp	4.Delap	7.No Power					
1.Concrete	4.Wood	7.							2.O-Built	5.Bsmt	8.LongTerm		
2.C Block	5.Slab	8.							Economic Code None				
3.Br/Stone	6.Piers	9.							0.None			3.No Power	7.
Basement	4 Full Basement								1.Location			4.Generate	8.
1.1/4 Bmt	4.Full Bmt	7.							2.Encroach			9.None	9.
2.1/2 Bmt	5.None	8.							Entrance Code 1 Interior Inspect				
3.3/4 Bmt	6.	9.None							1.Interior			4.Vacant	7.
Bsmt Gar # Cars	0								2.Refusal			5.Estimate	8.
Wet Basement	2 Damp Basement								3.Informed			6.Reviewed	9.
1.Dry	4.	7.							Information Code 1 Owner				
2.Damp	5.	8.	1.Owner			4.Agent	7.						
3.Wet	6.	9.	2.Relative			5.Estimate	8.						
			3.Tenant			6.Other	9.						

Date Inspected 7/29/2018

Additions, Outbuildings & Improvements

Type	Year	Units	Grade	Cond	Phys.	Funct.	Sound Value
68 Wood Deck	0	100	0 0	0	0 %	0 %	
1 One Story Frame	0	276	0 0	0	0 %	0 %	
23 Frame Garage	1965	576	3 90	4	0 %	80 %	
24 Frame Shed	0				%	%	200
24 Frame Shed	0				%	%	50
24 Frame Shed	0				%	%	300
24 Frame Shed	0				%	%	100
87 Pole Barn	0				%	%	200
66 Res. Greenhouse	0				%	%	1,500
					%	%	

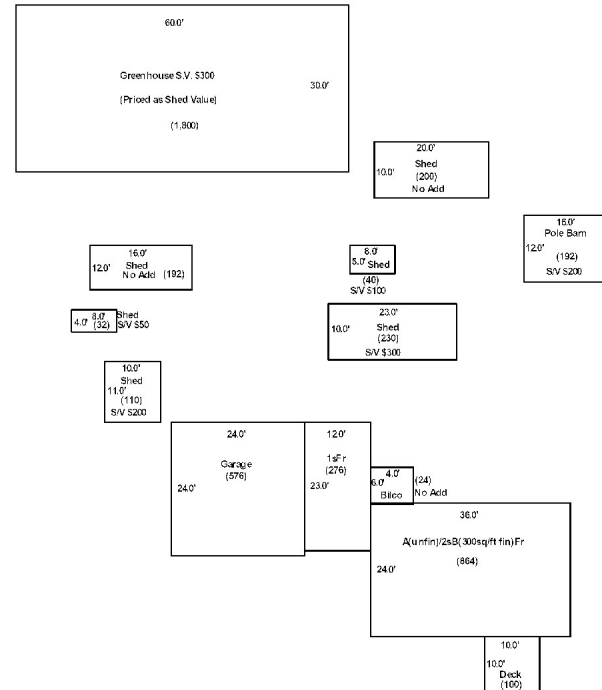

KLEI, HUGH T
76 TURNPIKE ROAD
WILLINGTON CT 06279

B5199P59 B5968P320 B5968P322

Inspection Witnessed By:

No./Date	Description	Date Insp.
X		

Notes:
* Bk 5968 Pg 320 is memorandum of lease
Changed 172 Acres from Tillable to Floodfields for plant -
(Waste)

Washburn

Property Data			Assessment Record						
Neighborhood 1 Neighborhood One			Year	Land	Buildings	Exempt	Total		
Tree Growth Year 0			2009	71,300	0	0	71,300		
1ST MORTGAGE 0			2012	71,300	0	0	71,300		
2ND MORTGAGE 0			2013	92,700	0	0	92,700		
Zone/Land Use 1 Residential			2015	92,700	0	0	92,700		
Secondary Zone			2018	92,700	0	0	92,700		
Topography 1 Level			2019	227,500	0	0	227,500		
1.Level 4.Below St 7.LevelBog			2020	132,900	0	0	132,900		
2.Rolling 5.Low 8.			2021	132,900	0	0	132,900		
3.Above St 6.Swampy 9.			2022	132,900	0	0	132,900		
Utilities									
1.Public 4.Dr Well 7.Cesspool									
2.Water 5.Dug Well 8.									
3.Sewer 6.Septic 9.None									
Street 1 Paved									
1.Paved 4.Proposed 7.									
2.Semi Imp 5.R/O/W 8.									
3.Gravel 6. 9.None									
TG PLAN YEAR 0									
Tif District # 0									
Sale Data			Land Data						
Sale Date 8/14/2008			Front Foot	Type	Effective		Influence		Influence Codes
Price 227,000					Frontage	Depth	Factor	Code	
Sale Type 1 Land Only			11.Regular Lot					1.Unimproved	
1.Land 4.Mobile 7.C/I L&B			12.Delta Triangle			%		2.Excess Frtg	
2.L & B 5.Other 8.			13.Nabla Triangle			%		3.Topography	
3.Building 6.C/I Land 9.			14.Rear Land			%		4.Size/Shape	
Financing			15.Class I Road			%		5.Access	
1.Convent 4.Seller 7.						%		6.Restriction	
2.FHA/VA 5.Private 8.						%		7.Open Space	
3.Assumed 6.Cash 9.Unknown						%		8.View/Environ	
Validity 3 Distressed Sale						%		9.Fract Share	
1.Valid 4.Split 7.Renovate			Square Foot	Square Feet				Acres	
2.Related 5.Partial 8.Other			16.Class II Road			%		30.Utility R O W	
3.Distress 6.Exempt 9.			17.Municipal Rese			%		31.Tillable	
Verified 5 Public Record			18.Munic Sep Lago			%		32.Pasture	
1.Buyer 4.Agent 7.Family			19.Gravel Pit			%		33.Orchard	
2.Seller 5.Pub Rec 8.Other			20.Industrial Bas			%		34.Softwood F&O	
3.Lender 6.MLS 9.						%		35.Mixed Wood F&O	
			Fract. Acre	Acreege/Sites				36.Hardwood F&O	
			21.Developed Pave	22	1.00	100 %	0	37.Softwood TG	
			22.Undev Paved (F	28	25.50	100 %	0	38.Mixed Wood TG	
			23.Developed Grav	31	24.00	100 %	0	39.Hardwood TG	
			Acres	28	172.00	100 %	0	40.Wasteland	
			24.Undev Gravel (40	19.50	100 %	0	41.Open Space	
			25.Comm Base Pave			%		42.Mobile Home Si	
			26.Comm Base Grav			%		43.Condo Site	
			27.Backlot			%		44.Lot Improvemen	
			28.Rear Land			%		45.Subdivision Lo	
			29.Pavement			%		46.Heavy Ind Sit	
			Total Acreege		242.00				

Washburn

Map Lot 001-044

Account 1105

Location CASTLE HILL ROAD

Card 1 Of 1 12/09/2022

Building Style 0	SF Bsmt Living 0	Layout 0
1.Conv. 5.Garrison 9.Gambrel	Fin Bsmt Grade 0 0	1.Typical 4. 7.
2.Ranch 6.Salt Box 10.Other	OPEN 5 OPTIONAL 0	2.Inadeq 5. 8.
3.R Ranch 7.Contemp 11.Split	Heat Type 100% 0	3.Poor 6. 9.
4.Cape 8.Log 12.	1.HWBB 5.FWA 9.No Heat	Attic 0
Dwelling Units 0	2.HWCI 6.GravWA 10.	1.1/4 Fin 4.Full Fin 7.
Other Units 0	3.H Pump 7.Electric 11.	2.1/2 Fin 5.FI/Stair 8.
Stories 0	4.Steam 8.FI/Wall 12.	3.3/4 Fin 6. 9.None
1.1 4.1.5 7.	Cool Type 0% 9 None	Insulation 0
2.2 5.1.75 8.	1.Refrig 4.W&C Air 7.	1.Full 4.Minimal 7.
3.3 6.2.5 9.	2.Evapor 5. 8.	2.Heavy 5.Partial 8.
Exterior Walls 0	3.H Pump 6. 9.None	3.Capped 6. 9.None
1.Wood 5.Stucco 9.T-111	Kitchen Style 0	Unfinished % 0%
2.Vin/Al 6.Brick 10.Other	1.Modern 4.Obsolete 7.	Grade & Factor 0 0%
3.Compos. 7.Stone 11.	2.Typical 5. 8.	1.E Grade 4.B Grade 7.
4.Asbestos 8.Concrete 12.	3.Old Type 6. 9.None	2.D Grade 5.A Grade 8.SC Grade
Roof Surface 0	Bath(s) Style 0	3.C Grade 6.AA Grade 9.Same
1.Asphalt 4.Composit 7.	1.Modern 4.Obsolete 7.	SQFT (Footprint) 0
2.Slate 5.Wood 8.	2.Typical 5. 8.	Condition 0
3.Metal 6.Other 9.	3.Old Type 6. 9.None	1.Poor 4.Avg 7.V G
SF Masonry Trim 0	# Rooms 0	2.Fair 5.Avg+ 8.Exc
OPEN-3-CUSTOM 0	# Bedrooms 0	3.Avg- 6.Good 9.Same
OPEN-4-CUSTOM 0	# Full Baths 0	Phys. % Good 0%
Year Built 0	# Half Baths 0	Funct. % Good 100%
Year Remodeled 0	# Addn Fixtures 0	Functional Code 9 None
Foundation 0	# Fireplaces 0	1.Incomp 4.Delap 7.No Power
1.Concrete 4.Wood 7.		2.O-Built 5.Bsmt 8.LongTerm
2.C Block 5.Slab 8.		3.Damage 6.Common 9.None
3.Br/Stone 6.Piers 9.		Econ. % Good 100%
Basement 0		Economic Code None
1.1/4 Bmt 4.Full Bmt 7.		0.None 3.No Power 7.
2.1/2 Bmt 5.None 8.		1.Location 4.Generate 8.
3.3/4 Bmt 6. 9.None		2.Encroach 9.None 9.
Bsmt Gar # Cars 0		Entrance Code 0
Wet Basement 0		1.Interior 4.Vacant 7.
1.Dry 4. 7.		2.Refusal 5.Estimate 8.
2.Damp 5. 8.	3.Informed 6.Reviewed 9.	
3.Wet 6. 9.	Information Code 0	
		1.Owner 4.Agent 7.
		2.Relative 5.Estimate 8.
		3.Tenant 6.Other 9.

Date Inspected

Additions, Outbuildings & Improvements

Type	Year	Units	Grade	Cond	Phys.	Funct.	Sound Value
					%	%	1.One Story Fram
					%	%	2.Two Story Fram
					%	%	3.Three Story Fr
					%	%	4.1 & 1/2 Story
					%	%	5.1 & 3/4 Story
					%	%	6.2 & 1/2 Story
					%	%	21.Open Frame Por
					%	%	22.Encl Frame Por
					%	%	23.Frame Garage
					%	%	24.Frame Shed
					%	%	25.Frame Bay Wind
					%	%	26.1SFr Overhang
					%	%	27.Unfin Basement
					%	%	28.Unfinished Att
					%	%	29.Finished Attic

SMITH FARM PROPERTIES, INC.
1407 State Road
Mapleton ME 04757

B4117P343

Inspection Witnessed By:

No./Date	Description	Date Insp.
X		

Notes:

Washburn

Property Data			Assessment Record						
Neighborhood 1 Neighborhood One			Year	Land	Buildings	Exempt	Total		
Tree Growth Year 0			2009	27,700	0	0	27,700		
1ST MORTGAGE 0			2012	27,700	0	0	27,700		
2ND MORTGAGE 0			2013	35,900	0	0	35,900		
Zone/Land Use 1 Residential			2015	35,900	0	0	35,900		
Secondary Zone			2018	35,900	0	0	35,900		
Topography 2 Rolling			2019	75,000	0	0	75,000		
1.Level 4.Below St 7.LevelBog			2020	75,000	0	0	75,000		
2.Rolling 5.Low 8.			2021	75,000	0	0	75,000		
3.Above St 6.Swampy 9.			2022	75,000	0	0	75,000		
Utilities									
1.Public 4.Dr Well 7.Cesspool									
2.Water 5.Dug Well 8.									
3.Sewer 6.Septic 9.None									
Street 1 Paved									
1.Paved 4.Proposed 7.									
2.Semi Imp 5.R/O/W 8.									
3.Gravel 6. 9.None									
TG PLAN YEAR 0									
Tif District # 0									
Sale Data			Land Data						
Sale Date 5/10/2005			Front Foot	Type	Effective		Influence		Influence Codes
Price			11.Regular Lot		Frontage	Depth	Factor	Code	1.Unimproved
Sale Type 1 Land Only			12.Delta Triangle				%		2.Excess Frtg
1.Land 4.Mobile 7.C/I L&B			13.Nabla Triangle				%		3.Topography
2.L & B 5.Other 8.			14.Rear Land				%		4.Size/Shape
3.Building 6.C/I Land 9.			15.Class I Road				%		5.Access
Financing							%		6.Restriction
1.Convent 4.Seller 7.							%		7.Open Space
2.FHA/VA 5.Private 8.							%		8.View/Environ
3.Assumed 6.Cash 9.Unknown							%		9.Fract Share
Validity 2 Related Parties			Square Foot	Square Feet					Acres
1.Valid 4.Split 7.Renovate			16.Class II Road				%		30.Utility R O W
2.Related 5.Partial 8.Other			17.Municipal Rese				%		31.Tillable
3.Distress 6.Exempt 9.			18.Munic Sep Lago				%		32.Pasture
Verified 5 Public Record			19.Gravel Pit				%		33.Orchard
1.Buyer 4.Agent 7.Family			20.Industrial Bas				%		34.Softwood F&O
2.Seller 5.Pub Rec 8.Other							%		35.Mixed Wood F&O
3.Lender 6.MLS 9.							%		36.Hardwood F&O
			Fract. Acre	Acreage/Sites					37.Softwood TG
			21.Developed Pave	22	1.00	100	%	0	38.Mixed Wood TG
			22.Undev Paved (F	28	20.00	100	%	0	39.Hardwood TG
			23.Developed Grav	31	56.00	100	%	0	40.Wasteland
							%		41.Open Space
			24.Undev Gravel (%		42.Mobile Home Si
			25.Comm Base Pave				%		43.Condo Site
			26.Comm Base Grav				%		44.Lot Improvemen
			27.Backlot				%		45.Subdivision Lo
			28.Rear Land				%		46.Heavy Ind Sit
			29.Pavement				%		
			Total Acreage		77.00				

Washburn

Map Lot 001-045

Account 815

Location 463 CASTLE HILL ROAD

Card 1 Of 1 12/09/2022

Building Style 0	SF Bsmt Living 0	Layout 0			
1.Conv. 5.Garrison 9.Gambrel	Fin Bsmt Grade 0 0	1.Typical 4. 7.			
2.Ranch 6.Salt Box 10.Other	OPEN 5 OPTIONAL 0	2.Inadeq 5. 8.			
3.R Ranch 7.Contemp 11.Split	Heat Type 100% 0	3.Poor 6. 9.			
4.Cape 8.Log 12.	1.HWBB 5.FWA 9.No Heat	Attic 0			
Dwelling Units 0	2.HWCI 6.GravWA 10.	1.1/4 Fin 4.Full Fin 7.			
Other Units 0	3.H Pump 7.Electric 11.	2.1/2 Fin 5.FI/Stair 8.			
Stories 0	4.Steam 8.FI/Wall 12.	3.3/4 Fin 6. 9.None			
1.1 4.1.5 7.	Cool Type 0% 9 None	Insulation 0			
2.2 5.1.75 8.	1.Refrig 4.W&C Air 7.	1.Full 4.Minimal 7.			
3.3 6.2.5 9.	2.Evapor 5. 8.	2.Heavy 5.Partial 8.			
Exterior Walls 0	3.H Pump 6. 9.None	3.Capped 6. 9.None			
1.Wood 5.Stucco 9.T-111	Kitchen Style 0	Unfinished % 0%			
2.Vin/Al 6.Brick 10.Other	1.Modern 4.Obsolete 7.	Grade & Factor 0 0%			
3.Compos. 7.Stone 11.	2.Typical 5. 8.	1.E Grade 4.B Grade 7.			
4.Asbestos 8.Concrete 12.	3.Old Type 6. 9.None	2.D Grade 5.A Grade 8.SC Grade			
Roof Surface 0	Bath(s) Style 0	3.C Grade 6.AA Grade 9.Same			
1.Asphalt 4.Composit 7.	1.Modern 4.Obsolete 7.	SQFT (Footprint) 0			
2.Slate 5.Wood 8.	2.Typical 5. 8.	Condition 0			
3.Metal 6.Other 9.	3.Old Type 6. 9.None	1.Poor 4.Avg 7.V G			
SF Masonry Trim 0	# Rooms 0	2.Fair 5.Avg+ 8.Exc			
OPEN-3-CUSTOM 0	# Bedrooms 0	3.Avg- 6.Good 9.Same			
OPEN-4-CUSTOM 0	# Full Baths 0	Phys. % Good 0%			
Year Built 0	# Half Baths 0	Funct. % Good 100%			
Year Remodeled 0	# Addn Fixtures 0	Functional Code 9 None			
Foundation 0	# Fireplaces 0	1.Incomp 4.Delap 7.No Power			
1.Concrete 4.Wood 7.		2.O-Built 5.Bsmt 8.LongTerm			
2.C Block 5.Slab 8.		3.Damage 6.Common 9.None			
3.Br/Stone 6.Piers 9.		Econ. % Good 100%			
Basement 0		Economic Code None			
1.1/4 Bmt 4.Full Bmt 7.		0.None 3.No Power 7.			
2.1/2 Bmt 5.None 8.		1.Location 4.Generate 8.			
3.3/4 Bmt 6. 9.None		2.Encroach 9.None 9.			
Bsmt Gar # Cars 0		Entrance Code 0			
Wet Basement 0		1.Interior 4.Vacant 7.			
1.Dry 4. 7.		2.Refusal 5.Estimate 8.			
2.Damp 5. 8.		3.Informed 6.Reviewed 9.			
3.Wet 6. 9.		Information Code 0			
		1.Owner 4.Agent 7.			
		2.Relative 5.Estimate 8.			
		3.Tenant 6.Other 9.			



Date Inspected

Additions, Outbuildings & Improvements								
Type	Year	Units	Grade	Cond	Phys.	Funct.	Sound Value	
					%	%		1.One Story Fram
					%	%		2.Two Story Fram
					%	%		3.Three Story Fr
					%	%		4.1 & 1/2 Story
					%	%		5.1 & 3/4 Story
					%	%		6.2 & 1/2 Story
					%	%		21.Open Frame Por
					%	%		22.Encl Frame Por
					%	%		23.Frame Garage
					%	%		24.Frame Shed
					%	%		25.Frame Bay Wind
					%	%		26.1SFr Overhang
					%	%		27.Unfin Basement
					%	%		28.Unfinished Att
					%	%		29.Finished Attic

HART, RONA M
451 CASTLE HILL ROAD
WASHBURN ME 04786

B2354P86 B5444P254

Inspection Witnessed By:

X

Date

No./Date	Description	Date Insp.

Notes:
*5-7-2019 Dwelling is vacant.

Washburn

Property Data			Assessment Record						
Neighborhood 1 Neighborhood One			Year	Land	Buildings	Exempt	Total		
Tree Growth Year 0			2009	6,800	36,000	0	42,800		
1ST MORTGAGE 0			2012	6,800	36,000	0	42,800		
2ND MORTGAGE 0			2013	8,800	24,400	0	33,200		
Zone/Land Use 1 Residential			2015	8,800	24,400	0	33,200		
Secondary Zone			2018	8,800	24,400	0	33,200		
Topography 1 Level 4 Below Street			2019	16,800	26,300	0	43,100		
1.Level 4.Below St 7.LevelBog			2020	16,800	26,300	0	43,100		
2.Rolling 5.Low 8.			2021	16,800	26,300	0	43,100		
3.Above St 6.Swampy 9.			2022	16,800	27,600	0	44,400		
Utilities 4 Drilled Well 6 Septic System									
1.Public 4.Dr Well 7.Cesspool									
2.Water 5.Dug Well 8.									
3.Sewer 6.Septic 9.None									
Street 1 Paved									
1.Paved 4.Proposed 7.									
2.Semi Imp 5.R/O/W 8.									
3.Gravel 6. 9.None									
TG PLAN YEAR 0									
Tif District # 0									
Sale Data			Land Data						
Sale Date 5/03/1991			Front Foot	Type	Effective		Influence		Influence Codes
Price					Frontage	Depth	Factor	Code	
Sale Type 2 Land & Buildings			11.Regular Lot					1.Unimproved	
1.Land 4.Mobile 7.C/I L&B			12.Delta Triangle			%		2.Excess Frtg	
2.L & B 5.Other 8.			13.Nabla Triangle			%		3.Topography	
3.Building 6.C/I Land 9.			14.Rear Land			%		4.Size/Shape	
Financing 1 Conventional			15.Class I Road			%		5.Access	
1.Convent 4.Seller 7.						%		6.Restriction	
2.FHA/VA 5.Private 8.						%		7.Open Space	
3.Assumed 6.Cash 9.Unknown						%		8.View/Environ	
Validity 1 Arms Length Sale						%		9.Fract Share	
1.Valid 4.Split 7.Renovate			Square Foot	Square Feet				Acres	
2.Related 5.Partial 8.Other			16.Class II Road			%		30.Utility R O W	
3.Distress 6.Exempt 9.			17.Municipal Rese			%		31.Tillable	
Verified 5 Public Record			18.Munic Sep Lago			%		32.Pasture	
1.Buyer 4.Agent 7.Family			19.Gravel Pit			%		33.Orchard	
2.Seller 5.Pub Rec 8.Other			20.Industrial Bas			%		34.Softwood F&O	
3.Lender 6.MLS 9.						%		35.Mixed Wood F&O	
			Fract. Acre	Acres/Sites				36.Hardwood F&O	
			21.Developed Pave	21	1.00	100	% 0	37.Softwood TG	
			22.Undev Paved (F	28	0.50	100	% 0	38.Mixed Wood TG	
			23.Developed Grav				%	39.Hardwood TG	
			Acres				%	40.Wasteland	
			24.Undev Gravel (%	41.Open Space	
			25.Comm Base Pave				%	42.Mobile Home Si	
			26.Comm Base Grav				%	43.Condo Site	
			27.Backlot				%	44.Lot Improvemen	
			28.Rear Land				%	45.Subdivision Lo	
			29.Pavement				%	46.Heavy Ind Sit	
				Total Acreage		1.50			

Washburn

Map Lot 001-046

Account 352

Location 451 CASTLE HILL ROAD

Card 1

Of 1

12/09/2022

Building Style	1 Conventional			SF Bsmt Living	0			Layout	1 Typical		
1.Conv.	5.Garrison	9.Gambrel		Fin Bsmt Grade	0 0			1.Typical	4.	7.	
2.Ranch	6.Salt Box	10.Other		OPEN 5 OPTIONAL	0			2.Inadeq	5.	8.	
3.R Ranch	7.Contemp	11.Split		Heat Type	100% 5 Forced Warm Air			3.Poor	6.	9.	
4.Cape	8.Log	12.		1.HWBB	5.FWA	9.No Heat	Attic	9 None			
Dwelling Units	1			2.HWCI	6.GravWA	10.	1.1/4 Fin	4.Full Fin	7.		
Other Units	0			3.H Pump	7.Electric	11.	2.1/2 Fin	5.FI/Stair	8.		
Stories	4 One & 1/2 Story			4.Steam	8.FI/Wall	12.	3.3/4 Fin	6.	9.None		
1.1	4.1.5	7.		Cool Type	0% 9 None			Insulation	4 Minimal		
2.2	5.1.75	8.		1.Refrig	4.W&C Air	7.	1.Full	4.Minimal	7.		
3.3	6.2.5	9.		2.Evapor	5.	8.	2.Heavy	5.Partial	8.		
Exterior Walls	4 Asbestos Siding			3.H Pump	6.	9.None	3.Capped	6.	9.None		
1.Wood	5.Stucco	9.T-111		Kitchen Style	2 Typical			Unfinished %	40%		
2.Vin/Al	6.Brick	10.Other		1.Modern	4.Obsolete	7.	Grade & Factor	2 Fair 105%			
3.Compos.	7.Stone	11.		2.Typical	5.	8.	1.E Grade	4.B Grade	7.		
4.Asbestos	8.Concrete	12.		3.Old Type	6.	9.None	2.D Grade	5.A Grade	8.SC Grade		
Roof Surface	1 Asphalt Shingles			Bath(s) Style	2 Typical Bath(s)			3.C Grade	6.AA Grade	9.Same	
1.Asphalt	4.Composit	7.		1.Modern	4.Obsolete	7.	SQFT (Footprint)	340			
2.Slate	5.Wood	8.		2.Typical	5.	8.	Condition	3 Below Average			
3.Metal	6.Other	9.		3.Old Type	6.	9.None	1.Poor	4.Avg	7.V G		
SF Masonry Trim	0			# Rooms	5			2.Fair	5.Avg+	8.Exc	
OPEN-3-CUSTOM	0			# Bedrooms	3			3.Avg-	6.Good	9.Same	
OPEN-4-CUSTOM	0			# Full Baths	1			Phys. % Good	0%		
Year Built	1920			# Half Baths	1			Func. % Good	80%		
Year Remodeled	0			# Addn Fixtures	0			Functional Code	4 Delapidation		
Foundation	1 Concrete			# Fireplaces	0			1.Incomp	4.Delap	7.No Power	
1.Concrete	4.Wood	7.									
2.C Block	5.Slab	8.									
3.Br/Stone	6.Piers	9.									
Basement	4 Full Basement										
1.1/4 Bmt	4.Full Bmt	7.									
2.1/2 Bmt	5.None	8.									
3.3/4 Bmt	6.	9.None									
Bsmt Gar # Cars	0										
Wet Basement	3 Wet Basement										
1.Dry	4.	7.									
2.Damp	5.	8.									
3.Wet	6.	9.									
Economic Code	None			0.None	3.No Power	7.	1.Location	4.Generate	8.		
Entrance Code	5 Estimated			1.Encroach	9.None	9.	2.Informed	6.Reviewed	9.		
1.Interior	4.Vacant	7.		Information Code	5 Estimate			1.Owner	4.Agent	7.	
2.Refusal	5.Estimate	8.		2.Relative	5.Estimate	8.	2.Tenant	6.Other	9.		
3.Informed	6.Reviewed	9.									

10.0'
Shed
10.0'
(100)
S/V \$50

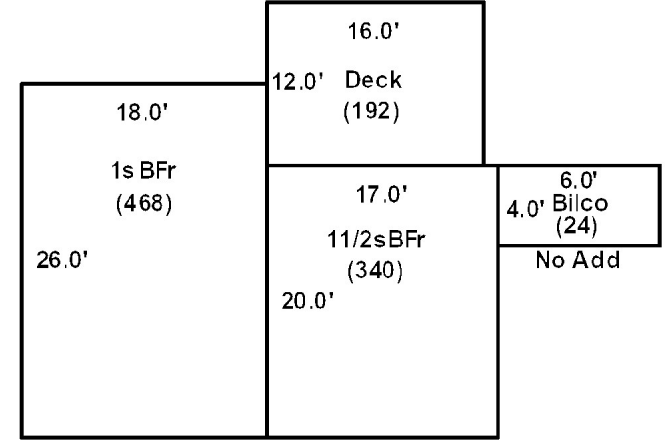

Date Inspected 7/29/2018

Additions, Outbuildings & Improvements

Type	Year	Units	Grade	Cond	Phys.	Funct.	Sound Value
20 1 Story/Bsmt	0	468	0 0	0	0 %	0 %	
68 Wood Deck	2000	192	3 100	2	0 %	100 %	
24 Frame Shed	0				%	%	50
					%	%	
					%	%	
					%	%	
					%	%	
					%	%	
					%	%	
					%	%	
					%	%	



- 1.One Story Fram
- 2.Two Story Fram
- 3.Three Story Fr
- 4.1 & 1/2 Story
- 5.1 & 3/4 Story
- 6.2 & 1/2 Story
- 21.Open Frame Por
- 22.Encl Frame Por
- 23.Frame Garage
- 24.Frame Shed
- 25.Frame Bay Wind
- 26.1SFr Overhang
- 27.Unfin Basement
- 28.Unfinished Att
- 29.Finished Attic

HKS PARTNERSHIP
76 TURNPIKE ROAD
WILLINGTON CT 06279

B3797P55

Inspection Witnessed By:

X

Date

No./Date	Description	Date Insp.

Notes:

Washburn

Property Data			Assessment Record																																																																																																																																																																																																					
Neighborhood 1 Neighborhood One			Year	Land	Buildings	Exempt	Total																																																																																																																																																																																																	
Tree Growth Year 0			2009	33,600	0	0	33,600																																																																																																																																																																																																	
1ST MORTGAGE 0			2012	33,600	0	0	33,600																																																																																																																																																																																																	
2ND MORTGAGE 0			2013	43,700	0	0	43,700																																																																																																																																																																																																	
Zone/Land Use 1 Residential			2015	43,700	0	0	43,700																																																																																																																																																																																																	
Secondary Zone			2018	43,700	0	0	43,700																																																																																																																																																																																																	
Topography 2 Rolling			2019	79,500	0	0	79,500																																																																																																																																																																																																	
1.Level 4.Below St 7.LevelBog			2020	79,500	0	0	79,500																																																																																																																																																																																																	
2.Rolling 5.Low 8.			2021	79,500	0	0	79,500																																																																																																																																																																																																	
3.Above St 6.Swampy 9.			2022	79,500	0	0	79,500																																																																																																																																																																																																	
Utilities																																																																																																																																																																																																								
1.Public 4.Dr Well 7.Cesspool																																																																																																																																																																																																								
2.Water 5.Dug Well 8.																																																																																																																																																																																																								
3.Sewer 6.Septic 9.None																																																																																																																																																																																																								
Street 1 Paved																																																																																																																																																																																																								
1.Paved 4.Proposed 7.																																																																																																																																																																																																								
2.Semi Imp 5.R/O/W 8.																																																																																																																																																																																																								
3.Gravel 6. 9.None																																																																																																																																																																																																								
TG PLAN YEAR 0			<table border="1"> <thead> <tr> <th rowspan="2">Front Foot</th> <th rowspan="2">Type</th> <th colspan="2">Effective</th> <th colspan="2">Influence</th> <th rowspan="2">Influence Codes</th> </tr> <tr> <th>Frontage</th> <th>Depth</th> <th>Factor</th> <th>Code</th> </tr> </thead> <tbody> <tr><td>11.Regular Lot</td><td> </td><td> </td><td> </td><td> </td><td>%</td><td>1.Unimproved</td></tr> <tr><td>12.Delta Triangle</td><td> </td><td> </td><td> </td><td> </td><td>%</td><td>2.Excess Frtg</td></tr> <tr><td>13.Nabla Triangle</td><td> </td><td> </td><td> </td><td> </td><td>%</td><td>3.Topography</td></tr> <tr><td>14.Rear Land</td><td> </td><td> </td><td> </td><td> </td><td>%</td><td>4.Size/Shape</td></tr> <tr><td>15.Class I Road</td><td> </td><td> </td><td> </td><td> </td><td>%</td><td>5.Access</td></tr> <tr><td> </td><td> </td><td> </td><td> </td><td> </td><td>%</td><td>6.Restriction</td></tr> <tr><td> </td><td> </td><td> </td><td> </td><td> </td><td>%</td><td>7.Open Space</td></tr> <tr><td> </td><td> </td><td> </td><td> </td><td> </td><td>%</td><td>8.View/Environ</td></tr> <tr><td> </td><td> </td><td> </td><td> </td><td> </td><td>%</td><td>9.Fract Share</td></tr> <tr><td> </td><td> </td><td> </td><td> </td><td> </td><td>%</td><td>30.Utility R O W</td></tr> <tr><td> </td><td> </td><td> </td><td> </td><td> </td><td>%</td><td>31.Tillable</td></tr> <tr><td> </td><td> </td><td> </td><td> </td><td> </td><td>%</td><td>32.Pasture</td></tr> <tr><td> </td><td> </td><td> </td><td> </td><td> </td><td>%</td><td>33.Orchard</td></tr> <tr><td> </td><td> </td><td> </td><td> </td><td> </td><td>%</td><td>34.Softwood F&O</td></tr> <tr><td> </td><td> </td><td> </td><td> </td><td> </td><td>%</td><td>35.Mixed Wood F&O</td></tr> <tr><td> </td><td> </td><td> </td><td> </td><td> </td><td>%</td><td>36.Hardwood F&O</td></tr> <tr><td> </td><td> </td><td> </td><td> </td><td> </td><td>%</td><td>37.Softwood TG</td></tr> <tr><td> </td><td> </td><td> </td><td> </td><td> </td><td>%</td><td>38.Mixed Wood TG</td></tr> <tr><td> </td><td> </td><td> </td><td> </td><td> </td><td>%</td><td>39.Hardwood TG</td></tr> <tr><td> </td><td> </td><td> </td><td> </td><td> </td><td>%</td><td>40.Wasteland</td></tr> <tr><td> </td><td> </td><td> </td><td> </td><td> </td><td>%</td><td>41.Open Space</td></tr> <tr><td> </td><td> </td><td> </td><td> </td><td> </td><td>%</td><td>42.Mobile Home Si</td></tr> <tr><td> </td><td> </td><td> </td><td> </td><td> </td><td>%</td><td>43.Condo Site</td></tr> <tr><td> </td><td> </td><td> </td><td> </td><td> </td><td>%</td><td>44.Lot Improvemen</td></tr> <tr><td> </td><td> </td><td> </td><td> </td><td> </td><td>%</td><td>45.Subdivision Lo</td></tr> <tr><td> </td><td> </td><td> </td><td> </td><td> </td><td>%</td><td>46.Heavy Ind Sit</td></tr> </tbody> </table>					Front Foot	Type	Effective		Influence		Influence Codes	Frontage	Depth	Factor	Code	11.Regular Lot					%	1.Unimproved	12.Delta Triangle					%	2.Excess Frtg	13.Nabla Triangle					%	3.Topography	14.Rear Land					%	4.Size/Shape	15.Class I Road					%	5.Access						%	6.Restriction						%	7.Open Space						%	8.View/Environ						%	9.Fract Share						%	30.Utility R O W						%	31.Tillable						%	32.Pasture						%	33.Orchard						%	34.Softwood F&O						%	35.Mixed Wood F&O						%	36.Hardwood F&O						%	37.Softwood TG						%	38.Mixed Wood TG						%	39.Hardwood TG						%	40.Wasteland						%	41.Open Space						%	42.Mobile Home Si						%	43.Condo Site						%	44.Lot Improvemen						%	45.Subdivision Lo						%	46.Heavy Ind Sit
Front Foot	Type	Effective								Influence		Influence Codes																																																																																																																																																																																												
		Frontage	Depth	Factor	Code																																																																																																																																																																																																			
11.Regular Lot					%	1.Unimproved																																																																																																																																																																																																		
12.Delta Triangle					%	2.Excess Frtg																																																																																																																																																																																																		
13.Nabla Triangle					%	3.Topography																																																																																																																																																																																																		
14.Rear Land					%	4.Size/Shape																																																																																																																																																																																																		
15.Class I Road					%	5.Access																																																																																																																																																																																																		
					%	6.Restriction																																																																																																																																																																																																		
					%	7.Open Space																																																																																																																																																																																																		
					%	8.View/Environ																																																																																																																																																																																																		
					%	9.Fract Share																																																																																																																																																																																																		
					%	30.Utility R O W																																																																																																																																																																																																		
					%	31.Tillable																																																																																																																																																																																																		
					%	32.Pasture																																																																																																																																																																																																		
					%	33.Orchard																																																																																																																																																																																																		
					%	34.Softwood F&O																																																																																																																																																																																																		
					%	35.Mixed Wood F&O																																																																																																																																																																																																		
					%	36.Hardwood F&O																																																																																																																																																																																																		
					%	37.Softwood TG																																																																																																																																																																																																		
					%	38.Mixed Wood TG																																																																																																																																																																																																		
					%	39.Hardwood TG																																																																																																																																																																																																		
					%	40.Wasteland																																																																																																																																																																																																		
					%	41.Open Space																																																																																																																																																																																																		
					%	42.Mobile Home Si																																																																																																																																																																																																		
					%	43.Condo Site																																																																																																																																																																																																		
					%	44.Lot Improvemen																																																																																																																																																																																																		
					%	45.Subdivision Lo																																																																																																																																																																																																		
					%	46.Heavy Ind Sit																																																																																																																																																																																																		
Tif District # 0			Land Data																																																																																																																																																																																																					
Sale Data			<table border="1"> <thead> <tr> <th rowspan="2">Front Foot</th> <th rowspan="2">Type</th> <th colspan="2">Effective</th> <th colspan="2">Influence</th> <th rowspan="2">Influence Codes</th> </tr> <tr> <th>Frontage</th> <th>Depth</th> <th>Factor</th> <th>Code</th> </tr> </thead> <tbody> <tr><td>11.Regular Lot</td><td> </td><td> </td><td> </td><td> </td><td>%</td><td>1.Unimproved</td></tr> <tr><td>12.Delta Triangle</td><td> </td><td> </td><td> </td><td> </td><td>%</td><td>2.Excess Frtg</td></tr> <tr><td>13.Nabla Triangle</td><td> </td><td> </td><td> </td><td> </td><td>%</td><td>3.Topography</td></tr> <tr><td>14.Rear Land</td><td> </td><td> </td><td> </td><td> </td><td>%</td><td>4.Size/Shape</td></tr> <tr><td>15.Class I Road</td><td> </td><td> </td><td> </td><td> </td><td>%</td><td>5.Access</td></tr> <tr><td> </td><td> </td><td> </td><td> </td><td> </td><td>%</td><td>6.Restriction</td></tr> <tr><td> </td><td> </td><td> </td><td> </td><td> </td><td>%</td><td>7.Open Space</td></tr> <tr><td> </td><td> </td><td> </td><td> </td><td> </td><td>%</td><td>8.View/Environ</td></tr> <tr><td> </td><td> </td><td> </td><td> </td><td> </td><td>%</td><td>9.Fract Share</td></tr> <tr><td> </td><td> </td><td> </td><td> </td><td> </td><td>%</td><td>30.Utility R O W</td></tr> <tr><td> </td><td> </td><td> </td><td> </td><td> </td><td>%</td><td>31.Tillable</td></tr> <tr><td> </td><td> </td><td> </td><td> </td><td> </td><td>%</td><td>32.Pasture</td></tr> <tr><td> </td><td> </td><td> </td><td> </td><td> </td><td>%</td><td>33.Orchard</td></tr> <tr><td> </td><td> </td><td> </td><td> </td><td> </td><td>%</td><td>34.Softwood F&O</td></tr> <tr><td> </td><td> </td><td> </td><td> </td><td> </td><td>%</td><td>35.Mixed Wood F&O</td></tr> <tr><td> </td><td> </td><td> </td><td> </td><td> </td><td>%</td><td>36.Hardwood F&O</td></tr> <tr><td> </td><td> </td><td> </td><td> </td><td> </td><td>%</td><td>37.Softwood TG</td></tr> <tr><td> </td><td> </td><td> </td><td> </td><td> </td><td>%</td><td>38.Mixed Wood TG</td></tr> <tr><td> </td><td> </td><td> </td><td> </td><td> </td><td>%</td><td>39.Hardwood TG</td></tr> <tr><td> </td><td> </td><td> </td><td> </td><td> </td><td>%</td><td>40.Wasteland</td></tr> <tr><td> </td><td> </td><td> </td><td> </td><td> </td><td>%</td><td>41.Open Space</td></tr> <tr><td> </td><td> </td><td> </td><td> </td><td> </td><td>%</td><td>42.Mobile Home Si</td></tr> <tr><td> </td><td> </td><td> </td><td> </td><td> </td><td>%</td><td>43.Condo Site</td></tr> <tr><td> </td><td> </td><td> </td><td> </td><td> </td><td>%</td><td>44.Lot Improvemen</td></tr> <tr><td> </td><td> </td><td> </td><td> </td><td> </td><td>%</td><td>45.Subdivision Lo</td></tr> <tr><td> </td><td> </td><td> </td><td> </td><td> </td><td>%</td><td>46.Heavy Ind Sit</td></tr> </tbody> </table>					Front Foot	Type	Effective		Influence		Influence Codes	Frontage	Depth	Factor	Code	11.Regular Lot					%	1.Unimproved	12.Delta Triangle					%	2.Excess Frtg	13.Nabla Triangle					%	3.Topography	14.Rear Land					%	4.Size/Shape	15.Class I Road					%	5.Access						%	6.Restriction						%	7.Open Space						%	8.View/Environ						%	9.Fract Share						%	30.Utility R O W						%	31.Tillable						%	32.Pasture						%	33.Orchard						%	34.Softwood F&O						%	35.Mixed Wood F&O						%	36.Hardwood F&O						%	37.Softwood TG						%	38.Mixed Wood TG						%	39.Hardwood TG						%	40.Wasteland						%	41.Open Space						%	42.Mobile Home Si						%	43.Condo Site						%	44.Lot Improvemen						%	45.Subdivision Lo						%	46.Heavy Ind Sit
Front Foot	Type	Effective		Influence		Influence Codes																																																																																																																																																																																																		
		Frontage	Depth	Factor	Code																																																																																																																																																																																																			
11.Regular Lot					%	1.Unimproved																																																																																																																																																																																																		
12.Delta Triangle					%	2.Excess Frtg																																																																																																																																																																																																		
13.Nabla Triangle					%	3.Topography																																																																																																																																																																																																		
14.Rear Land					%	4.Size/Shape																																																																																																																																																																																																		
15.Class I Road					%	5.Access																																																																																																																																																																																																		
					%	6.Restriction																																																																																																																																																																																																		
					%	7.Open Space																																																																																																																																																																																																		
					%	8.View/Environ																																																																																																																																																																																																		
					%	9.Fract Share																																																																																																																																																																																																		
					%	30.Utility R O W																																																																																																																																																																																																		
					%	31.Tillable																																																																																																																																																																																																		
					%	32.Pasture																																																																																																																																																																																																		
					%	33.Orchard																																																																																																																																																																																																		
					%	34.Softwood F&O																																																																																																																																																																																																		
					%	35.Mixed Wood F&O																																																																																																																																																																																																		
					%	36.Hardwood F&O																																																																																																																																																																																																		
					%	37.Softwood TG																																																																																																																																																																																																		
					%	38.Mixed Wood TG																																																																																																																																																																																																		
					%	39.Hardwood TG																																																																																																																																																																																																		
					%	40.Wasteland																																																																																																																																																																																																		
					%	41.Open Space																																																																																																																																																																																																		
					%	42.Mobile Home Si																																																																																																																																																																																																		
					%	43.Condo Site																																																																																																																																																																																																		
					%	44.Lot Improvemen																																																																																																																																																																																																		
					%	45.Subdivision Lo																																																																																																																																																																																																		
					%	46.Heavy Ind Sit																																																																																																																																																																																																		
Sale Date 4/28/2003			Front Foot																																																																																																																																																																																																					
Price			Square Foot																																																																																																																																																																																																					
Sale Type 1 Land Only			Fract. Acre																																																																																																																																																																																																					
1.Land 4.Mobile 7.C/I L&B			21.Developed Pave																																																																																																																																																																																																					
2.L & B 5.Other 8.			22.Undev Paved (F																																																																																																																																																																																																					
3.Building 6.C/I Land 9.			23.Developed Grav																																																																																																																																																																																																					
Financing 1 Conventional			Acres																																																																																																																																																																																																					
1.Convent 4.Seller 7.			24.Undev Gravel (
2.FHA/VA 5.Private 8.			25.Comm Base Pave																																																																																																																																																																																																					
3.Assumed 6.Cash 9.Unknown			26.Comm Base Grav																																																																																																																																																																																																					
Validity 1 Arms Length Sale			27.Backlot																																																																																																																																																																																																					
1.Valid 4.Split 7.Renovate			28.Rear Land																																																																																																																																																																																																					
2.Related 5.Partial 8.Other			29.Pavement																																																																																																																																																																																																					
3.Distress 6.Exempt 9.			Total Acreage 123.00																																																																																																																																																																																																					
Verified 5 Public Record																																																																																																																																																																																																								
1.Buyer 4.Agent 7.Family																																																																																																																																																																																																								
2.Seller 5.Pub Rec 8.Other																																																																																																																																																																																																								
3.Lender 6.MLS 9.																																																																																																																																																																																																								

Washburn

Map Lot 001-047

Account 502

Location CASTLE HILL ROAD

Card 1 Of 1 12/09/2022

Building Style 0	SF Bsmt Living 0	Layout 0
1.Conv. 5.Garrison 9.Gambrel	Fin Bsmt Grade 0 0	1.Typical 4. 7.
2.Ranch 6.Salt Box 10.Other	OPEN 5 OPTIONAL 0	2.Inadeq 5. 8.
3.R Ranch 7.Contemp 11.Split	Heat Type 100% 0	3.Poor 6. 9.
4.Cape 8.Log 12.	1.HWBB 5.FWA 9.No Heat	Attic 0
Dwelling Units 0	2.HWCI 6.GravWA 10.	1.1/4 Fin 4.Full Fin 7.
Other Units 0	3.H Pump 7.Electric 11.	2.1/2 Fin 5.FI/Stair 8.
Stories 0	4.Steam 8.FI/Wall 12.	3.3/4 Fin 6. 9.None
1.1 4.1.5 7.	Cool Type 0% 9 None	Insulation 0
2.2 5.1.75 8.	1.Refrig 4.W&C Air 7.	1.Full 4.Minimal 7.
3.3 6.2.5 9.	2.Evapor 5. 8.	2.Heavy 5.Partial 8.
Exterior Walls 0	3.H Pump 6. 9.None	3.Capped 6. 9.None
1.Wood 5.Stucco 9.T-111	Kitchen Style 0	Unfinished % 0%
2.Vin/Al 6.Brick 10.Other	1.Modern 4.Obsolete 7.	Grade & Factor 0 0%
3.Compos. 7.Stone 11.	2.Typical 5. 8.	1.E Grade 4.B Grade 7.
4.Asbestos 8.Concrete 12.	3.Old Type 6. 9.None	2.D Grade 5.A Grade 8.SC Grade
Roof Surface 0	Bath(s) Style 0	3.C Grade 6.AA Grade 9.Same
1.Asphalt 4.Composit 7.	1.Modern 4.Obsolete 7.	SQFT (Footprint) 0
2.Slate 5.Wood 8.	2.Typical 5. 8.	Condition 0
3.Metal 6.Other 9.	3.Old Type 6. 9.None	1.Poor 4.Avg 7.V G
SF Masonry Trim 0	# Rooms 0	2.Fair 5.Avg+ 8.Exc
OPEN-3-CUSTOM 0	# Bedrooms 0	3.Avg- 6.Good 9.Same
OPEN-4-CUSTOM 0	# Full Baths 0	Phys. % Good 0%
Year Built 0	# Half Baths 0	Funct. % Good 100%
Year Remodeled 0	# Addn Fixtures 0	Functional Code 9 None
Foundation 0	# Fireplaces 0	1.Incomp 4.Delap 7.No Power
1.Concrete 4.Wood 7.		2.O-Built 5.Bsmt 8.LongTerm
2.C Block 5.Slab 8.		3.Damage 6.Common 9.None
3.Br/Stone 6.Piers 9.		Econ. % Good 100%
Basement 0		Economic Code None
1.1/4 Bmt 4.Full Bmt 7.		0.None 3.No Power 7.
2.1/2 Bmt 5.None 8.		1.Location 4.Generate 8.
3.3/4 Bmt 6. 9.None		2.Encroach 9.None 9.
Bsmt Gar # Cars 0		Entrance Code 0
Wet Basement 0		1.Interior 4.Vacant 7.
1.Dry 4. 7.		2.Refusal 5.Estimate 8.
2.Damp 5. 8.	3.Informed 6.Reviewed 9.	
3.Wet 6. 9.	Information Code 0	
		1.Owner 4.Agent 7.
		2.Relative 5.Estimate 8.
		3.Tenant 6.Other 9.

Date Inspected

Additions, Outbuildings & Improvements								
Type	Year	Units	Grade	Cond	Phys.	Funct.	Sound Value	
					%	%		1.One Story Fram
					%	%		2.Two Story Fram
					%	%		3.Three Story Fr
					%	%		4.1 & 1/2 Story
					%	%		5.1 & 3/4 Story
					%	%		6.2 & 1/2 Story
					%	%		21.Open Frame Por
					%	%		22.Encl Frame Por
					%	%		23.Frame Garage
					%	%		24.Frame Shed
					%	%		25.Frame Bay Wind
					%	%		26.1SFr Overhang
					%	%		27.Unfin Basement
					%	%		28.Unfinished Att
					%	%		29.Finished Attic

PORTER FARMS, LLC
601 GRIFFIN RIDGE ROAD
MAPLETON ME 04757

B5567P210

Previous Owner
IRVING & MARR FARMS
221 DAVIS STREET

WOODLAND ME 04736
Sale Date: 7/27/2016

Inspection Witnessed By:

No./Date	Description	Date Insp.
X		

Notes:

Washburn

Property Data			Assessment Record						
Neighborhood 1 Neighborhood One			Year	Land	Buildings	Exempt	Total		
Tree Growth Year 0			2009	2,800	0	0	2,800		
1ST MORTGAGE 0			2012	2,800	0	0	2,800		
2ND MORTGAGE 0			2013	3,600	0	0	3,600		
Zone/Land Use 1 Residential			2015	3,600	0	0	3,600		
Secondary Zone			2018	3,600	0	0	3,600		
Topography 2 Rolling			2019	14,000	0	0	14,000		
1.Level 4.Below St 7.LevelBog			2020	14,000	0	0	14,000		
2.Rolling 5.Low 8.			2021	14,000	0	0	14,000		
3.Above St 6.Swampy 9.			2022	14,000	0	0	14,000		
Utilities									
1.Public 4.Dr Well 7.Cesspool									
2.Water 5.Dug Well 8.									
3.Sewer 6.Septic 9.None									
Street 1 Paved									
1.Paved 4.Proposed 7.									
2.Semi Imp 5.R/O/W 8.									
3.Gravel 6. 9.None									
TG PLAN YEAR 0									
Tif District # 0									
Sale Data			Land Data						
Sale Date 7/27/2016			Front Foot	Type	Effective		Influence		Influence Codes
Price					Frontage	Depth	Factor	Code	
Sale Type 1 Land Only			11.Regular Lot					1.Unimproved	
1.Land 4.Mobile 7.C/I L&B			12.Delta Triangle			%		2.Excess Frtg	
2.L & B 5.Other 8.			13.Nabla Triangle			%		3.Topography	
3.Building 6.C/I Land 9.			14.Rear Land			%		4.Size/Shape	
Financing 4 Seller Financed			15.Class I Road			%		5.Access	
1.Convent 4.Seller 7.						%		6.Restriction	
2.FHA/VA 5.Private 8.						%		7.Open Space	
3.Assumed 6.Cash 9.Unknown						%		8.View/Environ	
Validity 1 Arms Length Sale						%		9.Fract Share	
1.Valid 4.Split 7.Renovate			Square Foot	Square Feet				Acres	
2.Related 5.Partial 8.Other			16.Class II Road			%		30.Utility R O W	
3.Distress 6.Exempt 9.			17.Municipal Rese			%		31.Tillable	
Verified 5 Public Record			18.Munic Sep Lago			%		32.Pasture	
1.Buyer 4.Agent 7.Family			19.Gravel Pit			%		33.Orchard	
2.Seller 5.Pub Rec 8.Other			20.Industrial Bas			%		34.Softwood F&O	
3.Lender 6.MLS 9.						%		35.Mixed Wood F&O	
			Fract. Acre	Acres/Sites				36.Hardwood F&O	
			21.Developed Pave	22	1.00	100	%	0	
			22.Undev Paved (F	28	10.00	100	%	0	
			23.Developed Grav				%		
			Acres				%		
			24.Undev Gravel (%		
			25.Comm Base Pave				%		
			26.Comm Base Grav				%		
			27.Backlot				%		
			28.Rear Land				%		
			29.Pavement				%		
			Total Acreage		11.00				
								44.Lot Improvemen	
								45.Subdivision Lo	
								46.Heavy Ind Sit	

Washburn

Map Lot 001-048

Account 584

Location CASTLE HILL ROAD

Card 1 Of 1 12/09/2022

Building Style 0	SF Bsmt Living 0	Layout 0
1.Conv. 5.Garrison 9.Gambrel	Fin Bsmt Grade 0 0	1.Typical 4. 7.
2.Ranch 6.Salt Box 10.Other	OPEN 5 OPTIONAL 0	2.Inadeq 5. 8.
3.R Ranch 7.Contemp 11.Split	Heat Type 100% 0	3.Poor 6. 9.
4.Cape 8.Log 12.	1.HWBB 5.FWA 9.No Heat	Attic 0
Dwelling Units 0	2.HWCI 6.GravWA 10.	1.1/4 Fin 4.Full Fin 7.
Other Units 0	3.H Pump 7.Electric 11.	2.1/2 Fin 5.F/Stair 8.
Stories 0	4.Steam 8.F/Wall 12.	3.3/4 Fin 6. 9.None
1.1 4.1.5 7.	Cool Type 0% 9 None	Insulation 0
2.2 5.1.75 8.	1.Refrig 4.W&C Air 7.	1.Full 4.Minimal 7.
3.3 6.2.5 9.	2.Evapor 5. 8.	2.Heavy 5.Partial 8.
Exterior Walls 0	3.H Pump 6. 9.None	3.Capped 6. 9.None
1.Wood 5.Stucco 9.T-111	Kitchen Style 0	Unfinished % 0%
2.Vin/Al 6.Brick 10.Other	1.Modern 4.Obsolete 7.	Grade & Factor 0 0%
3.Compos. 7.Stone 11.	2.Typical 5. 8.	1.E Grade 4.B Grade 7.
4.Asbestos 8.Concrete 12.	3.Old Type 6. 9.None	2.D Grade 5.A Grade 8.SC Grade
Roof Surface 0	Bath(s) Style 0	3.C Grade 6.AA Grade 9.Same
1.Asphalt 4.Composit 7.	1.Modern 4.Obsolete 7.	SQFT (Footprint) 0
2.Slate 5.Wood 8.	2.Typical 5. 8.	Condition 0
3.Metal 6.Other 9.	3.Old Type 6. 9.None	1.Poor 4.Avg 7.V G
SF Masonry Trim 0	# Rooms 0	2.Fair 5.Avg+ 8.Exc
OPEN-3-CUSTOM 0	# Bedrooms 0	3.Avg- 6.Good 9.Same
OPEN-4-CUSTOM 0	# Full Baths 0	Phys. % Good 0%
Year Built 0	# Half Baths 0	Funct. % Good 100%
Year Remodeled 0	# Addn Fixtures 0	Functional Code 9 None
Foundation 0	# Fireplaces 0	1.Incomp 4.Delap 7.No Power
1.Concrete 4.Wood 7.		2.O-Built 5.Bsmt 8.LongTerm
2.C Block 5.Slab 8.		3.Damage 6.Common 9.None
3.Br/Stone 6.Piers 9.		Econ. % Good 100%
Basement 0		Economic Code None
1.1/4 Bmt 4.Full Bmt 7.		0.None 3.No Power 7.
2.1/2 Bmt 5.None 8.		1.Location 4.Generate 8.
3.3/4 Bmt 6. 9.None		2.Encroach 9.None 9.
Bsmt Gar # Cars 0		Entrance Code 0
Wet Basement 0		1.Interior 4.Vacant 7.
1.Dry 4. 7.		2.Refusal 5.Estimate 8.
2.Damp 5. 8.	3.Informed 6.Reviewed 9.	
3.Wet 6. 9.	Information Code 0	
	1.Owner 4.Agent 7.	
	2.Relative 5.Estimate 8.	
	3.Tenant 6.Other 9.	

Date Inspected

Additions, Outbuildings & Improvements

Type	Year	Units	Grade	Cond	Phys.	Funct.	Sound Value
					%	%	1.One Story Fram
					%	%	2.Two Story Fram
					%	%	3.Three Story Fr
					%	%	4.1 & 1/2 Story
					%	%	5.1 & 3/4 Story
					%	%	6.2 & 1/2 Story
					%	%	21.Open Frame Por
					%	%	22.Encl Frame Por
					%	%	23.Frame Garage
					%	%	24.Frame Shed
					%	%	25.Frame Bay Wind
					%	%	26.1SFr Overhang
					%	%	27.Unfin Basement
					%	%	28.Unfinished Att
					%	%	29.Finished Attic

LANGLEY, DAVID
 P.O. BOX 1972
 PRESQUE ISLE ME 04769

B4069P225 B4968P69 B5509P237

Inspection Witnessed By:

No./Date	Description	Date Insp.
X		

Notes:
 *-50% for approx. 1/2 of downstairs garage + approx. 1/3 upstairs cathedral. -20% for attached garages, 2 each.

Washburn

Property Data			Assessment Record						
Neighborhood 1 Neighborhood One			Year	Land	Buildings	Exempt	Total		
Tree Growth Year 0			2009	3,900	53,400	9,000	48,300		
1ST MORTGAGE 0			2012	4,600	59,300	8,800	55,100		
2ND MORTGAGE 0			2013	6,000	59,300	8,800	56,500		
Zone/Land Use 1 Residential			2015	6,000	59,300	9,000	56,300		
Secondary Zone			2018	6,000	59,300	18,400	46,900		
Topography 1 Level			2019	14,700	81,200	20,000	75,900		
1.Level 4.Below St 7.LevelBog			2020	14,700	80,300	25,000	70,000		
2.Rolling 5.Low 8.			2021	14,700	81,200	25,000	70,900		
3.Above St 6.Swampy 9.			2022	14,700	90,700	25,000	80,400		
Utilities 4 Drilled Well 6 Septic System									
1.Public 4.Dr Well 7.Cesspool									
2.Water 5.Dug Well 8.									
3.Sewer 6.Septic 9.None									
Street 1 Paved									
1.Paved 4.Proposed 7.									
2.Semi Imp 5.R/O/W 8.									
3.Gravel 6. 9.None									
TG PLAN YEAR 0									
Tif District # 0									
Sale Data									
Sale Date 12/28/2004									
Price 2,400									
Sale Type 2 Land & Buildings									
1.Land 4.Mobile 7.C/I L&B									
2.L & B 5.Other 8.									
3.Building 6.C/I Land 9.									
Financing 1 Conventional									
1.Convent 4.Seller 7.									
2.FHA/VA 5.Private 8.									
3.Assumed 6.Cash 9.Unknown									
Validity 1 Arms Length Sale									
1.Valid 4.Split 7.Renovate									
2.Related 5.Partial 8.Other									
3.Distress 6.Exempt 9.									
Verified 5 Public Record									
1.Buyer 4.Agent 7.Family									
2.Seller 5.Pub Rec 8.Other									
3.Lender 6.MLS 9.									
			Land Data						
			Front Foot	Type	Effective		Influence		Influence Codes
					Frontage	Depth	Factor	Code	
			11.Regular Lot				%		1.Unimproved
			12.Delta Triangle				%		2.Excess Frtg
			13.Nabla Triangle				%		3.Topography
			14.Rear Land				%		4.Size/Shape
			15.Class I Road				%		5.Access
							%		6.Restriction
							%		7.Open Space
							%		8.View/Environ
			Square Foot	Square Feet					9.Fract Share
			16.Class II Road	29	1,600		75 %	0	Acres
			17.Municipal Rese				%		30.Utility R O W
			18.Munic Sep Lago				%		31.Tillable
			19.Gravel Pit				%		32.Pasture
			20.Industrial Bas				%		33.Orchard
							%		34.Softwood F&O
			Fract. Acre	Acreage/Sites					35.Mixed Wood F&O
			21.Developed Pave	21	0.50		100 %	0	36.Hardwood F&O
			22.Undev Paved (F				%		37.Softwood TG
			23.Developed Grav				%		38.Mixed Wood TG
							%		39.Hardwood TG
							%		40.Wasteland
			24.Undev Gravel (%		41.Open Space
			25.Comm Base Pave				%		42.Mobile Home Si
			26.Comm Base Grav				%		43.Condo Site
			27.Backlot				%		44.Lot Improvemen
			28.Rear Land				%		45.Subdivision Lo
			29.Pavement				%		46.Heavy Ind Sit
			Total Acreage 0.50						

Washburn

Map Lot 001-049

Account 678

Location 323 CASTLE HILL ROAD

Card 1 Of 1 12/09/2022

Building Style 4 Cape Cod	SF Bsmt Living 0	Layout 1 Typical
1.Conv. 5.Garrison 9.Gambrel	Fin Bsmt Grade 0 0	1.Typical 4. 7.
2.Ranch 6.Salt Box 10.Other	OPEN 5 OPTIONAL 0	2.Inadeq 5. 8.
3.R Ranch 7.Contemp 11.Split	Heat Type 100% 1 Hot Water BB	3.Pool 6. 9.
4.Cape 8.Log 12.	1.HWBB 5.FWA 9.No Heat	Attic 9 None
Dwelling Units 1	2.HWCI 6.GravWA 10.	1.1/4 Fin 4.Full Fin 7.
Other Units 0	3.H Pump 7.Electric 11.	2.1/2 Fin 5.FI/Stair 8.
Stories 4 One & 1/2 Story	4.Steam 8.FI/Wall 12.	3.3/4 Fin 6. 9.None
1.1 4.1.5 7.	Cool Type 0% 9 None	Insulation 1 Full
2.2 5.1.75 8.	1.Refrig 4.W&C Air 7.	1.Full 4.Minimal 7.
3.3 6.2.5 9.	2.Evapor 5. 8.	2.Heavy 5.Partial 8.
Exterior Walls 1 Wood Siding	3.H Pump 6. 9.None	3.Capped 6. 9.None
1.Wood 5.Stucco 9.T-111	Kitchen Style 2 Typical	Unfinished % 50%
2.Vin/Al 6.Brick 10.Other	1.Modern 4.Obsolete 7.	Grade & Factor 3 Average 100%
3.Compos. 7.Stone 11.	2.Typical 5. 8.	1.E Grade 4.B Grade 7.
4.Asbestos 8.Concrete 12.	3.Old Type 6. 9.None	2.D Grade 5.A Grade 8.SC Grade
Roof Surface 1 Asphalt Shingles	Bath(s) Style 2 Typical Bath(s)	3.C Grade 6.AA Grade 9.Same
1.Asphalt 4.Composit 7.	1.Modern 4.Obsolete 7.	SQFT (Footprint) 1584
2.Slate 5.Wood 8.	2.Typical 5. 8.	Condition 4 Average
3.Metal 6.Other 9.	3.Old Type 6. 9.None	1.Poor 4.Avg 7.V G
SF Masonry Trim 0	# Rooms 3	2.Fair 5.Avg+ 8.Exc
OPEN-3-CUSTOM 0	# Bedrooms 2	3.Avg- 6.Good 9.Same
OPEN-4-CUSTOM 0	# Full Baths 1	Phys. % Good 0%
Year Built 2007	# Half Baths 1	Funct. % Good 100%
Year Remodeled 0	# Addn Fixtures 0	Functional Code 9 None
Foundation 5 Concrete Slab	# Fireplaces 0	1.Incomp 4.Delap 7.No Power
1.Concrete 4.Wood 7.	 <p>TRIO Software A Division of Harris Computer Systems</p>	2.O-Built 5.Bsmt 8.LongTerm
2.C Block 5.Slab 8.		3.Damage 6.Common 9.None
3.Br/Stone 6.Piers 9.		Econ. % Good 100%
Basement 9 No Basement		Economic Code None
1.1/4 Bmt 4.Full Bmt 7.		0.None 3.No Power 7.
2.1/2 Bmt 5.None 8.		1.Location 4.Generate 8.
3.3/4 Bmt 6. 9.None		2.Encroach 9.None 9.
Bsmt Gar # Cars 0		Entrance Code 1 Interior Inspect
Wet Basement 9 No Basement		1.Interior 4.Vacant 7.
1.Dry 4. 7.		2.Refusal 5.Estimate 8.
2.Damp 5. 8.	3.Informed 6.Reviewed 9.	
3.Wet 6. 9.	Information Code 2 Relative	
		1.Owner 4.Agent 7.
		2.Relative 5.Estimate 8.
		3.Tenant 6.Other 9.

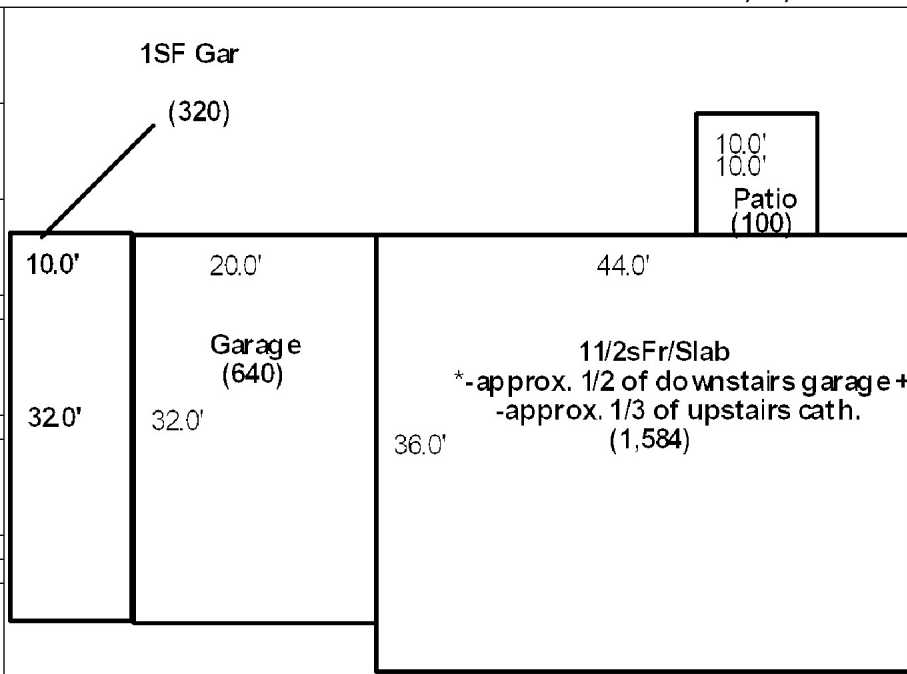

Date Inspected 7/27/2018

Additions, Outbuildings & Improvements

Type	Year	Units	Grade	Cond	Phys.	Funct.	Sound Value
62 Patio	0	100	3 100	4	0 %	100 %	
23 Frame Garage	0	640	0 0	0	0 %	80 %	
23 Frame Garage	2021	320	3 100	4	0 %	80 %	
					%	%	
					%	%	
					%	%	
					%	%	
					%	%	
					%	%	
					%	%	
					%	%	



CYR FAMILY LIMITED PARTNERSHIP
c/o GILBERT CYR
PORTAGE LAKE ME 04768

B3643P164

Inspection Witnessed By:

No./Date	Description	Date Insp.
X		

Notes:

Washburn

Property Data			Assessment Record																																																																																																																																																																																																												
Neighborhood 1 Neighborhood One			Year	Land	Buildings	Exempt	Total																																																																																																																																																																																																								
Tree Growth Year 0			2009	15,200	0	0	15,200																																																																																																																																																																																																								
1ST MORTGAGE 0			2012	15,300	0	0	15,300																																																																																																																																																																																																								
2ND MORTGAGE 0			2013	19,200	0	0	19,200																																																																																																																																																																																																								
Zone/Land Use 2 Commercial			2015	19,200	0	0	19,200																																																																																																																																																																																																								
Secondary Zone			2018	17,700	0	0	17,700																																																																																																																																																																																																								
Topography 2 Rolling			2019	25,200	0	0	25,200																																																																																																																																																																																																								
1.Level 4.Below St 7.LevelBog			2020	25,200	0	0	25,200																																																																																																																																																																																																								
2.Rolling 5.Low 8.			2021	24,300	0	0	24,300																																																																																																																																																																																																								
3.Above St 6.Swampy 9.			2022	24,400	0	0	24,400																																																																																																																																																																																																								
Utilities																																																																																																																																																																																																															
1.Public 4.Dr Well 7.Cesspool																																																																																																																																																																																																															
2.Water 5.Dug Well 8.																																																																																																																																																																																																															
3.Sewer 6.Septic 9.None																																																																																																																																																																																																															
Street 1 Paved																																																																																																																																																																																																															
1.Paved 4.Proposed 7.																																																																																																																																																																																																															
2.Semi Imp 5.R/O/W 8.																																																																																																																																																																																																															
3.Gravel 6. 9.None																																																																																																																																																																																																															
TG PLAN YEAR 2028			<table border="1"> <thead> <tr> <th rowspan="2">Front Foot</th> <th rowspan="2">Type</th> <th colspan="2">Effective</th> <th colspan="2">Influence</th> <th rowspan="2">Influence Codes</th> </tr> <tr> <th>Frontage</th> <th>Depth</th> <th>Factor</th> <th>Code</th> </tr> </thead> <tbody> <tr> <td>11.Regular Lot</td> <td></td> <td></td> <td></td> <td>%</td> <td></td> <td>1.Unimproved</td> </tr> <tr> <td>12.Delta Triangle</td> <td></td> <td></td> <td></td> <td>%</td> <td></td> <td>2.Excess Frtg</td> </tr> <tr> <td>13.Nabla Triangle</td> <td></td> <td></td> <td></td> <td>%</td> <td></td> <td>3.Topography</td> </tr> <tr> <td>14.Rear Land</td> <td></td> <td></td> <td></td> <td>%</td> <td></td> <td>4.Size/Shape</td> </tr> <tr> <td>15.Class I Road</td> <td></td> <td></td> <td></td> <td>%</td> <td></td> <td>5.Access</td> </tr> <tr> <td></td> <td></td> <td></td> <td></td> <td>%</td> <td></td> <td>6.Restriction</td> </tr> <tr> <td></td> <td></td> <td></td> <td></td> <td>%</td> <td></td> <td>7.Open Space</td> </tr> <tr> <td></td> <td></td> <td></td> <td></td> <td>%</td> <td></td> <td>8.View/Environ</td> </tr> <tr> <td></td> <td></td> <td></td> <td></td> <td>%</td> <td></td> <td>9.Fract Share</td> </tr> <tr> <td></td> <td></td> <td></td> <td></td> <td>%</td> <td></td> <td>Acres</td> </tr> <tr> <td></td> <td></td> <td></td> <td></td> <td>%</td> <td></td> <td>30.Utility R O W</td> </tr> <tr> <td></td> <td></td> <td></td> <td></td> <td>%</td> <td></td> <td>31.Tillable</td> </tr> <tr> <td></td> <td></td> <td></td> <td></td> <td>%</td> <td></td> <td>32.Pasture</td> </tr> <tr> <td></td> <td></td> <td></td> <td></td> <td>%</td> <td></td> <td>33.Orchard</td> </tr> <tr> <td></td> <td></td> <td></td> <td></td> <td>%</td> <td></td> <td>34.Softwood F&O</td> </tr> <tr> <td></td> <td></td> <td></td> <td></td> <td>%</td> <td></td> <td>35.Mixed Wood F&O</td> </tr> <tr> <td></td> <td></td> <td></td> <td></td> <td>%</td> <td></td> <td>36.Hardwood F&O</td> </tr> <tr> <td></td> <td></td> <td></td> <td></td> <td>%</td> <td></td> <td>37.Softwood TG</td> </tr> <tr> <td></td> <td></td> <td></td> <td></td> <td>%</td> <td></td> <td>38.Mixed Wood TG</td> </tr> <tr> <td></td> <td></td> <td></td> <td></td> <td>%</td> <td></td> <td>39.Hardwood TG</td> </tr> <tr> <td></td> <td></td> <td></td> <td></td> <td>%</td> <td></td> <td>40.Wasteland</td> </tr> <tr> <td></td> <td></td> <td></td> <td></td> <td>%</td> <td></td> <td>41.Open Space</td> </tr> <tr> <td></td> <td></td> <td></td> <td></td> <td>%</td> <td></td> <td>42.Mobile Home Si</td> </tr> <tr> <td></td> <td></td> <td></td> <td></td> <td>%</td> <td></td> <td>43.Condo Site</td> </tr> <tr> <td></td> <td></td> <td></td> <td></td> <td>%</td> <td></td> <td>44.Lot Improvemen</td> </tr> <tr> <td></td> <td></td> <td></td> <td></td> <td>%</td> <td></td> <td>45.Subdivision Lo</td> </tr> <tr> <td></td> <td></td> <td></td> <td></td> <td>%</td> <td></td> <td>46.Heavy Ind Sit</td> </tr> </tbody> </table>					Front Foot	Type	Effective		Influence		Influence Codes	Frontage	Depth	Factor	Code	11.Regular Lot				%		1.Unimproved	12.Delta Triangle				%		2.Excess Frtg	13.Nabla Triangle				%		3.Topography	14.Rear Land				%		4.Size/Shape	15.Class I Road				%		5.Access					%		6.Restriction					%		7.Open Space					%		8.View/Environ					%		9.Fract Share					%		Acres					%		30.Utility R O W					%		31.Tillable					%		32.Pasture					%		33.Orchard					%		34.Softwood F&O					%		35.Mixed Wood F&O					%		36.Hardwood F&O					%		37.Softwood TG					%		38.Mixed Wood TG					%		39.Hardwood TG					%		40.Wasteland					%		41.Open Space					%		42.Mobile Home Si					%		43.Condo Site					%		44.Lot Improvemen					%		45.Subdivision Lo					%		46.Heavy Ind Sit
Front Foot	Type	Effective								Influence		Influence Codes																																																																																																																																																																																																			
		Frontage	Depth	Factor	Code																																																																																																																																																																																																										
11.Regular Lot				%		1.Unimproved																																																																																																																																																																																																									
12.Delta Triangle				%		2.Excess Frtg																																																																																																																																																																																																									
13.Nabla Triangle				%		3.Topography																																																																																																																																																																																																									
14.Rear Land				%		4.Size/Shape																																																																																																																																																																																																									
15.Class I Road				%		5.Access																																																																																																																																																																																																									
				%		6.Restriction																																																																																																																																																																																																									
				%		7.Open Space																																																																																																																																																																																																									
				%		8.View/Environ																																																																																																																																																																																																									
				%		9.Fract Share																																																																																																																																																																																																									
				%		Acres																																																																																																																																																																																																									
				%		30.Utility R O W																																																																																																																																																																																																									
				%		31.Tillable																																																																																																																																																																																																									
				%		32.Pasture																																																																																																																																																																																																									
				%		33.Orchard																																																																																																																																																																																																									
				%		34.Softwood F&O																																																																																																																																																																																																									
				%		35.Mixed Wood F&O																																																																																																																																																																																																									
				%		36.Hardwood F&O																																																																																																																																																																																																									
				%		37.Softwood TG																																																																																																																																																																																																									
				%		38.Mixed Wood TG																																																																																																																																																																																																									
				%		39.Hardwood TG																																																																																																																																																																																																									
				%		40.Wasteland																																																																																																																																																																																																									
				%		41.Open Space																																																																																																																																																																																																									
				%		42.Mobile Home Si																																																																																																																																																																																																									
				%		43.Condo Site																																																																																																																																																																																																									
				%		44.Lot Improvemen																																																																																																																																																																																																									
				%		45.Subdivision Lo																																																																																																																																																																																																									
				%		46.Heavy Ind Sit																																																																																																																																																																																																									
Tif District # 0			Land Data																																																																																																																																																																																																												
Sale Data			Front Foot																																																																																																																																																																																																												
Sale Date 4/08/2002			11.Regular Lot																																																																																																																																																																																																												
Price			12.Delta Triangle																																																																																																																																																																																																												
Sale Type 1 Land Only			13.Nabla Triangle																																																																																																																																																																																																												
1.Land 4.Mobile 7.C/I L&B			14.Rear Land																																																																																																																																																																																																												
2.L & B 5.Other 8.			15.Class I Road																																																																																																																																																																																																												
3.Building 6.C/I Land 9.			Square Foot																																																																																																																																																																																																												
Financing			16.Class II Road																																																																																																																																																																																																												
1.Convent 4.Seller 7.			17.Municipal Rese																																																																																																																																																																																																												
2.FHA/VA 5.Private 8.			18.Munic Sep Lago																																																																																																																																																																																																												
3.Assumed 6.Cash 9.Unknown			19.Gravel Pit																																																																																																																																																																																																												
Validity 1 Arms Length Sale			20.Industrial Bas																																																																																																																																																																																																												
1.Valid 4.Split 7.Renovate			Fract. Acre																																																																																																																																																																																																												
2.Related 5.Partial 8.Other			21.Developed Pave																																																																																																																																																																																																												
3.Distress 6.Exempt 9.			22.Undev Paved (F																																																																																																																																																																																																												
Verified 5 Public Record			23.Developed Grav																																																																																																																																																																																																												
1.Buyer 4.Agent 7.Family			Acres																																																																																																																																																																																																												
2.Seller 5.Pub Rec 8.Other			24.Undev Gravel (
3.Lender 6.MLS 9.			25.Comm Base Pave																																																																																																																																																																																																												
			26.Comm Base Grav																																																																																																																																																																																																												
			27.Backlot																																																																																																																																																																																																												
			28.Rear Land																																																																																																																																																																																																												
			29.Pavement																																																																																																																																																																																																												
			Total Acreage 77.89																																																																																																																																																																																																												

Washburn

Map Lot 001-050

Account 311

Location Castle Hill Road

Card 1 Of 1 12/09/2022

Building Style 0	SF Bsmt Living 0	Layout 0
1.Conv. 5.Garrison 9.Gambrel	Fin Bsmt Grade 0 0	1.Typical 4. 7.
2.Ranch 6.Salt Box 10.Other	OPEN 5 OPTIONAL 0	2.Inadeq 5. 8.
3.R Ranch 7.Contemp 11.Split	Heat Type 100% 0	3.Poor 6. 9.
4.Cape 8.Log 12.	1.HWBB 5.FWA 9.No Heat	Attic 0
Dwelling Units 0	2.HWCI 6.GravWA 10.	1.1/4 Fin 4.Full Fin 7.
Other Units 0	3.H Pump 7.Electric 11.	2.1/2 Fin 5.F/Stair 8.
Stories 0	4.Steam 8.F/Wall 12.	3.3/4 Fin 6. 9.None
1.1 4.1.5 7.	Cool Type 0% 9 None	Insulation 0
2.2 5.1.75 8.	1.Refrig 4.W&C Air 7.	1.Full 4.Minimal 7.
3.3 6.2.5 9.	2.Evapor 5. 8.	2.Heavy 5.Partial 8.
Exterior Walls 0	3.H Pump 6. 9.None	3.Capped 6. 9.None
1.Wood 5.Stucco 9.T-111	Kitchen Style 0	Unfinished % 0%
2.Vin/Al 6.Brick 10.Other	1.Modern 4.Obsolete 7.	Grade & Factor 0 0%
3.Compos. 7.Stone 11.	2.Typical 5. 8.	1.E Grade 4.B Grade 7.
4.Asbestos 8.Concrete 12.	3.Old Type 6. 9.None	2.D Grade 5.A Grade 8.SC Grade
Roof Surface 0	Bath(s) Style 0	3.C Grade 6.AA Grade 9.Same
1.Asphalt 4.Composit 7.	1.Modern 4.Obsolete 7.	SQFT (Footprint) 0
2.Slate 5.Wood 8.	2.Typical 5. 8.	Condition 0
3.Metal 6.Other 9.	3.Old Type 6. 9.None	1.Poor 4.Avg 7.V G
SF Masonry Trim 0	# Rooms 0	2.Fair 5.Avg+ 8.Exc
OPEN-3-CUSTOM 0	# Bedrooms 0	3.Avg- 6.Good 9.Same
OPEN-4-CUSTOM 0	# Full Baths 0	Phys. % Good 0%
Year Built 0	# Half Baths 0	Funct. % Good 100%
Year Remodeled 0	# Addn Fixtures 0	Functional Code 9 None
Foundation 0	# Fireplaces 0	1.Incomp 4.Delap 7.No Power
1.Concrete 4.Wood 7.		2.O-Built 5.Bsmt 8.LongTerm
2.C Block 5.Slab 8.		3.Damage 6.Common 9.None
3.Br/Stone 6.Piers 9.		Econ. % Good 100%
Basement 0		Economic Code None
1.1/4 Bmt 4.Full Bmt 7.		0.None 3.No Power 7.
2.1/2 Bmt 5.None 8.		1.Location 4.Generate 8.
3.3/4 Bmt 6. 9.None		2.Encroach 9.None 9.
Bsmt Gar # Cars 0		Entrance Code 0
Wet Basement 0		1.Interior 4.Vacant 7.
1.Dry 4. 7.		2.Refusal 5.Estimate 8.
2.Damp 5. 8.	3.Informed 6.Reviewed 9.	
3.Wet 6. 9.	Information Code 0	
		1.Owner 4.Agent 7.
		2.Relative 5.Estimate 8.
		3.Tenant 6.Other 9.

Date Inspected

Additions, Outbuildings & Improvements

Type	Year	Units	Grade	Cond	Phys.	Funct.	Sound Value
					%	%	1.One Story Fram
					%	%	2.Two Story Fram
					%	%	3.Three Story Fr
					%	%	4.1 & 1/2 Story
					%	%	5.1 & 3/4 Story
					%	%	6.2 & 1/2 Story
					%	%	21.Open Frame Por
					%	%	22.Encl Frame Por
					%	%	23.Frame Garage
					%	%	24.Frame Shed
					%	%	25.Frame Bay Wind
					%	%	26.1SFr Overhang
					%	%	27.Unfin Basement
					%	%	28.Unfinished Att
					%	%	29.Finished Attic