

Washburn

Map Lot 012-026

Account 871

Location 1216 MAIN STREET

Card 1 Of 1 10/16/2019

Building Style	4 Cape Cod	SF Bsmt Living	0	Layout	1 Typical
1.Conv.	5.Garrison	9.Gambrel	Fin Bsmt Grade	0 0	1.Typical
2.Ranch	6.Salt Box	10.Other	OPEN 5 OPTIONAL	0	2.Inadeq
3.R Ranch	7.Contemp	11.Split	Heat Type	100%	3.Poor
4.Cape	8.Log	12.	1.HWBB	5.FWA	9.No Heat
Dwelling Units	1	2.HWCI	6.GravWA	10.	Attic
Other Units	0	3.H Pump	7.Electric	11.	1.1/4 Fin
Stories	4 One & 1/2 Story	4.Steam	8.Fi/Wall	12.	4.Full Fin
1.1	4.1.5	7.	Cool Type	0%	9.None
2.2	5.1.75	8.	1.Refrig	4.W&C Air	7.
3.3	6.2.5	9.	2.Evapor	5.	8.
Exterior Walls	2 Vinyl/Aluminum	3.H Pump	6.	9.None	Insulation
1.Wood	5.Stucco	9.T-111	Kitchen Style	2 Typical	1 Full
2.Vin/Al	6.Brick	10.Other	1.Modern	4.Obsolete	7.
3.Compos.	7.Stone	11.	2.Typical	5.	8.
4.Asbestos	8.Concrete	12.	3.Old Type	6.	9.None
Roof Surface	1 Asphalt Shingles	Bath(s) Style	2 Typical Bath(s)	Unfinished %	0%
1.Asphalt	4.Composit	7.	1.Modern	4.Obsolete	7.
2.Slate	5.Wood	8.	2.Typical	5.	8.
3.Metal	6.Other	9.	3.Old Type	6.	9.None
SF Masonry Trim	0	# Rooms	7	Grade & Factor	2 Fair 110%
OPEN-3-CUSTOM	0	# Bedrooms	3	1.E Grade	4.B Grade
OPEN-4-CUSTOM	0	# Full Baths	1	2.D Grade	5.A Grade
Year Built	1913	# Half Baths	1	3.C Grade	6.AA Grade
Year Remodeled	0	# Addn Fixtures	0	SQFT (Footprint) 852	
Foundation	2 Concrete Block	# Fireplaces	0	Condition 5 Above Average	
1.Concrete	4.Wood	7.	1.Poor		
2.C Block	5.Slab	8.	4.Avg		
3.Br/Stone	6.Piers	9.	7.V G		
Basement	4 Full Basement	Phys. % Good 0%			
1.1/4 Bmt	4.Full Bmt	7.	Funct. % Good 100%		
2.1/2 Bmt	5.None	8.	Functional Code 9 None		
3.3/4 Bmt	6.	9.None	1.Incomp		
Bsmt Gar # Cars	1	Economic Code None			
Wet Basement	3 Wet Basement	0.None			
1.Dry	4.	7.	3.No Power		
2.Damp	5.	8.	1.Location		
3.Wet	6.	9.	4.Generate		
Date Inspected 10/22/2018					
Entrance Code 1 Interior Inspect					
1.Interior					
4.Vacant					
7.					
2.Refusal					
5.Estimate					
8.					
3.Informed					
6.Reviewed					
9.					
Information Code 1 Owner					
1.Owner					
4.Agent					
7.					
2.Relative					
5.Estimate					
8.					
3.Tenant					
6.Other					
9.					

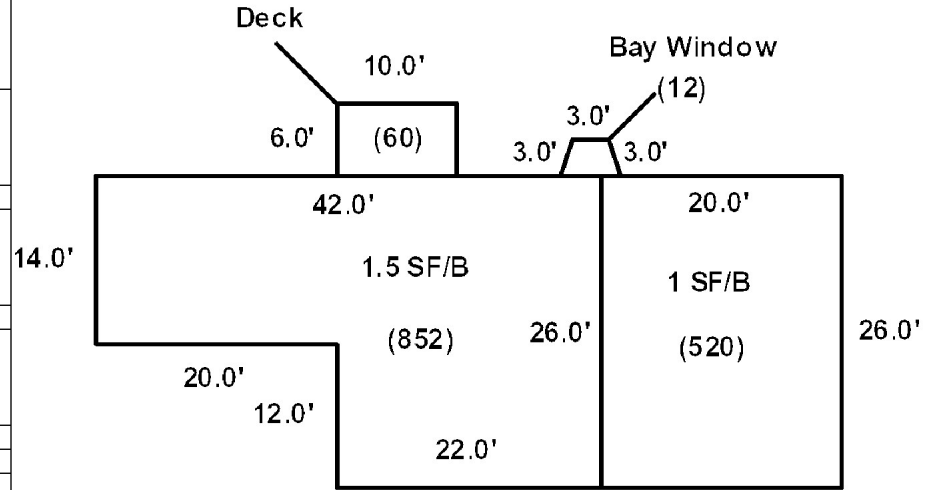

Additions, Outbuildings & Improvements							
Type	Year	Units	Grade	Cond	Phys.	Funct.	Sound Value
20 1 Story/Bsmt	1990	520	3 100	4	0 %	100 %	
68 Wood Deck	1990	60	3 100	4	0 %	100 %	
25 Frame Bay	1990	12	3 90	4	0 %	100 %	
					%	%	
					%	%	
					%	%	
					%	%	
					%	%	
					%	%	
					%	%	
					%	%	



Castonguay, Jerry M.
Castonguay, Courtney
P.O. Box 15

Washburn ME 04786
B4937P168

			Property Data			Assessment Record					
			Neighborhood	1 Neighborhood One		Year	Land	Buildings	Exempt	Total	
			Tree Growth Year 0			2007	4,200	60,100	13,000	51,300	
			1ST MORTGAGE 0			2008	4,200	60,100	13,000	51,300	
			2ND MORTGAGE 0			2009	4,200	60,100	9,000	55,300	
			Zone/Land Use 1 Residential			2012	4,200	62,900	8,800	58,300	
			Secondary Zone			2013	5,400	62,900	8,800	59,500	
			Topography 2 Rolling			2015	5,400	62,900	9,000	59,300	
			1.Level 4.Below St 7.LevelBog 2.Rolling 5.Low 8. 3.Above St 6.Swampy 9.			2018	5,400	62,900	18,400	49,900	
			Utilities 4 Drilled Well 3 Public Sewer			2019	11,800	59,100	20,000	50,900	
			1.Public 4.Dr Well 7.Cesspool 2.Water 5.Dug Well 8. 3.Sewer 6.Septic 9.None								
			Street 1 Paved								
			1.Paved 4.Proposed 7. 2.Semi Imp 5.R/O/W 8. 3.Gravel 6. 9.None								
			TG PLAN YEAR 0								
Inspection Witnessed By:			Tif District # 0								
			Sale Data								
X			Sale Date 6/26/2001			Land Data					
			Price 58,000			Front Foot		Type	Effective		Influence
No./Date			Sale Type 2 Land & Buildings			11.Regular Lot	Frontage	Depth	Factor	Code	1.Unimproved
			Description			1.Land 4.Mobile 7.C/I L&B			12.Delta Triangle		
Date Insp.						2.L & B 5.Other 8.			13.Nabla Triangle		
						3.Building 6.C/I Land 9.			14.Rear Land		
						Financing 1 Conventional			15.Miscellaneous		
						1.Convent 4.Seller 7.					
						2.FHA/VA 5.Private 8.					
						3.Assumed 6.Cash 9.Unknown					
Notes:						Validity 1 Arms Length Sale			Square Foot		Square Feet
						1.Valid 4.Split 7.Renovate			29	2,000	
						2.Related 5.Partial 8.Other					
						3.Distress 6.Exempt 9.					
						Verified 5 Public Record					
						1.Buyer 4.Agent 7.Family					
						2.Seller 5.Pub Rec 8.Other					
						3.Lender 6.MLS 9.					
									Fract. Acre		Acreage/Sites
									21	0.24	
									Total Acreage		0.24

Washburn

Map Lot 012-028

Account 92

Location 1226 Main Street

Card 1 Of 1 10/16/2019

Building Style	4 Cape Cod			SF Bsmt Living	0			Layout	1 Typical		
1.Conv.	5.Garrison	9.Gambrel		Fin Bsmt Grade	0 0			1.Typical	4.	7.	
2.Ranch	6.Salt Box	10.Other		OPEN 5 OPTIONAL	0			2.Inadeq	5.	8.	
3.R Ranch	7.Contemp	11.Split		Heat Type	100% 5 Forced Warm Air			3.Poor	6.	9.	
4.Cape	8.Log	12.		1.HWBB	5.FWA	9.No Heat	Attic	9 None			
Dwelling Units	1			2.HWCI	6.GravWA	10.	1.1/4 Fin	4.Full Fin	7.		
Other Units	0			3.H Pump	7.Electric	11.	2.1/2 Fin	5.FI/Stair	8.		
Stories	4 One & 1/2 Story			4.Steam	8.FI/Wall	12.	3.3/4 Fin	6.	9.None		
1.1	4.1.5	7.		Cool Type	0% 9 None			Insulation	4 Minimal		
2.2	5.1.75	8.		1.Refrig	4.W&C Air	7.	1.Full	4.Minimal	7.		
3.3	6.2.5	9.		2.Evapor	5.	8.	2.Heavy	5.Partial	8.		
Exterior Walls	4 Asbestos Siding			3.H Pump	6.	9.None	3.Capped	6.	9.None		
1.Wood	5.Stucco	9.T-111		Kitchen Style	2 Typical			Unfinished %	0%		
2.Vin/Al	6.Brick	10.Other		1.Modern	4.Obsolete	7.	Grade & Factor	3 Average 100%			
3.Compos.	7.Stone	11.		2.Typical	5.	8.	1.E Grade	4.B Grade	7.		
4.Asbestos	8.Concrete	12.		3.Old Type	6.	9.None	2.D Grade	5.A Grade	8.SC Grade		
Roof Surface	3 Sheet Metal			Bath(s) Style	2 Typical Bath(s)			3.C Grade	6.AA Grade	9.Same	
1.Asphalt	4.Composit	7.		1.Modern	4.Obsolete	7.	SQFT (Footprint) 672				
2.Slate	5.Wood	8.		2.Typical	5.	8.	Condition 5 Above Average				
3.Metal	6.Other	9.		3.Old Type	6.	9.None	1.Poor	4.Avg	7.V G		
SF Masonry Trim	0			# Rooms	7			2.Fair	5.Avg+	8.Exc	
OPEN-3-CUSTOM	0			# Bedrooms	2			3.Avg-	6.Good	9.Same	
OPEN-4-CUSTOM	0			# Full Baths	1			Phys. % Good	0%		
Year Built	1948			# Half Baths	0			Funct. % Good	100%		
Year Remodeled	0			# Addn Fixtures	0			Functional Code	9 None		
Foundation	1 Concrete			# Fireplaces	1			1.Incomp	4.Delap	7.No Power	
1.Concrete	4.Wood	7.									
2.C Block	5.Slab	8.									
3.Br/Stone	6.Piers	9.									
Basement	4 Full Basement										
1.1/4 Bmt	4.Full Bmt	7.									
2.1/2 Bmt	5.None	8.									
3.3/4 Bmt	6.	9.None									
Bsmt Gar # Cars	0										
Wet Basement	2 Damp Basement										
1.Dry	4.	7.									
2.Damp	5.	8.									
3.Wet	6.	9.									
Date Inspected 10/22/2018				Economic Code None				Entrance Code 1 Interior Inspect			
				0.None 3.No Power 7.				1.Interior 4.Vacant 7.			
				1.Location 4.Generate 8.				2.Refusal 5.Estimate 8.			
				2.O-Built 5.Bsmt 8.LongTerm				3.Informed 6.Reviewed 9.			
				3.Damage 6.Common 9.None				Information Code 1 Owner			
				Econ. % Good 100%				1.Owner 4.Agent 7.			
								2.Relative 5.Estimate 8.			
								3.Tenant 6.Other 9.			

Canopy SV \$250

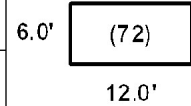

1 SF Garage w/ Unfin Base

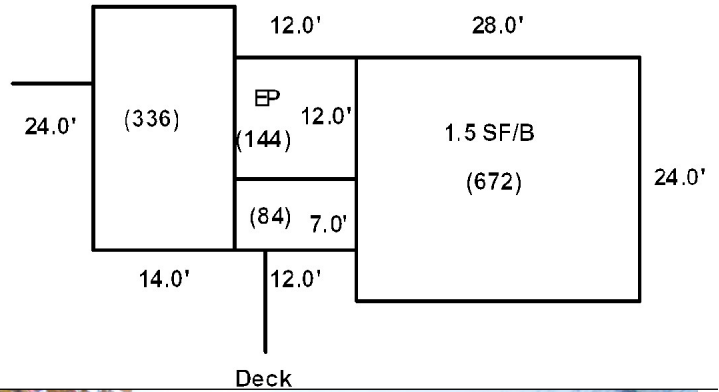

Additions, Outbuildings & Improvements									
Type	Year	Units	Grade	Cond	Phys.	Funct.	Sound Value		
68 Wood Deck	1980	84	3 100	4	0 %	100 %		1.One Story Fram	
22 Encl Frame Porch	1948	144	9 100	9	0 %	100 %		2.Two Story Fram	
23 Frame Garage	1948	336	3 100	5	0 %	90 %		3.Three Story Fr	
27 Unfin Basement	1948	336	2 100	4	0 %	100 %		4.1 & 1/2 Story	
61 Canopy	0						250	5.1 & 3/4 Story	
								6.2 & 1/2 Story	
								21.Open Frame Por	
								22.Encl Frame Por	
								23.Frame Garage	
								24.Frame Shed	
								25.Frame Bay Wind	
								26.1SFr Overhang	
								27.Unfin Basement	
								28.Unfinished Att	
								29.Finished Attic	

Doody, George W.
Doody, Velva L.
P.O. Box 242

Washburn ME 04786

			Property Data			Assessment Record				
			Neighborhood	1 Neighborhood One		Year	Land	Buildings	Exempt	Total
			Tree Growth Year 0			2007	5,200	62,500	13,000	54,700
			1ST MORTGAGE 0			2008	5,200	62,500	13,000	54,700
			2ND MORTGAGE 0			2009	5,200	62,500	9,000	58,700
			Zone/Land Use 1 Residential			2012	5,200	62,500	8,800	58,900
			Secondary Zone			2013	6,700	62,500	8,800	60,400
			Topography 1 Level			2015	6,700	62,500	9,000	60,200
			1.Level 4.Below St 7.LevelBog 2.Rolling 5.Low 8. 3.Above St 6.Swampy 9.			2018	6,700	62,500	18,400	50,800
			Utilities 2 Public Water 3 Public Sewer			2019	10,700	75,900	20,000	66,600
			1.Public 4.Dr Well 7.Cesspool 2.Water 5.Dug Well 8. 3.Sewer 6.Septic 9.None							
			Street 1 Paved							
			1.Paved 4.Proposed 7. 2.Semi Imp 5.R/O/W 8. 3.Gravel 6. 9.None							
			TG PLAN YEAR 0							
Inspection Witnessed By:			Tif District # 0							
			Sale Data							
X			Sale Date							
			Price							
No./Date			Sale Type 2 Land & Buildings			Front Foot				
			1.Land 4.Mobile 7.C/I L&B 2.L & B 5.Other 8. 3.Building 6.C/I Land 9.			11.Regular Lot 12.Delta Triangle 13.Nabla Triangle 14.Rear Land 15.Miscellaneous				
Description			Financing			Square Foot				
			1.Convent 4.Seller 7. 2.FHA/VA 5.Private 8. 3.Assumed 6.Cash 9.Unknown			16.Regular Lot 17.Municipal Rese 18.Munic Sep Lago 19.Gravel Pit 20.Industrial Bas				
Date Insp.			Validity			Fract. Acre				
			1.Valid 4.Split 7.Renovate 2.Related 5.Partial 8.Other 3.Distress 6.Exempt 9.			21.Developed Pave 22.Undev Paved (F 23.Developed Grav				
			Verified			Acres				
			1.Buyer 4.Agent 7.Family 2.Seller 5.Pub Rec 8.Other 3.Lender 6.MLS 9.			24.Undev Gravel (25.Comm Base Pave 26.Comm Base Grav 27.Backlot 28.Rear Land 29.Pavement				
						Land Data				
						Influence Codes				
						1.Unimproved 2.Excess Frtg 3.Topography 4.Size/Shape 5.Access 6.Restriction 7.Open Space 8.View/Environ 9.Fract Share Acres 30.Utility R O W 31.Tillable 32.Pasture 33.Orchard 34.Softwood F&O 35.Mixed Wood F&O 36.Hardwood F&O 37.Softwood TG 38.Mixed Wood TG 39.Hardwood TG 40.Wasteland 41.Open Space 42.Mobile Home Si 43.Condo Site 44.Lot Improvemen 45.Subdivision Lo 46.Golf Course				
						Effective				
						Influence				
						Factor Code				
						Type				
						Frontage Depth				
						Total Acreage 0.36				

Notes:
*1-25-2019 -15 % for attached garage.

Washburn

Map Lot 012-029

Account 370

Location 8 Thompson Street

Card 1

Of 1

10/16/2019

Building Style	4 Cape Cod		SF Bsmt Living	0		Layout	1 Typical		
1.Conv.	5.Garrison	9.Gambrel	Fin Bsmt Grade	0 0		1.Typical	4.	7.	
2.Ranch	6.Salt Box	10.Other	OPEN 5 OPTIONAL	0		2.Inadeq	5.	8.	
3.R Ranch	7.Contemp	11.Split	Heat Type	100% 1 Hot Water BB		3.Poor	6.	9.	
4.Cape	8.Log	12.	1.HWBB	5.FWA	9.No Heat	Attic	9 None		
Dwelling Units	1		2.HWCI	6.GravWA	10.	1.1/4 Fin	4.Full Fin	7.	
Other Units	0		3.H Pump	7.Electric	11.	2.1/2 Fin	5.FI/Stair	8.	
Stories	5 One & 3/4 Story		4.Steam	8.FI/Wall	12.	3.3/4 Fin	6.	9.None	
1.1	4.1.5	7.	Cool Type	0% 9 None		Insulation	1 Full		
2.2	5.1.75	8.	1.Refrig	4.W&C Air	7.	1.Full	4.Minimal	7.	
3.3	6.2.5	9.	2.Evapor	5.	8.	2.Heavy	5.Partial	8.	
Exterior Walls	4 Asbestos Siding		3.H Pump	6.	9.None	3.Capped	6.	9.None	
1.Wood	5.Stucco	9.T-111	Kitchen Style	2 Typical		Unfinished %	0%		
2.Vin/Al	6.Brick	10.Other	1.Modern	4.Obsolete	7.	Grade & Factor	3 Average 105%		
3.Compos.	7.Stone	11.	2.Typical	5.	8.	1.E Grade	4.B Grade	7.	
4.Asbestos	8.Concrete	12.	3.Old Type	6.	9.None	2.D Grade	5.A Grade	8.SC Grade	
Roof Surface	1 Asphalt Shingles		Bath(s) Style	2 Typical Bath(s)		3.C Grade	6.AA Grade	9.Same	
1.Asphalt	4.Composit	7.	1.Modern	4.Obsolete	7.	SQFT (Footprint)	736		
2.Slate	5.Wood	8.	2.Typical	5.	8.	Condition	4 Average		
3.Metal	6.Other	9.	3.Old Type	6.	9.None	1.Poor	4.Avg	7.V G	
SF Masonry Trim	0		# Rooms	6		2.Fair	5.Avg+	8.Exc	
OPEN-3-CUSTOM	0		# Bedrooms	3		3.Avg-	6.Good	9.Same	
OPEN-4-CUSTOM	0		# Full Baths	1		Phys. % Good	0%		
Year Built	1970		# Half Baths	1		Funct. % Good	100%		
Year Remodeled	0		# Addn Fixtures	0		Functional Code	9 None		
Foundation	1 Concrete		# Fireplaces	0		1.Incomp	4.Delap	7.No Power	
1.Concrete	4.Wood	7.		2.O-Built	5.Bsmt	8.LongTerm	Economic Code	None	
2.C Block	5.Slab	8.		3.Damage	6.Common	9.None	0.None	3.No Power	7.
3.Br/Stone	6.Piers	9.		Econ. % Good	100%		1.Location	4.Generate	8.
Basement	4 Full Basement			Entrance Code	5 Estimated		2.Encroach	9.None	9.
1.1/4 Bmt	4.Full Bmt	7.		1.Interior	4.Vacant	7.	Information Code	5 Estimate	
2.1/2 Bmt	5.None	8.		2.Refusal	5.Estimate	8.	1.Owner	4.Agent	7.
3.3/4 Bmt	6.	9.None		3.Informed	6.Reviewed	9.	2.Relative	5.Estimate	8.
Bsmt Gar # Cars	0			Information Code	5 Estimate		3.Tenant	6.Other	9.
Wet Basement	1 Dry Basement			1.One Story Fram					
1.Dry	4.	7.		2.Two Story Fram					
2.Damp	5.	8.	3.Three Story Fr						
3.Wet	6.	9.	4.1 & 1/2 Story						

Date Inspected 10/27/2018

Additions, Outbuildings & Improvements

Type	Year	Units	Grade	Cond	Phys.	Funct.	Sound Value
1 One Story Frame	1970	32	3 100	4	0 %	100 %	
21 Open Frame	1970	24	3 100	4	0 %	100 %	
62 Patio	2000	119	3 105	4	0 %	100 %	
68 Wood Deck	2000	42	3 100	4	0 %	100 %	
25 Frame Bay	1970	7	9 100	9	0 %	100 %	
23 Frame Garage	1970	480	3 100	4	0 %	85 %	
23 Frame Garage	1990	480	3 100	4	0 %	100 %	
21 Open Frame	1990	160	3 100	4	0 %	100 %	
					%	%	
					%	%	

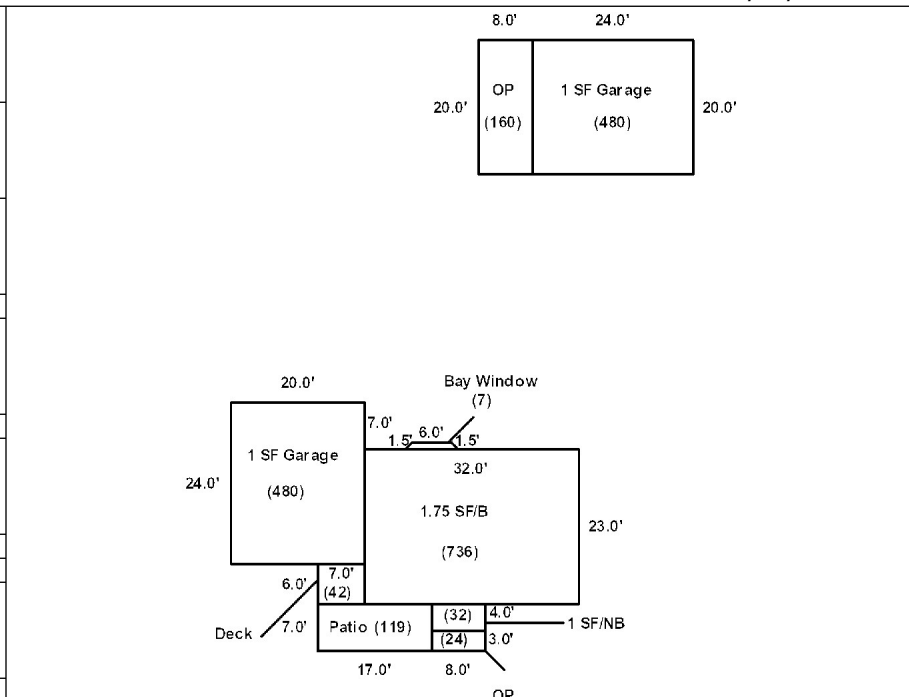

Washburn

Map Lot 012-030

Account 779

Location 10 LORETTA LANE

Card 1 Of 1 10/16/2019

Building Style 2 Ranch	SF Bsmt Living 0	Layout 1 Typical
1.Conv. 5.Garrison 9.Gambrel	Fin Bsmt Grade 0 0	1.Typical 4. 7.
2.Ranch 6.Salt Box 10.Other	OPEN 5 OPTIONAL 0	2.Inadeq 5. 8.
3.R Ranch 7.Contemp 11.Split	Heat Type 100% 1 Hot Water BB	3.Poor 6. 9.
4.Cape 8.Log 12.	1.HWBB 5.FWA 9.No Heat	Attic 9 None
Dwelling Units 1	2.HWCI 6.GravWA 10.	1.1/4 Fin 4.Full Fin 7.
Other Units 0	3.H Pump 7.Electric 11.	2.1/2 Fin 5.FI/Stair 8.
Stories 1 One Story	4.Steam 8.FI/Wall 12.	3.3/4 Fin 6. 9.None
1.1 4.1.5 7.	Cool Type 100% 3 Heat Pump	Insulation 1 Full
2.2 5.1.75 8.	1.Refrig 4.W&C Air 7.	1.Full 4.Minimal 7.
3.3 6.2.5 9.	2.Evapor 5. 8.	2.Heavy 5.Partial 8.
Exterior Walls 9 T-111	3.H Pump 6. 9.None	3.Capped 6. 9.None
1.Wood 5.Stucco 9.T-111	Kitchen Style 2 Typical	Unfinished % 0%
2.Vin/Al 6.Brick 10.Other	1.Modern 4.Obsolete 7.	Grade & Factor 3 Average 100%
3.Compos. 7.Stone 11.	2.Typical 5. 8.	1.E Grade 4.B Grade 7.
4.Asbestos 8.Concrete 12.	3.Old Type 6. 9.None	2.D Grade 5.A Grade 8.SC Grade
Roof Surface 1 Asphalt Shingles	Bath(s) Style 2 Typical Bath(s)	3.C Grade 6.AA Grade 9.Same
1.Asphalt 4.Composit 7.	1.Modern 4.Obsolete 7.	SQFT (Footprint) 1080
2.Slate 5.Wood 8.	2.Typical 5. 8.	Condition 6 Good
3.Metal 6.Other 9.	3.Old Type 6. 9.None	1.Poor 4.Avg 7.V G
SF Masonry Trim 0	# Rooms 6	2.Fair 5.Avg+ 8.Exc
OPEN-3-CUSTOM 0	# Bedrooms 2	3.Avg- 6.Good 9.Same
OPEN-4-CUSTOM 0	# Full Baths 1	Phys. % Good 0%
Year Built 1970	# Half Baths 0	Funct. % Good 100%
Year Remodeled 0	# Addn Fixtures 0	Functional Code 9 None
Foundation 1 Concrete	# Fireplaces 0	1.Incomp 4.Delap 7.No Power
1.Concrete 4.Wood 7.	 <p>TRIO Software <small>A Division of Harris Computer Systems</small></p>	2.O-Built 5.Bsmt 8.LongTerm
2.C Block 5.Slab 8.		3.Damage 6.Common 9.None
3.Br/Stone 6.Piers 9.		Econ. % Good 100%
Basement 4 Full Basement		Economic Code None
1.1/4 Bmt 4.Full Bmt 7.		0.None 3.No Power 7.
2.1/2 Bmt 5.None 8.		1.Location 4.Generate 8.
3.3/4 Bmt 6. 9.None		2.Encroach 9.None 9.
Bsmt Gar # Cars 0		Entrance Code 1 Interior Inspect
Wet Basement 1 Dry Basement		1.Interior 4.Vacant 7.
1.Dry 4. 7.		2.Refusal 5.Estimate 8.
2.Damp 5. 8.	3.Informed 6.Reviewed 9.	
3.Wet 6. 9.	Information Code 3 Tenant	
		1.Owner 4.Agent 7.
		2.Relative 5.Estimate 8.
		3.Tenant 6.Other 9.

Date Inspected 10/27/2018

Additions, Outbuildings & Improvements

Type	Year	Units	Grade	Cond	Phys.	Funct.	Sound Value
40 Basement Entry	1970	36	9 100	9	0 %	100 %	
21 Open Frame	1970	90	3 100	3	0 %	100 %	
22 Encl Frame Porch	1970	64	9 100	9	0 %	100 %	
23 Frame Garage	1970	567	3 100	4	0 %	95 %	
24 Frame Shed	0				%	%	350
					%	%	
					%	%	
					%	%	
					%	%	
					%	%	
					%	%	
					%	%	

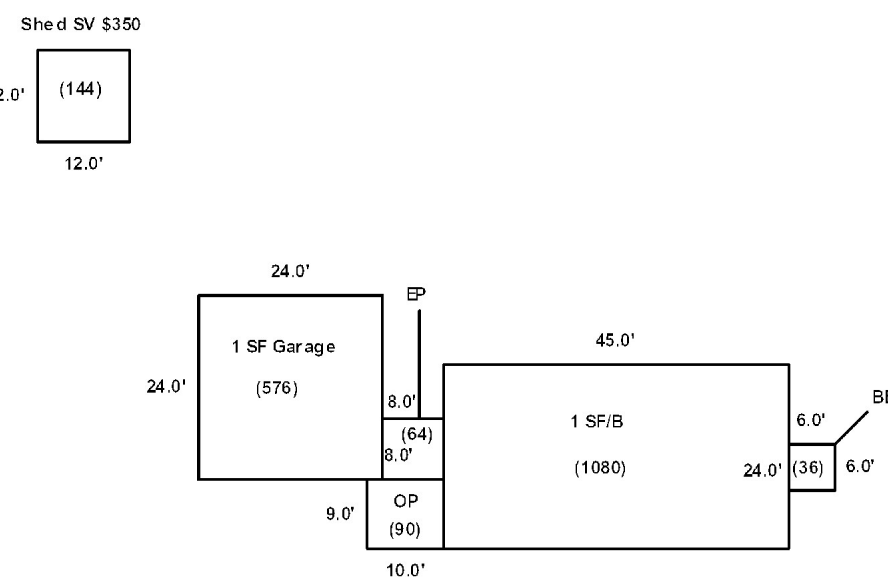

Washburn

Map Lot 012-031

Account 877

Location 7 LORETTA LANE

Card 1 Of 1 10/16/2019

Building Style 2 Ranch	SF Bsmt Living 0	Layout 1 Typical
1.Conv. 5.Garrison 9.Gambrel	Fin Bsmt Grade 0 0	1.Typical 4. 7.
2.Ranch 6.Salt Box 10.Other	OPEN 5 OPTIONAL 0	2.Inadeq 5. 8.
3.R Ranch 7.Contemp 11.Split	Heat Type 100% 5 Forced Warm Air	3.Poor 6. 9.
4.Cape 8.Log 12.	1.HWBB 5.FWA 9.No Heat	Attic 9 None
Dwelling Units 1	2.HWCI 6.GravWA 10.	1.1/4 Fin 4.Full Fin 7.
Other Units 0	3.H Pump 7.Electric 11.	2.1/2 Fin 5.F/ Stair 8.
Stories 1 One Story	4.Steam 8.F/ Wall 12.	3.3/4 Fin 6. 9.None
1.1 4.1.5 7.	Cool Type 0% 9 None	Insulation 1 Full
2.2 5.1.75 8.	1.Refrig 4.W&C Air 7.	1.Full 4.Minimal 7.
3.3 6.2.5 9.	2.Evapor 5. 8.	2.Heavy 5.Partial 8.
Exterior Walls 4 Asbestos Siding	3.H Pump 6. 9.None	3.Capped 6. 9.None
1.Wood 5.Stucco 9.T-111	Kitchen Style 2 Typical	Unfinished % 0%
2.Vin/Al 6.Brick 10.Other	1.Modern 4.Obsolete 7.	Grade & Factor 3 Average 100%
3.Compos. 7.Stone 11.	2.Typical 5. 8.	1.E Grade 4.B Grade 7.
4.Asbestos 8.Concrete 12.	3.Old Type 6. 9.None	2.D Grade 5.A Grade 8.SC Grade
Roof Surface 1 Asphalt Shingles	Bath(s) Style 2 Typical Bath(s)	3.C Grade 6.AA Grade 9.Same
1.Asphalt 4.Composit 7.	1.Modern 4.Obsolete 7.	SQFT (Footprint) 952
2.Slate 5.Wood 8.	2.Typical 5. 8.	Condition 5 Above Average
3.Metal 6.Other 9.	3.Old Type 6. 9.None	1.Poor 4.Avg 7.V G
SF Masonry Trim 0	# Rooms 5	2.Fair 5.Avg+ 8.Exc
OPEN-3-CUSTOM 0	# Bedrooms 3	3.Avg- 6.Good 9.Same
OPEN-4-CUSTOM 0	# Full Baths 1	Phys. % Good 0%
Year Built 1965	# Half Baths 0	Funct. % Good 100%
Year Remodeled 0	# Addn Fixtures 0	Functional Code 9 None
Foundation 1 Concrete	# Fireplaces 0	1.Incomp 4.Delap 7.No Power
1.Concrete 4.Wood 7.		2.O-Built 5.Bsmt 8.LongTerm
2.C Block 5.Slab 8.		3.Damage 6.Common 9.None
3.Br/Stone 6.Piers 9.		Econ. % Good 100%
Basement 4 Full Basement		Economic Code None
1.1/4 Bmt 4.Full Bmt 7.		0.None 3.No Power 7.
2.1/2 Bmt 5.None 8.		1.Location 4.Generate 8.
3.3/4 Bmt 6. 9.None		2.Encroach 9.None 9.
Bsmt Gar # Cars 0		Entrance Code 5 Estimated
Wet Basement 2 Damp Basement		1.Interior 4.Vacant 7.
1.Dry 4. 7.		2.Refusal 5.Estimate 8.
2.Damp 5. 8.	3.Informed 6.Reviewed 9.	
3.Wet 6. 9.	Information Code 5 Estimate	
	1.Owner 4.Agent 7.	
	2.Relative 5.Estimate 8.	
	3.Tenant 6.Other 9.	

Date Inspected 10/27/2018

Additions, Outbuildings & Improvements

Type	Year	Units	Grade	Cond	Phys.	Funct.	Sound Value
20 1 Story/Bsmt	1965	192	9 100	9	0 %	100 %	
21 Open Frame	1965	120	3 100	3	0 %	100 %	
24 Frame Shed	0				%	%	100
24 Frame Shed	0				%	%	100
					%	%	
					%	%	
					%	%	
					%	%	
					%	%	
					%	%	
					%	%	

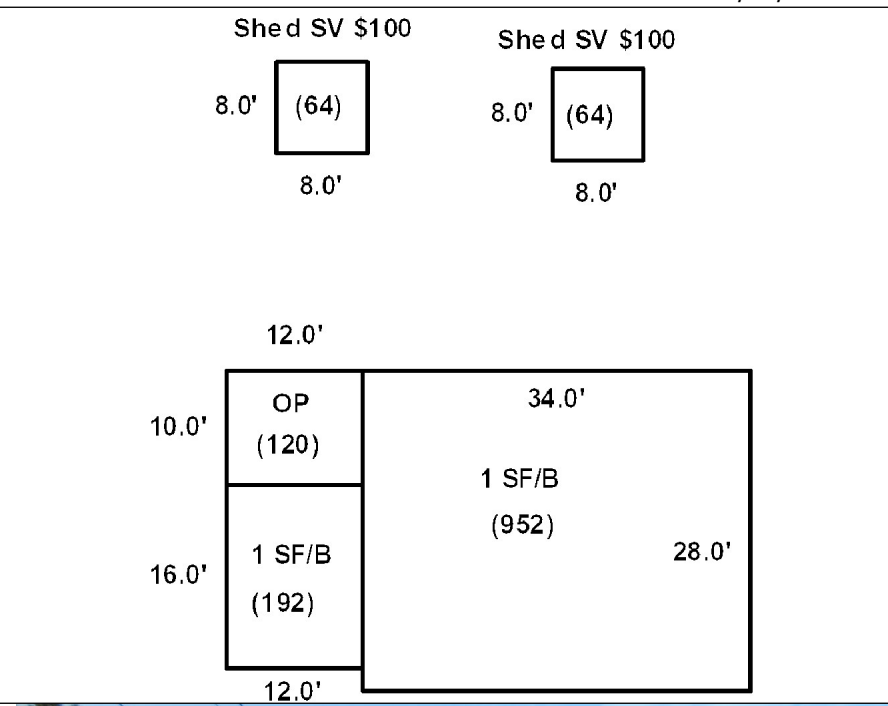

Smith, Frank J.
Smith, Norma S.
P.O. Box 128

Washburn ME 04786
B1474P130

Inspection Witnessed By:

No./Date	Description	Date Insp.
X		

Notes:

Washburn

Property Data			Assessment Record																																																																																																																																																																																																												
Neighborhood 1 Neighborhood One			Year	Land	Buildings	Exempt	Total																																																																																																																																																																																																								
Tree Growth Year 0			2007	5,100	56,000	18,000	43,100																																																																																																																																																																																																								
1ST MORTGAGE 0			2008	5,100	56,000	19,000	42,100																																																																																																																																																																																																								
2ND MORTGAGE 0			2009	5,100	56,000	14,400	46,700																																																																																																																																																																																																								
Zone/Land Use 1 Residential			2012	5,100	56,000	14,080	47,020																																																																																																																																																																																																								
Secondary Zone			2013	6,700	56,000	14,080	48,620																																																																																																																																																																																																								
Topography 1 Level			2015	6,700	56,000	14,400	48,300																																																																																																																																																																																																								
1.Level 4.Below St 7.LevelBog 2.Rolling 5.Low 8. 3.Above St 6.Swampy 9.			2018	6,700	56,000	23,920	38,780																																																																																																																																																																																																								
Utilities 2 Public Water 3 Public Sewer			2019	11,200	58,900	26,000	44,100																																																																																																																																																																																																								
1.Public 4.Dr Well 7.Cesspool 2.Water 5.Dug Well 8. 3.Sewer 6.Septic 9.None																																																																																																																																																																																																															
Street 1 Paved																																																																																																																																																																																																															
1.Paved 4.Proposed 7. 2.Semi Imp 5.R/O/W 8. 3.Gravel 6. 9.None																																																																																																																																																																																																															
TG PLAN YEAR 0			<table border="1"> <thead> <tr> <th rowspan="2">Front Foot</th> <th rowspan="2">Type</th> <th colspan="2">Effective</th> <th colspan="2">Influence</th> <th rowspan="2">Influence Codes</th> </tr> <tr> <th>Frontage</th> <th>Depth</th> <th>Factor</th> <th>Code</th> </tr> </thead> <tbody> <tr> <td>11.Regular Lot</td> <td></td> <td></td> <td></td> <td>%</td> <td></td> <td>1.Unimproved</td> </tr> <tr> <td>12.Delta Triangle</td> <td></td> <td></td> <td></td> <td>%</td> <td></td> <td>2.Excess Frtg</td> </tr> <tr> <td>13.Nabla Triangle</td> <td></td> <td></td> <td></td> <td>%</td> <td></td> <td>3.Topography</td> </tr> <tr> <td>14.Rear Land</td> <td></td> <td></td> <td></td> <td>%</td> <td></td> <td>4.Size/Shape</td> </tr> <tr> <td>15.Miscellaneous</td> <td></td> <td></td> <td></td> <td>%</td> <td></td> <td>5.Access</td> </tr> <tr> <td></td> <td></td> <td></td> <td></td> <td>%</td> <td></td> <td>6.Restriction</td> </tr> <tr> <td></td> <td></td> <td></td> <td></td> <td>%</td> <td></td> <td>7.Open Space</td> </tr> <tr> <td></td> <td></td> <td></td> <td></td> <td>%</td> <td></td> <td>8.View/Environ</td> </tr> <tr> <td></td> <td></td> <td></td> <td></td> <td>%</td> <td></td> <td>9.Fract Share</td> </tr> <tr> <td></td> <td></td> <td></td> <td></td> <td>%</td> <td></td> <td>Acres</td> </tr> <tr> <td></td> <td></td> <td></td> <td></td> <td>%</td> <td></td> <td>30.Utility R O W</td> </tr> <tr> <td></td> <td></td> <td></td> <td></td> <td>%</td> <td></td> <td>31.Tillable</td> </tr> <tr> <td></td> <td></td> <td></td> <td></td> <td>%</td> <td></td> <td>32.Pasture</td> </tr> <tr> <td></td> <td></td> <td></td> <td></td> <td>%</td> <td></td> <td>33.Orchard</td> </tr> <tr> <td></td> <td></td> <td></td> <td></td> <td>%</td> <td></td> <td>34.Softwood F&O</td> </tr> <tr> <td></td> <td></td> <td></td> <td></td> <td>%</td> <td></td> <td>35.Mixed Wood F&O</td> </tr> <tr> <td></td> <td></td> <td></td> <td></td> <td>%</td> <td></td> <td>36.Hardwood F&O</td> </tr> <tr> <td></td> <td></td> <td></td> <td></td> <td>%</td> <td></td> <td>37.Softwood TG</td> </tr> <tr> <td></td> <td></td> <td></td> <td></td> <td>%</td> <td></td> <td>38.Mixed Wood TG</td> </tr> <tr> <td></td> <td></td> <td></td> <td></td> <td>%</td> <td></td> <td>39.Hardwood TG</td> </tr> <tr> <td></td> <td></td> <td></td> <td></td> <td>%</td> <td></td> <td>40.Wasteland</td> </tr> <tr> <td></td> <td></td> <td></td> <td></td> <td>%</td> <td></td> <td>41.Open Space</td> </tr> <tr> <td></td> <td></td> <td></td> <td></td> <td>%</td> <td></td> <td>42.Mobile Home Si</td> </tr> <tr> <td></td> <td></td> <td></td> <td></td> <td>%</td> <td></td> <td>43.Condo Site</td> </tr> <tr> <td></td> <td></td> <td></td> <td></td> <td>%</td> <td></td> <td>44.Lot Improvemen</td> </tr> <tr> <td></td> <td></td> <td></td> <td></td> <td>%</td> <td></td> <td>45.Subdivision Lo</td> </tr> <tr> <td></td> <td></td> <td></td> <td></td> <td>%</td> <td></td> <td>46.Golf Course</td> </tr> </tbody> </table>					Front Foot	Type	Effective		Influence		Influence Codes	Frontage	Depth	Factor	Code	11.Regular Lot				%		1.Unimproved	12.Delta Triangle				%		2.Excess Frtg	13.Nabla Triangle				%		3.Topography	14.Rear Land				%		4.Size/Shape	15.Miscellaneous				%		5.Access					%		6.Restriction					%		7.Open Space					%		8.View/Environ					%		9.Fract Share					%		Acres					%		30.Utility R O W					%		31.Tillable					%		32.Pasture					%		33.Orchard					%		34.Softwood F&O					%		35.Mixed Wood F&O					%		36.Hardwood F&O					%		37.Softwood TG					%		38.Mixed Wood TG					%		39.Hardwood TG					%		40.Wasteland					%		41.Open Space					%		42.Mobile Home Si					%		43.Condo Site					%		44.Lot Improvemen					%		45.Subdivision Lo					%		46.Golf Course
Front Foot	Type	Effective								Influence		Influence Codes																																																																																																																																																																																																			
		Frontage	Depth	Factor	Code																																																																																																																																																																																																										
11.Regular Lot				%		1.Unimproved																																																																																																																																																																																																									
12.Delta Triangle				%		2.Excess Frtg																																																																																																																																																																																																									
13.Nabla Triangle				%		3.Topography																																																																																																																																																																																																									
14.Rear Land				%		4.Size/Shape																																																																																																																																																																																																									
15.Miscellaneous				%		5.Access																																																																																																																																																																																																									
				%		6.Restriction																																																																																																																																																																																																									
				%		7.Open Space																																																																																																																																																																																																									
				%		8.View/Environ																																																																																																																																																																																																									
				%		9.Fract Share																																																																																																																																																																																																									
				%		Acres																																																																																																																																																																																																									
				%		30.Utility R O W																																																																																																																																																																																																									
				%		31.Tillable																																																																																																																																																																																																									
				%		32.Pasture																																																																																																																																																																																																									
				%		33.Orchard																																																																																																																																																																																																									
				%		34.Softwood F&O																																																																																																																																																																																																									
				%		35.Mixed Wood F&O																																																																																																																																																																																																									
				%		36.Hardwood F&O																																																																																																																																																																																																									
				%		37.Softwood TG																																																																																																																																																																																																									
				%		38.Mixed Wood TG																																																																																																																																																																																																									
				%		39.Hardwood TG																																																																																																																																																																																																									
				%		40.Wasteland																																																																																																																																																																																																									
				%		41.Open Space																																																																																																																																																																																																									
				%		42.Mobile Home Si																																																																																																																																																																																																									
				%		43.Condo Site																																																																																																																																																																																																									
				%		44.Lot Improvemen																																																																																																																																																																																																									
				%		45.Subdivision Lo																																																																																																																																																																																																									
				%		46.Golf Course																																																																																																																																																																																																									
Tif District # 0			Land Data																																																																																																																																																																																																												
Sale Data			Front Foot		Square Feet																																																																																																																																																																																																										
Sale Date			11.Regular Lot		29																																																																																																																																																																																																										
Price			12.Delta Triangle		700																																																																																																																																																																																																										
Sale Type			13.Nabla Triangle		75																																																																																																																																																																																																										
1.Land 4.Mobile 7.C/I L&B			14.Rear Land		%																																																																																																																																																																																																										
2.L & B 5.Other 8.			15.Miscellaneous		%																																																																																																																																																																																																										
3.Building 6.C/I Land 9.			Square Foot		Acres/Sites																																																																																																																																																																																																										
Financing			16.Regular Lot		21																																																																																																																																																																																																										
1.Convent 4.Seller 7.			17.Municipal Rese		0.36																																																																																																																																																																																																										
2.FHA/VA 5.Private 8.			18.Munic Sep Lago		100																																																																																																																																																																																																										
3.Assumed 6.Cash 9.Unknown			19.Gravel Pit		%																																																																																																																																																																																																										
Validity			20.Industrial Bas		%																																																																																																																																																																																																										
1.Valid 4.Split 7.Renovate			Fract. Acre		Acres																																																																																																																																																																																																										
2.Related 5.Partial 8.Other			21.Developed Pave		%																																																																																																																																																																																																										
3.Distress 6.Exempt 9.			22.Undev Paved (F		%																																																																																																																																																																																																										
Verified			23.Developed Grav		%																																																																																																																																																																																																										
1.Buyer 4.Agent 7.Family			24.Undev Gravel (%																																																																																																																																																																																																										
2.Seller 5.Pub Rec 8.Other			25.Comm Base Pave		%																																																																																																																																																																																																										
3.Lender 6.MLS 9.			26.Comm Base Grav		%																																																																																																																																																																																																										
			27.Backlot		%																																																																																																																																																																																																										
			28.Rear Land		%																																																																																																																																																																																																										
			29.Pavement		%																																																																																																																																																																																																										
			Total Acreage		0.36																																																																																																																																																																																																										

Washburn

Map Lot 012-032

Account 836

Location 3 Loretta Lane

Card 1

Of 1

10/16/2019

Building Style 2 Ranch	SF Bsmt Living 0	Layout 1 Typical
1.Conv. 5.Garrison 9.Gambrel	Fin Bsmt Grade 0 0	1.Typical 4. 7.
2.Ranch 6.Salt Box 10.Other	OPEN 5 OPTIONAL 0	2.Inadeq 5. 8.
3.R Ranch 7.Contemp 11.Split	Heat Type 100% 1 Hot Water BB	3.Poor 6. 9.
4.Cape 8.Log 12.	1.HWBB 5.FWA 9.No Heat	Attic 9 None
Dwelling Units 1	2.HWCI 6.GravWA 10.	1.1/4 Fin 4.Full Fin 7.
Other Units 0	3.H Pump 7.Electric 11.	2.1/2 Fin 5.FI/Stair 8.
Stories 1 One Story	4.Steam 8.FI/Wall 12.	3.3/4 Fin 6. 9.None
1.1 4.1.5 7.	Cool Type 0% 9 None	Insulation 1 Full
2.2 5.1.75 8.	1.Refrig 4.W&C Air 7.	1.Full 4.Minimal 7.
3.3 6.2.5 9.	2.Evapor 5. 8.	2.Heavy 5.Partial 8.
Exterior Walls 10 Other	3.H Pump 6. 9.None	3.Capped 6. 9.None
1.Wood 5.Stucco 9.T-111	Kitchen Style 2 Typical	Unfinished % 0%
2.Vin/Al 6.Brick 10.Other	1.Modern 4.Obsolete 7.	Grade & Factor 3 Average 100%
3.Compos. 7.Stone 11.	2.Typical 5. 8.	1.E Grade 4.B Grade 7.
4.Asbestos 8.Concrete 12.	3.Old Type 6. 9.None	2.D Grade 5.A Grade 8.SC Grade
Roof Surface 3 Sheet Metal	Bath(s) Style 2 Typical Bath(s)	3.C Grade 6.AA Grade 9.Same
1.Asphalt 4.Composit 7.	1.Modern 4.Obsolete 7.	SQFT (Footprint) 988
2.Slate 5.Wood 8.	2.Typical 5. 8.	Condition 6 Good
3.Metal 6.Other 9.	3.Old Type 6. 9.None	1.Poor 4.Avg 7.V G
SF Masonry Trim 0	# Rooms 5	2.Fair 5.Avg+ 8.Exc
OPEN-3-CUSTOM 0	# Bedrooms 2	3.Avg- 6.Good 9.Same
OPEN-4-CUSTOM 0	# Full Baths 1	Phys. % Good 0%
Year Built 1961	# Half Baths 0	Funct. % Good 100%
Year Remodeled 0	# Addn Fixtures 0	Functional Code 9 None
Foundation 1 Concrete	# Fireplaces 0	1.Incomp 4.Delap 7.No Power
1.Concrete 4.Wood 7.	 <p>TRIO Software <i>A Division of Harris Computer Systems</i></p>	2.O-Built 5.Bsmt 8.LongTerm
2.C Block 5.Slab 8.		3.Damage 6.Common 9.None
3.Br/Stone 6.Piers 9.		Econ. % Good 100%
Basement 4 Full Basement		Economic Code None
1.1/4 Bmt 4.Full Bmt 7.		0.None 3.No Power 7.
2.1/2 Bmt 5.None 8.		1.Location 4.Generate 8.
3.3/4 Bmt 6. 9.None		2.Encroach 9.None 9.
Bsmt Gar # Cars 0		Entrance Code 1 Interior Inspect
Wet Basement 3 Wet Basement		1.Interior 4.Vacant 7.
1.Dry 4. 7.		2.Refusal 5.Estimate 8.
2.Damp 5. 8.	3.Informed 6.Reviewed 9.	
3.Wet 6. 9.	Information Code 1 Owner	
	1.Owner 4.Agent 7.	
	2.Relative 5.Estimate 8.	
	3.Tenant 6.Other 9.	

Date Inspected 10/27/2018

Additions, Outbuildings & Improvements

Type	Year	Units	Grade	Cond	Phys.	Funct.	Sound Value
21 Open Frame	1970	56	3 100	4	0 %	100 %	
21 Open Frame	1985	80	3 100	4	0 %	100 %	
23 Frame Garage	1985	752	3 100	4	0 %	100 %	
24 Frame Shed	0				%	%	250
					%	%	
					%	%	
					%	%	
					%	%	
					%	%	
					%	%	
					%	%	

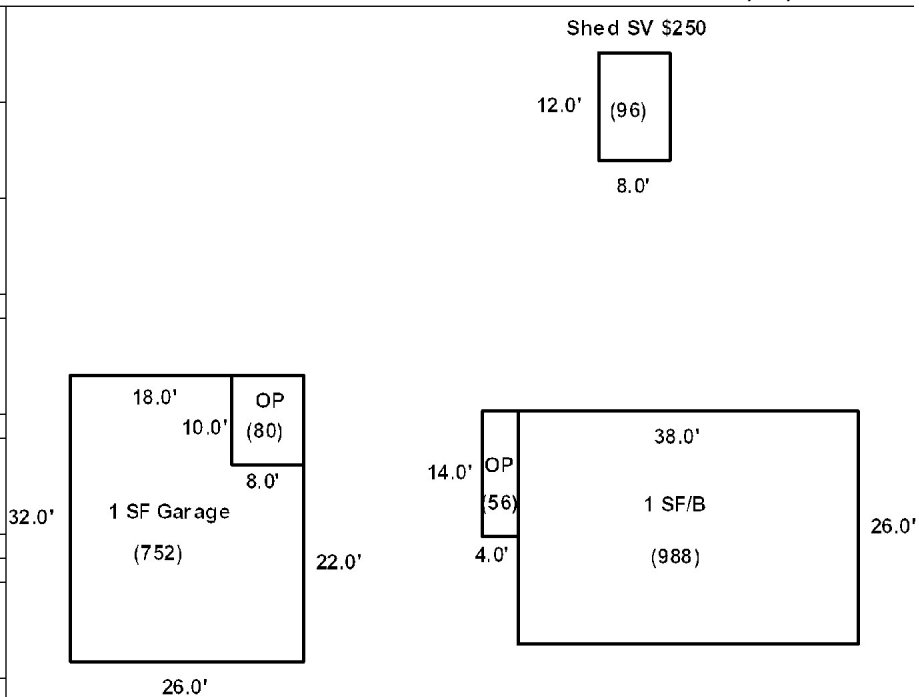

Chandler Family LLC

1634 State Road

Mapleton ME 04757

B3706P302

Property Data

Neighborhood	1 Neighborhood One	
Tree Growth Year	0	
1ST MORTGAGE	0	
2ND MORTGAGE	0	

Assessment Record

Year	Land	Buildings	Exempt	Total
2007	1,500	0	0	1,500
2008	1,500	0	0	1,500
2009	1,500	0	0	1,500
2012	1,500	0	0	1,500
2013	1,900	0	0	1,900
2015	1,900	0	0	1,900
2018	1,900	0	0	1,900
2019	2,200	0	0	2,200

Zone/Land Use	1 Residential	
Secondary Zone		
Topography	1 Level	
1.Level	4.Below St	7.LevelBog
2.Rolling	5.Low	8.
3.Above St	6.Swampy	9.
Utilities		
1.Public	4.Dr Well	7.Cesspool
2.Water	5.Dug Well	8.
3.Sewer	6.Septic	9.None
Street	1 Paved	
1.Paved	4.Proposed	7.
2.Semi Imp	5.R/O/W	8.
3.Gravel	6.	9.None
TG PLAN YEAR	0	
Tif District #	0	

Land Data

Front Foot	Type	Effective		Influence		Influence Codes
		Frontage	Depth	Factor	Code	
11.Regular Lot				%		1.Unimproved
12.Delta Triangle				%		2.Excess Frtg
13.Nabla Triangle				%		3.Topography
14.Rear Land				%		4.Size/Shape
15.Miscellaneous				%		5.Access
				%		6.Restriction
				%		7.Open Space
				%		8.View/Environ
				%		9.Fract Share
				%		30.Utility R O W
				%		31.Tillable
				%		32.Pasture
				%		33.Orchard
				%		34.Softwood F&O
				%		35.Mixed Wood F&O
				%		36.Hardwood F&O
				%		37.Softwood TG
				%		38.Mixed Wood TG
				%		39.Hardwood TG
				%		40.Wasteland
				%		41.Open Space
				%		42.Mobile Home Si
				%		43.Condo Site
				%		44.Lot Improvemen
				%		45.Subdivision Lo
				%		46.Golf Course
Total Acreage		0.06				

Inspection Witnessed By:

No./Date	Description	Date Insp.
X		

Notes:

Washburn

Map Lot 012-034

Account 109

Location Thompson Street

Card 1 Of 1 10/16/2019

Building Style 0	SF Bsmt Living 0	Layout 0
1.Conv. 5.Garrison 9.Gambrel	Fin Bsmt Grade 0 0	1.Typical 4. 7.
2.Ranch 6.Salt Box 10.Other	OPEN 5 OPTIONAL 0	2.Inadeq 5. 8.
3.R Ranch 7.Contemp 11.Split	Heat Type 100% 0	3.Poor 6. 9.
4.Cape 8.Log 12.	1.HWBB 5.FWA 9.No Heat	Attic 0
Dwelling Units 0	2.HWCI 6.GravWA 10.	1.1/4 Fin 4.Full Fin 7.
Other Units 0	3.H Pump 7.Electric 11.	2.1/2 Fin 5.F/Stair 8.
Stories 0	4.Steam 8.F/Wall 12.	3.3/4 Fin 6. 9.None
1.1 4.1.5 7.	Cool Type 0% 9 None	Insulation 0
2.2 5.1.75 8.	1.Refrig 4.W&C Air 7.	1.Full 4.Minimal 7.
3.3 6.2.5 9.	2.Evapor 5. 8.	2.Heavy 5.Partial 8.
Exterior Walls 0	3.H Pump 6. 9.None	3.Capped 6. 9.None
1.Wood 5.Stucco 9.T-111	Kitchen Style 0	Unfinished % 0%
2.Vin/Al 6.Brick 10.Other	1.Modern 4.Obsolete 7.	Grade & Factor 0 0%
3.Compos. 7.Stone 11.	2.Typical 5. 8.	1.E Grade 4.B Grade 7.
4.Asbestos 8.Concrete 12.	3.Old Type 6. 9.None	2.D Grade 5.A Grade 8.SC Grade
Roof Surface 0	Bath(s) Style 0	3.C Grade 6.AA Grade 9.Same
1.Asphalt 4.Composit 7.	1.Modern 4.Obsolete 7.	SQFT (Footprint) 0
2.Slate 5.Wood 8.	2.Typical 5. 8.	Condition 0
3.Metal 6.Other 9.	3.Old Type 6. 9.None	1.Poor 4.Avg 7.V G
SF Masonry Trim 0	# Rooms 0	2.Fair 5.Avg+ 8.Exc
OPEN-3-CUSTOM 0	# Bedrooms 0	3.Avg- 6.Good 9.Same
OPEN-4-CUSTOM 0	# Full Baths 0	Phys. % Good 0%
Year Built 0	# Half Baths 0	Funct. % Good 100%
Year Remodeled 0	# Addn Fixtures 0	Functional Code 9 None
Foundation 0	# Fireplaces 0	1.Incomp 4.Delap 7.No Power
1.Concrete 4.Wood 7.		2.O-Built 5.Bsmt 8.LongTerm
2.C Block 5.Slab 8.		3.Damage 6.Common 9.None
3.Br/Stone 6.Piers 9.		Econ. % Good 100%
Basement 0		Economic Code None
1.1/4 Bmt 4.Full Bmt 7.		0.None 3.No Power 7.
2.1/2 Bmt 5.None 8.		1.Location 4.Generate 8.
3.3/4 Bmt 6. 9.None		2.Encroach 9.None 9.
Bsmt Gar # Cars 0		Entrance Code 0
Wet Basement 0		1.Interior 4.Vacant 7.
1.Dry 4. 7.		2.Refusal 5.Estimate 8.
2.Damp 5. 8.	3.Informed 6.Reviewed 9.	
3.Wet 6. 9.	Information Code 0	
		1.Owner 4.Agent 7.
		2.Relative 5.Estimate 8.
		3.Tenant 6.Other 9.

Date Inspected

Additions, Outbuildings & Improvements								
Type	Year	Units	Grade	Cond	Phys.	Funct.	Sound Value	
					%	%		1.One Story Fram
					%	%		2.Two Story Fram
					%	%		3.Three Story Fr
					%	%		4.1 & 1/2 Story
					%	%		5.1 & 3/4 Story
					%	%		6.2 & 1/2 Story
					%	%		21.Open Frame Por
					%	%		22.Encl Frame Por
					%	%		23.Frame Garage
					%	%		24.Frame Shed
					%	%		25.Frame Bay Wind
					%	%		26.1SFr Overhang
					%	%		27.Unfin Basement
					%	%		28.Unfinished Att
					%	%		29.Finished Attic

TOWN OF WASHBURN

1287 WASHBURN ROAD

WASHBURN ME 04786
B5381P30

Previous Owner
Tompkins, Pauline S.H.
443 Caribou Road #42

Presque Isle ME 04769
Sale Date: 11/24/2014

Inspection Witnessed By:

X	Date	Date Insp.
No./Date	Description	Date Insp.

Notes:

Washburn

Property Data			Assessment Record																																																																																																																																																																																																							
Neighborhood 1 Neighborhood One			Year	Land	Buildings	Exempt	Total																																																																																																																																																																																																			
Tree Growth Year 0			2007	3,200	0	0	3,200																																																																																																																																																																																																			
1ST MORTGAGE 0			2008	3,200	0	0	3,200																																																																																																																																																																																																			
2ND MORTGAGE 0			2009	3,200	0	0	3,200																																																																																																																																																																																																			
Zone/Land Use 1 Residential			2012	3,200	0	0	3,200																																																																																																																																																																																																			
Secondary Zone			2013	4,200	0	0	4,200																																																																																																																																																																																																			
Topography 1 Level			2015	4,200	0	4,200	0																																																																																																																																																																																																			
1.Level 4.Below St 7.LevelBog			2018	4,200	0	4,200	0																																																																																																																																																																																																			
2.Rolling 5.Low 8.			2019	3,400	0	3,400	0																																																																																																																																																																																																			
3.Above St 6.Swampy 9.																																																																																																																																																																																																										
Utilities																																																																																																																																																																																																										
1.Public 4.Dr Well 7.Cesspool																																																																																																																																																																																																										
2.Water 5.Dug Well 8.																																																																																																																																																																																																										
3.Sewer 6.Septic 9.None																																																																																																																																																																																																										
Street 1 Paved																																																																																																																																																																																																										
1.Paved 4.Proposed 7.																																																																																																																																																																																																										
2.Semi Imp 5.R/O/W 8.																																																																																																																																																																																																										
3.Gravel 6. 9.None																																																																																																																																																																																																										
TG PLAN YEAR 0			<table border="1"> <thead> <tr> <th colspan="2">Front Foot</th> <th colspan="2">Effective</th> <th colspan="2">Influence</th> <th rowspan="2">Influence Codes</th> </tr> <tr> <th>Type</th> <th> </th> <th>Frontage</th> <th>Depth</th> <th>Factor</th> <th>Code</th> </tr> </thead> <tbody> <tr> <td>11.Regular Lot</td> <td> </td> <td> </td> <td> </td> <td>%</td> <td> </td> <td>1.Unimproved</td> </tr> <tr> <td>12.Delta Triangle</td> <td> </td> <td> </td> <td> </td> <td>%</td> <td> </td> <td>2.Excess Frtg</td> </tr> <tr> <td>13.Nabla Triangle</td> <td> </td> <td> </td> <td> </td> <td>%</td> <td> </td> <td>3.Topography</td> </tr> <tr> <td>14.Rear Land</td> <td> </td> <td> </td> <td> </td> <td>%</td> <td> </td> <td>4.Size/Shape</td> </tr> <tr> <td>15.Miscellaneous</td> <td> </td> <td> </td> <td> </td> <td>%</td> <td> </td> <td>5.Access</td> </tr> <tr> <td> </td> <td> </td> <td> </td> <td> </td> <td>%</td> <td> </td> <td>6.Restriction</td> </tr> <tr> <td> </td> <td> </td> <td> </td> <td> </td> <td>%</td> <td> </td> <td>7.Open Space</td> </tr> <tr> <td> </td> <td> </td> <td> </td> <td> </td> <td>%</td> <td> </td> <td>8.View/Environ</td> </tr> <tr> <td> </td> <td> </td> <td> </td> <td> </td> <td>%</td> <td> </td> <td>9.Fract Share</td> </tr> <tr> <td> </td> <td> </td> <td> </td> <td> </td> <td>%</td> <td> </td> <td>30.Utility R O W</td> </tr> <tr> <td> </td> <td> </td> <td> </td> <td> </td> <td>%</td> <td> </td> <td>31.Tillable</td> </tr> <tr> <td> </td> <td> </td> <td> </td> <td> </td> <td>%</td> <td> </td> <td>32.Pasture</td> </tr> <tr> <td> </td> <td> </td> <td> </td> <td> </td> <td>%</td> <td> </td> <td>33.Orchard</td> </tr> <tr> <td> </td> <td> </td> <td> </td> <td> </td> <td>%</td> <td> </td> <td>34.Softwood F&O</td> </tr> <tr> <td> </td> <td> </td> <td> </td> <td> </td> <td>%</td> <td> </td> <td>35.Mixed Wood F&O</td> </tr> <tr> <td> </td> <td> </td> <td> </td> <td> </td> <td>%</td> <td> </td> <td>36.Hardwood F&O</td> </tr> <tr> <td> </td> <td> </td> <td> </td> <td> </td> <td>%</td> <td> </td> <td>37.Softwood TG</td> </tr> <tr> <td> </td> <td> </td> <td> </td> <td> </td> <td>%</td> <td> </td> <td>38.Mixed Wood TG</td> </tr> <tr> <td> </td> <td> </td> <td> </td> <td> </td> <td>%</td> <td> </td> <td>39.Hardwood TG</td> </tr> <tr> <td> </td> <td> </td> <td> </td> <td> </td> <td>%</td> <td> </td> <td>40.Wasteland</td> </tr> <tr> <td> </td> <td> </td> <td> </td> <td> </td> <td>%</td> <td> </td> <td>41.Open Space</td> </tr> <tr> <td> </td> <td> </td> <td> </td> <td> </td> <td>%</td> <td> </td> <td>42.Mobile Home Si</td> </tr> <tr> <td> </td> <td> </td> <td> </td> <td> </td> <td>%</td> <td> </td> <td>43.Condo Site</td> </tr> <tr> <td> </td> <td> </td> <td> </td> <td> </td> <td>%</td> <td> </td> <td>44.Lot Improvemen</td> </tr> <tr> <td> </td> <td> </td> <td> </td> <td> </td> <td>%</td> <td> </td> <td>45.Subdivision Lo</td> </tr> <tr> <td> </td> <td> </td> <td> </td> <td> </td> <td>%</td> <td> </td> <td>46.Golf Course</td> </tr> </tbody> </table>					Front Foot		Effective		Influence		Influence Codes	Type		Frontage	Depth	Factor	Code	11.Regular Lot				%		1.Unimproved	12.Delta Triangle				%		2.Excess Frtg	13.Nabla Triangle				%		3.Topography	14.Rear Land				%		4.Size/Shape	15.Miscellaneous				%		5.Access					%		6.Restriction					%		7.Open Space					%		8.View/Environ					%		9.Fract Share					%		30.Utility R O W					%		31.Tillable					%		32.Pasture					%		33.Orchard					%		34.Softwood F&O					%		35.Mixed Wood F&O					%		36.Hardwood F&O					%		37.Softwood TG					%		38.Mixed Wood TG					%		39.Hardwood TG					%		40.Wasteland					%		41.Open Space					%		42.Mobile Home Si					%		43.Condo Site					%		44.Lot Improvemen					%		45.Subdivision Lo					%		46.Golf Course
Front Foot		Effective						Influence		Influence Codes																																																																																																																																																																																																
Type		Frontage	Depth	Factor	Code																																																																																																																																																																																																					
11.Regular Lot				%		1.Unimproved																																																																																																																																																																																																				
12.Delta Triangle				%		2.Excess Frtg																																																																																																																																																																																																				
13.Nabla Triangle				%		3.Topography																																																																																																																																																																																																				
14.Rear Land				%		4.Size/Shape																																																																																																																																																																																																				
15.Miscellaneous				%		5.Access																																																																																																																																																																																																				
				%		6.Restriction																																																																																																																																																																																																				
				%		7.Open Space																																																																																																																																																																																																				
				%		8.View/Environ																																																																																																																																																																																																				
				%		9.Fract Share																																																																																																																																																																																																				
				%		30.Utility R O W																																																																																																																																																																																																				
				%		31.Tillable																																																																																																																																																																																																				
				%		32.Pasture																																																																																																																																																																																																				
				%		33.Orchard																																																																																																																																																																																																				
				%		34.Softwood F&O																																																																																																																																																																																																				
				%		35.Mixed Wood F&O																																																																																																																																																																																																				
				%		36.Hardwood F&O																																																																																																																																																																																																				
				%		37.Softwood TG																																																																																																																																																																																																				
				%		38.Mixed Wood TG																																																																																																																																																																																																				
				%		39.Hardwood TG																																																																																																																																																																																																				
				%		40.Wasteland																																																																																																																																																																																																				
				%		41.Open Space																																																																																																																																																																																																				
				%		42.Mobile Home Si																																																																																																																																																																																																				
				%		43.Condo Site																																																																																																																																																																																																				
				%		44.Lot Improvemen																																																																																																																																																																																																				
				%		45.Subdivision Lo																																																																																																																																																																																																				
				%		46.Golf Course																																																																																																																																																																																																				
Sale Date 11/24/2014			<table border="1"> <thead> <tr> <th colspan="2">Square Foot</th> <th colspan="2">Acres/Sites</th> <th colspan="2">Total Acreage</th> </tr> <tr> <th> </th> <th> </th> <th> </th> <th> </th> <th> </th> <th> </th> </tr> </thead> <tbody> <tr> <td>22</td> <td> </td> <td>0.14</td> <td> </td> <td>0.14</td> <td> </td> </tr> </tbody> </table>					Square Foot		Acres/Sites		Total Acreage								22		0.14		0.14																																																																																																																																																																																		
Square Foot		Acres/Sites		Total Acreage																																																																																																																																																																																																						
22		0.14		0.14																																																																																																																																																																																																						
Price 1,000																																																																																																																																																																																																										
Sale Type 1 Land Only																																																																																																																																																																																																										
1.Land 4.Mobile 7.C/I L&B																																																																																																																																																																																																										
2.L & B 5.Other 8.																																																																																																																																																																																																										
3.Building 6.C/I Land 9.																																																																																																																																																																																																										
Financing																																																																																																																																																																																																										
1.Convent 4.Seller 7.																																																																																																																																																																																																										
2.FHA/VA 5.Private 8.																																																																																																																																																																																																										
3.Assumed 6.Cash 9.Unknown																																																																																																																																																																																																										
Validity 1 Arms Length Sale																																																																																																																																																																																																										
1.Valid 4.Split 7.Renovate																																																																																																																																																																																																										
2.Related 5.Partial 8.Other																																																																																																																																																																																																										
3.Distress 6.Exempt 9.																																																																																																																																																																																																										
Verified 5 Public Record																																																																																																																																																																																																										
1.Buyer 4.Agent 7.Family																																																																																																																																																																																																										
2.Seller 5.Pub Rec 8.Other																																																																																																																																																																																																										
3.Lender 6.MLS 9.																																																																																																																																																																																																										

Washburn

Map Lot 012-037

Account 430

Location THOMPSON STREET

Card 1 Of 1 10/16/2019

Building Style 0	SF Bsmt Living 0	Layout 0
1.Conv. 5.Garrison 9.Gambrel	Fin Bsmt Grade 0 0	1.Typical 4. 7.
2.Ranch 6.Salt Box 10.Other	OPEN 5 OPTIONAL 0	2.Inadeq 5. 8.
3.R Ranch 7.Contemp 11.Split	Heat Type 100% 0	3.Poor 6. 9.
4.Cape 8.Log 12.	1.HWBB 5.FWA 9.No Heat	Attic 0
Dwelling Units 0	2.HWCI 6.GravWA 10.	1.1/4 Fin 4.Full Fin 7.
Other Units 0	3.H Pump 7.Electric 11.	2.1/2 Fin 5.FI/Stair 8.
Stories 0	4.Steam 8.FI/Wall 12.	3.3/4 Fin 6. 9.None
1.1 4.1.5 7.	Cool Type 0% 9 None	Insulation 0
2.2 5.1.75 8.	1.Refrig 4.W&C Air 7.	1.Full 4.Minimal 7.
3.3 6.2.5 9.	2.Evapor 5. 8.	2.Heavy 5.Partial 8.
Exterior Walls 0	3.H Pump 6. 9.None	3.Capped 6. 9.None
1.Wood 5.Stucco 9.T-111	Kitchen Style 0	Unfinished % 0%
2.Vin/Al 6.Brick 10.Other	1.Modern 4.Obsolete 7.	Grade & Factor 0 0%
3.Compos. 7.Stone 11.	2.Typical 5. 8.	1.E Grade 4.B Grade 7.
4.Asbestos 8.Concrete 12.	3.Old Type 6. 9.None	2.D Grade 5.A Grade 8.SC Grade
Roof Surface 0	Bath(s) Style 0	3.C Grade 6.AA Grade 9.Same
1.Asphalt 4.Composit 7.	1.Modern 4.Obsolete 7.	SQFT (Footprint) 0
2.Slate 5.Wood 8.	2.Typical 5. 8.	Condition 0
3.Metal 6.Other 9.	3.Old Type 6. 9.None	1.Poor 4.Avg 7.V G
SF Masonry Trim 0	# Rooms 0	2.Fair 5.Avg+ 8.Exc
OPEN-3-CUSTOM 0	# Bedrooms 0	3.Avg- 6.Good 9.Same
OPEN-4-CUSTOM 0	# Full Baths 0	Phys. % Good 0%
Year Built 0	# Half Baths 0	Funct. % Good 100%
Year Remodeled 0	# Addn Fixtures 0	Functional Code 9 None
Foundation 0	# Fireplaces 0	1.Incomp 4.Delap 7.No Power
1.Concrete 4.Wood 7.		2.O-Built 5.Bsmt 8.LongTerm
2.C Block 5.Slab 8.		3.Damage 6.Common 9.None
3.Br/Stone 6.Piers 9.		Econ. % Good 100%
Basement 0		Economic Code None
1.1/4 Bmt 4.Full Bmt 7.		0.None 3.No Power 7.
2.1/2 Bmt 5.None 8.		1.Location 4.Generate 8.
3.3/4 Bmt 6. 9.None		2.Encroach 9.None 9.
Bsmt Gar # Cars 0		Entrance Code 0
Wet Basement 0		1.Interior 4.Vacant 7.
1.Dry 4. 7.		2.Refusal 5.Estimate 8.
2.Damp 5. 8.	3.Informed 6.Reviewed 9.	
3.Wet 6. 9.	Information Code 0	
	1.Owner 4.Agent 7.	
	2.Relative 5.Estimate 8.	
	3.Tenant 6.Other 9.	

Date Inspected

Additions, Outbuildings & Improvements

Type	Year	Units	Grade	Cond	Phys.	Funct.	Sound Value
					%	%	1.One Story Fram
					%	%	2.Two Story Fram
					%	%	3.Three Story Fr
					%	%	4.1 & 1/2 Story
					%	%	5.1 & 3/4 Story
					%	%	6.2 & 1/2 Story
					%	%	21.Open Frame Por
					%	%	22.Encl Frame Por
					%	%	23.Frame Garage
					%	%	24.Frame Shed
					%	%	25.Frame Bay Wind
					%	%	26.1SFr Overhang
					%	%	27.Unfin Basement
					%	%	28.Unfinished Att
					%	%	29.Finished Attic

Washburn

Map Lot 012-038

Account 870

Location 13 Thompson Street

Card 1 Of 1 10/16/2019

Building Style	2 Ranch		SF Bsmt Living	0		Layout	1 Typical							
1.Conv.	5.Garrison	9.Gambrel	Fin Bsmt Grade	0 0		1.Typical	4.	7.						
2.Ranch	6.Salt Box	10.Other	OPEN 5 OPTIONAL	0		2.Inadeq	5.	8.						
3.R Ranch	7.Contemp	11.Split	Heat Type	100% 1 Hot Water BB		3.Poor	6.	9.						
4.Cape	8.Log	12.	1.HWB	5.FWA	9.No Heat	Attic 9 None								
Dwelling Units	1		2.HWCI	6.GravWA	10.	1.1/4 Fin	4.Full Fin	7.						
Other Units	0		3.H Pump	7.Electric	11.	2.1/2 Fin	5.F/ Stair	8.						
Stories	1 One Story		4.Steam	8.F/ Wall	12.	3.3/4 Fin	6.	9.None						
1.1	4.1.5	7.	Cool Type	0% 9 None		Insulation 1 Full								
2.2	5.1.75	8.	1.Refrig	4.W&C Air	7.	1.Full	4.Minimal	7.						
3.3	6.2.5	9.	2.Evapor	5.	8.	2.Heavy	5.Partial	8.						
Exterior Walls	2 Vinyl/Aluminum		3.H Pump	6.	9.None	3.Capped	6.	9.None						
1.Wood	5.Stucco	9.T-111	Kitchen Style	2 Typical		Unfinished % 0%								
2.Vin/Al	6.Brick	10.Other	1.Modern	4.Obsolete	7.	Grade & Factor 3 Average 105%								
3.Compos.	7.Stone	11.	2.Typical	5.	8.	1.E Grade	4.B Grade	7.						
4.Asbestos	8.Concrete	12.	3.Old Type	6.	9.None	2.D Grade	5.A Grade	8.SC Grade						
Roof Surface	3 Sheet Metal		Bath(s) Style	2 Typical Bath(s)		3.C Grade	6.AA Grade	9.Same						
1.Asphalt	4.Composit	7.	1.Modern	4.Obsolete	7.	SQFT (Footprint) 988								
2.Slate	5.Wood	8.	2.Typical	5.	8.	Condition 5 Above Average								
3.Metal	6.Other	9.	3.Old Type	6.	9.None	1.Poor	4.Avg	7.V G						
SF Masonry Trim	0		# Rooms	4		2.Fair	5.Avg+	8.Exc						
OPEN-3-CUSTOM	0		# Bedrooms	2		3.Avg-	6.Good	9.Same						
OPEN-4-CUSTOM	0		# Full Baths	1		Phys. % Good 0%								
Year Built	1972		# Half Baths	0		Funct. % Good 100%								
Year Remodeled	0		# Addn Fixtures	0		Functional Code 9 None								
Foundation	1 Concrete		# Fireplaces	0		1.Incomp	4.Delap	7.No Power						
1.Concrete	4.Wood	7.							2.O-Built	5.Bsmt	8.LongTerm			
2.C Block	5.Slab	8.							Economic Code None			1.Location	4.Generate	8.
3.Br/Stone	6.Piers	9.							0.None			2.Encroach	9.None	9.
Basement	4 Full Basement								Entrance Code 1 Interior Inspect			3.Damage	6.Common	9.None
1.1/4 Bmt	4.Full Bmt	7.							1.Interior			4.Vacant	7.	
2.1/2 Bmt	5.None	8.							2.Refusal			5.Estimate	8.	
3.3/4 Bmt	6.	9.None							3.Informed			6.Reviewed	9.	
Bsmt Gar # Cars	1								Information Code 1 Owner			1.Owner	4.Agent	7.
Wet Basement	1 Dry Basement								2.Relative			5.Estimate	8.	
1.Dry	4.	7.							3.Tenant			6.Other	9.	
2.Damp	5.	8.												
3.Wet	6.	9.												

Date Inspected 10/27/2018

Additions, Outbuildings & Improvements

Type	Year	Units	Grade	Cond	Phys.	Funct.	Sound Value	
22 Encl Frame Porch	1972	128	3 100	5	0 %	100 %		1.One Story Fram
24 Frame Shed	1985	240	3 100	3	0 %	100 %		2.Two Story Fram
21 Open Frame	1985	60	3 95	4	0 %	100 %		3.Three Story Fr
					%	%		4.1 & 1/2 Story
					%	%		5.1 & 3/4 Story
					%	%		6.2 & 1/2 Story
					%	%		21.Open Frame Por
					%	%		22.Encl Frame Por
					%	%		23.Frame Garage
					%	%		24.Frame Shed
					%	%		25.Frame Bay Wind
					%	%		26.1SFr Overhang
					%	%		27.Unfin Basement
					%	%		28.Unfinished Att
					%	%		29.Finished Attic

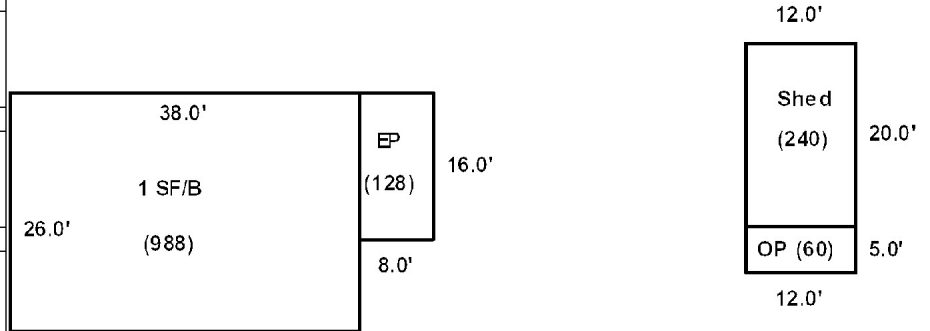

NADEAU, NICHOLAS J.
NADEAU, JESSICA L.
P.O. BOX 22

WASHBURN ME 04786
B4767P180 B4767P182

Previous Owner
Humphrey, E/O Keith & Mary
c/o Sharon E. Humphrey-Mason
84 Blue Hill West
Bangor ME 04401
Sale Date: 11/06/2009

Inspection Witnessed By:

X	Date	Date Insp.
No./Date	Description	Date Insp.

Notes:
*1-28-2019 -10% for attached garage.

Washburn

Property Data			Assessment Record						
Neighborhood 1 Neighborhood One			Year	Land	Buildings	Exempt	Total		
Tree Growth Year 0			2007	3,700	51,300	0	55,000		
1ST MORTGAGE 0			2008	3,700	51,300	0	55,000		
2ND MORTGAGE 0			2009	3,700	51,300	0	55,000		
Zone/Land Use 1 Residential			2012	3,700	51,300	8,800	46,200		
Secondary Zone			2013	4,800	51,300	8,800	47,300		
Topography 1 Level			2015	4,800	51,300	9,000	47,100		
1.Level 4.Below St 7.LevelBog			2018	4,800	51,300	18,400	37,700		
2.Rolling 5.Low 8.			2019	7,700	54,100	20,000	41,800		
3.Above St 6.Swampy 9.									
Utilities 2 Public Water 3 Public Sewer									
1.Public 4.Dr Well 7.Cesspool									
2.Water 5.Dug Well 8.									
3.Sewer 6.Septic 9.None									
Street 1 Paved									
1.Paved 4.Proposed 7.			Land Data						
2.Semi Imp 5.R/O/W 8.									
3.Gravel 6. 9.None			Front Foot	Type	Effective		Influence		Influence Codes
TG PLAN YEAR 0			11.Regular Lot		Frontage	Depth	Factor	Code	
Tif District # 0			12.Delta Triangle				%		1.Unimproved
Sale Data			13.Nabla Triangle				%		2.Excess Frtg
Sale Date 11/06/2009			14.Rear Land				%		3.Topography
Price 79,500			15.Miscellaneous				%		4.Size/Shape
Sale Type 2 Land & Buildings							%		5.Access
1.Land 4.Mobile 7.C/I L&B							%		6.Restriction
2.L & B 5.Other 8.			Square Foot	Square Feet					7.Open Space
3.Building 6.C/I Land 9.			16.Regular Lot				%		8.View/Environ
Financing 1 Conventional			17.Municipal Rese				%		9.Fract Share
1.Convent 4.Seller 7.			18.Munic Sep Lago				%		Acres
2.FHA/VA 5.Private 8.			19.Gravel Pit				%		30.Utility R O W
3.Assumed 6.Cash 9.Unknown			20.Industrial Bas				%		31.Tillable
Validity 1 Arms Length Sale							%		32.Pasture
1.Valid 4.Split 7.Renovate			Fract. Acre	Acreege/Sites					33.Orchard
2.Related 5.Partial 8.Other			21.Developed Pave	21	0.22	100	%	0	34.Softwood F&O
3.Distress 6.Exempt 9.			22.Undev Paved (F				%		35.Mixed Wood F&O
Verified 5 Public Record			23.Developed Grav				%		36.Hardwood F&O
1.Buyer 4.Agent 7.Family			Acres				%		37.Softwood TG
2.Seller 5.Pub Rec 8.Other			24.Undev Gravel (%		38.Mixed Wood TG
3.Lender 6.MLS 9.			25.Comm Base Pave				%		39.Hardwood TG
			26.Comm Base Grav				%		40.Wasteland
			27.Backlot				%		41.Open Space
			28.Rear Land				%		42.Mobile Home Si
			29.Pavement				%		43.Condo Site
			Total Acreage		0.22				44.Lot Improvemen
									45.Subdivision Lo
									46.Golf Course

Washburn

Map Lot 012-040

Account 520

Location 7 THOMPSON STREET

Card 1 Of 1 10/16/2019

Building Style	2 Ranch			SF Bsmt Living	0			Layout	1 Typical		
1.Conv.	5.Garrison	9.Gambrel		Fin Bsmt Grade	0 0			1.Typical	4.	7.	
2.Ranch	6.Salt Box	10.Other		OPEN 5 OPTIONAL	0			2.Inadeq	5.	8.	
3.R Ranch	7.Contemp	11.Split		Heat Type	100% 5 Forced Warm Air			3.Poor	6.	9.	
4.Cape	8.Log	12.		1.HWBB	5.FWA	9.No Heat	Attic	9 None			
Dwelling Units	1			2.HWCI	6.GravWA	10.	1.1/4 Fin	4.Full Fin	7.		
Other Units	0			3.H Pump	7.Electric	11.	2.1/2 Fin	5.F/Stair	8.		
Stories	1 One Story			4.Steam	8.F/Wall	12.	3.3/4 Fin	6.	9.None		
1.1	4.1.5	7.		Cool Type	0% 9 None			Insulation	1 Full		
2.2	5.1.75	8.		1.Refrig	4.W&C Air	7.	1.Full	4.Minimal	7.		
3.3	6.2.5	9.		2.Evapor	5.	8.	2.Heavy	5.Partial	8.		
Exterior Walls	1 Wood Siding			3.H Pump	6.	9.None	3.Capped	6.	9.None		
1.Wood	5.Stucco	9.T-111		Kitchen Style	2 Typical			Unfinished %	0%		
2.Vin/Al	6.Brick	10.Other		1.Modern	4.Obsolete	7.	Grade & Factor	3 Average 105%			
3.Compos.	7.Stone	11.		2.Typical	5.	8.	1.E Grade	4.B Grade	7.		
4.Asbestos	8.Concrete	12.		3.Old Type	6.	9.None	2.D Grade	5.A Grade	8.SC Grade		
Roof Surface	3 Sheet Metal			Bath(s) Style	2 Typical Bath(s)			3.C Grade	6.AA Grade	9.Same	
1.Asphalt	4.Composit	7.		1.Modern	4.Obsolete	7.	SQFT (Footprint)	1000			
2.Slate	5.Wood	8.		2.Typical	5.	8.	Condition	6 Good			
3.Metal	6.Other	9.		3.Old Type	6.	9.None	1.Poor	4.Avg	7.V G		
SF Masonry Trim	0			# Rooms	5			2.Fair	5.Avg+	8.Exc	
OPEN-3-CUSTOM	0			# Bedrooms	3			3.Avg-	6.Good	9.Same	
OPEN-4-CUSTOM	0			# Full Baths	1			Phys. % Good	0%		
Year Built	1960			# Half Baths	0			Funct. % Good	100%		
Year Remodeled	0			# Addn Fixtures	0			Functional Code	9 None		
Foundation	1 Concrete			# Fireplaces	0			1.Incomp	4.Delap	7.No Power	
1.Concrete	4.Wood	7.									
2.C Block	5.Slab	8.									
3.Br/Stone	6.Piers	9.									
Basement	4 Full Basement										
1.1/4 Bmt	4.Full Bmt	7.									
2.1/2 Bmt	5.None	8.									
3.3/4 Bmt	6.	9.None									
Bsmt Gar # Cars	0										
Wet Basement	2 Damp Basement										
1.Dry	4.	7.									
2.Damp	5.	8.									
3.Wet	6.	9.									
								Econ. % Good	100%		
								Economic Code	None		
								0.None	3.No Power	7.	
								1.Location	4.Generate	8.	
								2.Encroach	9.None	9.	
								Entrance Code	3 Information Only		
								1.Interior	4.Vacant	7.	
								2.Refusal	5.Estimate	8.	
								3.Informed	6.Reviewed	9.	
								Information Code	1 Owner		
								1.Owner	4.Agent	7.	
								2.Relative	5.Estimate	8.	
								3.Tenant	6.Other	9.	

Date Inspected 10/27/2018

Additions, Outbuildings & Improvements

Type	Year	Units	Grade	Cond	Phys.	Funct.	Sound Value
23 Frame Garage	1960	432	3 100	4	0 %	90 %	
					%	%	
					%	%	
					%	%	
					%	%	
					%	%	
					%	%	
					%	%	
					%	%	
					%	%	
					%	%	

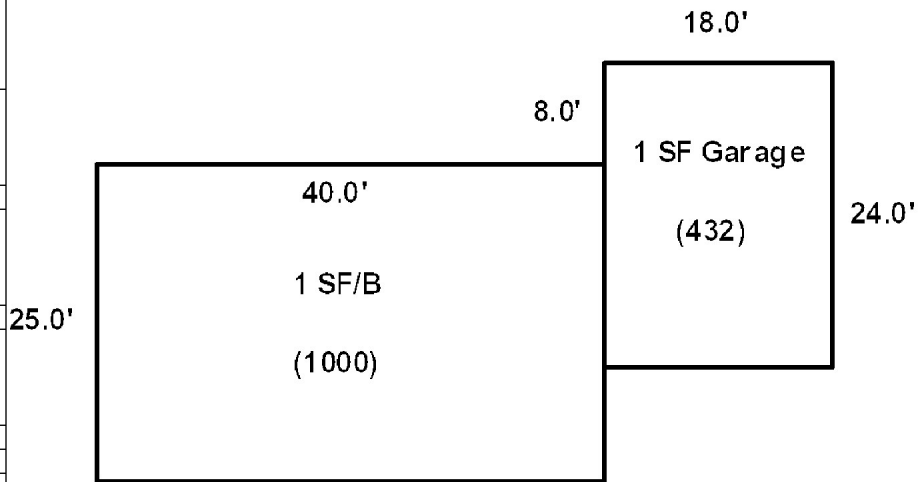

Washburn

Map Lot 012-041

Account 498

Location 1232 MAIN STREET

Card 1 Of 1 10/16/2019

Building Style 1 Conventional	SF Bsmt Living 0	Layout 1 Typical
1.Conv. 5.Garrison 9.Gambrel	Fin Bsmt Grade 0 0	1.Typical 4. 7.
2.Ranch 6.Salt Box 10.Other	OPEN 5 OPTIONAL 0	2.Inadeq 5. 8.
3.R Ranch 7.Contemp 11.Split	Heat Type 100% 5 Forced Warm Air	3.Poor 6. 9.
4.Cape 8.Log 12.	1.HWBB 5.FWA 9.No Heat	Attic 9 None
Dwelling Units 1	2.HWCI 6.GravWA 10.	1.1/4 Fin 4.Full Fin 7.
Other Units 0	3.H Pump 7.Electric 11.	2.1/2 Fin 5.FI/Stair 8.
Stories 2 Two Story	4.Steam 8.FI/Wall 12.	3.3/4 Fin 6. 9.None
1.1 4.1.5 7.	Cool Type 0% 9 None	Insulation 4 Minimal
2.2 5.1.75 8.	1.Refrig 4.W&C Air 7.	1.Full 4.Minimal 7.
3.3 6.2.5 9.	2.Evapor 5. 8.	2.Heavy 5.Partial 8.
Exterior Walls 2 Vinyl/Aluminum	3.H Pump 6. 9.None	3.Capped 6. 9.None
1.Wood 5.Stucco 9.T-111	Kitchen Style 2 Typical	Unfinished % 0%
2.Vin/Al 6.Brick 10.Other	1.Modern 4.Obsolete 7.	Grade & Factor 2 Fair 115%
3.Compos. 7.Stone 11.	2.Typical 5. 8.	1.E Grade 4.B Grade 7.
4.Asbestos 8.Concrete 12.	3.Old Type 6. 9.None	2.D Grade 5.A Grade 8.SC Grade
Roof Surface 1 Asphalt Shingles	Bath(s) Style 2 Typical Bath(s)	3.C Grade 6.AA Grade 9.Same
1.Asphalt 4.Composit 7.	1.Modern 4.Obsolete 7.	SQFT (Footprint) 728
2.Slate 5.Wood 8.	2.Typical 5. 8.	Condition 6 Good
3.Metal 6.Other 9.	3.Old Type 6. 9.None	1.Poor 4.Avg 7.V G
SF Masonry Trim 0	# Rooms 5	2.Fair 5.Avg+ 8.Exc
OPEN-3-CUSTOM 0	# Bedrooms 3	3.Avg- 6.Good 9.Same
OPEN-4-CUSTOM 0	# Full Baths 2	Phys. % Good 0%
Year Built 1900	# Half Baths 0	Funct. % Good 100%
Year Remodeled 0	# Addn Fixtures 0	Functional Code 9 None
Foundation 1 Concrete	# Fireplaces 0	1.Incomp 4.Delap 7.No Power
1.Concrete 4.Wood 7.		2.O-Built 5.Bsmt 8.LongTerm
2.C Block 5.Slab 8.		3.Damage 6.Common 9.None
3.Br/Stone 6.Piers 9.		Econ. % Good 100%
Basement 4 Full Basement		Economic Code None
1.1/4 Bmt 4.Full Bmt 7.		0.None 3.No Power 7.
2.1/2 Bmt 5.None 8.		1.Location 4.Generate 8.
3.3/4 Bmt 6. 9.None		2.Encroach 9.None 9.
Bsmt Gar # Cars 0		Entrance Code 1 Interior Inspect
Wet Basement 1 Dry Basement		1.Interior 4.Vacant 7.
1.Dry 4. 7.		2.Refusal 5.Estimate 8.
2.Damp 5. 8.	3.Informed 6.Reviewed 9.	
3.Wet 6. 9.	Information Code 1 Owner	
	1.Owner 4.Agent 7.	
	2.Relative 5.Estimate 8.	
	3.Tenant 6.Other 9.	

Date Inspected 10/27/2018

Additions, Outbuildings & Improvements

Type	Year	Units	Grade	Cond	Phys.	Funct.	Sound Value
25 Frame Bay	1900	16	9 100	9	0 %	100 %	
68 Wood Deck	2000	168	3 100	4	0 %	100 %	
21 Open Frame	1970	16	3 100	5	0 %	100 %	
23 Frame Garage	1970	380	3 100	5	0 %	90 %	
24 Frame Shed	0				%	%	150
					%	%	
					%	%	
					%	%	
					%	%	
					%	%	
					%	%	
					%	%	
					%	%	

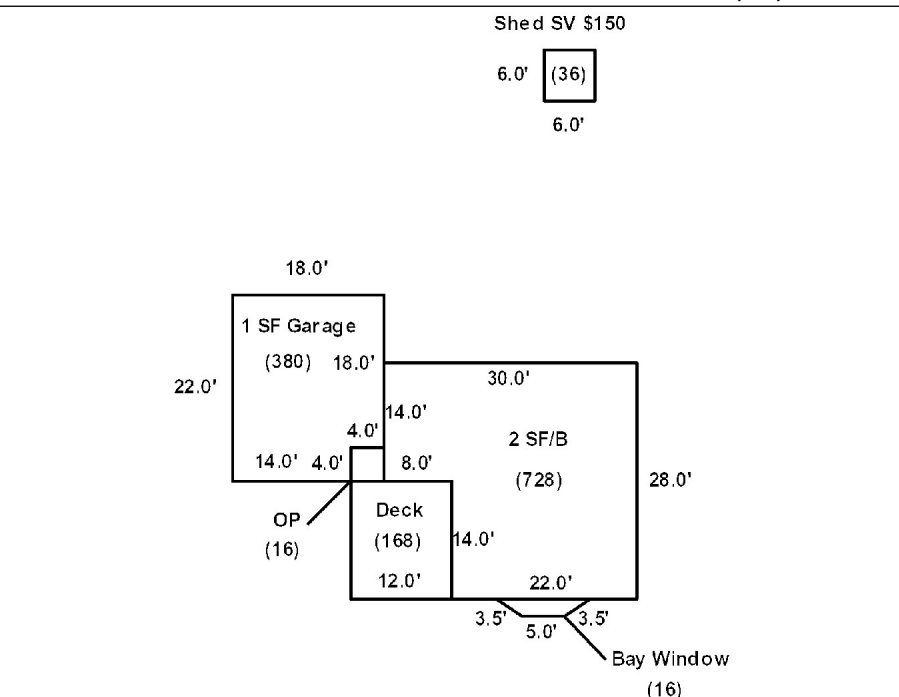

Washburn

Map Lot 012-042

Account 881

Location 1236 Main Street

Card 1 Of 1 10/16/2019

Building Style	4 Cape Cod	SF Bsmt Living	0	Layout	1 Typical	
1.Conv.	5.Garrison	9.Gambrel	Fin Bsmt Grade	0 0	1.Typical	
2.Ranch	6.Salt Box	10.Other	OPEN 5 OPTIONAL	0	2.Inadeq	
3.R Ranch	7.Contemp	11.Split	Heat Type	100%	3.Pool	
4.Cape	8.Log	12.	1.HWBB	5.FWA	9.No Heat	
Dwelling Units	1	2.HWCI	6.GravWA	10.	Attic	
Other Units	0	3.H Pump	7.Electric	11.	1.1/4 Fin	
Stories	4 One & 1/2 Story	4.Steam	8.Fi/Wall	12.	4.Full Fin	
1.1	4.1.5	7.	Cool Type	100%	3 Heat Pump	
2.2	5.1.75	8.	1.Refrig	4.W&C Air	7.	
3.3	6.2.5	9.	2.Evapor	5.	8.	
Exterior Walls	2 Vinyl/Aluminum	3.H Pump	6.	9.None	Insulation	
1.Wood	5.Stucco	9.T-111	Kitchen Style	2 Typical	1.Full	
2.Vin/Al	6.Brick	10.Other	1.Modern	4.Obsolete	7.	
3.Compos.	7.Stone	11.	2.Typical	5.	8.	
4.Asbestos	8.Concrete	12.	3.Old Type	6.	9.None	
Roof Surface	3 Sheet Metal	Bath(s) Style	2 Typical Bath(s)	1.Modern	4.Obsolete	
1.Asphalt	4.Composit	7.	1.Modern	4.Obsolete	7.	
2.Slate	5.Wood	8.	2.Typical	5.	8.	
3.Metal	6.Other	9.	3.Old Type	6.	9.None	
SF Masonry Trim	0	# Rooms	7	Unfinished %	0%	
OPEN-3-CUSTOM	0	# Bedrooms	3	Grade & Factor	3 Average 90%	
OPEN-4-CUSTOM	0	# Full Baths	2	1.E Grade	4.B Grade	
Year Built	1900	# Half Baths	0	2.D Grade	5.A Grade	
Year Remodeled	1990	# Addn Fixtures	0	3.C Grade	6.AA Grade	
Foundation	1 Concrete	# Fireplaces	0	SQFT (Footprint) 1048		
1.Concrete	4.Wood	7.	Condition	6 Good	1.Poor	
2.C Block	5.Slab	8.	2.Fair	4.Avg	7.V G	
3.Br/Stone	6.Piers	9.	3.Avg-	5.Avg+	8.Exc	
Basement	4 Full Basement	 <p>TRIO Software <small>A Division of Harris Computer Systems</small></p>		Phys. % Good	0%	
1.1/4 Bmt	4.Full Bmt			7.	Funct. % Good	100%
2.1/2 Bmt	5.None			8.	Functional Code	9 None
3.3/4 Bmt	6.			9.None	1.Incomp	4.Delap
Bsmt Gar # Cars	0			Economic Code		None
Wet Basement	3 Wet Basement			0.None		3.No Power
1.Dry	4.			7.	1.Location	4.Generate
2.Damp	5.			8.	2.Encroach	9.None
3.Wet	6.			9.	Entrance Code	5 Estimated
					1.Interior	4.Vacant
			2.Refusal	5.Estimate		
			3.Informed	6.Reviewed		
			Information Code	5 Estimate		
			1.Owner	4.Agent		
			2.Relative	5.Estimate		
			3.Tenant	6.Other		

Date Inspected 10/27/2018

Additions, Outbuildings & Improvements

Type	Year	Units	Grade	Cond	Phys.	Funct.	Sound Value
21 Open Frame	1950	24	3 100	4	0 %	100 %	
22 Encl Frame Porch	1950	120	3 105	4	0 %	100 %	
68 Wood Deck	2000	496	3 100	4	0 %	100 %	
78 3/4S-Ad/Gar	1900	952	3 95	6	0 %	90 %	
					%	%	
					%	%	
					%	%	
					%	%	
					%	%	
					%	%	
					%	%	

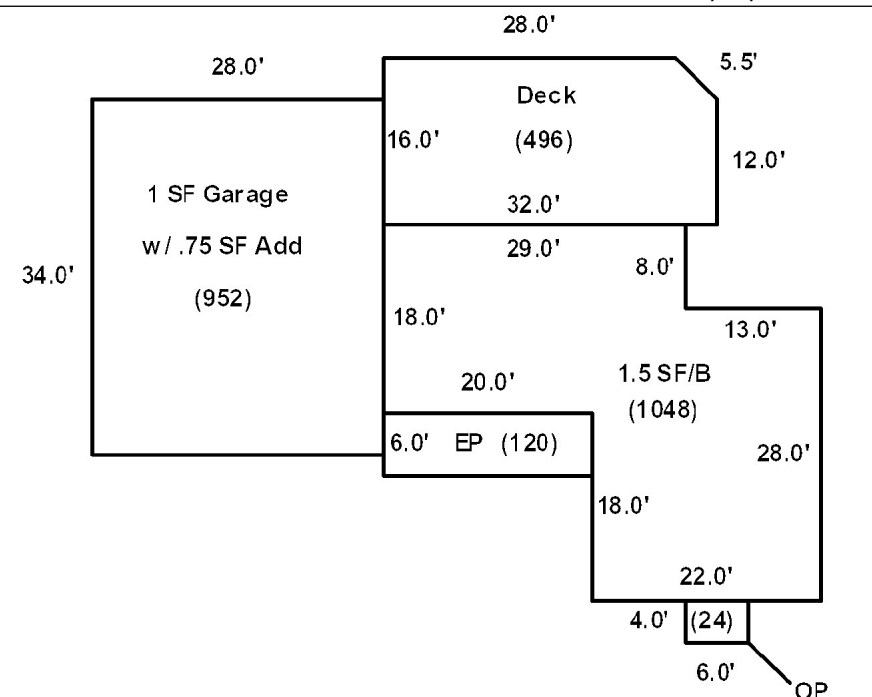

Washburn

Map Lot 012-043

Account 746

Location 1240 Main Street - McKay

Card 1 Of 1 10/16/2019

Building Style 0	SF Bsmt Living 0	Layout 0			
1.Conv. 5.Garrison 9.Gambrel	Fin Bsmt Grade 0 0	1.Typical 4. 7.			
2.Ranch 6.Salt Box 10.Other	OPEN 5 OPTIONAL 0	2.Inadeq 5. 8.			
3.R Ranch 7.Contemp 11.Split	Heat Type 100% 0	3.Poor 6. 9.			
4.Cape 8.Log 12.	1.HWBB 5.FWA 9.No Heat	Attic 0			
Dwelling Units 0	2.HWCI 6.GravWA 10.	1.1/4 Fin 4.Full Fin 7.			
Other Units 0	3.H Pump 7.Electric 11.	2.1/2 Fin 5.F/Stair 8.			
Stories 0	4.Steam 8.F/Wall 12.	3.3/4 Fin 6. 9.None			
1.1 4.1.5 7.	Cool Type 0% 9 None	Insulation 0			
2.2 5.1.75 8.	1.Refrig 4.W&C Air 7.	1.Full 4.Minimal 7.			
3.3 6.2.5 9.	2.Evapor 5. 8.	2.Heavy 5.Partial 8.			
Exterior Walls 0	3.H Pump 6. 9.None	3.Capped 6. 9.None			
1.Wood 5.Stucco 9.T-111	Kitchen Style 0	Unfinished % 0%			
2.Vin/Al 6.Brick 10.Other	1.Modern 4.Obsolete 7.	Grade & Factor 0 0%			
3.Compos. 7.Stone 11.	2.Typical 5. 8.	1.E Grade 4.B Grade 7.			
4.Asbestos 8.Concrete 12.	3.Old Type 6. 9.None	2.D Grade 5.A Grade 8.SC Grade			
Roof Surface 0	Bath(s) Style 0	3.C Grade 6.AA Grade 9.Same			
1.Asphalt 4.Composit 7.	1.Modern 4.Obsolete 7.	SQFT (Footprint) 0			
2.Slate 5.Wood 8.	2.Typical 5. 8.	Condition 0			
3.Metal 6.Other 9.	3.Old Type 6. 9.None	1.Poor 4.Avg 7.V G			
SF Masonry Trim 0	# Rooms 0	2.Fair 5.Avg+ 8.Exc			
OPEN-3-CUSTOM 0	# Bedrooms 0	3.Avg- 6.Good 9.Same			
OPEN-4-CUSTOM 0	# Full Baths 0	Phys. % Good 0%			
Year Built 0	# Half Baths 0	Funct. % Good 100%			
Year Remodeled 0	# Addn Fixtures 0	Functional Code 9 None			
Foundation 0	# Fireplaces 0	1.Incomp 4.Delap 7.No Power			
1.Concrete 4.Wood 7.		2.O-Built 5.Bsmt 8.LongTerm			
2.C Block 5.Slab 8.		3.Damage 6.Common 9.None			
3.Br/Stone 6.Piers 9.		Econ. % Good 100%			
Basement 0		Economic Code None			
1.1/4 Bmt 4.Full Bmt 7.		0.None 3.No Power 7.			
2.1/2 Bmt 5.None 8.		1.Location 4.Generate 8.			
3.3/4 Bmt 6. 9.None		2.Encroach 9.None 9.			
Bsmt Gar # Cars 0		Entrance Code 0			
Wet Basement 0		1.Interior 4.Vacant 7.			
1.Dry 4. 7.		2.Refusal 5.Estimate 8.			
2.Damp 5. 8.		3.Informed 6.Reviewed 9.			
3.Wet 6. 9.		Information Code 0			
		1.Owner 4.Agent 7.			
		2.Relative 5.Estimate 8.			
		3.Tenant 6.Other 9.			



Date Inspected

Additions, Outbuildings & Improvements							
Type	Year	Units	Grade	Cond	Phys.	Funct.	Sound Value
					%	%	1.One Story Fram
					%	%	2.Two Story Fram
					%	%	3.Three Story Fr
					%	%	4.1 & 1/2 Story
					%	%	5.1 & 3/4 Story
					%	%	6.2 & 1/2 Story
					%	%	21.Open Frame Por
					%	%	22.Encl Frame Por
					%	%	23.Frame Garage
					%	%	24.Frame Shed
					%	%	25.Frame Bay Wind
					%	%	26.1SFr Overhang
					%	%	27.Unfin Basement
					%	%	28.Unfinished Att
					%	%	29.Finished Attic

SPERREY, RODNEY R.
SPERREY, CHERYL M.
P.O. BOX 284

WASHBURN ME 04786
B1941P39 B5144P147

Inspection Witnessed By:

X	Date	Date Insp.
No./Date	Description	Date Insp.

Notes:
*5-10-2019 -5% for attached 1.75 SF Barn and -50% for delap.

Washburn

Property Data			Assessment Record						
Neighborhood 1 Neighborhood One			Year	Land	Buildings	Exempt	Total		
Tree Growth Year 0			2007	9,500	42,400	13,000	38,900		
1ST MORTGAGE 0			2008	9,500	42,400	13,000	38,900		
2ND MORTGAGE 0			2009	9,500	42,400	9,000	42,900		
Zone/Land Use 1 Residential			2012	9,500	42,400	8,800	43,100		
Secondary Zone			2013	9,500	42,400	8,800	43,100		
Topography 1 Level			2015	9,500	42,400	9,000	42,900		
1.Level 4.Below St 7.LevelBog 2.Rolling 5.Low 8. 3.Above St 6.Swampy 9.			2018	9,500	42,400	18,400	33,500		
Utilities 2 Public Water 3 Public Sewer			2019	16,900	69,000	20,000	65,900		
1.Public 4.Dr Well 7.Cesspool 2.Water 5.Dug Well 8. 3.Sewer 6.Septic 9.None									
Street 1 Paved									
1.Paved 4.Proposed 7. 2.Semi Imp 5.R/O/W 8. 3.Gravel 6. 9.None									
TG PLAN YEAR 0			Land Data						
Tif District # 0			Front Foot	Type	Effective		Influence		Influence Codes 1.Unimproved 2.Excess Frtg 3.Topography 4.Size/Shape 5.Access 6.Restriction 7.Open Space 8.View/Environ 9.Fract Share Acres 30.Utility R O W 31.Tillable 32.Pasture 33.Orchard 34.Softwood F&O 35.Mixed Wood F&O 36.Hardwood F&O 37.Softwood TG 38.Mixed Wood TG 39.Hardwood TG 40.Wasteland 41.Open Space 42.Mobile Home Si 43.Condo Site 44.Lot Improvemen 45.Subdivision Lo 46.Golf Course
Sale Data			11.Regular Lot		Frontage	Depth	Factor	Code	
Sale Date 11/05/1986			12.Delta Triangle				%		
Price			13.Nabla Triangle				%		
Sale Type 2 Land & Buildings			14.Rear Land				%		
1.Land 4.Mobile 7.C/I L&B			15.Miscellaneous				%		
2.L & B 5.Other 8.			Square Foot		Square Feet				
3.Building 6.C/I Land 9.			16.Regular Lot				%		
Financing			17.Municipal Rese				%		
1.Convent 4.Seller 7.			18.Munic Sep Lago				%		
2.FHA/VA 5.Private 8.			19.Gravel Pit				%		
3.Assumed 6.Cash 9.Unknown			20.Industrial Bas				%		
Validity 1 Arms Length Sale			Fract. Acre		Acres/Sites				
1.Valid 4.Split 7.Renovate			21.Developed Pave	21	1.00	100	%	0	
2.Related 5.Partial 8.Other			22.Undev Paved (F	28	0.76	100	%	0	
3.Distress 6.Exempt 9.			23.Developed Grav				%		
Verified 5 Public Record			Acres				%		
1.Buyer 4.Agent 7.Family			24.Undev Gravel (%		
2.Seller 5.Pub Rec 8.Other			25.Comm Base Pave				%		
3.Lender 6.MLS 9.			26.Comm Base Grav				%		
			27.Backlot				%		
			28.Rear Land				%		
			29.Pavement				%		
			Total Acreage		1.76				

Washburn

Map Lot 012-044

Account 861

Location 1248 MAIN STREET

Card 1

Of 1

10/16/2019

Building Style	4 Cape Cod	SF Bsmt Living	0	Layout	1 Typical
1.Conv.	5.Garrison	9.Gambrel	Fin Bsmt Grade	0 0	1.Typical
2.Ranch	6.Salt Box	10.Other	OPEN 5 OPTIONAL	0	2.Inadeq
3.R Ranch	7.Contemp	11.Split	Heat Type	100% 5 Forced Warm Air	3.Poor
4.Cape	8.Log	12.	1.HWBB	5.FWA	9.No Heat
Dwelling Units	1	2.HWCI	6.GravWA	10.	Attic
Other Units	0	3.H Pump	7.Electric	11.	1.1/4 Fin
Stories	4 One & 1/2 Story	4.Steam	8.Fi/Wall	12.	4.Full Fin
1.1	4.1.5	7.	Cool Type	0% 9 None	7.
2.2	5.1.75	8.	1.Refrig	4.W&C Air	7.
3.3	6.2.5	9.	2.Evapor	5.	8.
Exterior Walls	1 Wood Siding	3.H Pump	6.	9.None	8.
1.Wood	5.Stucco	9.T-111	Kitchen Style	2 Typical	9.None
2.Vin/Al	6.Brick	10.Other	1.Modern	4.Obsolete	7.
3.Compos.	7.Stone	11.	2.Typical	5.	8.
4.Asbestos	8.Concrete	12.	3.Old Type	6.	9.None
Roof Surface	1 Asphalt Shingles	Bath(s) Style	2 Typical Bath(s)	1.Modern	4.Obsolete
1.Asphalt	4.Composit	7.	2.Typical	5.	8.
2.Slate	5.Wood	8.	3.Old Type	6.	9.None
3.Metal	6.Other	9.	SQFT (Footprint)	884	Condition
SF Masonry Trim	0	# Rooms	7	1.Poor	4.Avg
OPEN-3-CUSTOM	0	# Bedrooms	4	2.Fair	5.Avg+
OPEN-4-CUSTOM	0	# Full Baths	2	3.Avg-	6.Good
Year Built	1897	# Half Baths	0	Phys. % Good	0%
Year Remodeled	0	# Addn Fixtures	0	Funct. % Good	100%
Foundation	3 Brick &/or Stone	# Fireplaces	1	Functional Code	9 None
1.Concrete	4.Wood	7.	Economic Code	None	0.None
2.C Block	5.Slab	8.	0.No Power	7.	1.Location
3.Br/Stone	6.Piers	9.	1.Incomp	4.Delap	7.No Power
Basement	4 Full Basement	1.1/4 Bmt	4.Full Bmt	7.	2.O-Built
1.1/4 Bmt	4.Full Bmt	7.	2.1/2 Bmt	5.None	8.
2.1/2 Bmt	5.None	8.	3.3/4 Bmt	6.	9.None
3.3/4 Bmt	6.	9.None	Bsmt Gar # Cars	0	Entrance Code
Bsmt Gar # Cars	0	Wet Basement	1 Dry Basement	1.Dry	4.
Wet Basement	1 Dry Basement	1.Dry	4.	7.	2.Refusal
1.Dry	4.	7.	2.Damp	5.	8.
2.Damp	5.	8.	3.Wet	6.	9.
3.Wet	6.	9.			

Date Inspected 10/27/2018

Additions, Outbuildings & Improvements

Type	Year	Units	Grade	Cond	Phys.	Funct.	Sound Value
116 1.75 Story Barn	1900	1800	2 110	2	0 %	45 %	
21 Open Frame	1897	531	3 90	5	0 %	100 %	
20 1 Story/Bsmt	1897	21	9 100	9	0 %	100 %	
20 1 Story/Bsmt	1897	42	9 100	9	0 %	100 %	
20 1 Story/Bsmt	1920	80	3 90	5	0 %	100 %	
1 One Story Frame	1950	48	3 90	4	0 %	100 %	
					%	%	
					%	%	
					%	%	
					%	%	
					%	%	

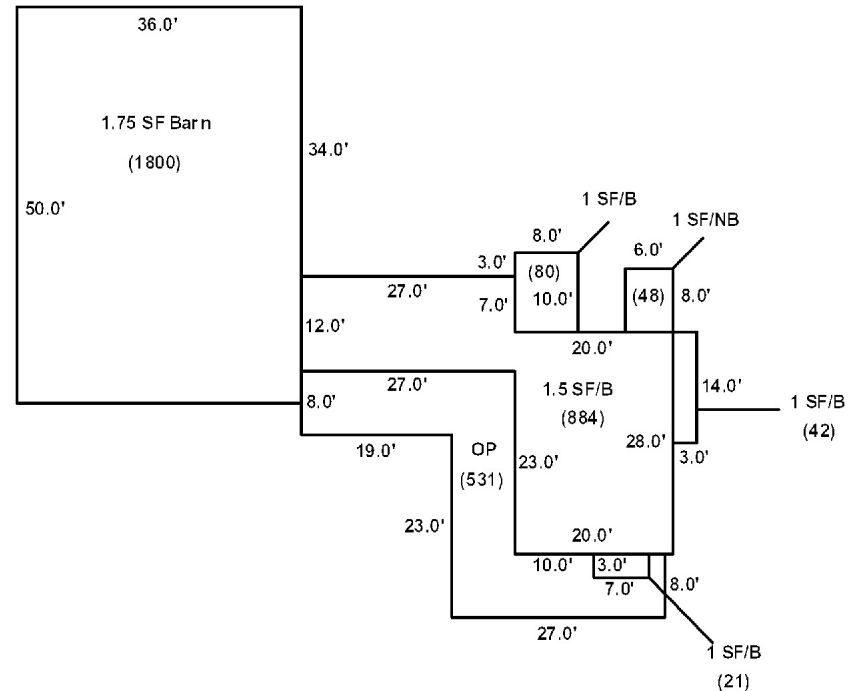

Town of Washburn

1287 Main Street

Washburn ME 04786

B2155P235

Property Data

Neighborhood	1 Neighborhood One	
Tree Growth Year	0	
1ST MORTGAGE	0	
2ND MORTGAGE	0	

Zone/Land Use	2 Commercial	
Secondary Zone		
Topography	1 Level	

1.Level	4.Below St	7.LevelBog
2.Rolling	5.Low	8.
3.Above St	6.Swampy	9.

Utilities	2 Public Water	3 Public Sewer
1.Public	4.Dr Well	7.Cesspool
2.Water	5.Dug Well	8.
3.Sewer	6.Septic	9.None

Street	1 Paved	
1.Paved	4.Proposed	7.
2.Semi Imp	5.R/O/W	8.
3.Gravel	6.	9.None

TG PLAN YEAR	0	
Tif District #	0	

Sale Data

Sale Date		
Price		
Sale Type	2 Land & Buildings	
1.Land	4.Mobile	7.C/I L&B
2.L & B	5.Other	8.
3.Building	6.C/I Land	9.
Financing		
1.Convent	4.Seller	7.
2.FHA/VA	5.Private	8.
3.Assumed	6.Cash	9.Unknown
Validity		
1.Valid	4.Split	7.Renovate
2.Related	5.Partial	8.Other
3.Distress	6.Exempt	9.
Verified		
1.Buyer	4.Agent	7.Family
2.Seller	5.Pub Rec	8.Other
3.Lender	6.MLS	9.

Assessment Record

Year	Land	Buildings	Exempt	Total
2007	9,000	142,400	151,400	0
2008	9,000	142,400	151,400	0
2009	9,000	142,400	151,400	0
2012	9,000	142,400	151,400	0
2013	11,700	142,400	154,100	0
2015	11,700	142,400	154,100	0
2018	11,700	142,400	154,100	0
2019	37,200	140,800	178,000	0

Land Data

Front Foot	Type	Effective		Influence		Influence Codes
		Frontage	Depth	Factor	Code	
11.Regular Lot				%		1.Unimproved
12.Delta Triangle				%		2.Excess Frtg
13.Nabla Triangle				%		3.Topography
14.Rear Land				%		4.Size/Shape
15.Miscellaneous				%		5.Access
				%		6.Restriction
				%		7.Open Space
				%		8.View/Environ
				%		9.Fract Share
				%		Acres
				%		30.Utility R O W
				%		31.Tillable
				%		32.Pasture
				%		33.Orchard
				%		34.Softwood F&O
				%		35.Mixed Wood F&O
				%		36.Hardwood F&O
				%		37.Softwood TG
				%		38.Mixed Wood TG
				%		39.Hardwood TG
				%		40.Wasteland
				%		41.Open Space
				%		42.Mobile Home Si
				%		43.Condo Site
				%		44.Lot Improvemen
				%		45.Subdivision Lo
				%		46.Golf Course
Total Acreage		1.11				

Inspection Witnessed By:

No./Date	Description	Date Insp.
X		

Notes:

Washburn

Map Lot 012-047

Account 1010

Location 1260 Main St - Health Care Ctr

Card 1 Of 1 10/16/2019

Building Style 0	SF Bsmt Living 0	Layout 0
1.Conv. 5.Garrison 9.Gambrel	Fin Bsmt Grade 0 0	1.Typical 4. 7.
2.Ranch 6.Salt Box 10.Other	OPEN 5 OPTIONAL 0	2.Inadeq 5. 8.
3.R Ranch 7.Contemp 11.Split	Heat Type 100% 0	3.Poor 6. 9.
4.Cape 8.Log 12.	1.HWBB 5.FWA 9.No Heat	Attic 0
Dwelling Units 0	2.HWCI 6.GravWA 10.	1.1/4 Fin 4.Full Fin 7.
Other Units 0	3.H Pump 7.Electric 11.	2.1/2 Fin 5.F/Stair 8.
Stories 0	4.Steam 8.F/Wall 12.	3.3/4 Fin 6. 9.None
1.1 4.1.5 7.	Cool Type 0% 9 None	Insulation 0
2.2 5.1.75 8.	1.Refrig 4.W&C Air 7.	1.Full 4.Minimal 7.
3.3 6.2.5 9.	2.Evapor 5. 8.	2.Heavy 5.Partial 8.
Exterior Walls 0	3.H Pump 6. 9.None	3.Capped 6. 9.None
1.Wood 5.Stucco 9.T-111	Kitchen Style 0	Unfinished % 0%
2.Vin/Al 6.Brick 10.Other	1.Modern 4.Obsolete 7.	Grade & Factor 0 0%
3.Compos. 7.Stone 11.	2.Typical 5. 8.	1.E Grade 4.B Grade 7.
4.Asbestos 8.Concrete 12.	3.Old Type 6. 9.None	2.D Grade 5.A Grade 8.SC Grade
Roof Surface 0	Bath(s) Style 0	3.C Grade 6.AA Grade 9.Same
1.Asphalt 4.Composit 7.	1.Modern 4.Obsolete 7.	SQFT (Footprint) 0
2.Slate 5.Wood 8.	2.Typical 5. 8.	Condition 0
3.Metal 6.Other 9.	3.Old Type 6. 9.None	1.Poor 4.Avg 7.V G
SF Masonry Trim 0	# Rooms 0	2.Fair 5.Avg+ 8.Exc
OPEN-3-CUSTOM 0	# Bedrooms 0	3.Avg- 6.Good 9.Same
OPEN-4-CUSTOM 0	# Full Baths 0	Phys. % Good 0%
Year Built 0	# Half Baths 0	Funcnt. % Good 100%
Year Remodeled 0	# Addn Fixtures 0	Functional Code 9 None
Foundation 0	# Fireplaces 0	1.Incomp 4.Delap 7.No Power
1.Concrete 4.Wood 7.		2.O-Built 5.Bsmt 8.LongTerm
2.C Block 5.Slab 8.		3.Damage 6.Common 9.None
3.Br/Stone 6.Piers 9.		Econ. % Good 100%
Basement 0		Economic Code None
1.1/4 Bmt 4.Full Bmt 7.		0.None 3.No Power 7.
2.1/2 Bmt 5.None 8.		1.Location 4.Generate 8.
3.3/4 Bmt 6. 9.None		2.Encroach 9.None 9.
Bsmt Gar # Cars 0		Entrance Code 5 Estimated
Wet Basement 0		1.Interior 4.Vacant 7.
1.Dry 4. 7.		2.Refusal 5.Estimate 8.
2.Damp 5. 8.		3.Informed 6.Reviewed 9.
3.Wet 6. 9.		Information Code 5 Estimate
		1.Owner 4.Agent 7.
		2.Relative 5.Estimate 8.
		3.Tenant 6.Other 9.



Date Inspected 10/27/2018

Additions, Outbuildings & Improvements

Type	Year	Units	Grade	Cond	Phys.	Funcnt.	Sound Value
20 1 Story/Bsmt	2000	2012	3 110	4	0 %	100 %	
21 Open Frame	2000	136	3 100	4	0 %	100 %	
40 Basement Entry	2000	95	3 100	4	0 %	100 %	
					%	%	
					%	%	
					%	%	
					%	%	
					%	%	
					%	%	
					%	%	
					%	%	

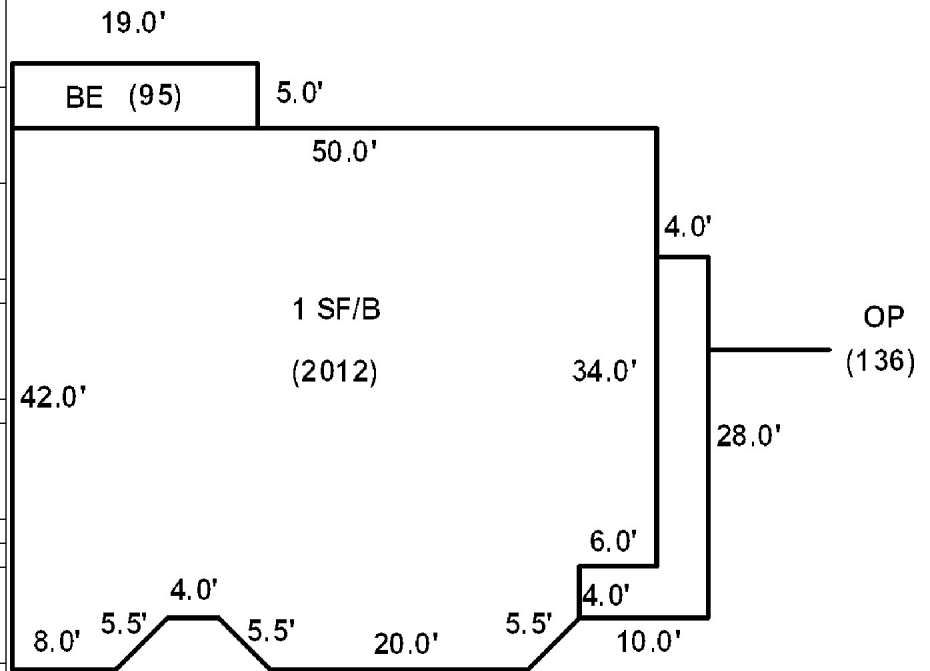

Washburn

Map Lot 012-048

Account 1057

Location 1266 MAIN STREET

Card 1 Of 1 10/16/2019

Building Style 1 Conventional	SF Bsmt Living 0	Layout 1 Typical
1.Conv. 5.Garrison 9.Gambrel	Fin Bsmt Grade 0 0	1.Typical 4. 7.
2.Ranch 6.Salt Box 10.Other	OPEN 5 OPTIONAL 0	2.Inadeq 5. 8.
3.R Ranch 7.Contemp 11.Split	Heat Type 100% 5 Forced Warm Air	3.Poor 6. 9.
4.Cape 8.Log 12.	1.HWBB 5.FWA 9.No Heat	Attic 9 None
Dwelling Units 1	2.HWCI 6.GravWA 10.	1.1/4 Fin 4.Full Fin 7.
Other Units 0	3.H Pump 7.Electric 11.	2.1/2 Fin 5.FI/Stair 8.
Stories 2 Two Story	4.Steam 8.FI/Wall 12.	3.3/4 Fin 6. 9.None
1.1 4.1.5 7.	Cool Type 0% 9 None	Insulation 1 Full
2.2 5.1.75 8.	1.Refrig 4.W&C Air 7.	1.Full 4.Minimal 7.
3.3 6.2.5 9.	2.Evapor 5. 8.	2.Heavy 5.Partial 8.
Exterior Walls 2 Vinyl/Aluminum	3.H Pump 6. 9.None	3.Capped 6. 9.None
1.Wood 5.Stucco 9.T-111	Kitchen Style 2 Typical	Unfinished % 0%
2.Vin/Al 6.Brick 10.Other	1.Modern 4.Obsolete 7.	Grade & Factor 2 Fair 110%
3.Compos. 7.Stone 11.	2.Typical 5. 8.	1.E Grade 4.B Grade 7.
4.Asbestos 8.Concrete 12.	3.Old Type 6. 9.None	2.D Grade 5.A Grade 8.SC Grade
Roof Surface 1 Asphalt Shingles	Bath(s) Style 2 Typical Bath(s)	3.C Grade 6.AA Grade 9.Same
1.Asphalt 4.Composit 7.	1.Modern 4.Obsolete 7.	SQFT (Footprint) 644
2.Slate 5.Wood 8.	2.Typical 5. 8.	Condition 6 Good
3.Metal 6.Other 9.	3.Old Type 6. 9.None	1.Poor 4.Avg 7.V G
SF Masonry Trim 0	# Rooms 8	2.Fair 5.Avg+ 8.Exc
OPEN-3-CUSTOM 0	# Bedrooms 4	3.Avg- 6.Good 9.Same
OPEN-4-CUSTOM 0	# Full Baths 1	Phys. % Good 0%
Year Built 1940	# Half Baths 1	Funct. % Good 100%
Year Remodeled 0	# Addn Fixtures 0	Functional Code 9 None
Foundation 1 Concrete	# Fireplaces 1	1.Incomp 4.Delap 7.No Power
1.Concrete 4.Wood 7.		2.O-Built 5.Bsmt 8.LongTerm
2.C Block 5.Slab 8.		3.Damage 6.Common 9.None
3.Br/Stone 6.Piers 9.		Econ. % Good 100%
Basement 4 Full Basement		Economic Code None
1.1/4 Bmt 4.Full Bmt 7.		0.None 3.No Power 7.
2.1/2 Bmt 5.None 8.		1.Location 4.Generate 8.
3.3/4 Bmt 6. 9.None		2.Encroach 9.None 9.
Bsmt Gar # Cars 0		Entrance Code 3 Information Only
Wet Basement 1 Dry Basement		1.Interior 4.Vacant 7.
1.Dry 4. 7.		2.Refusal 5.Estimate 8.
2.Damp 5. 8.	3.Informed 6.Reviewed 9.	
3.Wet 6. 9.	Information Code 1 Owner	
	1.Owner 4.Agent 7.	
	2.Relative 5.Estimate 8.	
	3.Tenant 6.Other 9.	

Date Inspected 10/27/2018

Additions, Outbuildings & Improvements

Type	Year	Units	Grade	Cond	Phys.	Funct.	Sound Value
22 Encl Frame Porch	1940	182	3 90	5	0 %	100 %	
61 Canopy	1950	277	3 95	4	0 %	100 %	
1 One Story Frame	1940	40	2 110	6	0 %	100 %	
40 Basement Entry	1940	220	2 115	4	0 %	100 %	
14 1.5 Story/Bsmt	1940	512	9 100	9	0 %	100 %	
21 Open Frame	1960	216	3 100	4	0 %	100 %	
23 Frame Garage	1940	252	2 100	3	0 %	100 %	
					%	%	
					%	%	
					%	%	

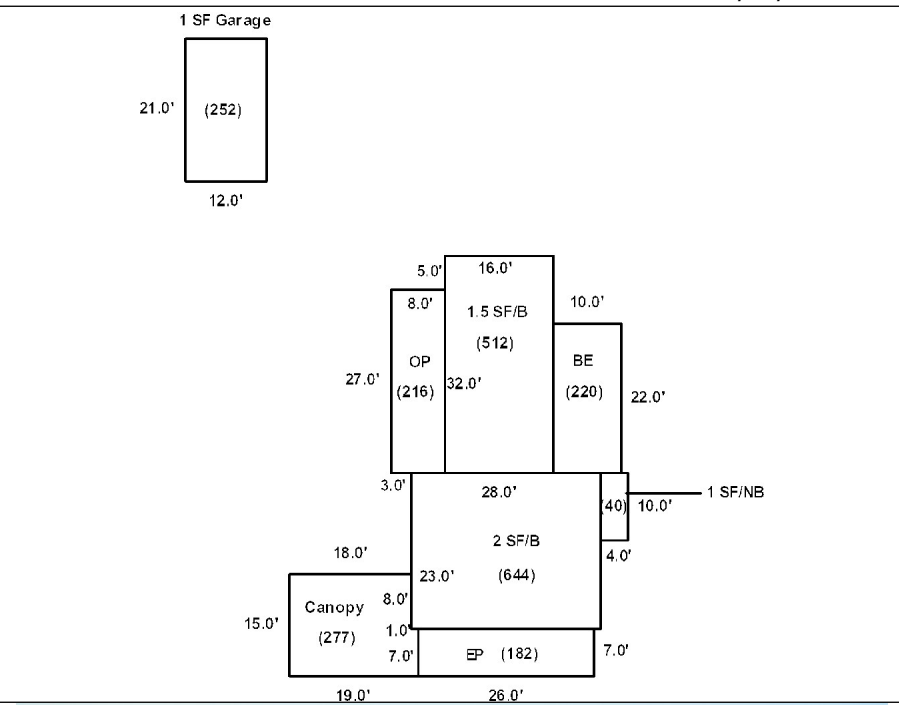

Washburn First Baptist Church

1268 Main Street

Washburn ME 04786

			Property Data			Assessment Record						
			Neighborhood	1 Neighborhood One		Year	Land	Buildings	Exempt	Total		
			Tree Growth Year	0		2007	2,000	62,900	64,900	0		
			1ST MORTGAGE	0		2008	2,000	62,900	64,900	0		
			2ND MORTGAGE	0		2009	2,000	62,900	64,900	0		
			Zone/Land Use	1 Residential		2012	2,000	62,900	64,900	0		
			Secondary Zone			2013	2,600	62,900	65,500	0		
			Topography	1 Level		2015	2,600	62,900	65,500	0		
			1.Level	4.Below St	7.LevelBog	2018	5,200	62,900	68,100	0		
			2.Rolling	5.Low	8.	2019	10,300	166,800	177,100	0		
			3.Above St	6.Swampy	9.							
			Utilities	2 Public Water 3 Public Sewer								
			1.Public	4.Dr Well	7.Cesspool							
			2.Water	5.Dug Well	8.							
			3.Sewer	6.Septic	9.None							
			Street	1 Paved								
			1.Paved	4.Proposed	7.							
			2.Semi Imp	5.R/O/W	8.							
			3.Gravel	6.	9.None							
			TG PLAN YEAR	0								
			Tif District #	0								
			Sale Data									
			Sale Date									
			Price									
			Sale Type									
			1.Land	4.Mobile	7.C/I L&B							
			2.L & B	5.Other	8.							
			3.Building	6.C/I Land	9.							
			Financing									
			1.Convent	4.Seller	7.							
			2.FHA/VA	5.Private	8.							
			3.Assumed	6.Cash	9.Unknown							
			Validity									
			1.Valid	4.Split	7.Renovate							
			2.Related	5.Partial	8.Other							
			3.Distress	6.Exempt	9.							
			Verified									
			1.Buyer	4.Agent	7.Family							
			2.Seller	5.Pub Rec	8.Other							
			3.Lender	6.MLS	9.							
						Land Data						
						Front Foot	Type	Effective		Influence		Influence Codes
								Frontage	Depth	Factor	Code	
						11.Regular Lot				%		1.Unimproved
						12.Delta Triangle				%		2.Excess Frtg
						13.Nabla Triangle				%		3.Topography
						14.Rear Land				%		4.Size/Shape
						15.Miscellaneous				%		5.Access
										%		6.Restriction
										%		7.Open Space
										%		8.View/Environ
										%		9.Fract Share
						Square Foot		Square Feet				Acres
						16.Regular Lot	29	700		100	%	0
						17.Municipal Rese				%		30.Utility R O W
						18.Munic Sep Lago				%		31.Tillable
						19.Gravel Pit				%		32.Pasture
						20.Industrial Bas				%		33.Orchard
										%		34.Softwood F&O
										%		35.Mixed Wood F&O
										%		36.Hardwood F&O
										%		37.Softwood TG
										%		38.Mixed Wood TG
										%		39.Hardwood TG
										%		40.Wasteland
										%		41.Open Space
										%		42.Mobile Home Si
										%		43.Condo Site
										%		44.Lot Improvemen
										%		45.Subdivision Lo
										%		46.Golf Course
						Fract. Acre		Acreage/Sites				
						21.Developed Pave	21	0.27		100	%	0
						22.Undev Paved (F				%		
						23.Developed Grav				%		
						Acres						
						24.Undev Gravel (%		
						25.Comm Base Pave				%		
						26.Comm Base Grav				%		
						27.Backlot				%		
						28.Rear Land				%		
						29.Pavement				%		
						Total Acreage		0.27				

Inspection Witnessed By:

X	Date	Description	Date Insp.

Notes:

*1-28-2019 -20% for size obs on church.

Washburn

Map Lot 012-049

Account 177

Location 1268 Main Street

Card 1 Of 1 10/16/2019

Building Style 0	SF Bsmt Living 0	Layout 0
1.Conv. 5.Garrison 9.Gambrel	Fin Bsmt Grade 0 0	1.Typical 4. 7.
2.Ranch 6.Salt Box 10.Other	OPEN 5 OPTIONAL 0	2.Inadeq 5. 8.
3.R Ranch 7.Contemp 11.Split	Heat Type 100% 0	3.Poor 6. 9.
4.Cape 8.Log 12.	1.HWBB 5.FWA 9.No Heat	Attic 0
Dwelling Units 0	2.HWCI 6.GravWA 10.	1.1/4 Fin 4.Full Fin 7.
Other Units 0	3.H Pump 7.Electric 11.	2.1/2 Fin 5.FI/Stair 8.
Stories 0	4.Steam 8.FI/Wall 12.	3.3/4 Fin 6. 9.None
1.1 4.1.5 7.	Cool Type 0% 9 None	Insulation 0
2.2 5.1.75 8.	1.Refrig 4.W&C Air 7.	1.Full 4.Minimal 7.
3.3 6.2.5 9.	2.Evapor 5. 8.	2.Heavy 5.Partial 8.
Exterior Walls 0	3.H Pump 6. 9.None	3.Capped 6. 9.None
1.Wood 5.Stucco 9.T-111	Kitchen Style 0	Unfinished % 0%
2.Vin/Al 6.Brick 10.Other	1.Modern 4.Obsolete 7.	Grade & Factor 0 0%
3.Compos. 7.Stone 11.	2.Typical 5. 8.	1.E Grade 4.B Grade 7.
4.Asbestos 8.Concrete 12.	3.Old Type 6. 9.None	2.D Grade 5.A Grade 8.SC Grade
Roof Surface 0	Bath(s) Style 0	3.C Grade 6.AA Grade 9.Same
1.Asphalt 4.Composit 7.	1.Modern 4.Obsolete 7.	SQFT (Footprint) 0
2.Slate 5.Wood 8.	2.Typical 5. 8.	Condition 0
3.Metal 6.Other 9.	3.Old Type 6. 9.None	1.Poor 4.Avg 7.V G
SF Masonry Trim 0	# Rooms 0	2.Fair 5.Avg+ 8.Exc
OPEN-3-CUSTOM 0	# Bedrooms 0	3.Avg- 6.Good 9.Same
OPEN-4-CUSTOM 0	# Full Baths 0	Phys. % Good 0%
Year Built 0	# Half Baths 0	Funct. % Good 100%
Year Remodeled 0	# Addn Fixtures 0	Functional Code 9 None
Foundation 0	# Fireplaces 0	1.Incomp 4.Delap 7.No Power
1.Concrete 4.Wood 7.		2.O-Built 5.Bsmt 8.LongTerm
2.C Block 5.Slab 8.		3.Damage 6.Common 9.None
3.Br/Stone 6.Piers 9.		Econ. % Good 100%
Basement 0		Economic Code None
1.1/4 Bmt 4.Full Bmt 7.		0.None 3.No Power 7.
2.1/2 Bmt 5.None 8.		1.Location 4.Generate 8.
3.3/4 Bmt 6. 9.None		2.Encroach 9.None 9.
Bsmt Gar # Cars 0		Entrance Code 5 Estimated
Wet Basement 0		1.Interior 4.Vacant 7.
1.Dry 4. 7.		2.Refusal 5.Estimate 8.
2.Damp 5. 8.		3.Informed 6.Reviewed 9.
3.Wet 6. 9.		Information Code 5 Estimate
		1.Owner 4.Agent 7.
		2.Relative 5.Estimate 8.
		3.Tenant 6.Other 9.

Date Inspected 10/27/2018

Additions, Outbuildings & Improvements

Type	Year	Units	Grade	Cond	Phys.	Funct.	Sound Value
228 Church	1950	2392	2 110	6	0 %	80 %	
1 One Story Frame	1950	90	3 90	4	0 %	100 %	
1 One Story Frame	1950	64	3 90	4	0 %	100 %	
					%	%	
					%	%	
					%	%	
					%	%	
					%	%	
					%	%	
					%	%	
					%	%	
					%	%	

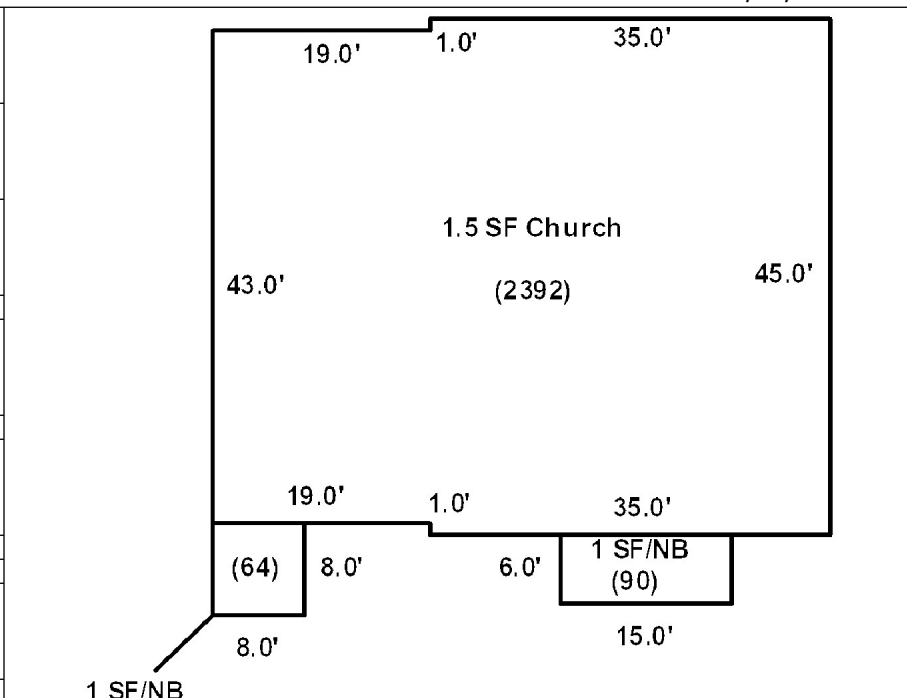

Washburn

Map Lot 012-050

Account 449

Location 1272 MAIN STREET

Card 1

Of 1

10/16/2019

Building Style 1 Conventional	SF Bsmt Living 0	Layout 1 Typical
1.Conv. 5.Garrison 9.Gambrel	Fin Bsmt Grade 0 0	1.Typical 4. 7.
2.Ranch 6.Salt Box 10.Other	OPEN 5 OPTIONAL 0	2.Inadeq 5. 8.
3.R Ranch 7.Contemp 11.Split	Heat Type 100% 1 Hot Water BB	3.Poor 6. 9.
4.Cape 8.Log 12.	1.HWBB 5.FWA 9.No Heat	Attic 9 None
Dwelling Units 2	2.HWCI 6.GravWA 10.	1.1/4 Fin 4.Full Fin 7.
Other Units 0	3.H Pump 7.Electric 11.	2.1/2 Fin 5.F/Stair 8.
Stories 2 Two Story	4.Steam 8.F/Wall 12.	3.3/4 Fin 6. 9.None
1.1 4.1.5 7.	Cool Type 0% 9 None	Insulation 1 Full
2.2 5.1.75 8.	1.Refrig 4.W&C Air 7.	1.Full 4.Minimal 7.
3.3 6.2.5 9.	2.Evapor 5. 8.	2.Heavy 5.Partial 8.
Exterior Walls 2 Vinyl/Aluminum	3.H Pump 6. 9.None	3.Capped 6. 9.None
1.Wood 5.Stucco 9.T-111	Kitchen Style 2 Typical	Unfinished % 0%
2.Vin/Al 6.Brick 10.Other	1.Modern 4.Obsolete 7.	Grade & Factor 2 Fair 110%
3.Compos. 7.Stone 11.	2.Typical 5. 8.	1.E Grade 4.B Grade 7.
4.Asbestos 8.Concrete 12.	3.Old Type 6. 9.None	2.D Grade 5.A Grade 8.SC Grade
Roof Surface 3 Sheet Metal	Bath(s) Style 2 Typical Bath(s)	3.C Grade 6.AA Grade 9.Same
1.Asphalt 4.Composit 7.	1.Modern 4.Obsolete 7.	SQFT (Footprint) 1044
2.Slate 5.Wood 8.	2.Typical 5. 8.	Condition 5 Above Average
3.Metal 6.Other 9.	3.Old Type 6. 9.None	1.Poor 4.Avg 7.V G
SF Masonry Trim 0	# Rooms 10	2.Fair 5.Avg+ 8.Exc
OPEN-3-CUSTOM 0	# Bedrooms 4	3.Avg- 6.Good 9.Same
OPEN-4-CUSTOM 0	# Full Baths 2	Phys. % Good 0%
Year Built 1920	# Half Baths 0	Funct. % Good 100%
Year Remodeled 0	# Addn Fixtures 0	Functional Code 9 None
Foundation 1 Concrete	# Fireplaces 0	1.Incomp 4.Delap 7.No Power
1.Concrete 4.Wood 7.		2.O-Built 5.Bsmt 8.LongTerm
2.C Block 5.Slab 8.		Econ. % Good 100%
3.Br/Stone 6.Piers 9.		Economic Code None
Basement 4 Full Basement		0.None 3.No Power 7.
1.1/4 Bmt 4.Full Bmt 7.		1.Location 4.Generate 8.
2.1/2 Bmt 5.None 8.		2.Encroach 9.None 9.
3.3/4 Bmt 6. 9.None		Entrance Code 5 Estimated
Bsmt Gar # Cars 0		1.Interior 4.Vacant 7.
Wet Basement 1 Dry Basement		2.Refusal 5.Estimate 8.
1.Dry 4. 7.		3.Informed 6.Reviewed 9.
2.Damp 5. 8.	Information Code 5 Estimate	
3.Wet 6. 9.	1.Owner 4.Agent 7.	
	2.Relative 5.Estimate 8.	
	3.Tenant 6.Other 9.	

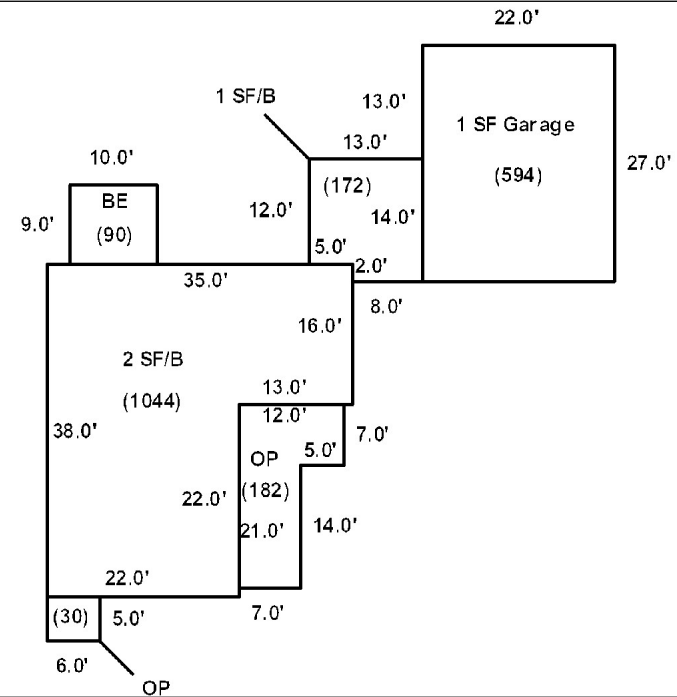

Date Inspected 10/27/2018

Additions, Outbuildings & Improvements

Type	Year	Units	Grade	Cond	Phys.	Funct.	Sound Value
21 Open Frame	1960	30	9 100	9	0 %	100 %	
21 Open Frame	1960	182	3 100	5	0 %	100 %	
40 Basement Entry	1960	90	3 90	4	0 %	100 %	
20 1 Story/Bsmt	1960	172	9 100	9	0 %	100 %	
23 Frame Garage	1960	594	3 100	5	0 %	90 %	
					%	%	
					%	%	
					%	%	
					%	%	
					%	%	
					%	%	
					%	%	

